

F.A.P. SECTION	COUNTY	TOTAL SHEETS	SHEET NO.
750 (112,113) Y, WRS	FAYETTE	178	137
STA. TO STA.		FED. AID PROJECT	
FED. ROAD DIST. NO. 7 ILLINOIS		CONTRACT NO. 94927	

FINAL SURVEY	SURVEYED	DATE
NOTE BOOK	PLOTTED	
NO.	TEMPLA	
	AREAS CHECKED	

ORIGINAL SURVEY	SURVEYED	DATE
NOTE BOOK	PLOTTED	
NO.	TEMPLA	
	AREAS CHECKED	

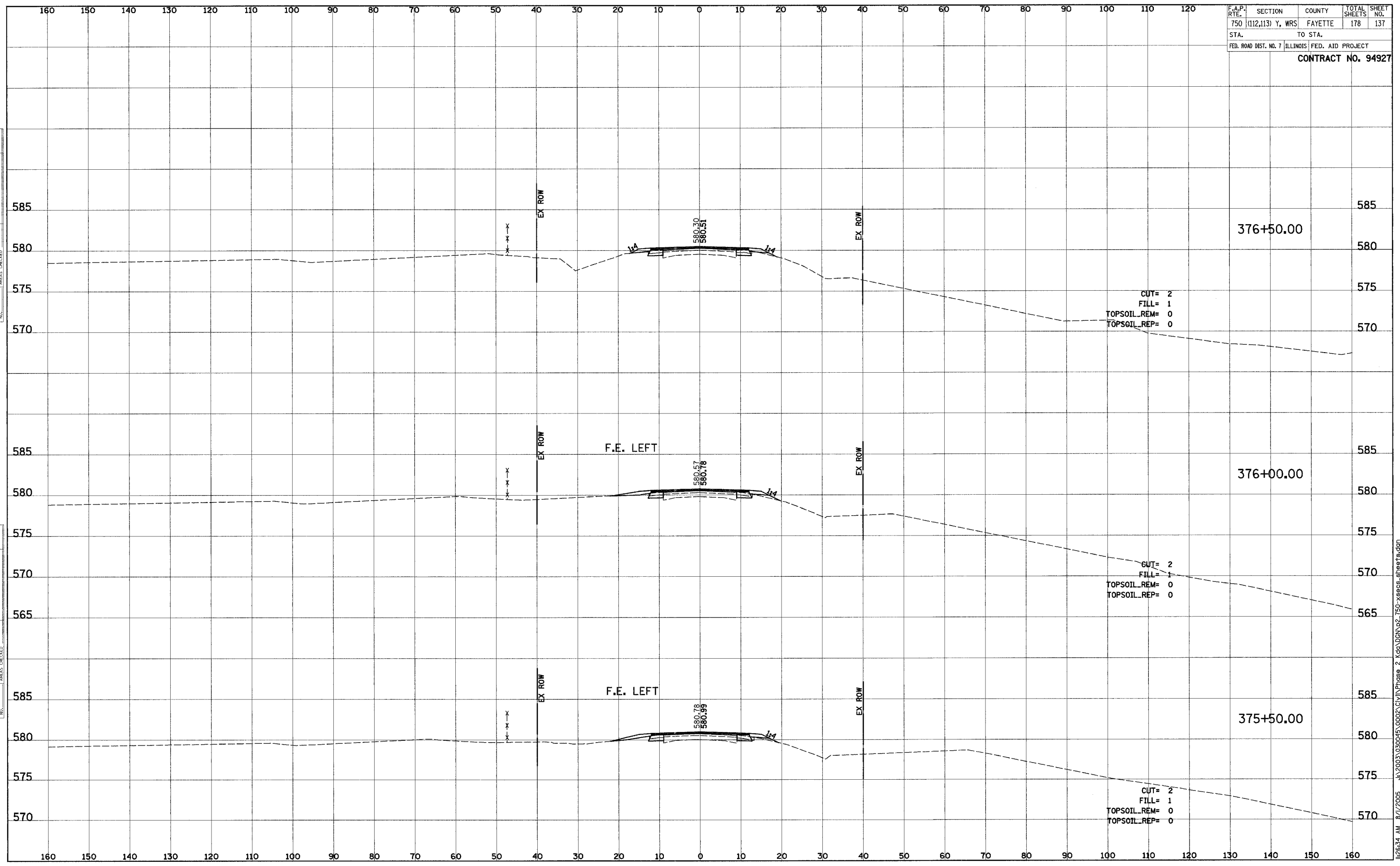

8/1/2005 8:26:34 AM J:\2003\030045\0002\Civil\Phase 2\kg\UGN\p2_750-xsecs.sheets.dgn