

- A**
[DETOUR]
M4-8
(24 x 12)
- B**
[END DETOUR]
M4-8a
(24 x 18)
- C**
[SOUTH]
M3-3
(21 x 9)
- D**
[INTERSTATE 55]
M1-1
(24 x 24)
- E**
[41]
M1-4
(24 x 24)
- F**
[←]
M5-1(L)
(21 x 15)
- G**
[←]
M6-1(L)
(21 x 15)
- H**
[↑]
M6-3
(21 x 15)
- I**
[↗]
M6-2(R)
(21 x 15)
- J**
[↗]
M5-2
(21 x 15)

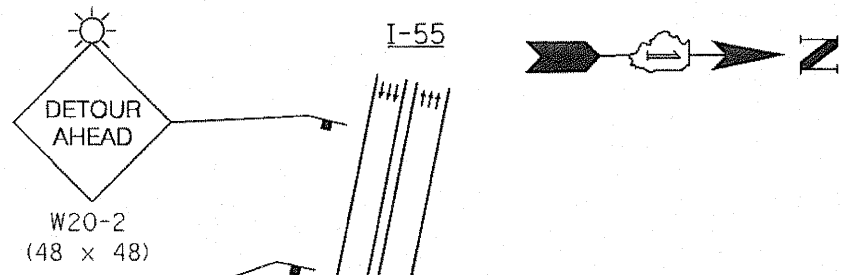

- NOTES:**
- ALL SIGN DIMENSIONS ARE SHOWN IN INCHES.
 - THE COST OF PROVIDING AND REMOVING THE DETOUR SIGNING SHALL BE INCLUDED IN THE BID PRICE FOR "TRAFFIC CONTROL AND PROTECTION (EXPRESSWAYS)".
 - ALL DETOUR AND DIRECTION SIGNS SHALL BE ORANGE WITH BLACK LETTERS & SYMBOLS.
 - SIGN M1-1 SHALL BE BLUE AND RED WITH WHITE LETTERS. SIGN M1-4 SHALL BE WHITE WITH BLACK LETTERS.

SB U.S. 41
(S LAKE SHORE DR)
RAMP CLOSED
USE 18 TH ST
USE PORTABLE
CHANGEABLE
MESSAGE SIGN

STAGE III B
RAMP & LANE 3 CLOSURES

CONNECTOR RAMP FROM
NB I-55 TO SB US 41
STRUCTURE NO. 016-1045

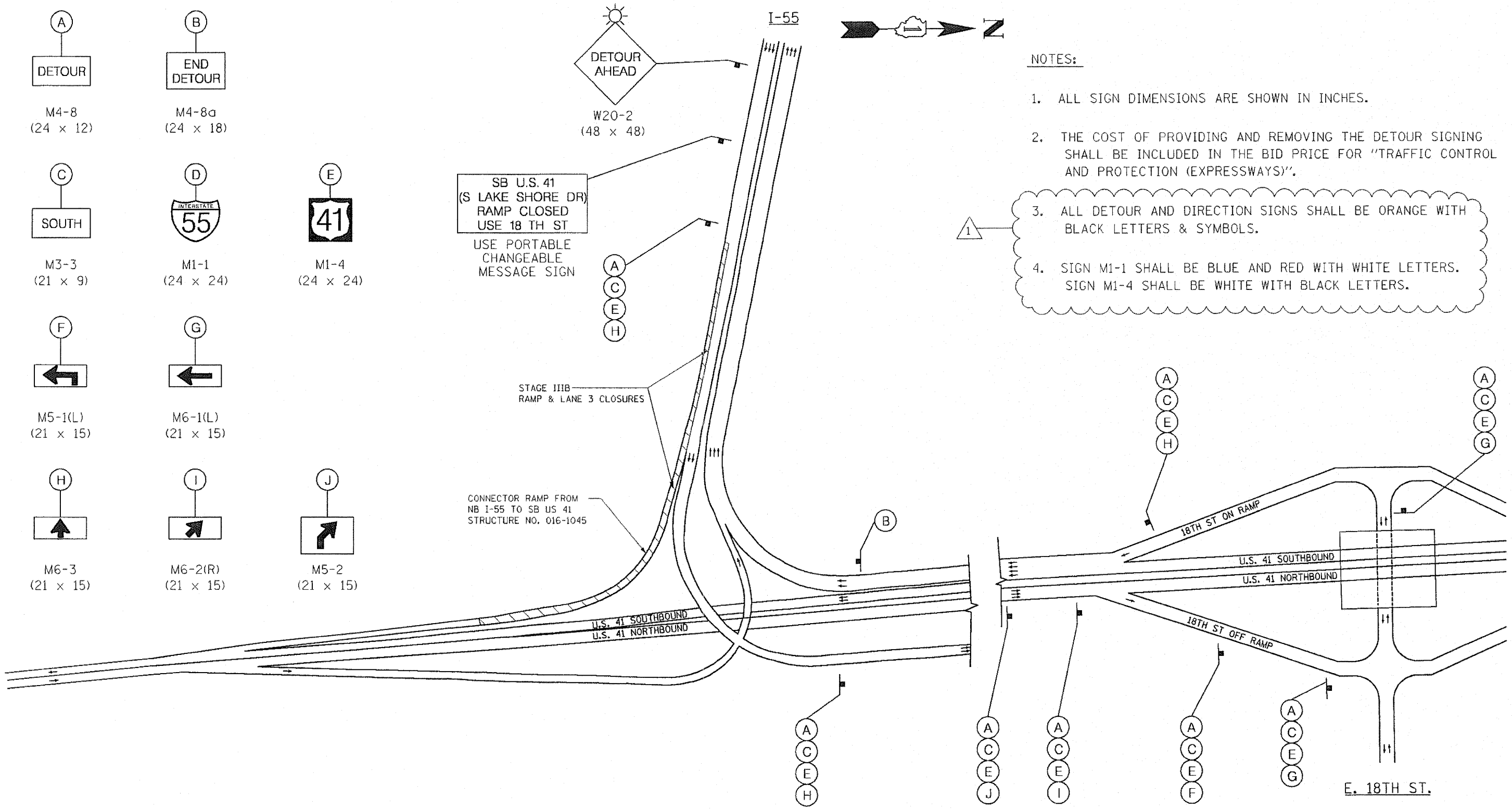

DETOUR STAGE III B
N.B. I-55 TO S.B. U.S. 41

FILE NAME: I:\102908.I-55.STRUCTURAL\shes\3160937-18-detour-11TB.dgn

	USER NAME = IDGT	DESIGNED - J.C.N./B.N.S.	REVISED - 1 ADDENDUM 1 11-04-2011	STATE OF ILLINOIS DEPARTMENT OF TRANSPORTATION	DETOUR PLAN - STAGE III B F.A.I. RTE. I-55 OVER U.S. 41 / LAKE SHORE DRIVE	F.A.I. RTE. 55	SECTION 2011-031-BR	COUNTY COOK	TOTAL SHEETS 41	SHEET NO. 10
	PLOT SCALE = 99.9999' / IN.	CHECKED - B.N.S./J.C.N.	REVISED -			CONTRACT NO. 60P37				
	PLOT DATE = 11/3/2011	DRAWN - F.M.	REVISED -			ILLINOIS FED. AID PROJECT				
	DATE - OCTOBER 12, 2011	DATE -	REVISED -			SHEET NO. 510 OF 541 SHEETS				