

NOTES:

1. ALL SIGN DIMENSIONS ARE SHOWN IN INCHES.
2. THE COST OF PROVIDING AND REMOVING THE DETOUR SIGNING SHALL BE INCLUDED IN THE BID PRICE FOR "TRAFFIC CONTROL AND PROTECTION (EXPRESSWAYS)".
3. ALL DETOUR AND DIRECTION SIGNS SHALL BE ORANGE WITH BLACK LETTERS & SYMBOLS.
4. SIGN M1-1 SHALL BE BLUE AND RED WITH WHITE LETTERS. SIGN M1-4 SHALL BE WHITE WITH BLACK LETTERS.

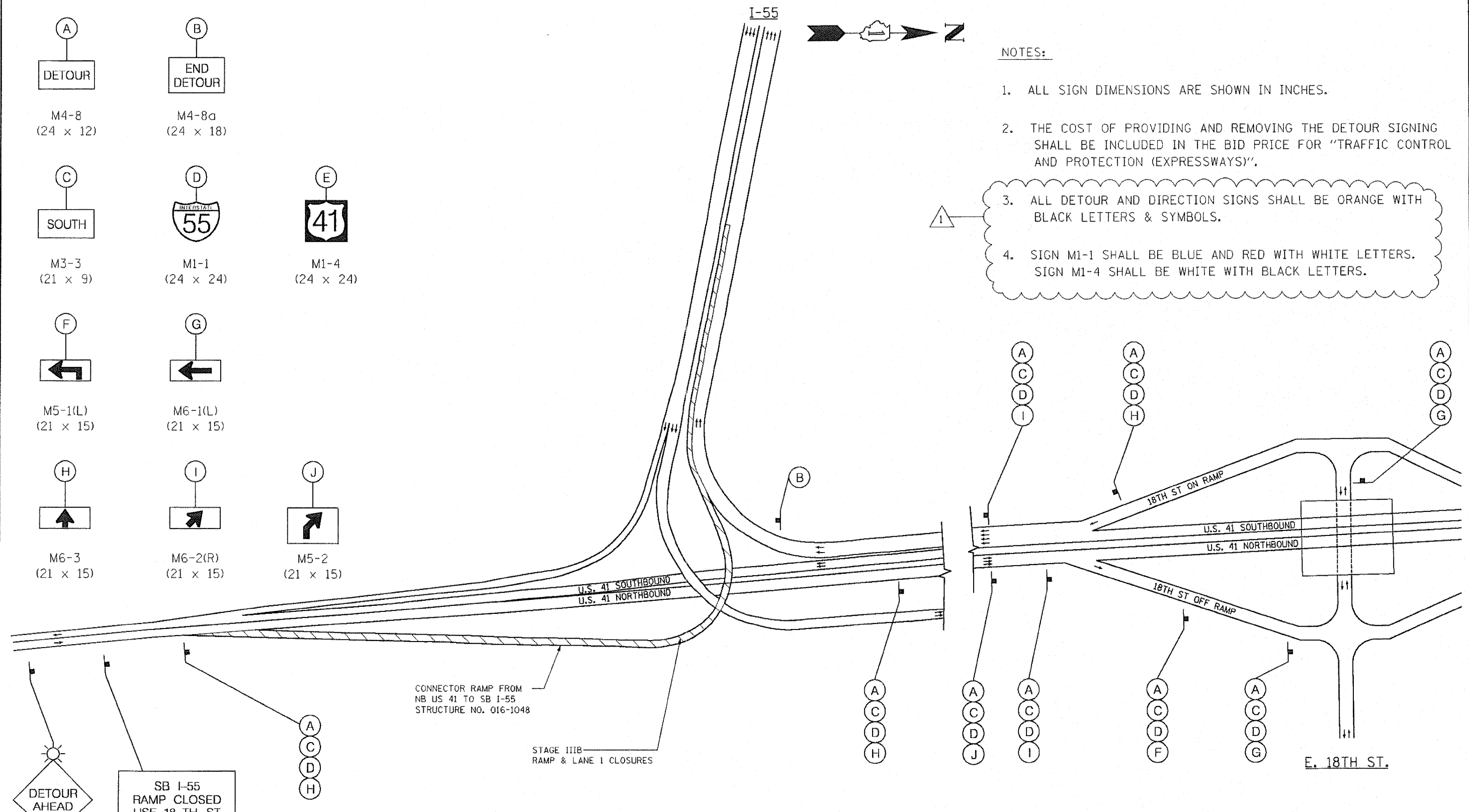

NIGHT TIME DETOUR PLAN - STAGE II & STAGE III B
 N.B. U.S. 41 TO S.B. I-55

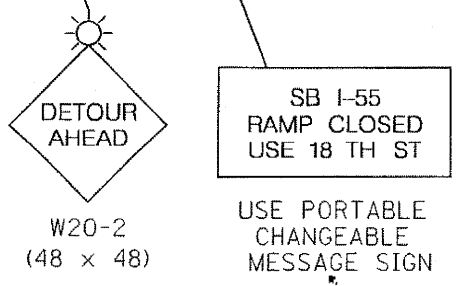

FILE NAME = I:\102506_I-55 STRUCTURAL\sheet\1060P37-11-detour-11IB.dgn

	USER NAME = IDDT	DESIGNED - J.C.N./B.N.S.	REVISED - 1-ADDENDUM 1 11-04-2011
	PLOT SCALE = 99.9999 / / IN.	CHECKED - B.N.S./J.C.N.	REVISED -
	PLOT DATE = 11/3/2011	DRAWN - F.M.	REVISED -
		DATE - OCTOBER 12, 2011	REVISED -

STATE OF ILLINOIS
 DEPARTMENT OF TRANSPORTATION

NIGHT TIME DETOUR PLAN - STAGE II & STAGE III B
 F.A.I. RTE. I-55 OVER U.S. 41 / LAKE SHORE DRIVE

F.A.I. RTE.	SECTION	COUNTY	TOTAL SHEETS	SHEET NO.
55	2011-031-BR	COOK	41	11
CONTRACT NO. 60P37				
ILLINOIS FED. AID PROJECT				

SHEET NO. S11 OF S41 SHEETS