

STATE OF ILLINOIS

DEPARTMENT OF TRANSPORTATION

PRELIMINARY PROPOSED HIGHWAY PLANS

**F.A.P ROUTE 753 (IL 104)
SECTION 128TR
PROJECT STP-YZUI(431)
TREE REMOVAL
MORGAN COUNTY**

C-96-059-23

F.A.P. RTE.	SECTION	COUNTY	TOTAL SHEETS	SHEET NO.
753	128TR	MORGAN	27	1
		ILLINOIS	CONTRACT NO. 72119	

D-96-020-23

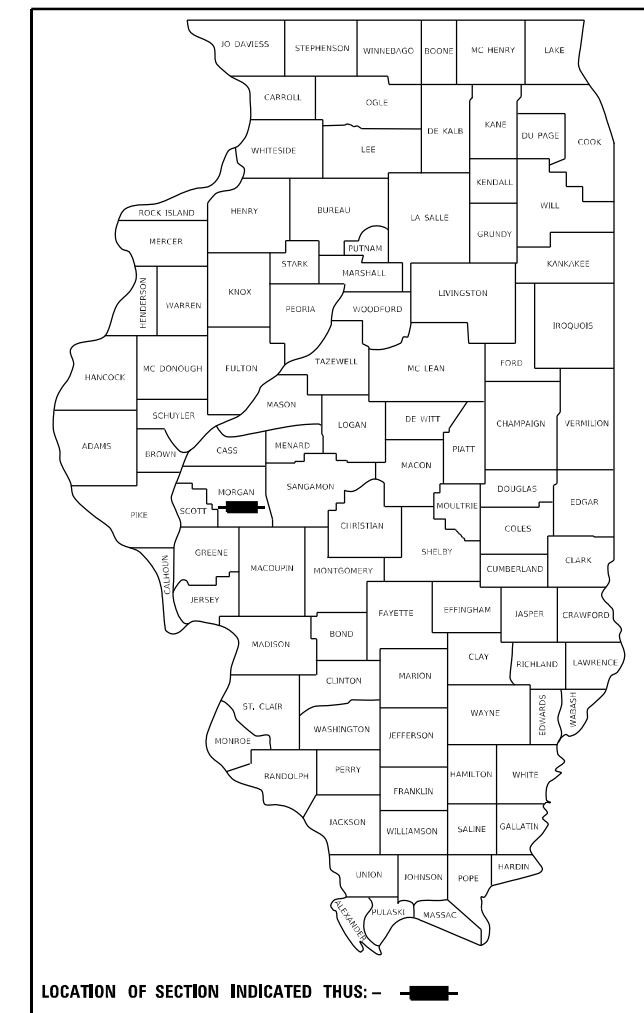

INDEX OF SHEETS

SHEET NO.	SHEET DESCRIPTION
1	COVER SHEET
2	GENERAL NOTES, HIGHWAY STANDARDS
3	SUMMARY OF QUANTITIES
4	SCHEDULES
5-6	ALIGNMENT INFORMATION (EXISTING & PROPOSED)
7-13	REMOVAL PLANS
14-20	EROSION CONTROL PLANS
21-27	RIGHT OF WAY PLANS - INFORMATION ONLY

ROADWAY CLASSIFICATION
MINOR ARTERIAL

AVERAGE DAILY TRAFFIC YEAR 2021
WAVERLY LAKE ROAD\GORDON HILL ROAD TO LIMA ROAD
ADT: 2750 (MU = 3.64%, SU = 3.27%, PV = 93.09%)

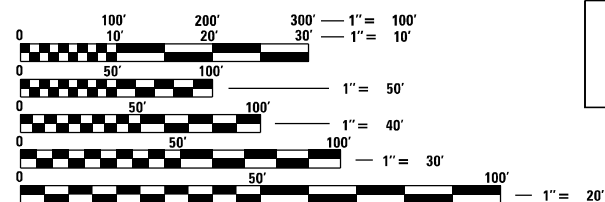

FULL SIZE PLANS HAVE BEEN PREPARED USING STANDARD ENGINEERING SCALES. REDUCED SIZED PLANS WILL NOT CONFORM TO STANDARD SCALES. IN MAKING MEASUREMENTS ON REDUCED PLANS, THE ABOVE SCALES MAY BE USED.

J.U.L.I.E.
JOINT UTILITY LOCATION INFORMATION FOR EXCAVATION
1-800-892-0123
OR 811

BEGIN PROJECT
STATION 698+00.00 R1

STATION EQUATION
STATION 721+97.87 R1 BK =
STATION 721+96.60 R2 AH

END PROJECT
STATION 736+00.00 R2

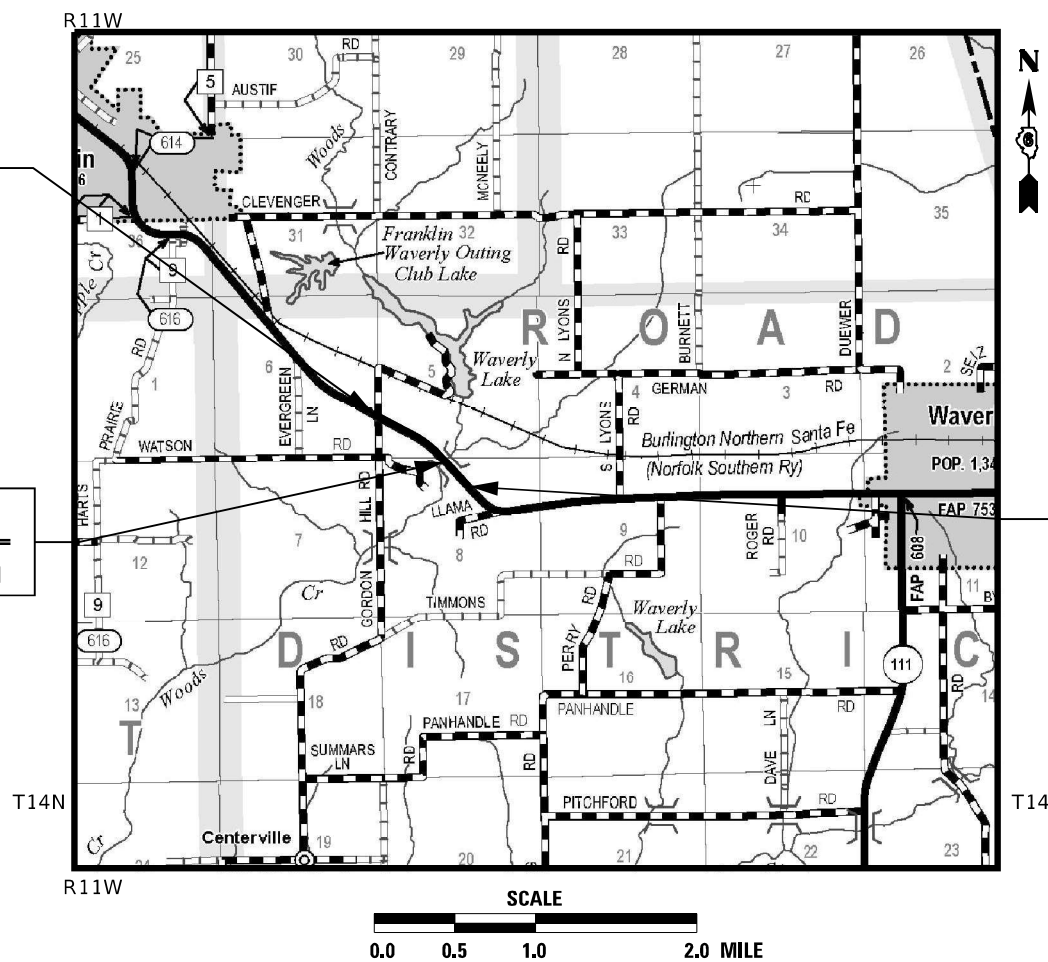

GROSS LENGTH = 3801.3 FT. = 0.72 MILE
NET LENGTH = 3801.3 FT. = 0.72 MILE

PROJECT ENGINEER BRIAN LANINGHAM 217-782-6990
PROJECT MANAGER MICHAEL WHITLING 217-524-0239

CONTRACT NO. 72119

STATE OF ILLINOIS
DEPARTMENT OF TRANSPORTATION

SUBMITTED August 23, 2022

REGIONAL ENGINEER

October 14, 2022

ENGINEER OF DESIGN AND ENVIRONMENT

October 14, 2022

DIRECTOR OF HIGHWAYS PROJECT IMPLEMENTATION

**PRINTED BY THE AUTHORITY
OF THE STATE OF ILLINOIS**

HIGHWAY STANDARDS

NUMBER	DESCRIPTION
00001-08	STANDARD SYMBOLS, ABBREVIATIONS AND PATTERNS
001006	DECIMAL OF AN INCH AND OF FOOT
280001-07	TEMPORARY EROSION CONTROL SYSTEM
701001-02	OFF-RD OPERATIONS, 2L, 2W, MORE THAN 15' (4.5m) AWAY
701006-05	OFF-RD OPERATIONS, 2L, 2S, 15' (4.5m) TO 24' (600mm) FROM PAVEMENT EDGE
701201-05	LANE CLOSURE, 2L, 2W, DAY ONLY, FOR SPEEDS \geq 45 MPH
701901-08	TRAFFIC CONTROL DEVICES

GENERAL NOTES

- TEMPORARY EROSION CONTROL SEEDING IS INCLUDED IN THIS CONTRACT TO SEED ALL AREAS THAT HAVE BEEN DISTURBED DUE TO THE TREE REMOVAL PROCESS OR OTHER AREAS AS DIRECTED BY THE ENGINEER.
- AGGREGATE DITCH CHECKS, INLET AND PIPE PROTECTION AND PERIMETER EROSION BARRIER SHALL BE PLACED AS SHOWN IN THE PLANS OR AS DIRECTED BY THE ENGINEER.
- ALL TREES TO BE SAVED IN THE "TREES TO BE SAVED TABLE" SHALL BE MARKED BY THE CONTRACTOR AND VERIFIED BY THE ENGINEER PRIOR TO ANY TREE REMOVAL.
- RIGHT OF WAY PLANS ARE SHOWN FOR INFORMATIONAL PURPOSES ONLY, FURNISHING AND ERECTING RIGHT OF WAY MARKERS TO BE PERFORMED BY OTHER IN FUTURE CONTRACT.

COMMITMENTS

- TREES EQUAL TO OR GREATER THAN 3 INCHES IN DIAMETER SHALL NOT BE REMOVED BETWEEN APRIL 1 AND SEPTEMBER 30 OF ANY GIVEN YEAR
- ALL TREES LISTED IN THE "TREES TO BE SAVED" TABLE SHALL NOT BE REMOVED, BUT SHALL REMAIN.

TREES TO BE SAVED TABLE			
STATION	OFFSET (FEET)	SIDE	TREE DESCRIPTION
701+18.76	66.58	RT	15" HICKORY
701+21.96	104.65	RT	17" HICKORY
701+35.54	116.48	RT	27" WHITE OAK
701+62.88	108.30	RT	40" WHITE OAK
701+59.12	103.35	RT	7" HICKORY
701+74.27	122.81	RT	7" HICKORY
701+89.15	110.20	RT	26" WHITE OAK
701+59.38	131.81	RT	6" HICKORY
701+59.38	129.88	RT	6" HICKORY
701+59.38	127.25	RT	12" HICKORY
702+08.72	110.56	RT	33" WHITE OAK
702+29.09	133.10	RT	28" WHITE OAK
702+36.85	120.88	RT	6" SHAGBARK HICKORY
702+45.27	121.48	RT	6" CHERRY
702+62.95	114.45	RT	7" RED OAK
702+35.42	92.46	RT	20" RED OAK
702+01.78	89.38	RT	10" ELM
701+86.18	89.95	RT	6" RED OAK
702+61.21	96.52	RT	22" WHITE OAK
702+74.93	108.79	RT	23" WHITE OAK
702+82.82	105.46	RT	6" ELM
702+79.51	91.64	RT	8" RED OAK
702+95.55	87.44	RT	20" WHITE OAK
703+01.04	92.66	RT	20" WHITE OAK
702+99.13	105.80	RT	6" SHAGBARK HICKORY
702+96.98	108.97	RT	15" RED OAK
702+99.02	114.04	RT	8" RED OAK
703+08.21	115.44	RT	12" RED OAK

APPLICATION RATES

THE FOLLOWING RATES OF APPLICATION WERE UTILIZED TO CALCULATE QUANTITIES

TEMPORARY EROSION CONTROL SEEDING 100 LBS/ACRE

**STATE OF ILLINOIS
DEPARTMENT OF TRANSPORTATION
DIVISION OF HIGHWAYS
DISTRICT 6**

EXAMINED August 22 20 22

 ENGINEER OF OPERATIONS

EXAMINED August 22 20 22

 ENGINEER OF PROJECT IMPLEMENTATION

EXAMINED August 16 20 22

 ENGINEER OF PROGRAM DEVELOPMENT

MODEL 01 GENERAL NOTES
FILE NAME: p:\public\paw_bentley.com\p\INDOT\Documents\DOT_Offices\District_6\Project\0672119\CaddData\Cadd\Sheet\0672119-sh-03-gennote.dgn

USER NAME = Michael.Whitting	DESIGNED -	REVISED -
	DRAWN -	REVISED -
PLOT SCALE = 100,0000 ' / in.	CHECKED -	REVISED -
PLOT DATE = 8/23/2022	DATE -	REVISED -

**STATE OF ILLINOIS
DEPARTMENT OF TRANSPORTATION**

GENERAL NOTES	
SCALE:	SHEET OF SHEETS STA. TO STA.

F.A.P. RTE.	SECTION	COUNTY	TOTAL SHEETS	SHEET NO.
753	128TR	MORGAN	27	2
			CONTRACT NO. 72119	
		ILLINOIS	FED. AID PROJECT	

MODEL Summary of Quantities
 FILE NAME: p:\pub\elect\paweb\com\PIV\DOT\Documents\DOT Office\Dir\dir_6\Project\0672119\CADD\data\CADD\sheet\0672119-sh-03-SUM.dgn

CONSTR. CODE
 PPS# 6-01108-0300
 80% FED / 20% STATE

CODE NO.	ITEM	UNIT	TOTAL QUANTITY	TREE REMOVAL
				RURAL
20100110	TREE REMOVAL (6 TO 15 UNITS DIAMETER)	UNIT	276	276
20100210	TREE REMOVAL (OVER 15 UNITS DIAMETER)	UNIT	253	253
20100500	TREE REMOVAL, ACRES	ACRE	7.5	7.50
28000250	TEMPORARY EROSION CONTROL SEEDING	POUND	1182	1182
28000315	AGGREGATE DITCH CHECKS	TON	120	120
28000400	PERIMETER EROSION BARRIER	FOOT	3290	3290
28000500	INLET AND PIPE PROTECTION	EACH	9	9
67100100	MOBILIZATION	L SUM	1	1
70100450	TRAFFIC CONTROL AND PROTECTION, STANDARD 701201	L SUM	1	1
X6650202	WOVEN WIRE FENCE REMOVAL	FOOT	4584	4584

USER NAME = Michael.Whitting	DESIGNED -	REVISED -
	DRAWN -	REVISED -
PLOT SCALE = 100,0000' / in.	CHECKED -	REVISED -
PLOT DATE = 8/23/2022	DATE -	REVISED -

STATE OF ILLINOIS
DEPARTMENT OF TRANSPORTATION

SUMMARY OF QUANTITIES

SCALE: SHEET OF SHEETS STA. TO STA.

F.A.P. RTE.	SECTION	COUNTY	TOTAL SHEETS	SHEET NO.
753	128TR	MORGAN	27	3
			CONTRACT NO. 72119	
ILLINOIS FED. AID PROJECT				

20100500 - TREE REMOVAL, ACRES					
STATION	SIDE	TO	STATION	SIDE	ACRES
699+38.00	LT	-	705+93.00	LT	0.56
706+57.00	LT	-	716+27.00	LT	0.99
716+50.00	LT	-	716+85.00	LT	0.58
717+03.00	LT	-	724+68 R2	LT	1.89
725+40.00 R2	LT	-	726+42.00 R2	LT	0.07
728+41.00 R2	LT	-	733+82.00 R2	LT	0.51
701+38.00	RT	-	705+31.00	RT	0.50
705+99.00	RT	-	711+05.00	RT	0.78
711+34.00	RT	-	715+75.00	RT	0.87
722+33.00 R2	RT	-	724+27.00 R2	RT	0.12
724+75.00 R2	RT	-	726+16.00 R2	RT	0.15
727+75.00 R2	RT	-	734+75.00 R2	RT	0.43
TOTAL =					7.50

20100210 - TREE REMOVAL (OVER 15 UNITS DIAMETER)			
STATION	OFFSET	SIDE	UNIT
734+85.20	42.0	RT	19
734+71.60	34.5	LT	30
735+19.73	31.8	LT	16
735+20.88	34.7	LT	16
735+39.05	32.8	LT	24
735+53.86	39.3	RT	34
735+82.46	33.8	LT	16
736+20.52	28.5	LT	20
736+45.64	34.2	LT	25
736+49.65	34.7	LT	19
736+56.29	40.5	RT	18
736+56.29	40.5	RT	16
TOTAL =			253

28000400 - PERIMETER EROSION BARRIER							
STATION	OFFSET	SIDE	TO	STATION	OFFSET	SIDE	FOOT
699+00.00	44.0	LT	-	701+74.43	75.1	LT	290
704+75.00	99.0	LT	-	706+00.00	99.0	LT	125
706+00.00	104.0	RT	-	709+50.00	104.0	RI	350
715+21.14	133.9	RT	-	716+37.98	25.0	RT	201
721+25.00	153.0	LT	-	726+43.00 R2	30.0	LT	661
721+79.67	26.4	RT	-	726+29.00 R2	24.5	RT	555
727+50.00 R2	20.3	RT	-	734+77.81 R2	64.0	RT	833
728+43.00 R2	44.3	LT	-	730+50.00 R2	93.0	LT	275
TOTAL =							3290

20100110 - TREE REMOVAL (6 TO 15 UNIT DIAMETER)			
STATION	OFFSET	SIDE	UNIT
713+21.24	33.2	LT	10
733+87.27	34.5	LT	8
734+01.19	34.6	LT	11
734+16.98	34.0	LT	12
734+18.50	35.2	LT	12
734+35.15	34.2	LT	9
734+42.76	33.0	LT	12
734+52.18	32.8	LT	6
734+86.22	39.0	RT	9
734+98.22	34.2	LT	9
735+09.47	33.4	LT	12
735+21.33	32.2	LT	14
735+43.33	40.4	RT	6
735+50.60	33.4	LT	11
735+51.47	33.7	LT	12
735+73.20	36.2	RT	6
735+80.92	37.3	RT	8
735+82.78	36.1	RT	14
735+84.47	27.5	LT	12
735+85.73	28.5	LT	11
735+99.80	36.7	RT	10
736+09.03	38.1	RT	15
736+15.11	36.3	LT	10
736+26.98	30.8	LT	15
736+33.99	36.0	RT	10
736+40.42	37.5	RT	12
TOTAL =			276

28000250 - TEMPORARY EROSION CONTROL SEEDING					
STATION	SIDE	TO	STATION	SIDE	POUND
699+14.00	LT	-	716+69.00	LT	363
717+09.00	LT	-	724+75.00 R2	LT	236
724+62.00 R2	LT	-	726+42.00 R2	LT	24
728+44.00 R2	LT	-	736+75.00 R2	LT	100
701+14.00	RT	-	716+35.00	RT	320
722+33.00 R2	RT	-	724+27.00 R2	RT	22
724+75.00 R2	RT	-	726+16.00 R2	RT	22
727+65.00 R2	RT	-	737+50.00 R2	RT	95
TOTAL =					1182

28000315 - AGGREGATE DITCH CHECKS			
STATION	OFFSET	SIDE	TONS
702+50.00	50.0	RT	5
702+64.00	43.0	LT	5
703+75.00	47.0	RT	5
704+95.00	35.0	LT	5
705+50.00	90.0	RT	5
706+15.00	24.0	LT	5
707+50.00	87.0	RT	5
709+50.00	60.0	RT	5
711+50.00	40.0	RT	5
712+10.00	32.0	LT	5
712+23.00	31.0	RT	5
713+50.00	35.0	LT	5
714+75.00	60.0	RT	5
715+50.00	35.0	LT	5
716+38.00	26.0	LT	5
716+50.00	36.0	RT	5
717+50.00	20.0	LT	5
725+00.00 R2	51.0	RT	5
725+03.00 R2	48.0	LT	5
726+50.00 R2	61.0	RT	5
726+48.50 R2	53.0	LT	5
732+25.00 R2	58.0	RT	5
732+50.00 R2	36.0	LT	5
734+25.00 R2	27.0	RT	5
TOTAL =			120

28000500 - INLET AND PIPE PROTECTION			
STATION	OFFSET	SIDE	EACH
705+17.62	27.5	LT	1
707+33.00	53.5	LT	1
709+43.00	36.5	LT	1
714+88.75	24.5	RT	1
717+04.00	21.0	LT	1
720+31.00	15.5	LT	1
724+31.50 R2	25.3	LT	1
726+11.00 R2	32.0	LT	1
737+93.40 R2	28.0	LT	1
TOTAL =			9

X6650202 - WOVEN WIRE FENCE REMOVAL							
STATION	OFFSET	SIDE	TO	STATION	OFFSET	SIDE	FOOT
699+22.03	43.8	LT	-	716+88.60	100.0	LT	1842
702+74.41	66.0	RI	-	703+12.92	76.2	RT	40
706+39.86	40.8	RT	-	710+47.45	49.2	RT	408
711+98.42	57.5	RT	-	716+32.69	51.6	RT	450
713+40.32	135.0	LT	-	713+83.56	59.9	LT	88
717+09.30	95.0	LT	-	724+45.71 R2	102.6	LT	832
721+36.65	155.0	LT	-	723+03.96 R2	104.5	LT	176
729+35.44	91.6	LT	-	733+83.13 R2	70.0	LT	483
731+66.40 R2	95.1	LT	-	732+15.01 R2	40.2	LT	74
732+47.55 R2	97.2	RT	-	733+41.11 R2	69.2	RT	98
733+84.98 R2	65.0	RT	-	734+77.87	59.2	RT	93
TOTAL =							4584

MODEL: Schedule.tbl
 FILE: \\blufect-pw-bentley.com\P\INDOT\Documents\DOT\Office\Dir\Dir: E:\Project\0672119\CADD\DATA\CADD\Sheet\0672119\Sheet-04-Schedule.dgn

USER NAME = Michael.Wrighting	DESIGNED -	REVISED -
PLOT SCALE = 40,0000 '*/in.	DRAWN -	REVISED -
PLOT DATE = 8/23/2022	CHECKED -	REVISED -
	DATE -	REVISED -

**STATE OF ILLINOIS
DEPARTMENT OF TRANSPORTATION**

SCHEDULE OF QUANTITIES			
SCALE:	SHEET	OF SHEETS	STA. TO STA.

F.A.P. RTE. 753	SECTION 128TR	COUNTY MORGAN	TOTAL SHEETS 27	SHEET NO. 4
CONTRACT NO. 72119				
ILLINOIS FED. AID PROJECT				

EXIST. CURVE C5000
 PI STA. = 677+65.46
 $\Delta = 21^{\circ} 32' 06''$ (LT)
 D = $2^{\circ} 00' 00''$
 T = 2,864.76'
 E = 544.80'
 L = 1,076.74'
 e = 51.34'
 e = 2.90%
 T.R. = _____
 S.E. RUN = _____
 P.C. STA. = 672+20.66
 P.T. STA. = 682+97.40

EXIST. CURVE 23
 PI STA. = 716+94.46
 $\Delta = 18^{\circ} 15' 47''$ (RT)
 D = $1^{\circ} 48' 11''$
 T = 3,177.84'
 E = 510.80'
 L = 1,012.94'
 e = 40.79'
 e = 4.2%
 T.R. = _____
 S.E. RUN = _____
 P.C. STA. = 711+83.66
 P.T. STA. = 721+96.60

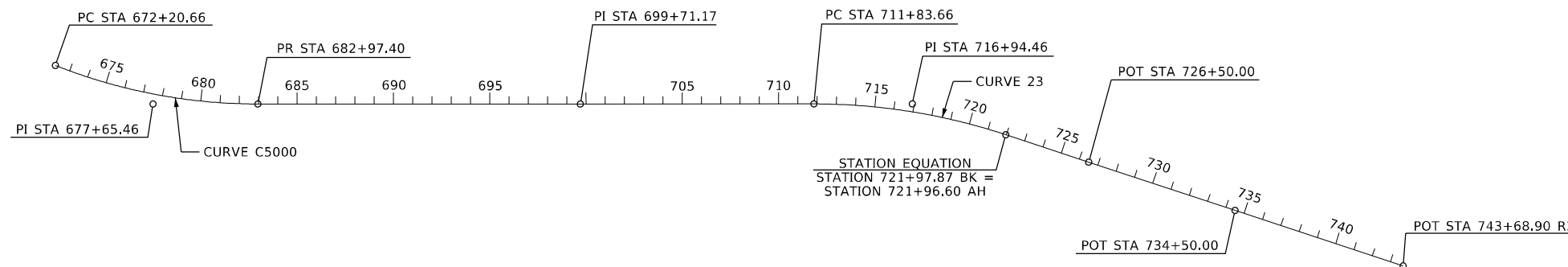

EXISTING FAP 753 (ILLINOIS 104)

SCALE: 1" = 400'

COORDINATE GEOMETRY

CENTERLINE EXISTING FAP 753 (ILLINOIS 104)									
POINT NAME	CURVE NAME	GRID COORDINATES		EASTING	DELTA	RADIUS	TANGENT	LENGTH	EXTERNAL
		STATION	NORTHING						
		PC 672+20.66	1,068,822.48	2,335,408.43					
	C5000	PI 677+65.46	1,068,405.87	2,335,759.49	21° 32' 06.15" LT	2,864.76'	544.80'	1,076.74'	51.34'
		PT 682+97.40	1,068,147.20	2,336,238.97					
		CC	1,070,668.48	2,337,599.13					
1		699+71.17	1,067,352.51	2,337,712.05					
		PC 711+83.66	1,066,777.26	2,338,779.40					
	23	PI 716+94.46	1,066,534.91	2,339,229.05	18° 15' 46.85" RT	3,177.84'	510.80'	1,012.94'	40.79'
		PT 721+96.60	1,066,163.87	2,339,580.10					
		CC	1,063,979.84	2,337,271.71					
9		726+50.00	1,065,834.52	2,339,891.71					
24		734+50.00	1,065,253.39	2,340,441.52					
22		743+68.90	1,064,585.90	2,341,073.05					

MODEL 01 - F.A.P. Alignment Centerline
 FILE NAME: p:\work\projects\104\FAP\DOT\Documents\DOT Office\Drawings\Project\0672119\FAP-05-ATB.dgn

USER NAME = Michael.Whitting	DESIGNED -	REVISED -
	DRAWN -	REVISED -
PLOT SCALE = 800,0000' / in.	CHECKED -	REVISED -
PLOT DATE = 8/23/2022	DATE -	REVISED -

**STATE OF ILLINOIS
DEPARTMENT OF TRANSPORTATION**

EXISTING ALIGNMENTS COORDINATE GEOMETRY

SCALE: 1" = 400' SHEET OF SHEETS STA. TO STA.

F.A.P. RTE.	SECTION	COUNTY	TOTAL SHEETS	SHEET NO.
753	126TR	MORGAN	27	5
CONTRACT NO. 72119			ILLINOIS FED. AID PROJECT	

FOR INFORMATIONAL PURPOSE ONLY

EXIST. CURVE C5000
 PI STA. = 677+65.46
 $\Delta = 21^\circ 32' 06''$ (LT)
 D = 2° 00' 00"
 R = 2,864.76'
 T = 544.80'
 L = 1,076.74'
 E = 51.34'
 e = 2.90%
 T.R. = _____
 S.E. RUN = _____
 P.C. STA. = 672+20.66
 P.T. STA. = 682+97.40



PROP. CURVE C1000
 PI STA. = 716+94.46
 $\Delta = 18^\circ 15' 47''$ (RT)
 D = 2° 06' 51"
 R = 2,710.00'
 T = 435.60'
 L = 863.81'
 E = 34.79'
 e = 4.6%
 T.R. = 40.11'
 S.E. RUN = 123.00'
 P.C. STA. = 712+58.86
 P.T. STA. = 721+22.67

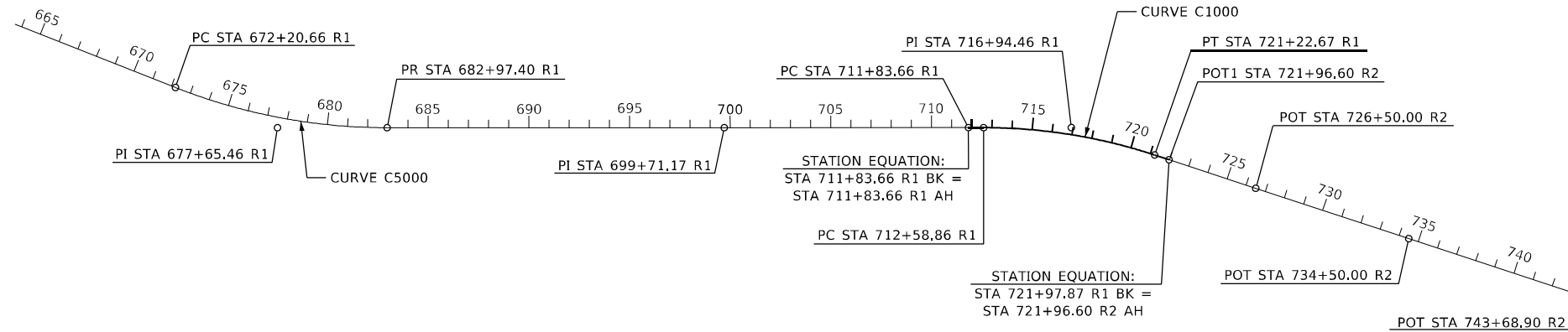

PROPOSED ALIGNMENT SHIFT FAP 753 (ILLINOIS 104)
 SCALE: 1" = 400'

COORDINATE GEOMETRY

PROPOSED ALIGNMENT SHIFT FAP 753 (ILLINOIS 104)									
POINT NAME	CURVE NAME	GRID COORDINATES		EASTING	DELTA	RADIUS	TANGENT	LENGTH	EXTERNAL
		STATION	NORTHING						
		PC 672+20.66	1,068,822.48	2,335,408.43					
	C5000	PI 677+65.46	1,068,405.87	2,335,759.49	21° 32' 06.15" LT	2,864.76'	544.80'	1,076.74'	51.34'
		PT 682+97.40	1,068,147.20	2,336,238.97					
		CC	1,070,668.48	2,337,599.13					
1		699+71.17	1,067,352.51	2,337,712.05					
POT1000		711+83.66	1,066,777.26	2,338,779.39					
		PC 712+58.86	1,066,741.58	2,338,845.59					
	C1000	PI 716+94.46	1,066,534.91	2,339,229.05	18° 15' 46.85" RT	2,710.00'	435.60'	863.81'	34.79'
		PT 721+22.67	1,066,218.49	2,339,528.42					
		CC	1,066,163.87	2,337,559.86					
EQ1001		721+96.60	1,064,356.00	2,339,580.10					
9		726+50.00	1,065,834.52	2,339,891.71					
24		734+50.00	1,065,253.39	2,340,441.52					
22		743+68.90	1,064,585.90	2,341,073.05					

MODEL 03 P. Alignment Centerline
 FILE NAME: p:\illinois\104\FAP753\DOT\Documents\DOT\Office\Drawings\Project\0672119\align-05-ATB.dgn



USER NAME = MichaelWhitting	DESIGNED -	REVISED -	
	DRAWN -	REVISED -	
PLOT SCALE = 800,0000' / in.	CHECKED -	REVISED -	
PLOT DATE = 8/23/2022	DATE -	REVISED -	

**STATE OF ILLINOIS
 DEPARTMENT OF TRANSPORTATION**

PROPOSED ALIGNMENTS COORDINATE GEOMETRY

SCALE: 1" = 400' SHEET OF SHEETS STA. TO STA.

F.A.P. RTE.	SECTION	COUNTY	TOTAL SHEETS	SHEET NO.
753	128TR	MORGAN	27	6
CONTRACT NO. 72119				
ILLINOIS FED. AID PROJECT				



REMOVAL LEGEND	
	TREE REMOVAL ACRE
	TREE REMOVAL
	REMOVAL ITEM

NOTES

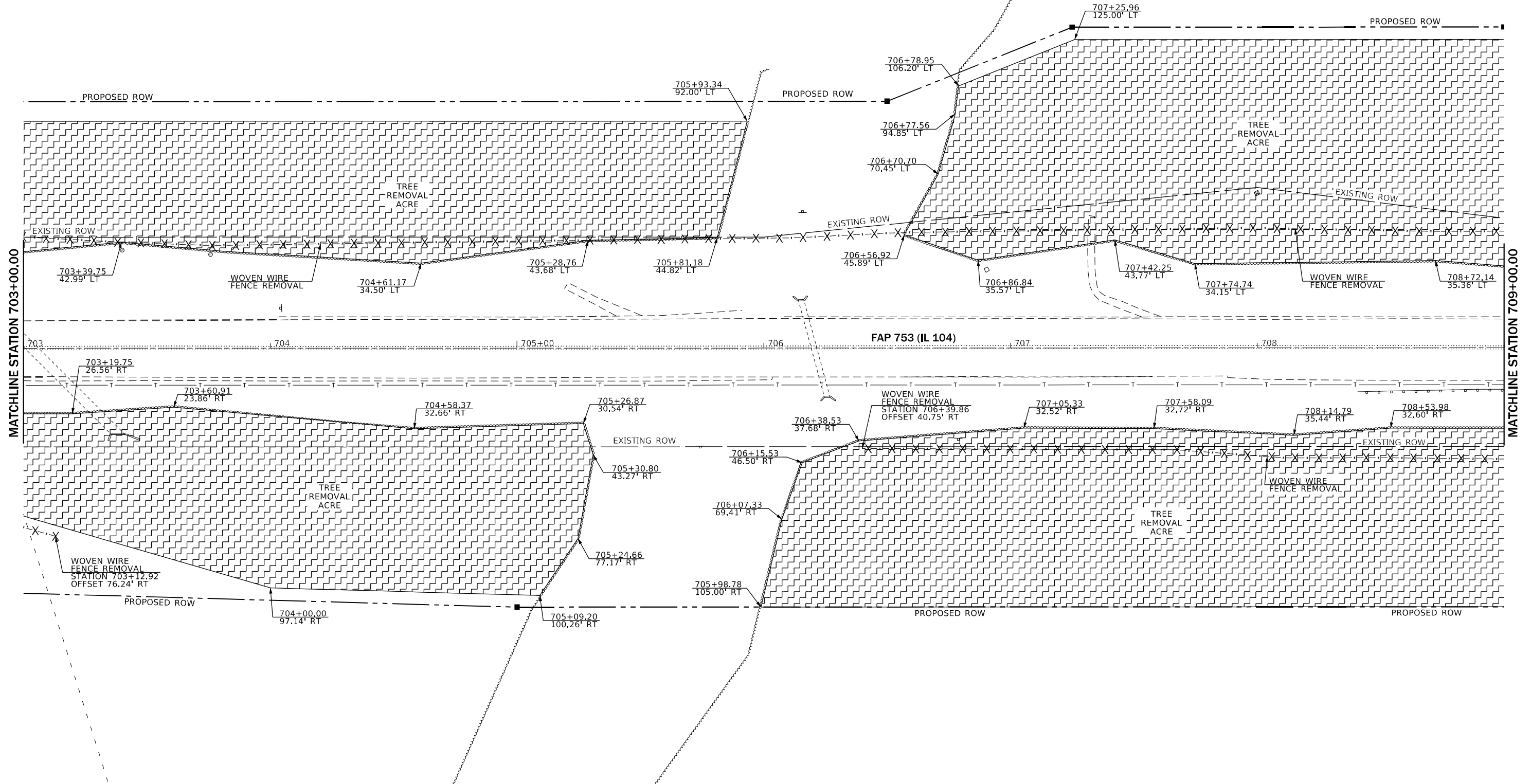
1. SEE GENERAL NOTES SHEET FOR TREE COMMITMENTS.



FILE NAME =	USER NAME = Michael Whitting	DESIGNED -	REVISED -	STATE OF ILLINOIS DEPARTMENT OF TRANSPORTATION	REMOVAL PLAN			F.A.P. RTE.	SECTION	COUNTY	TOTAL SHEETS	SHEET NO.
pwz\illdoi-pw.bentley.com\PWIDOT\Documents\100\Projects\District_6\Projects\672119\CADData\CADsheets\DRW\Sheet-06-removal.dgn	PLOT SCALE = 40,0000' / in.	CHECKED -	REVISED -					753	126TR	MORGAN	27	8
Removal Sheet 02	PLOT DATE = 8/23/2022	DATE -	REVISED -		SCALE: SHEET OF SHEETS STA. TO STA.			ILLINOIS FED. AID PROJECT				
CONTRACT NO. 72119												

REMOVAL LEGEND	
	TREE REMOVAL ACRE
	TREE REMOVAL
	REMOVAL ITEM

NOTES

1. SEE GENERAL NOTES SHEET FOR TREE COMMITMENTS.

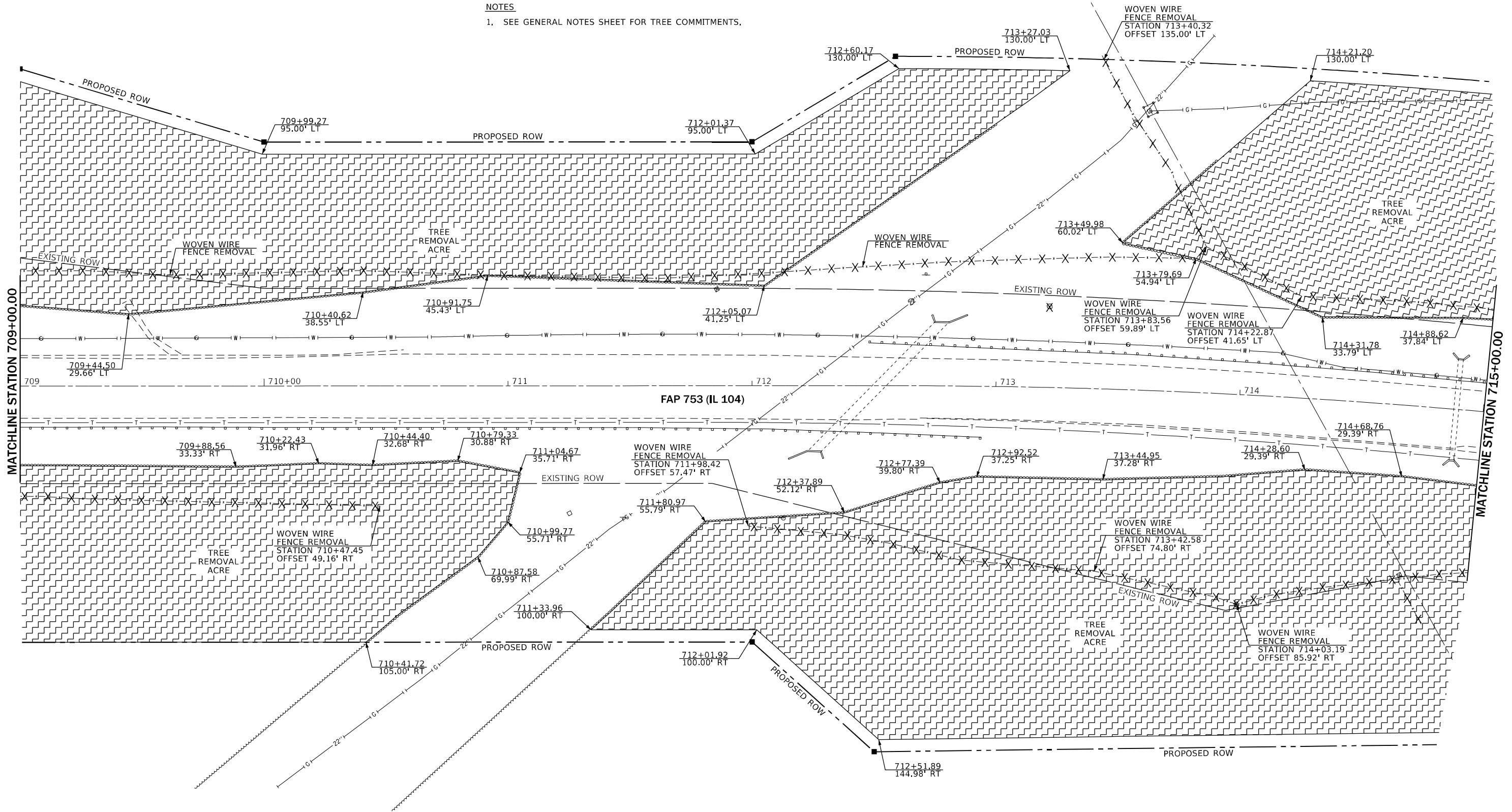

FILE NAME =	USER NAME = Michael.Whitting	DESIGNED -	REVISED -	STATE OF ILLINOIS DEPARTMENT OF TRANSPORTATION	REMOVAL PLAN			F.A.P. RTE.	SECTION	COUNTY	TOTAL SHEETS	SHEET NO.
pwz\idoc-pw.bentley.com:PWIDOT\Documents\100\Projects\District_6\Projects\672119\CADData\CADsheets\Drawn\ht-06-removal.dgn	DRAWN -	REVISOR -	REVISED -					753	128TR	MORGAN	27	9
Remove Sheet 03	PLOT SCALE = 40,0000' / in.	CHECKED -	REVISED -		SCALE: SHEET OF SHEETS STA. TO STA.			CONTRACT NO. 72119				
	PLOT DATE = 8/23/2022	DATE -	REVISED -					ILLINOIS FED. AID PROJECT				

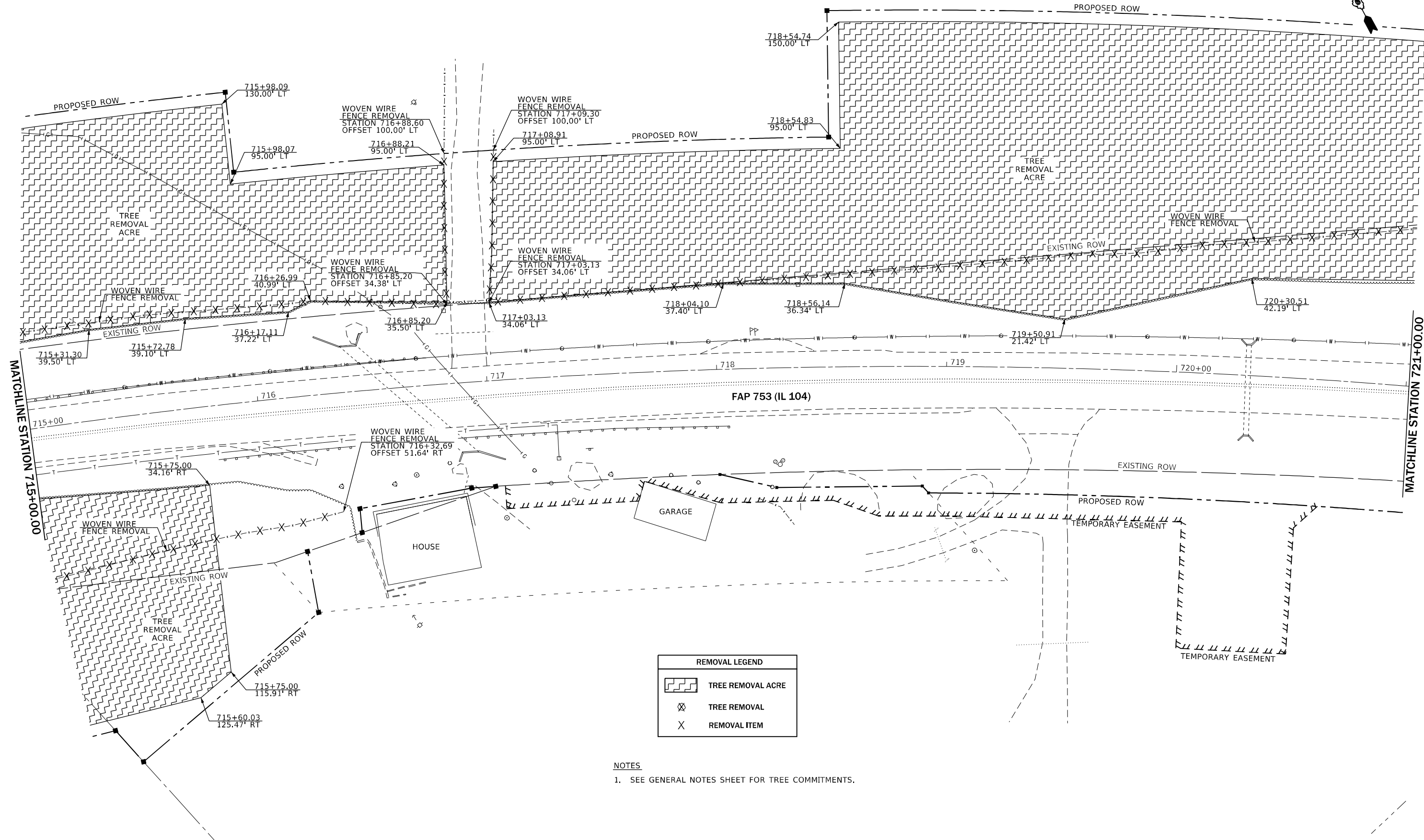
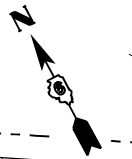

REMOVAL LEGEND	
	TREE REMOVAL ACRE
	TREE REMOVAL
	REMOVAL ITEM

NOTES
 1. SEE GENERAL NOTES SHEET FOR TREE COMMITMENTS.

FILE NAME =	USER NAME = Michael.Whitting	DESIGNED -	REVISED -	STATE OF ILLINOIS DEPARTMENT OF TRANSPORTATION	REMOVAL PLAN			F.A.P. RTE.	SECTION	COUNTY	TOTAL SHEETS	SHEET NO.
pwz\idoc-pw.bentley.com:PWIDOT\Documents\SDO\Projects\District_6\Projects\672119\CADDData\CAD\sheet-06-removal.dgn	DRAWN -	REVISIONS -	753					128TR	MORGAN	27	10	
Remove Sheet 04	PLOT SCALE = 40,0000 * / in.	CHECKED -	REVISIONS -		CONTRACT NO. 72119			ILLINOIS FED. AID PROJECT				
	PLOT DATE = 8/23/2022	DATE -	REVISIONS -		SCALE:	SHEET	OF	SHEETS	STA.	TO	STA.	

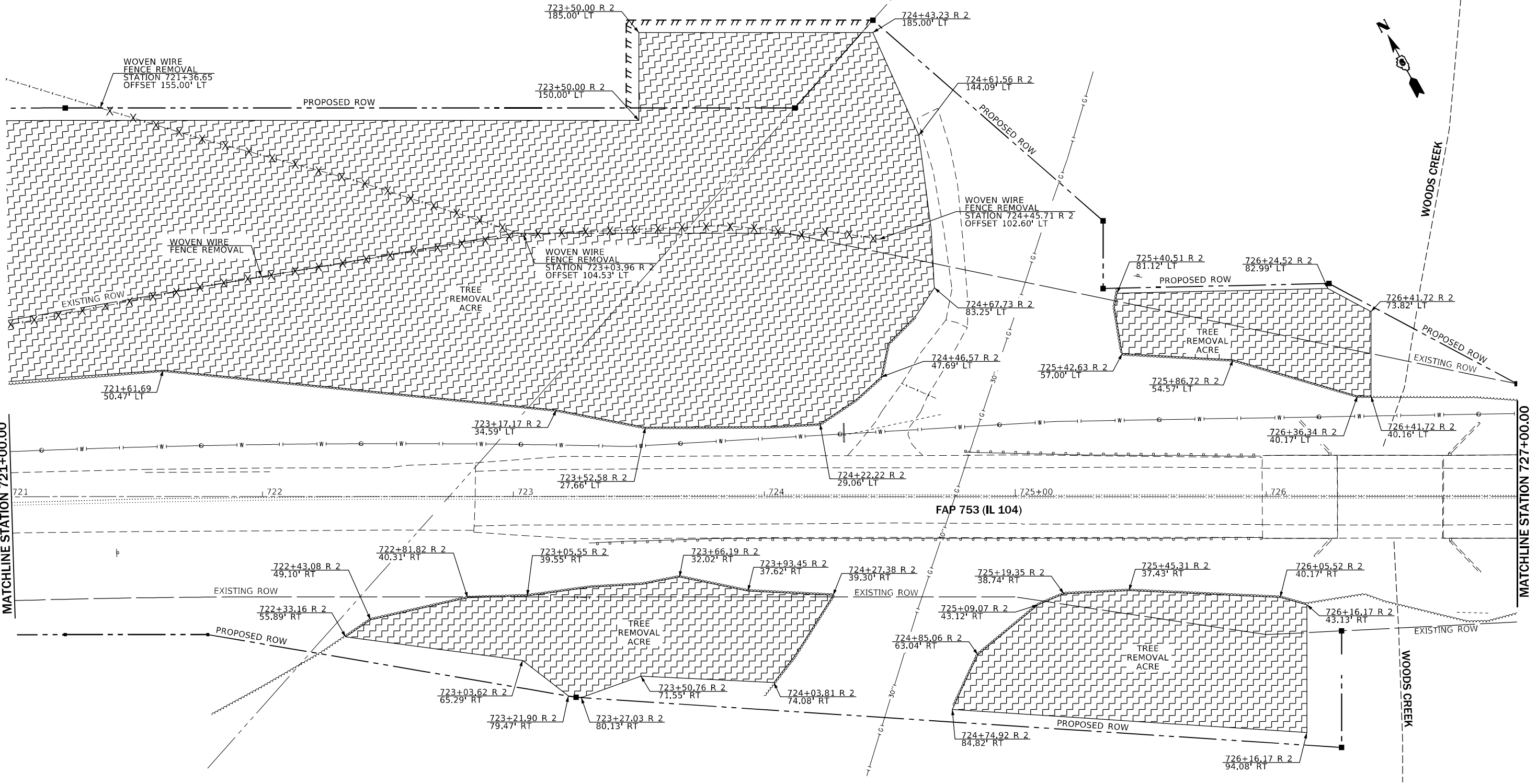

REMOVAL LEGEND	
	TREE REMOVAL ACRE
	TREE REMOVAL
	REMOVAL ITEM

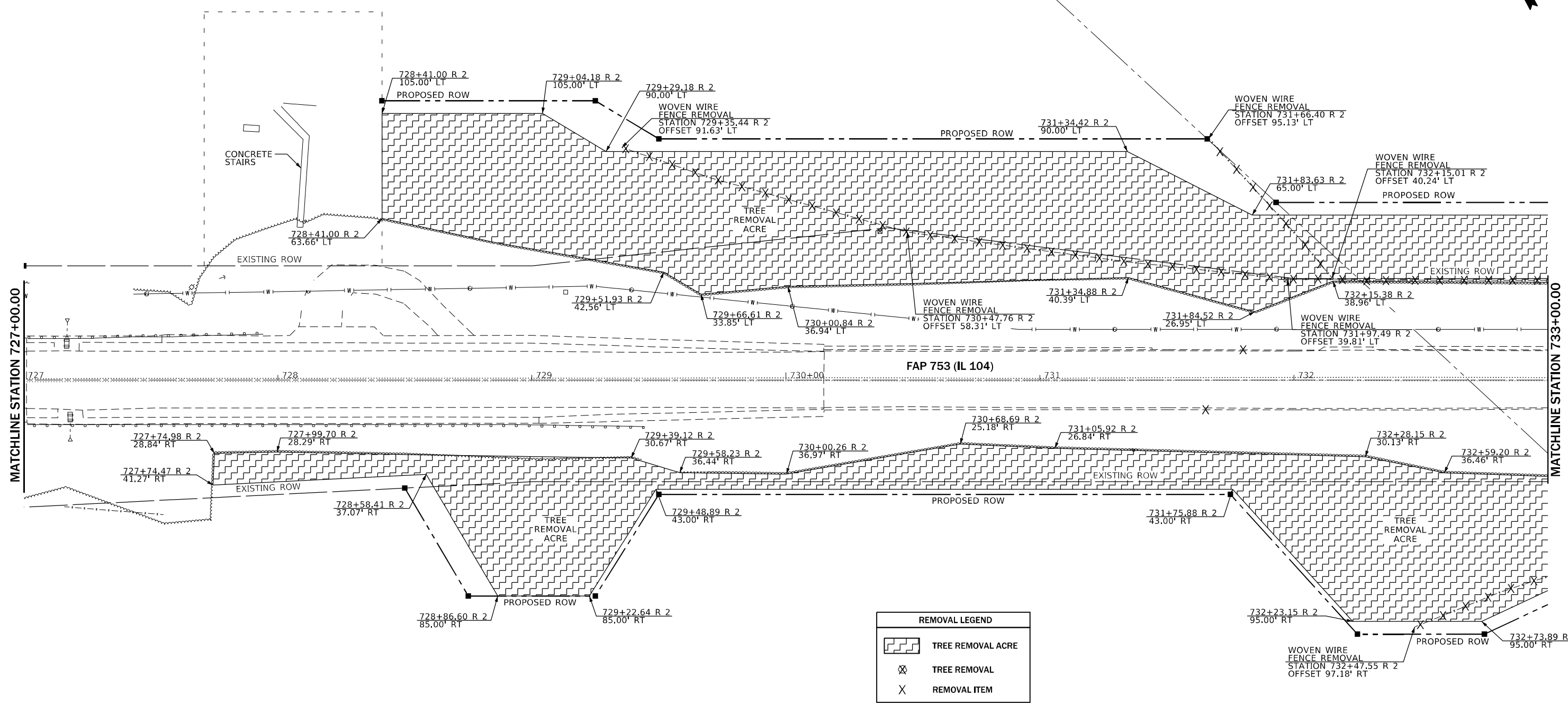
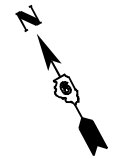

NOTES
 1. SEE GENERAL NOTES SHEET FOR TREE COMMITMENTS.

FILE NAME =	USER NAME = Michael Whitting	DESIGNED -	REVISED -	STATE OF ILLINOIS DEPARTMENT OF TRANSPORTATION	REMOVAL PLAN				F.A.P. RTE.	SECTION	COUNTY	TOTAL SHEETS	SHEET NO.
pwz\ldo-pw-bentley.com\PWIDOT\Documents\IDOT\Offices\District_6\Projects\D672119\CADData\CADsheets\DRW\Sheet-06-removal.dgn		CHECKED -	REVISED -		753	128TR	MORGAN	27	11				
PLOT SCALE = 40,0000' / in.		DATE -	REVISED -		CONTRACT NO. 72119								
Removal Sheet 05					SCALE:	SHEET	OF	SHEETS	STA.	TO	STA.	ILLINOIS	FED. AID PROJECT



NOTES
 1. SEE GENERAL NOTES SHEET FOR TREE COMMITMENTS.

FILE NAME =	USER NAME = Michael Whitting	DESIGNED -	REVISED -	STATE OF ILLINOIS DEPARTMENT OF TRANSPORTATION	REMOVAL PLAN			F.A.P. RTE.	SECTION	COUNTY	TOTAL SHEETS	SHEET NO.
pwz\idoc-pw.bentley.com\PWIDOT\Documents\IDOC\Projects\District_6\Projects\D672119\CADData\CADsheets\Drawn\ht-06-removal.dgn	DRAWN	REVISD -	REVISD -					753	128TR	MORGAN	27	12
Remove Sheet 06	PLOT SCALE = 40,0000 * / in.	CHECKED -	REVISD -		SCALE: SHEET OF SHEETS STA. TO STA.			CONTRACT NO. 72119				
	PLOT DATE = 8/23/2022	DATE -	REVISD -		ILLINOIS FED. AID PROJECT							

REMOVAL LEGEND	
	TREE REMOVAL ACRE
	TREE REMOVAL
	REMOVAL ITEM



NOTES
 1. SEE GENERAL NOTES SHEET FOR TREE COMMITMENTS.

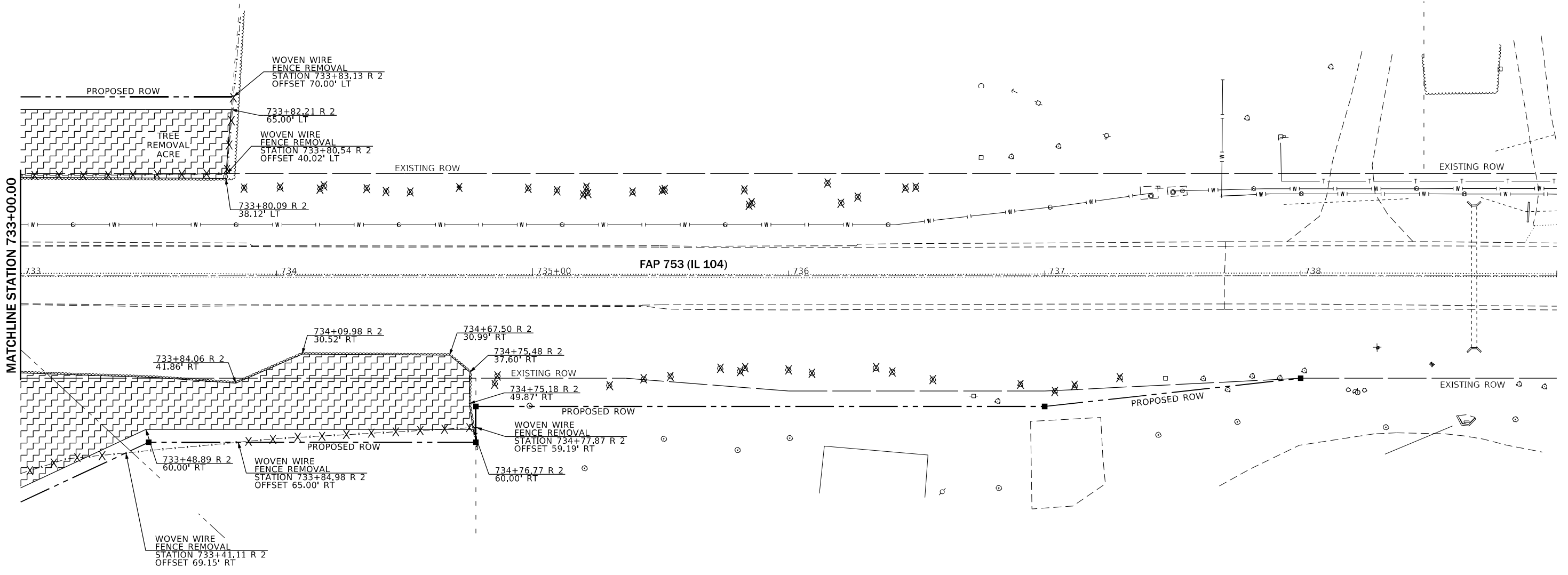

FILE NAME =	USER NAME = Michael Whitting	DESIGNED -	REVISED -	STATE OF ILLINOIS DEPARTMENT OF TRANSPORTATION	REMOVAL PLAN			F.A.P. RTE.	SECTION	COUNTY	TOTAL SHEETS	SHEET NO.
pwz\idoc-pw.bentley.com:PWIDOT\Documents\100\Projects\District_6\Projects\672119\CADD\CAD\Sheet-06-removal.dgn	DRAWN -	REVISED -	753					126TR	MORGAN	27	13	
Remove Sheet 07	PLOT SCALE = 40,0000 * / in.	CHECKED -	REVISED -		SCALE: SHEET OF SHEETS STA. TO STA.			CONTRACT NO. 72119				
	PLOT DATE = 8/23/2022	DATE -	REVISED -		ILLINOIS FED. AID PROJECT							

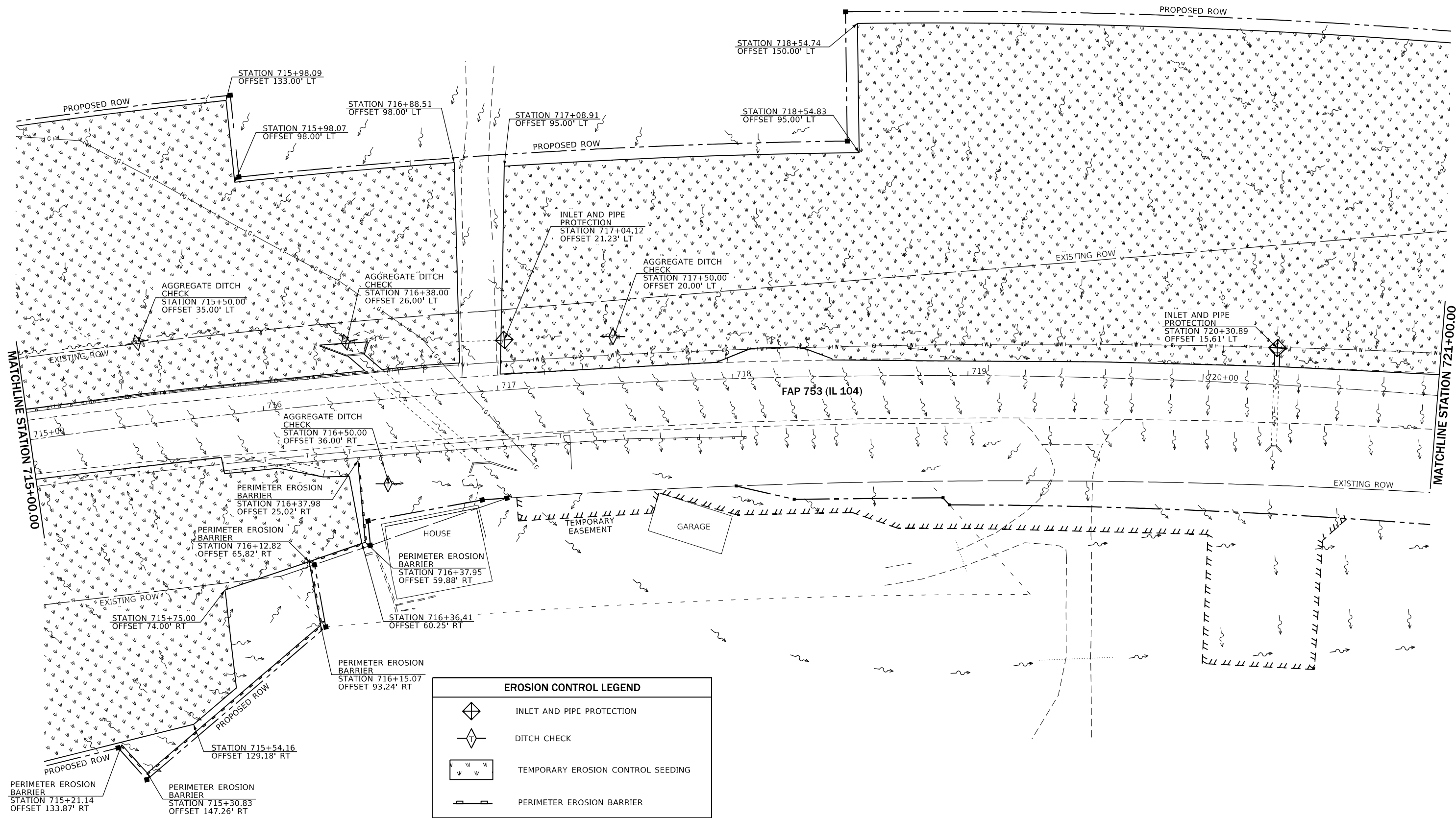

EROSION CONTROL LEGEND	
	INLET AND PIPE PROTECTION
	DITCH CHECK
	TEMPORARY EROSION CONTROL SEEDING
	PERIMETER EROSION BARRIER

MODEL: Erosion Control Sheet 04
 FILE NAME: P:\Public\Projects\753\753_128TR\Documents\DOT\Office\Drawings\753_128TR\753_128TR_07_ErosionControl.dgn

USER NAME = Michael.Wright	DESIGNED -	REVISED -
PLOT SCALE = 40,0000 * / in.	DRAWN -	REVISED -
PLOT DATE = 8/23/2022	CHECKED -	REVISED -
	DATE -	REVISED -

**STATE OF ILLINOIS
DEPARTMENT OF TRANSPORTATION**

SCALE: 1" = 20'		SHEET	OF	SHEETS	STA.	TO	STA.
-----------------	--	-------	----	--------	------	----	------

EROSION CONTROL

F.A.P. RTE.	SECTION	COUNTY	TOTAL SHEETS	SHEET NO.
753	128TR	MORGAN	27	17
CONTRACT NO. 72119				
ILLINOIS FED. AID PROJECT				

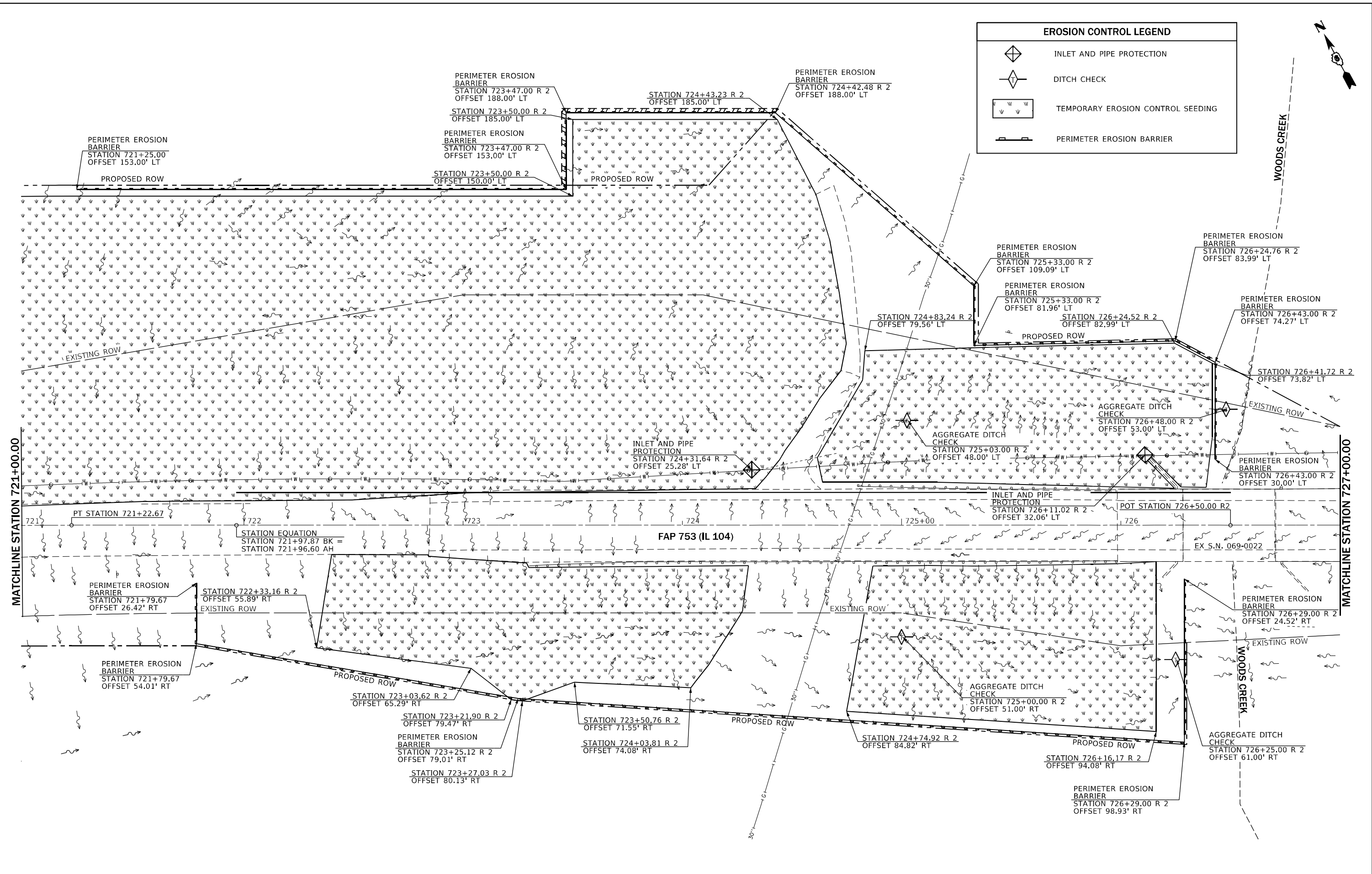
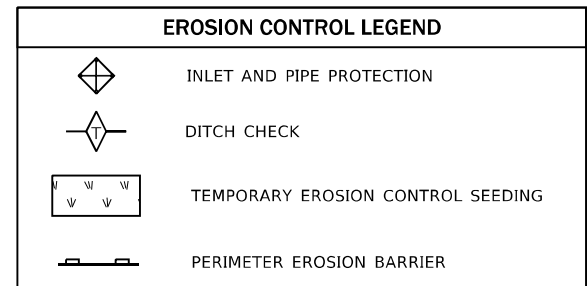

MODEL: Erosion Control Sheet 05
 FILE NAME: P:\Public\Projects\72119\CADD\Drawings\72119\72119-07-ErosionControl.dgn

USER NAME = MichaelWhitting	DESIGNED -	REVISED -
PLOT SCALE = 40,0000 * / in.	DRAWN -	REVISED -
PLOT DATE = 8/23/2022	CHECKED -	REVISED -
	DATE -	REVISED -

**STATE OF ILLINOIS
DEPARTMENT OF TRANSPORTATION**

EROSION CONTROL	
SCALE: 1" = 20'	SHEET OF SHEETS STA. TO STA.

F.A.P. RTE.	SECTION	COUNTY	TOTAL SHEETS	SHEET NO.
753	128TR	MORGAN	27	18
CONTRACT NO. 72119				
ILLINOIS FED. AID PROJECT				

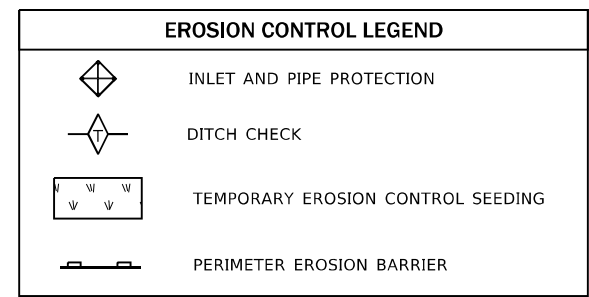
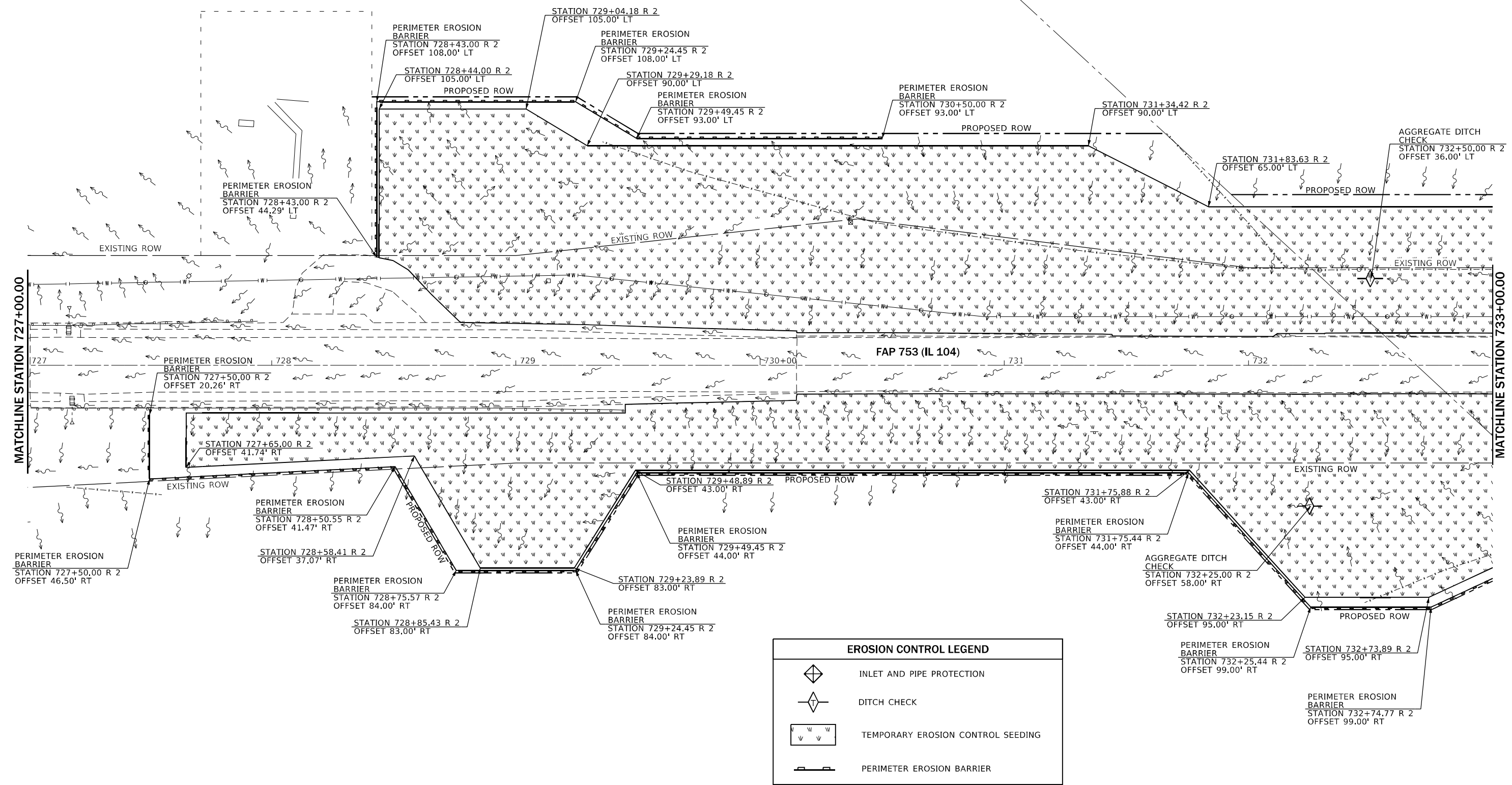
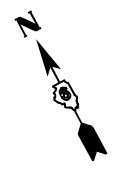

MODEL: Erosion Control Sheet 06
 FILE NAME: public\p12\p12\p12\DOT\Documents\DOT\Office\Dir\erfc\erfc07-ErosionControl.dgn

USER NAME = Michael.Wittling	DESIGNED -	REVISED -
	DRAWN -	REVISED -
PLOT SCALE = 40,0000' / in.	CHECKED -	REVISED -
PLOT DATE = 8/23/2022	DATE -	REVISED -

STATE OF ILLINOIS
DEPARTMENT OF TRANSPORTATION

EROSION CONTROL			
SCALE: 1" = 20'	SHEET	OF SHEETS	STA. TO STA.

F.A.P. RTE.	SECTION	COUNTY	TOTAL SHEETS	SHEET NO.
753	128TR	MORGAN	27	19
ILLINOIS FED. AID PROJECT			CONTRACT NO. 72119	



EROSION CONTROL LEGEND	
	INLET AND PIPE PROTECTION
	TEMPORARY DITCH CHECK
	TEMPORARY EROSION CONTROL SEEDING
	PERIMETER EROSION BARRIER

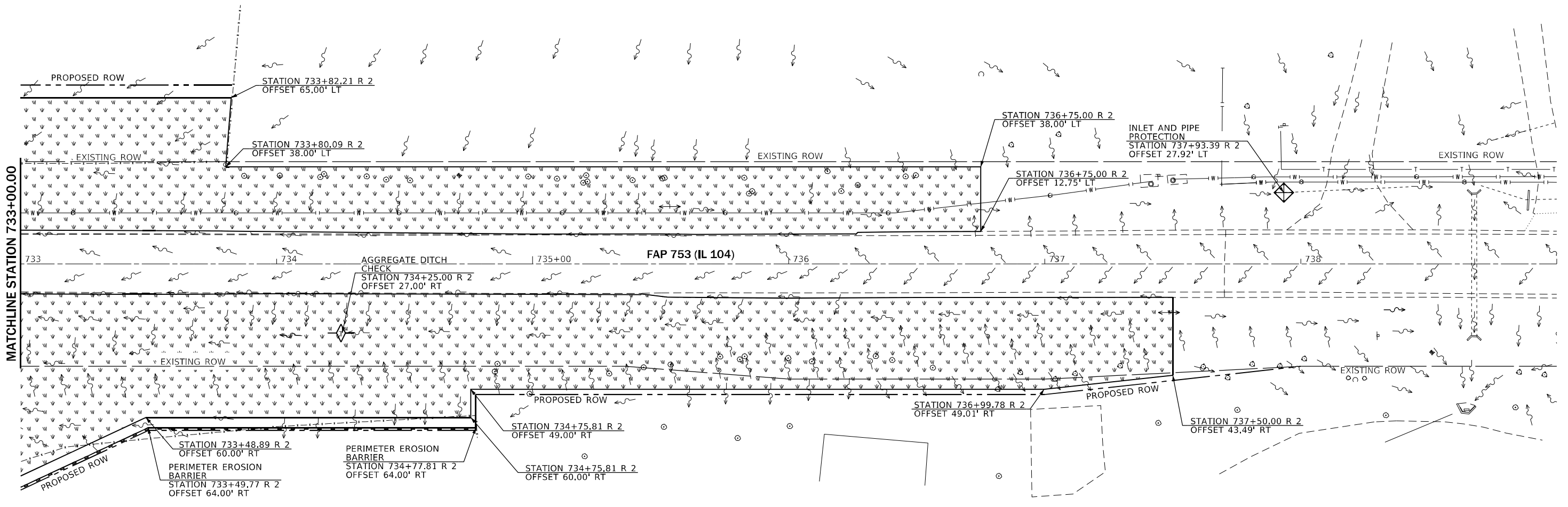

MODEL: Erosion Control Sheet 07
 FILE NAME: P:\Public\Projects\753\753_07_ErosionControl.dgn
 PROJECT: 753\753_07_ErosionControl.dgn
 DATE: 8/23/2022

USER NAME = Michael.Whitting	DESIGNED -	REVISED -
PLOT SCALE = 40,0000 * / in.	DRAWN -	REVISED -
PLOT DATE = 8/23/2022	CHECKED -	REVISED -
	DATE -	REVISED -

**STATE OF ILLINOIS
DEPARTMENT OF TRANSPORTATION**

EROSION CONTROL	
SCALE: 1" = 20'	SHEET OF SHEETS STA. TO STA.

F.A.P. RTE.	SECTION	COUNTY	TOTAL SHEETS	SHEET NO.
753	128TR	MORGAN	27	20
CONTRACT NO. 72119				
ILLINOIS FED. AID PROJECT				

FOR INFORMATIONAL PURUPOSE ONLY

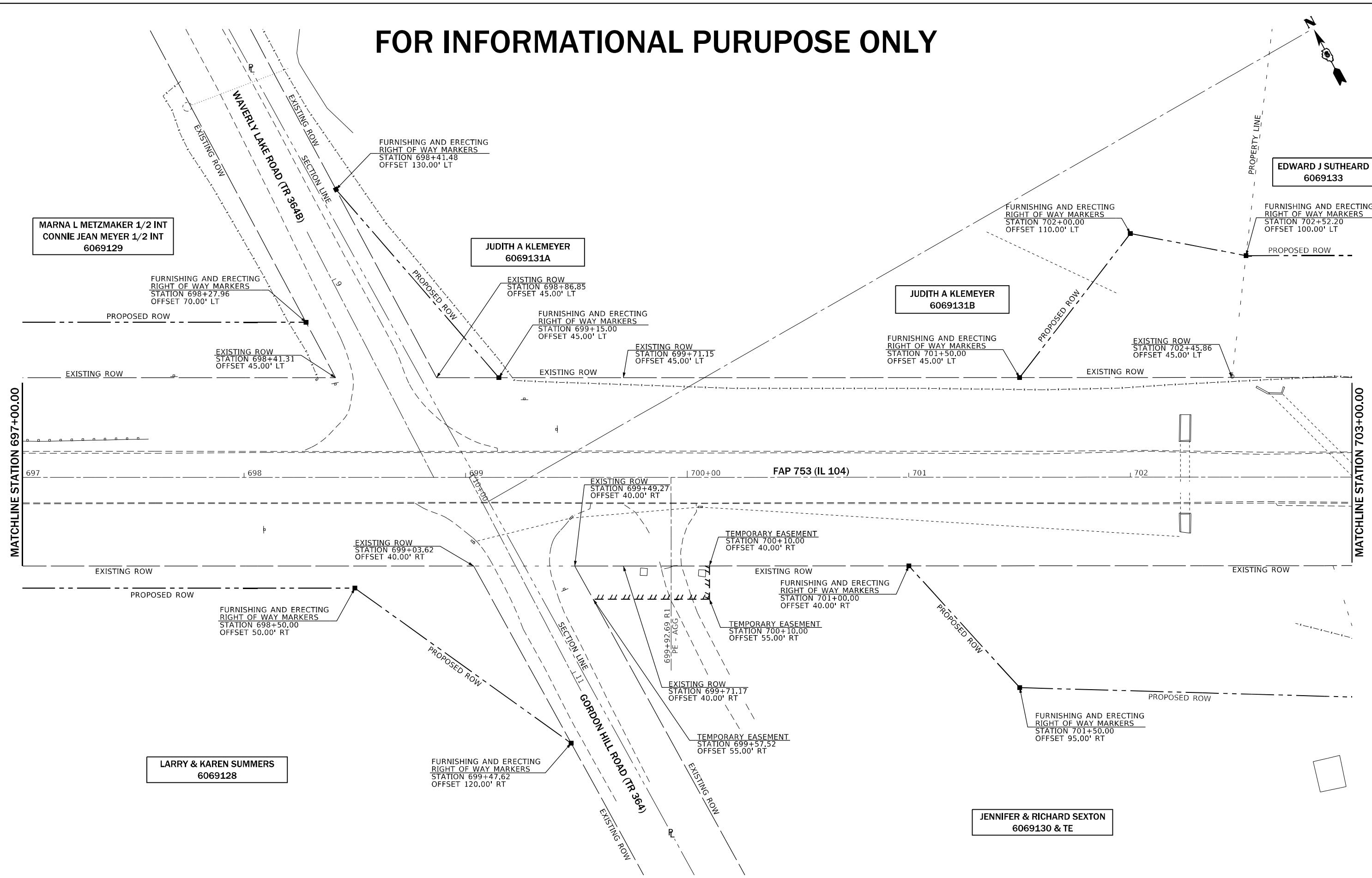

MODEL: ROW Sheet 01
 FILE NAME: p:\illinois\bea\paw.com\p\illinois\Documents\DOT\Office\Dir\dir: E:\Project\0672119\CADD\data\CD\Reest\0672119\sh-08-rov.dgn

USER NAME = Michael Whitting	DESIGNED -	REVISED -
DRAWN -	REVISED -	
PLOT SCALE = 40,0000' / in.	CHECKED -	REVISED -
PLOT DATE = 8/23/2022	DATE -	REVISED -

STATE OF ILLINOIS
DEPARTMENT OF TRANSPORTATION

SCALE: 1" = 20' SHEET OF SHEETS STA. 697+00.00 TO STA. 703+00.00		RIGHT OF WAY FAP 753 (IL 104)	
		F.A.P. RTE. 753	SECTION 128TR

COUNTY MORGAN	TOTAL SHEETS 27	SHEET NO. 21
CONTRACT NO. 72119		
ILLINOIS	FED. AID PROJECT	STP-NDFU(489)

FOR INFORMATIONAL PURUPOSE ONLY



FURNISHING AND ERECTING
RIGHT OF WAY MARKERS
STATION 707+25.00
OFFSET 130.00' LT

FURNISHING AND ERECTING
RIGHT OF WAY MARKERS
STATION 709+00.00
OFFSET 130.00' LT

EDWARD J SUTHEARD
6069133

FURNISHING AND ERECTING
RIGHT OF WAY MARKERS
STATION 706+50.00
OFFSET 100.00' LT

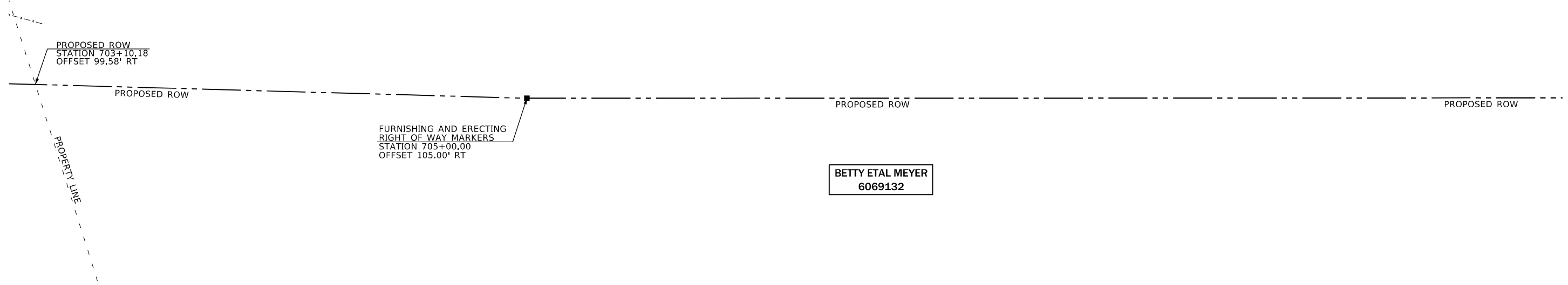
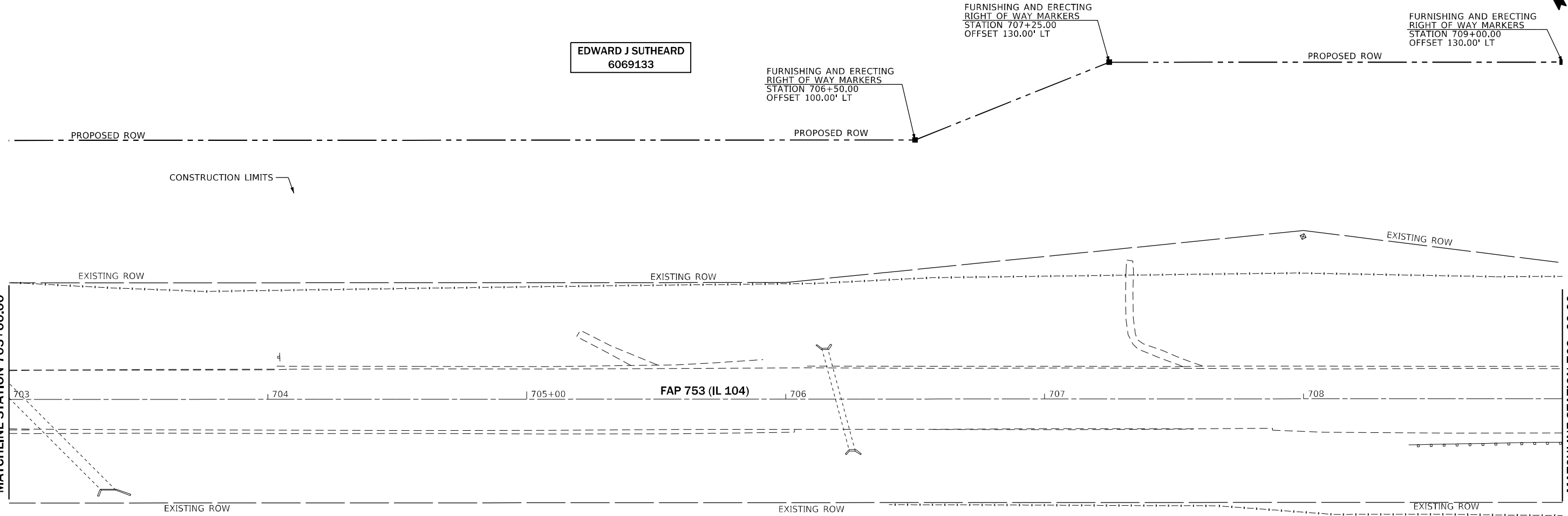

PROPOSED ROW
STATION 703+10.18
OFFSET 99.58' RT

FURNISHING AND ERECTING
RIGHT OF WAY MARKERS
STATION 705+00.00
OFFSET 105.00' RT

BETTY ETAL MEYER
6069132

JENNIFER & RICHARD SEXTON
6069130

MODEL: R/WY Sheet 02
FILE NAME: p:\pub\scpx\benfay.com\PIV\DOT\Documents\DOT Office\Dir\dr_6\Project\0672119\CADD\DATA\CAD\Sheet\0672119\sh-08-rw.cgm

USER NAME = Michael.Whitting	DESIGNED -	REVISED -
DRAWN -	REVISIED -	
PLOT SCALE = 40,0000 * / in.	CHECKED -	REVISIED -
PLOT DATE = 8/23/2022	DATE -	REVISIED -

STATE OF ILLINOIS
DEPARTMENT OF TRANSPORTATION

RIGHT OF WAY
FAP 753 (IL 104)

SCALE: 1" = 20' SHEET OF SHEETS STA. 703+00.00 TO STA. 709+00.00

F.A.P. RTE.	SECTION	COUNTY	TOTAL SHEETS	SHEET NO.
753	128TR	MORGAN	27	22
CONTRACT NO. 72119				
ILLINOIS FED. AID PROJECT STP-NDFU(489)				

FOR INFORMATIONAL PURUPOSE ONLY

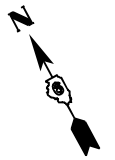

EDWARD J SUTHEARD
6069133

FURNISHING AND ERECTING
RIGHT OF WAY MARKERS
STATION 712+58.86
OFFSET 135.00' LT

MICHAEL T LOWDER
6069135 & TE

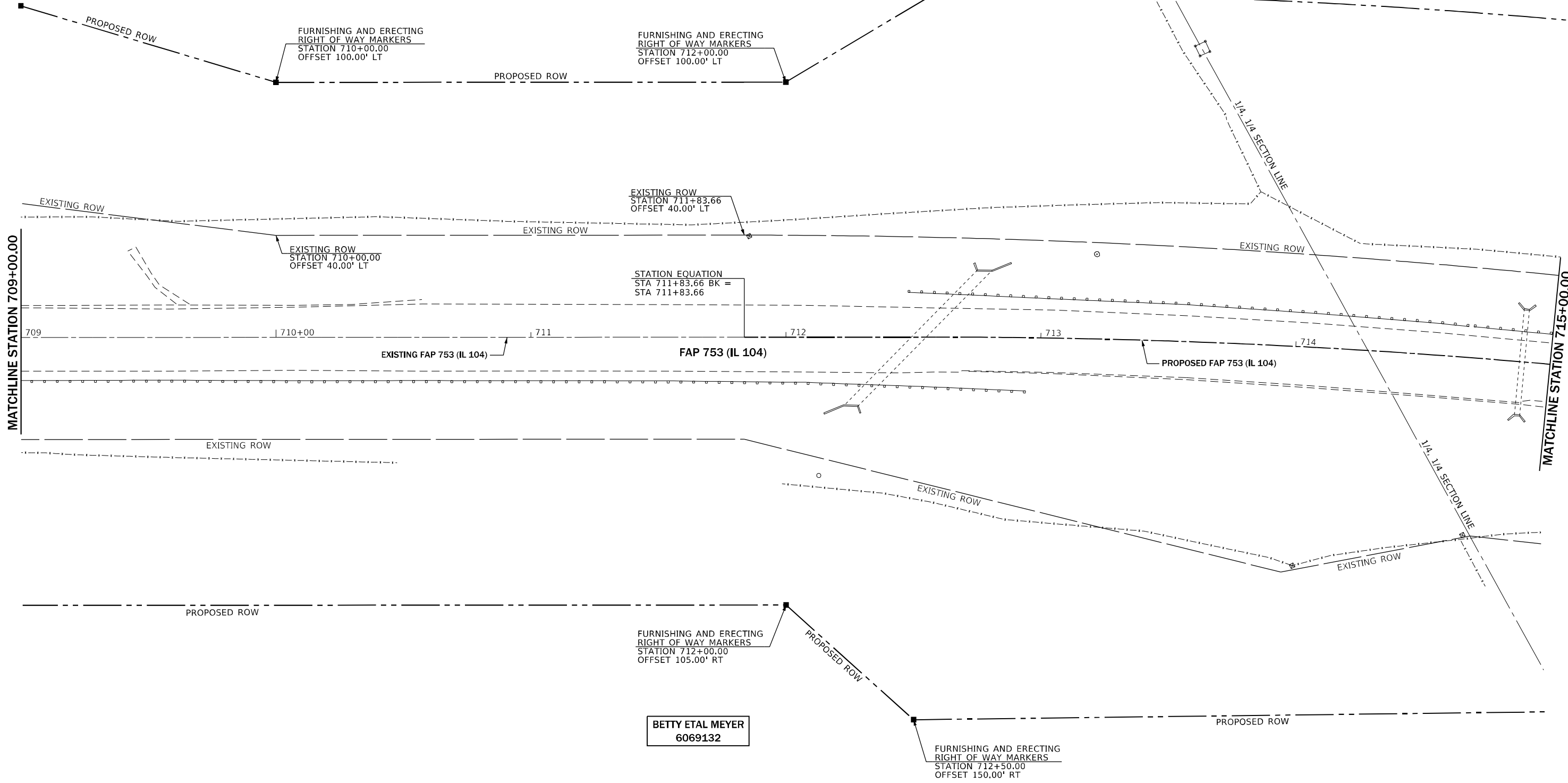

MODEL ROW Sheet 03
FILE NAME: p:\w\l\c\paw\betty_meyer.com\PI\DOT\Documents\DOT_Offices\Dir\dr_6\Project\0672119\CADD\data\CADD\sheet\0672119\sh-08-rov.cgm

USER NAME = MichaelWhitting	DESIGNED -	REVISED -
DRAWN -	REVISED -	
PLOT SCALE = 40,0000 * / in.	CHECKED -	REVISED -
PLOT DATE = 8/23/2022	DATE -	REVISED -

**STATE OF ILLINOIS
DEPARTMENT OF TRANSPORTATION**

**RIGHT OF WAY
FAP 753 (IL 104)**

SCALE: 1" = 20' SHEET OF SHEETS STA. 709+00.00 TO STA. 715+00.00

F.A.P. RTE.	SECTION	COUNTY	TOTAL SHEETS	SHEET NO.
753	128TR	MORGAN	27	23
CONTRACT NO. 72119				
ILLINOIS FED. AID PROJECT STP-NDFU(489)				

FOR INFORMATIONAL PURUPOSE ONLY

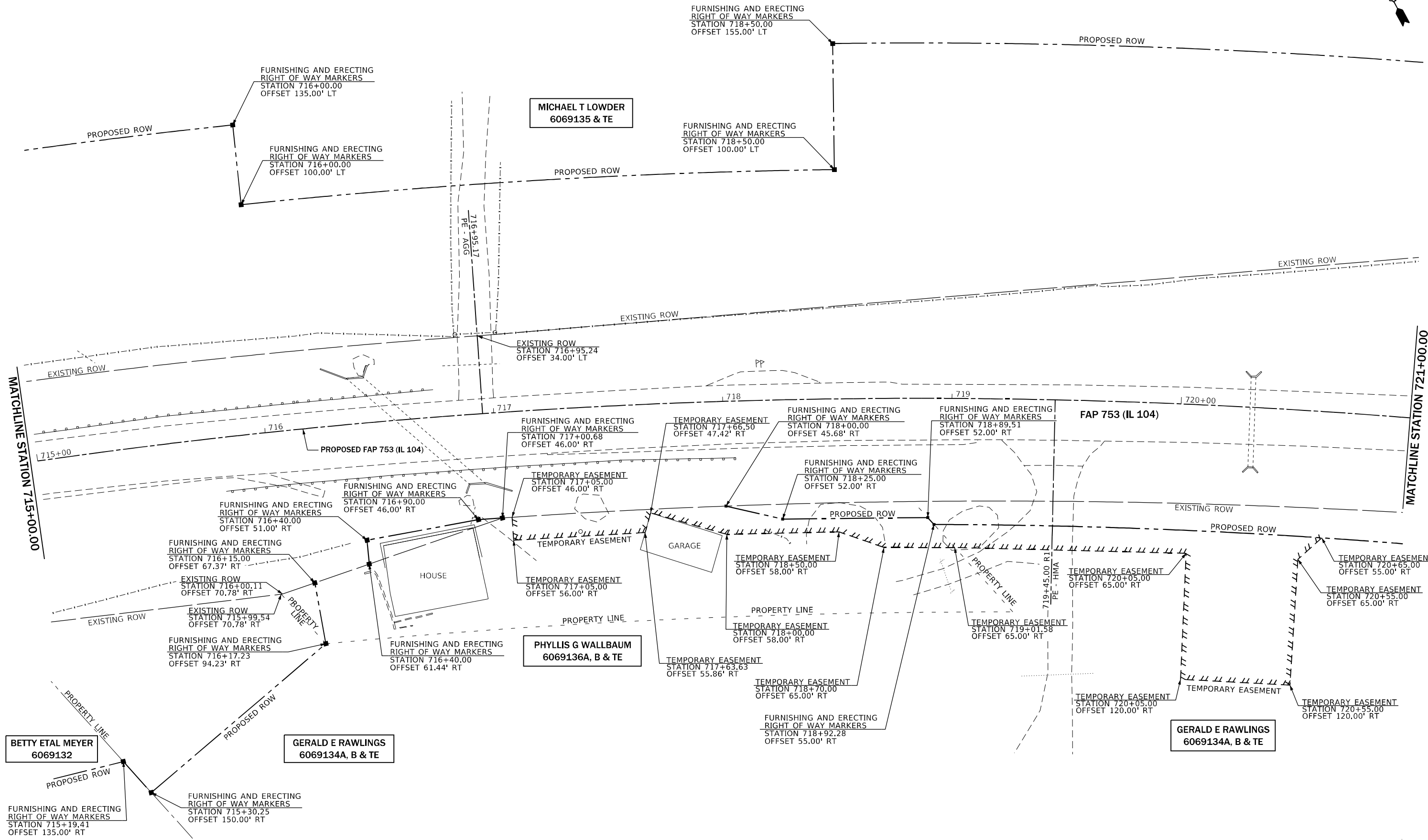

MODEL ROW Sheet 04
 FILE NAME: p:\public\paw_betty.com\p\INDOT\Documents\DOT_Offset\Dir\dir_6069132\1924h-08-rov.dwg
 PROJECT: 6069132\1924h-08-rov.dwg

USER NAME = Michael.Writing DRAWN - PLOT SCALE = 40,0000 * 1/ in. PLOT DATE = 8/23/2022	DESIGNED - CHECKED - DATE -	REVISED - REVISED - REVISED - REVISED -	STATE OF ILLINOIS DEPARTMENT OF TRANSPORTATION	RIGHT OF WAY FAP 753 (IL 104)	SCALE: 1" = 20' SHEET OF SHEETS STA. 715+00.00 TO STA. 721+00.00	F.A.P. RTE. 753 SECTION 128TR COUNTY MORGAN TOTAL SHEETS 27 SHEET NO. 24 CONTRACT NO. 72119 ILLINOIS FED. AID PROJECT STP-NDFU(489)
--	-----------------------------------	--	---	--	--	---

FOR INFORMATIONAL PURUPOSE ONLY

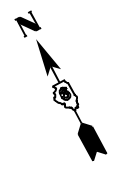

- NOTE:
1. CITY OF WAVERLY RIGHT OF WAY NOT ACQUIRED.

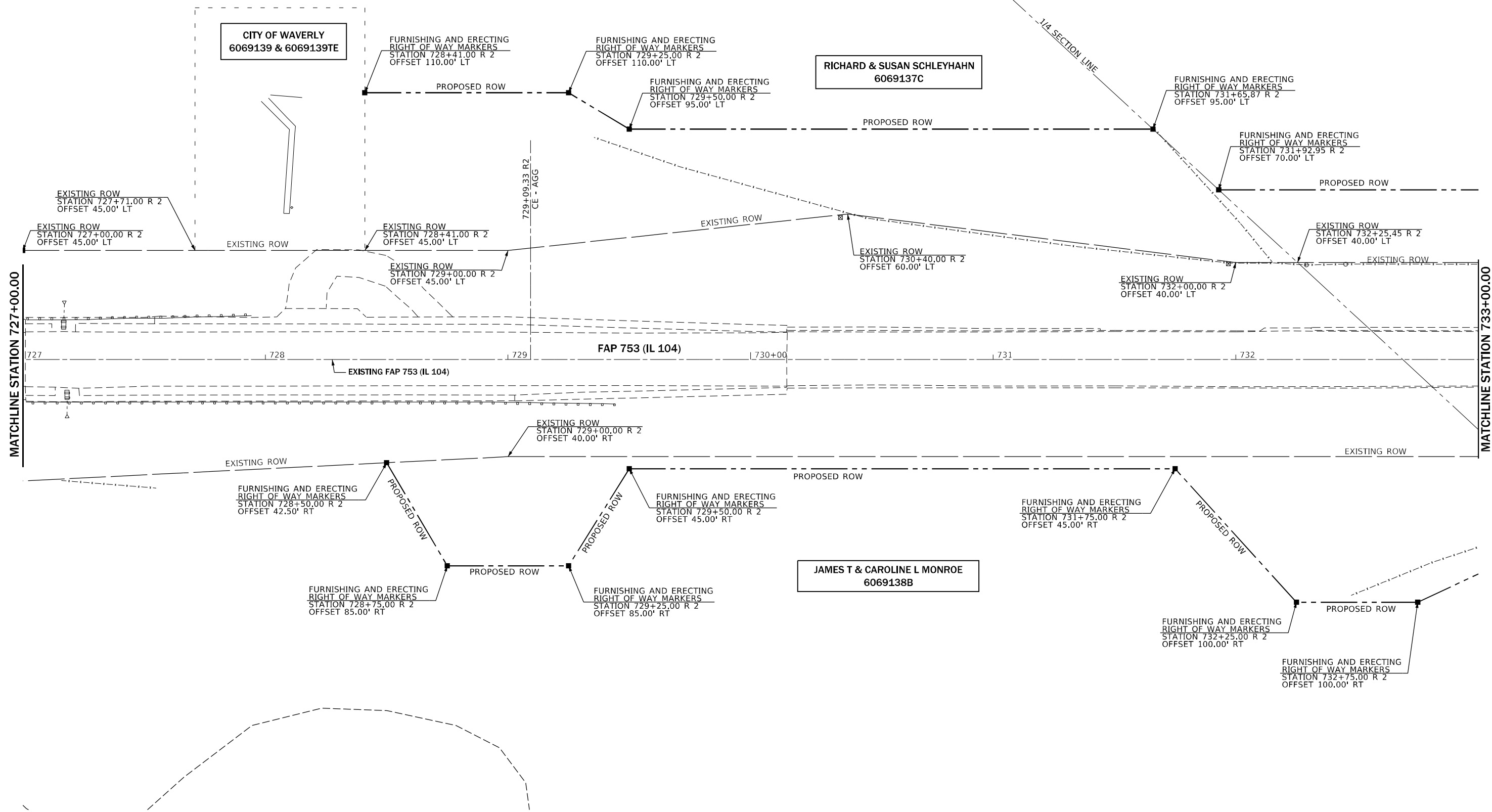

MODEL ROW Sheet 06
FILE NAME: p:\public\paw_bentley.com\p\INDOT\Documents\DOT_Offices\Dir\rdt_6\Project\0672119\CADD\data\Cadd\Sheet\0672119\sh-06-rov.dwg

USER NAME = MichaelWhitting	DESIGNED -	REVISED -
PLOT SCALE = 40,0000' / in.	DRAWN -	REVISED -
PLOT DATE = 8/23/2022	CHECKED -	REVISED -
	DATE -	REVISED -

**STATE OF ILLINOIS
DEPARTMENT OF TRANSPORTATION**

RIGHT OF WAY FAP 753 (IL 104)	
SCALE: 1" = 20'	SHEET OF SHEETS
STA. 727+00.00	TO STA. 733+00.00

F.A.P. RTE.	SECTION	COUNTY	TOTAL SHEETS	SHEET NO.
753	128TR	MORGAN	27	26
CONTRACT NO. 72119				
ILLINOIS		FED. AID PROJECT	STP-NDFU(489)	

FOR INFORMATIONAL PURUPOSE ONLY



NOTE:
1. CITY OF WAVERLY RIGHT OF WAY NOT ACQUIRED.

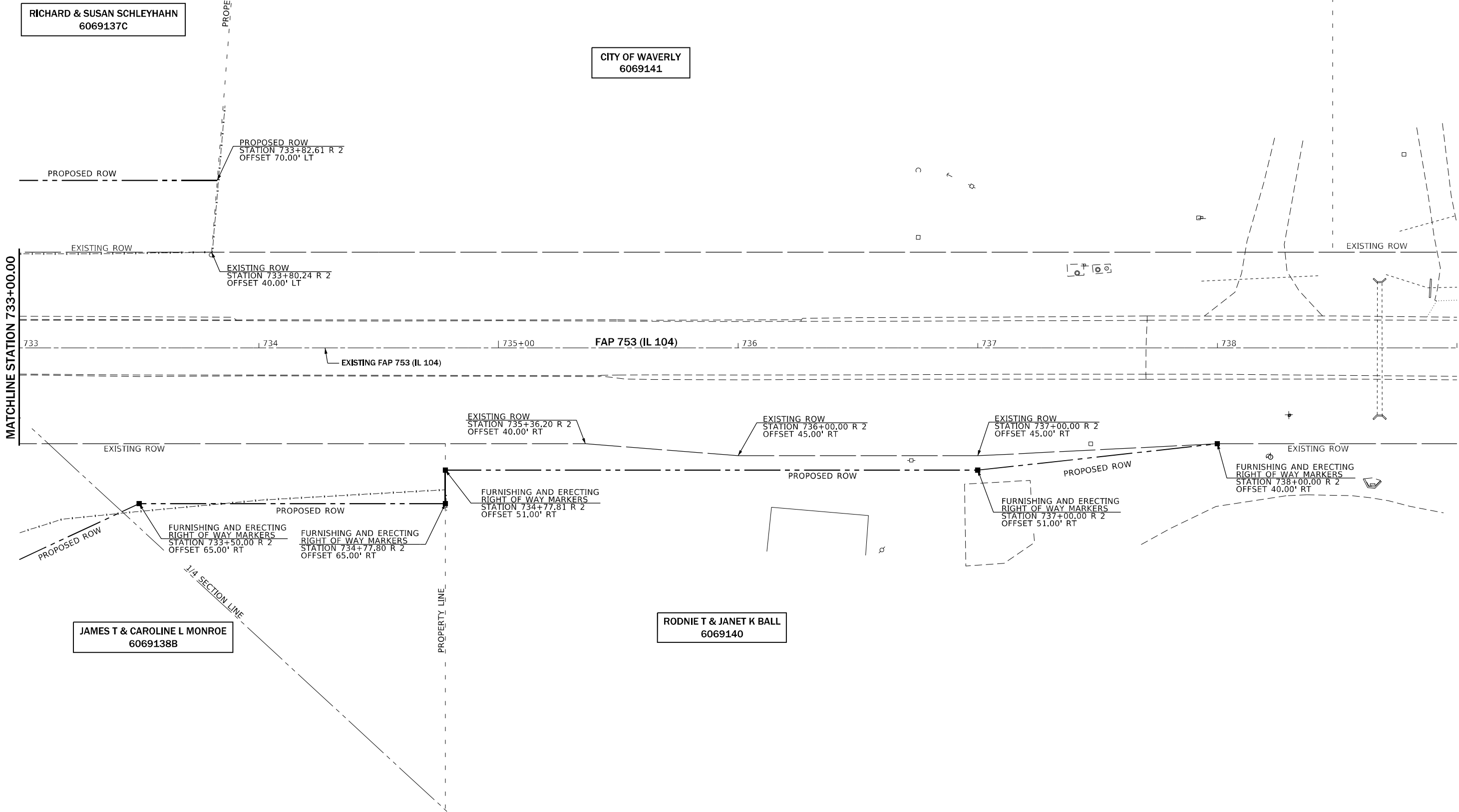

MODEL: ROW Sheet 07
 FILE NAME: p:\public\paw_bentley.com\p\INDOT\Documents\DOT_Offices\Dir\rdt_6\Project\0672119\CADD\data\0672119_sht-08-rov.dwg

USER NAME = Michael.Whitting	DESIGNED -	REVISED -
DRAWN -	REVISED -	
PLOT SCALE = 40,0000 * / in.	CHECKED -	REVISED -
PLOT DATE = 8/23/2022	DATE -	REVISED -

STATE OF ILLINOIS
DEPARTMENT OF TRANSPORTATION

RIGHT OF WAY
FAP 753 (IL 104)

SCALE: 1" = 20' SHEET OF SHEETS STA. 733+00.00 TO STA. 739+00.00

F.A.P. RTE.	SECTION	COUNTY	TOTAL SHEETS	SHEET NO.
753	128TR	MORGAN	27	27
CONTRACT NO. 72119				
ILLINOIS FED. AID PROJECT STP-NDFU(489)				