

STATE OF ILLINOIS
DEPARTMENT OF TRANSPORTATION

F.A.I. RTE.	SECTION	COUNTY	TOTAL SHEETS	SHEET NO.
55	(68-2)RS-6, (68-3)RS-4	MONTGOMERY	29	1
		ILLINOIS	72D32	

PROPOSED HIGHWAY PLANS

FAI ROUTE 55 (I-55)
SECTION (68-2)RS-6, (68-3)RS-4
PROJECT NHPP-3IH8(050)
RESURFACING, DITCH REPAIR
MONTGOMERY COUNTY

INDEX OF SHEETS

- 1 COVER SHEET
- 2 GENERAL NOTES
- 3-8 SUMMARY OF QUANTITIES
- 9-15 SCHEDULES
- 16-17 TYPICAL SECTIONS
- 18-23 PLAN SHEETS
- 24-29 DETAIL SHEETS

STANDARDS

- 000001-08 701201-05
- 001001-02 701400-11
- 001006 701401-13
- 280001-07 701411-09
- 420701-03 701426-09
- 442001-04 701428-01
- 442101-09 701451-05
- 635001-02 701456-05
- 642001-03 701901-08
- 701101-05 780001-05
- 701106-02 781001-04
- 420001-10 542301-03

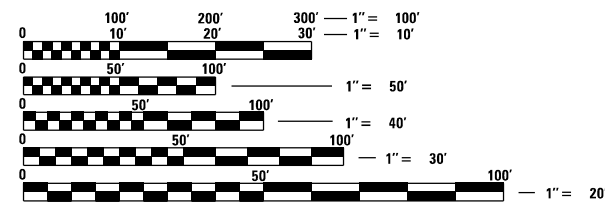

FULL SIZE PLANS HAVE BEEN PREPARED USING STANDARD ENGINEERING SCALES. REDUCED SIZED PLANS WILL NOT CONFORM TO STANDARD SCALES. IN MAKING MEASUREMENTS ON REDUCED PLANS, THE ABOVE SCALES MAY BE USED.

J.U.L.I.E.
JOINT UTILITY LOCATION INFORMATION FOR EXCAVATORS
1-800-892-0123
OR 811

PROJECT ENGINEER: JON KELLEY (217) 785-2739
PROJECT MANAGER: BRIAN MINDER (217) 557-7897

CONTRACT NO. 72D32

C-96-156-10

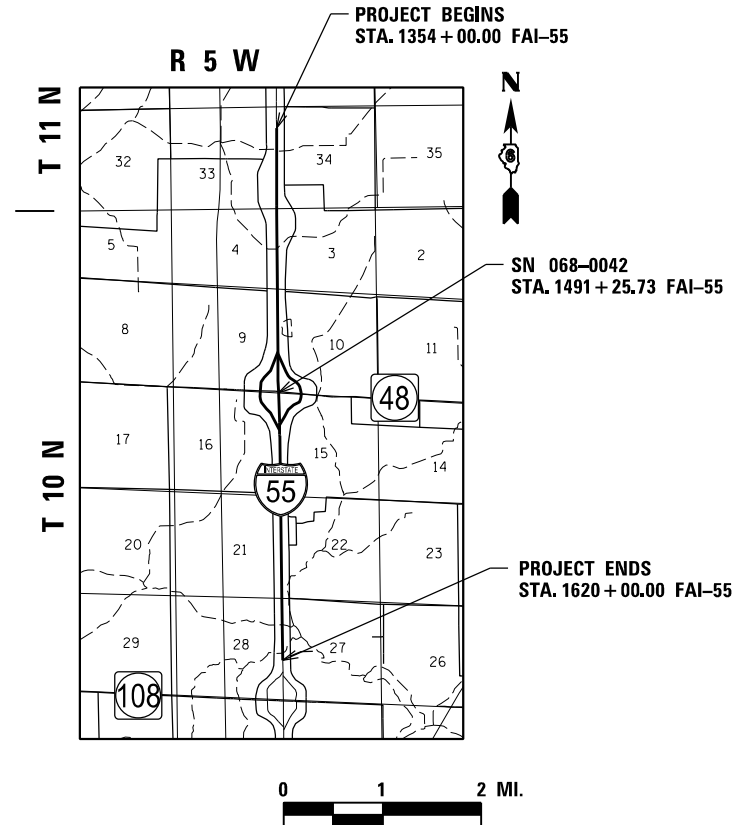

GROSS LENGTH = 26,600.00 FT. = 5.038 MILES
GROSS LENGTH = 26,600.00 FT. = 5.038 MILES
NET LENGTH = x.xx FT. = x.xxx MILE

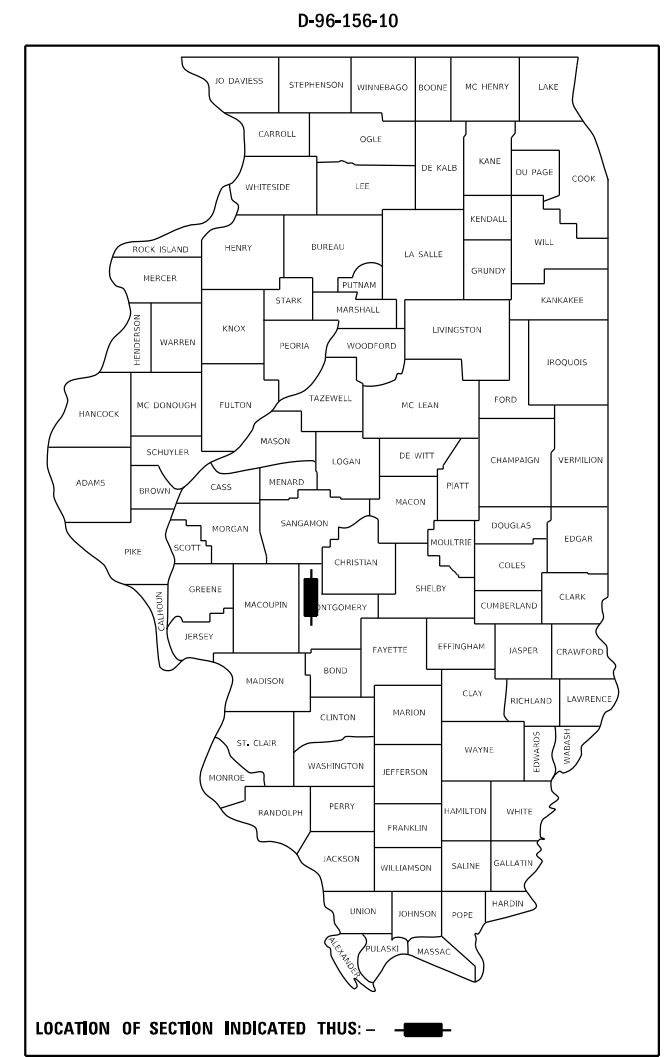

FUNCTIONAL CLASSIFICATION: INTERSTATE
ADT = 27,830 (2021)
MU = 7,580, SU = 900, PV = 19,350

STATE OF ILLINOIS
DEPARTMENT OF TRANSPORTATION

SUBMITTED August 26 20 22

Jeffrey P. Myers REGIONAL ENGINEER
October 14, 2022

Scott A. ERS
ENGINEER OF DESIGN AND ENVIRONMENT
October 14, 2022

Stephen M. Smith
DIRECTOR OF HIGHWAYS PROJECT IMPLEMENTATION

PRINTED BY THE AUTHORITY
OF THE STATE OF ILLINOIS

GENERAL NOTES:

1. THE CONTRACTOR SHALL NOTIFY THE DISTRICT 6 BUREAU OF OPERATIONS AT (217) 785-5306 THREE (3) WEEKS PRIOR TO IMPLEMENTING ANY TRAFFIC CONTROL.
2. THE DISTRICT 6 BUREAU OF OPERATIONS SHALL BE NOTIFIED BY PHONE (217) 785-5306 AT LEAST 14 DAYS PRIOR TO PLACEMENT OF FINAL PAVEMENT MARKINGS.

COMMITMENTS:

RATES OF APPLICATION:

BIUMINOUS MATERIALS (TACK COAT)	0.05 POUNDS / SQ FT MAINLINE 0.025 POUNDS / SQ FT MAINLINE BETWEEN LIFTS 0.25 POUNDS / SQ FT FOR AGGREGATE SURFACES
AGGREGATE WEDGE SHOULDERS	1.60 TONS PER CU YD
STONE MATRIX ASPHALT COURSES	112 POUNDS / SQ YD - INCH THICKNESS
HOT-MIX ASPHALT COURSES	112 POUNDS / SQ YD - INCH THICKNESS
NITROGEN FERTILIZER NUTRIENT	90 LB/ACRE
PHOSPHORUS FERTILIZER NUTRIENT	90 LB/ACRE
POTASSIUM FERTILIZER NUTRIENT	90 LB/ACRE
MULCH, METHOD 2	2.0 TONS/ACRE
AGRICULTURAL GROUND LIMESTONE	2.0 TONS/ACRE

MIXTURE REQUIREMENTS:

MIXTURE USES:	MAINLINE PASSING LANE BINDER COURSE (BOTTOM LIFT)	MAINLINE DRIVING LANE BINDER COURSE (BOTTOM LIFT)	MAINLINE PASSING & DRIVING LANES BINDER COURSE (TOP LIFT)	MAINLINE PASSING & DRIVING LANES SURFACE COURSE	WIDENING HMA SHOULDERS 10"	RAMPS SURFACE COURSE	RAMPS BINDER COURSE	SHOULDERS HMA SHOULDERS
PG:	SBS PG 76-28	SBS PG 76-28	SBS PG 76-28	SBS PG 76-28	PG 64-22	SBS PG 76-28	PG 64-22	PG 64-22
DESIGN AIR VOIDS:	4.0% AT N50	4.0% AT N80	4.0% AT N80	4.0% AT N80	4.0% AT N50	4.0% AT N70	4.0% AT N70	4.0% AT N50
MIXTURE COMPOSITION:	SMA - 12.5	SMA - 12.5	SMA - 9.5	SMA - 9.5	IL - 19.0	IL - 9.5	IL - 9.5FG	IL - 9.5
FRICTION AGGREGATE:	N/A	N/A	N/A	MIX "E"	N/A	MIX "C"	N/A	MIX "C"
MIXTURE WEIGHT:	112 LBS/SY INCH THICKNESS	112 LBS/SY INCH THICKNESS	112 LBS/SY INCH THICKNESS	112 LBS/SY INCH THICKNESS	112 LBS/SY INCH THICKNESS	112 LBS/SY INCH THICKNESS	112 LBS/SY INCH THICKNESS	112 LBS/SY INCH THICKNESS
QUALITY MANAGEMENT:	PFP	PFP	PFP	PFP	QC/QA	QC/QA	QC/QA	QC/QA
SUBLOT SIZE:	1000 TONS	1000 TONS	1000 TONS	1000 TONS	N/A	1000 TONS	1000 TONS	N/A
MTD REQD:	YES	YES	YES	YES	NO	YES	NO	NO

**STATE OF ILLINOIS
DEPARTMENT OF TRANSPORTATION
DIVISION OF HIGHWAYS
DISTRICT 6**

EXAMINED August 22 20 22
[Signature]
ENGINEER OF OPERATIONS

EXAMINED August 22 20 22
[Signature]
ENGINEER OF PROJECT IMPLEMENTATION

EXAMINED August 22 20 22
[Signature]
ENGINEER OF PROGRAM DEVELOPMENT

MODEL: Default
FILE NAME: p:\w\dot-m\dot-bentley.com\p\dot\dot\Documents\DOT_Offices\District_6\Projects\0672D32\CAD\Drawn\CAD\Sheet\0672D32_01.dwg

USER NAME = Brian.Minder	DESIGNED -	REVISED -
	DRAWN -	REVISED -
PLOT SCALE = 20.0000' / in.	CHECKED -	REVISED -
PLOT DATE = 8/26/2022	DATE -	REVISED -

**STATE OF ILLINOIS
DEPARTMENT OF TRANSPORTATION**

GENERAL NOTES

SCALE: NTS SHEET 1 OF 1 SHEETS STA. N/A TO STA. N/A

F.A.I. RTE.	SECTION	COUNTY	TOTAL SHEETS	SHEET NO.
55	(68-2)RS-6, (68-3)RS-4	MONTGOMERY	29	2
ILLINOIS FED. AID PROJECT			CONTRACT NO. 72D32	

				PPS# 6-00717-0000	
				90% FEDERAL 10% STATE	
CODE NO.	ITEM	UNIT	TOTAL QUANTITY	I-55 ROADWAY	
				0005	RURAL
20200600	EXCAVATING AND GRADING EXISTING SHOULDER	UNIT	17	17	
21400100	GRADING AND SHAPING DITCHES	FOOT	5,544	5,544	
25000210	SEEDING CLASS 2A	ACRE	1.25	1.25	
25000400	NITROGEN FERTILIZER NUTRIENT	POUND	113	113	
25000500	PHOSPHORUS FERTILIZER NUTRIENT	POUND	113	113	
25000600	POTASSIUM FERTILIZER NUTRIENT	POUND	113	113	
25000700	AGRICULTURAL GROUND LIMESTONE	TON	2.5	2.5	
25100115	MULCH, METHOD 2	ACRE	1.25	1.25	
25100630	EROSION CONTROL BLANKET	SQ YD	19	19	
28000500	INLET AND PIPE PROTECTION	EACH	14	14	
28100205	STONE RIPRAP, CLASS A3	TON	28	28	
40600290	BITUMINOUS MATERIALS (TACK COAT)	POUND	220,321	220,321	
40600370	LONGITUDINAL JOINT SEALANT	FOOT	60,440	60,440	
40600985	PORTLAND CEMENT CONCRETE SURFACE REMOVAL - BUTT JOINT	SQ YD	1,919	1,919	

REV. - MS

MODEL: Default
 FILE: Main.dwg
 PLOT: 11/15/2022 10:00:00 AM
 PLOTTER: HP DesignJet 5000 Series
 PLOT SCALE: 1/8" = 1'-0"
 PLOT DATE: 8/26/2022

USER NAME = Brian.Minder	DESIGNED - _____	REVISED - _____
DRAWN - _____	CHECKED - _____	REVISED - _____
PLOT SCALE = 20.0000 ' / in.	DATE - _____	REVISED - _____
PLOT DATE = 8/26/2022		

**STATE OF ILLINOIS
DEPARTMENT OF TRANSPORTATION**

SUMMARY OF QUANTITIES

SCALE: NTS SHEET 1 OF 6 SHEETS STA. TO STA.

F.A.I. RTE.	SECTION	COUNTY	TOTAL SHEETS	SHEET NO.
55	(68-2)RS-6, (68-3)RS-4	MONTGOMERY	29	3
CONTRACT NO. 72D32				
ILLINOIS FED. AID PROJECT				

				PPS# 6-00717-0000	
				90% FEDERAL 10% STATE	
CODE NO.	ITEM	UNIT	TOTAL QUANTITY	I-55 ROADWAY	
				0005	RURAL
40600990	TEMPORARY RAMP	SQ YD	1,860	1,860	
40602970	HOT-MIX ASPHALT BINDER COURSE, IL -9.5 FG, N70	TON	1,175	1,175	
40604152	POLYMERIZED HOT-MIX ASPHALT SURFACE COURSE, IL-9.5, MIX "C", N70	TON	1,476	1,476	
40605005	POLYMERIZED HOT-MIX ASPHALT BINDER COURSE, SMA 9.5, N80	TON	11,988	11,988	
40605010	POLYMERIZED HOT-MIX ASPHALT BINDER COURSE, STONE MATRIX ASPHALT, 12.5, N50	TON	9,990	9,990	
40605015	POLYMERIZED HOT-MIX ASPHALT BINDER COURSE, STONE MATRIX ASPHALT, 12.5, N80	TON	11,277	11,277	
40605024	POLYMERIZED HOT-MIX ASPHALT SURFACE COURSE, STONE MATRIX ASPHALT, 9.5, MIX "E", N80	TON	12,500	12,500	
44000155	HOT-MIX ASPHALT SURFACE REMOVAL, 1 1/2"	SQ YD	104,185	104,185	
44000160	HOT-MIX ASPHALT SURFACE REMOVAL, 2 3/4"	SQ YD	10,162	10,162	
44000163	HOT-MIX ASPHALT SURFACE REMOVAL, 3 1/2"	SQ YD	153,592	153,592	
44200050	WELDED WIRE REINFORCEMENT	SQ YD	29	29	
44200610	CLASS A PATCHES, TYPE II, 13 INCH	SQ YD	337	337	
44200614	CLASS A PATCHES, TYPE IV, 13 INCH	SQ YD	190	190	
44200934	CLASS B PATCHES, TYPE II, 8 INCH	SQ YD	75	75	

REV. - MS

MODEL: Default
 FILE: MainE - p:\blider-cw\benfley.com\PHWDOT\Documents\DOT Offices\District 6\Projects\0672022\CADD\Drawings\0672022_sht-500.dgn

USER NAME = Brian.Minder	DESIGNED - _____	REVISED - _____	STATE OF ILLINOIS DEPARTMENT OF TRANSPORTATION	SUMMARY OF QUANTITIES				F.A.I. RTE.	SECTION	COUNTY	TOTAL SHEETS	SHEET NO.
PLOT SCALE = 20.0000 ' / in.	DRAWN - _____	REVISED - _____		55	(68-2)RS-6, (68-3)RS-4	MONTGOMERY	29	4				
PLOT DATE = 8/26/2022	CHECKED - _____	REVISED - _____		CONTRACT NO. 72D32				ILLINOIS FED. AID PROJECT				
	DATE - _____	REVISED - _____		SCALE: NTS	SHEET 2 OF 6 SHEETS	STA.	TO STA.					

CODE NO.	ITEM	UNIT	TOTAL QUANTITY	PPS# 6-00717-0000	
				90% FEDERAL	10% STATE
				I-55 ROADWAY	
				0005	
				RURAL	
44200944	CLASS B PATCHES, TYPE IV, 8 INCH	SQ YD	29	29	
44201294	CLASS B PATCH - EXPANSION JOINT	FOOT	16	16	
44201296	DEFORMED BARS - EXPANSION JOINT	EACH	14	14	
44201299	DOWEL BARS 1 1/2"	EACH	210	210	
44213000	PATCHING REINFORCEMENT	SQ YD	527	527	
44213200	SAW CUTS	FOOT	3,336	3,336	
44213204	TIE BARS 3/4"	EACH	85	85	
48102100	AGGREGATE WEDGE SHOULDER, TYPE B	TON	2,369	2,369	
48203037	HOT-MIX ASPHALT SHOULDERS 10"	SQ YD	762	762	
48203100	HOT-MIX ASPHALT SHOULDERS	TON	23,935	23,935	
54213669	PRECAST REINFORCED CONCRETE FLARED END SECTION, 24"	EACH	1	1	
54248510	CONCRETE COLLAR	CU YD	0.2	0.2	
59300100	CONTROLLED LOW STRENGTH MATERIAL	CU YD	2	2	
60920012	PIPE CULVERT TO BE CLEANED, 12"	FOOT	10	10	

REV. - MS

MODEL: Default
 FILE: Main.dwg
 PLOT DATE: 8/26/2022
 USER: Brian.Minder
 DESIGNED: -
 DRAWN: -
 CHECKED: -
 DATE: -
 REVISED: -
 REVISED: -
 REVISED: -
 REVISED: -

USER NAME = Brian.Minder PLOT SCALE = 20.0000 ' / in. PLOT DATE = 8/26/2022		DESIGNED - _____ DRAWN - _____ CHECKED - _____ DATE - _____		REVISED - _____ REVISED - _____ REVISED - _____ REVISED - _____		STATE OF ILLINOIS DEPARTMENT OF TRANSPORTATION		SUMMARY OF QUANTITIES				F.A.I. RTE. 55 SECTION (68-2)RS-6, (68-3)RS-4 COUNTY MONTGOMERY TOTAL SHEETS 29 SHEET NO. 5	
SCALE: NTS		SHEET 3 OF 6 SHEETS		STA. _____		TO STA. _____		ILLINOIS FED. AID PROJECT				CONTRACT NO. 72D32	

CODE NO.	ITEM	UNIT	TOTAL QUANTITY	PPS# 6-00717-0000
				90% FEDERAL 10% STATE I-55 ROADWAY 0005 RURAL
60920024	PIPE CULVERT TO BE CLEANED, 24"	FOOT	10	10
63500105	DELINEATORS	EACH	137	137
64200116	SHOULDER RUMBLE STRIPS 16"	FOOT	95,290	95,290
67000400	ENGINEER'S FIELD OFFICE, TYPE A	CAL MO	6	6
67100100	MOBILIZATION	L SUM	1	1
70100420	TRAFFIC CONTROL AND PROTECTION, STANDARD 701411	EACH	9	9
70100450	TRAFFIC CONTROL AND PROTECTION STANDARD 701201	L SUM	1	1
70100800	TRAFFIC CONTROL AND PROTECTION, STANDARD 701401	L SUM	1	1
70100820	TRAFFIC CONTROL AND PROTECTION, STANDARD 701451	L SUM	1	1
70100825	TRAFFIC CONTROL AND PROTECTION, STANDARD 701456	L SUM	1	1
70107025	CHANGEABLE MESSAGE SIGN	CAL DA	125	125
70200100	NIGHTTIME WORK ZONE LIGHTING	L SUM	1	1
70300100	SHORT-TERM PAVEMENT MARKING	FOOT	23,350	23,350
70300150	SHORT-TERM PAVEMENT MARKING REMOVAL	SQ FT	7,705	7,705

REV. - MS

MODEL: Default
 FILE: Main.dwg
 PROJECT: \\server\share\dot\Projects\DOT\Office\District_6\Projects\0672023\CAD\Drawings\0672023_sht-500.dwg

USER NAME = Brian.Minder	DESIGNED - _____	REVISED - _____	STATE OF ILLINOIS DEPARTMENT OF TRANSPORTATION	SUMMARY OF QUANTITIES		F.A.I. RTE.	SECTION	COUNTY	TOTAL SHEETS	SHEET NO.
PLOT SCALE = 20.0000 ' / in.	DRAWN - _____	REVISED - _____		55	(68-2)RS-6, (68-3)RS-4	MONTGOMERY	29	6		
PLOT DATE = 8/26/2022	CHECKED - _____	REVISED - _____		CONTRACT NO. 72D32						
DATE - _____	REVISED - _____	SCALE: NTS		SHEET 4 OF 6 SHEETS	STA. _____	TO STA. _____	ILLINOIS	FED. AID PROJECT		

				PPS# 6-00717-0000
				90% FEDERAL
				10% STATE
CODE NO.	ITEM	UNIT	TOTAL QUANTITY	I-55 ROADWAY
				0005
				RURAL
* 78009000	MODIFIED URETHANE PAVEMENT MARKING - LETTERS AND SYMBOLS	SQ FT	64	64
* 78009005	MODIFIED URETHANE PAVEMENT MARKING - LINE 5"	FOOT	133,235	133,235
* 78009008	MODIFIED URETHANE PAVEMENT MARKING - LINE 8"	FOOT	5,540	5,540
* 78009012	MODIFIED URETHANE PAVEMENT MARKING - LINE 12"	FOOT	468	468
* 78009024	MODIFIED URETHANE PAVEMENT MARKING - LINE 24"	FOOT	64	64
* 78011000	GROOVING FOR RECESSED PAVEMENT MARKING LETTERS AND SYMBOLS	SQ FT	64	64
* 78011030	GROOVING FOR RECESSED PAVEMENT MARKING 6"	FOOT	133,235	133,235
* 78011045	GROOVING FOR RECESSED PAVEMENT MARKING 9"	FOOT	5,540	5,540
* 78011065	GROOVING FOR RECESSED PAVEMENT MARKING 13"	FOOT	468	468
* 78011125	GROOVING FOR RECESSED PAVEMENT MARKING 25"	FOOT	64	64
* 78100100	RAISED REFLECTIVE PAVEMENT MARKERS	EACH	1,534	1,534
78300200	RAISED REFLECTIVE PAVEMENT MARKER REMOVAL	EACH	1,534	1,534
Z0013798	CONSTRUCTION LAYOUT	L SUM	1	1
Z0034105	MATERIAL TRANSFER DEVICE	TON	47,231	47,231

* SPECIALTY ITEM

REV. - MS

MODEL: Default
 FILE: Main1 - pld\lides-cw-behntley.com-PWIDOT\Documents\DOT Offices\District 6\Projects\0672023\CADD\Drawings\0672023_sht-500.dgn

USER NAME = Brian.Minder	DESIGNED - _____	REVISED - _____
DRAWN - _____	CHECKED - _____	REVISED - _____
PLOT SCALE = 20.0000 ' / in.	DATE - _____	REVISED - _____
PLOT DATE = 8/26/2022		

**STATE OF ILLINOIS
DEPARTMENT OF TRANSPORTATION**

SUMMARY OF QUANTITIES

SCALE: NTS SHEET 5 OF 6 SHEETS STA. TO STA.

F.A.I. RTE.	SECTION	COUNTY	TOTAL SHEETS	SHEET NO.
55	(68-2)RS-6, (68-3)RS-4	MONTGOMERY	29	7
CONTRACT NO. 72D32				
ILLINOIS FED. AID PROJECT				

				PPS# 6-00717-0000
				90% FEDERAL
				10% STATE
CODE NO.	ITEM	UNIT	TOTAL QUANTITY	I-55 ROADWAY
				0006
				RURAL
X0320157	CLEANING UNDERDRAIN OUTLETS	EACH	216	216
X0100003	CLEARING AND GRUBBING	SQ YD	60	60
X0322279	OUTLET MARKERS	EACH	216	216
X0322936	REMOVE EXISTING FLARED END SECTION	EACH	1	1
X0325893	CLEAN EXISTING END SECTION	EACH	5	5
X2503000	MAINTENANCE MOWING	ACRE	51	51
X6024505	INLETS TO BE RECONSTRUCTED WITH SALVAGED FRAME AND GRATE	EACH	1	1
X6350120	DELINEATOR REMOVAL	EACH	60	60
X6650208	WOVEN WIRE FENCE REMOVAL AND REPLACEMENT	FOOT	70	70
∅ Z0076600	TRAINEES	HOUR	2000	2000
∅ Z0076604	TRAINEES TRAINING PROGRAM GRADUATE	HOUR	2000	2000

∅ 0042

REV. - MS

MODEL: Default
 FILE: M:\MSA - Proj\11482-216\benlley.com\PHWDOT\Documents\DOT Offices\District 6\Projects\0672023\CADD\DATA\CAD\Drawings\0672023_sht-500.dgn

USER NAME = Brian.Minder	DESIGNED - _____	REVISED - _____
	DRAWN - _____	REVISED - _____
PLOT SCALE = 20.0000 ' / in.	CHECKED - _____	REVISED - _____
PLOT DATE = 8/26/2022	DATE - _____	REVISED - _____

**STATE OF ILLINOIS
DEPARTMENT OF TRANSPORTATION**

SUMMARY OF QUANTITIES			
SCALE: NTS	SHEET 6 OF 6 SHEETS	STA.	TO STA.

F.A.I. RTE.	SECTION	COUNTY	TOTAL SHEETS	SHEET NO.
55	(68-2)RS-6, (68-3)RS-4	MONTGOMERY	29	8
CONTRACT NO. 72D32				
ILLINOIS FED. AID PROJECT				

PAVING SCHEDULE

STA.		STA.	LENGTH (FOOT)	48203037 HMA SHLDRS 10" (SQ YD)	40600290 BIT MATLS (TACK COAT) (POUND)	40605010 POLY HMA BIND CSE, SMA 12.5 N50, 2.5" (TON)	40605015 POLY HMA BIND CSE, SMA 12.5 N80, (TON)	40605005 POLY HMA BIND CSE, SMA 9.5 N80, (TON)	40605024 POLY HMA SURF CSE, SMA 9.5 MIX "E", N80, 1 1/2" (TON)	40602970 HMA BIND CSE IL-9.5 FG, N70, 1 1/4" (TON)	40604152 POLY HMA SURF CSE, IL-9.5, MIX "C", N70, 1 1/2" (TON)	48203100 HMA SHLDRS (TON)	48102100 AGGR WEDGE SHLDRS, TY B (TON)	64200116 SHLDR RUMBLE STRIPS, 16 INCH (FOOT)	40600372 LONGITUDINAL JT SEAL (FOOT)	40600990 TEMP RAMP (SQ YD)	78100100 RAISED REFL PVT MARKER (EACH)	78300200 RAISED REFL PVT MARKER REM (EACH)
NB I-55																		
1353+20.00	to	1354+00.00	80		288	15	15	18	30			20	3	160	80	290	2	2
1354+00.00	to	1381+46.00	2,746		9,886	513	513	615	615			1,111	102	5,492	2,746		69	69
1381+46.00	to	1392+96.00	1,150		4,140	215	215	258	258			465	43	1,150	2,300		29	29
1392+96.00	to	1410+97.00	1,801		6,484	336	336	403	403			728	67	3,602	1,801		45	45
1410+97.00	to	1416+65.00	568		2,045	106	106	127	127			230	21	568	1,136		14	14
1416+65.00	to	1442+80.00	2,615		9,414	488	488	586	586			1,058	97	5,200	2,615		65	65
1442+80.00	to	1445+85.00	305	136	1,190	57	57	68	68			154	11	305	305		8	8
1445+85.00	to	1447+09.00	124	55	484	23	23	28	28			63	2	124	124		3	3
1447+09.00	to	1468+58.00	2,149		7,736	401	401	481	481			869	79	4,298	2,149		54	54
1468+58.00	to	1480+38.00	1,180		4,248	220	220	264	264			477	44	1,180	2,360		30	30
1480+38.00	to	1488+95.00	857		3,085	160	160	192	192			347	32	1,714	857		21	21
1488+95.00	to	1489+75.00	80		288	15	15	18	18			32	3	160	80		2	2
1489+75.00	to	1492+80.00	305		1,098	57	57	68	68			123	11	610	305		8	8
1492+80.00	to	1493+60.00	80		288	15	15	18	18			32	3	160	80		2	2
1493+60.00	to	1505+11.00	1,151		4,144	215	215	258	258			466	43	2,302	1,151		29	29
1505+11.00	to	1510+41.00	530		1,908	99	99	119	119			214	20	530	1,060		13	13
1510+41.00	to	1544+30.00	3,389		12,200	633	633	759	759			1,371	125	6,748	3,389		85	85
1544+30.00	to	1547+35.00	305	136	1,190	57	57	68	68			154	6	305	305		8	8
1547+35.00	to	1548+59.00	124	55	484	23	23	28	28			63	2	124	124		3	3
1548+59.00	to	1620+00.00	7,141		25,708	1,333	1,333	1,600	1,600			2,888	264	14,282	7,141		179	179
1620+00.00	to	1620+80.00	80		288	15	15	18	30			20	3	160	80	290	2	2
SB I-55																		
1353+20.00	to	1354+00.00	80		288	15	15	18	30			20	3	160	80	290	2	2
1354+00.00	to	1366+89.00	1,289		4,640	241	241	289	289			521	48	2,578	1,289		32	32
1366+89.00	to	1372+76.00	587		2,113	110	110	131	131			237	22	587	1,174		15	15
1372+76.00	to	1390+47.00	1,771		6,376	331	331	397	397			716	65	3,542	1,771		44	44
1390+47.00	to	1402+09.00	1,162		4,183	217	217	260	260			470	43	1,162	2,324		29	29
1402+09.00	to	1437+91.00	3,582		12,895	669	669	802	802			1,449	132	7,164	3,582		90	90
1437+91.00	to	1439+15.00	124	55	484	23	23	28	28			63	2	124	124		3	3
1439+15.00	to	1442+20.00	305	136	1,190	57	57	68	68			154	6	305	305		8	8
1442+20.00	to	1470+67.00	2,847		10,249	531	531	638	638			1,151	105	5,664	2,847		71	71
1470+67.00	to	1476+56.00	589		2,120	110	110	132	132			238	22	589	1,178		15	15
1476+56.00	to	1488+95.00	1,239		4,460	231	231	278	278			501	46	2,478	1,239		31	31
1488+95.00	to	1489+75.00	80		288	15	15	18	18						80			
1489+75.00	to	1492+80.00	305		1,098	57	57	68	68						305			
1492+80.00	to	1493+60.00	80		288	15	15	18	18						80			
1493+60.00	to	1503+92.00	1,032		3,715	193	193	231	231						1,032			
1503+92.00	to	1515+46.00	1,154		4,154	215	215	258	258			467	43	1,154	2,308		29	29
1515+46.00	to	1539+41.00	2,395		8,622	447	447	536	536			969	89	4,790	2,395		60	60
1539+41.00	to	1540+65.00	124	55	484	23	23	28	28			63	2	124	124		3	3
1540+65.00	to	1543+70.00	305	136	1,190	57	57	68	68			154	6	305	305		8	8
1543+70.00	to	1620+00.00	7,630		27,468	1,424	1,424	1,709	1,709			3,086	282	15,230	7,630		191	191
1620+00.00	to	1620+80.00	80		288	15	15	18	30			20	3	160	80	290	2	2

MOEFL - Default
 FILE NAME: p:\blender-cw\benflay.com\PHWDOT\Documents\DOT Offices\District 6\Projects\0672023\CAD\Drawings\0672023_sbs-schedule.dgn

REV. - MS

USER NAME = Brian.Minder PLOT SCALE = 20.0000 ' / in. PLOT DATE = 8/26/2022	DESIGNED - _____	REVISED - _____	STATE OF ILLINOIS DEPARTMENT OF TRANSPORTATION	SCHEDULE OF QUANTITIES			F.A.I. RTE.	SECTION	COUNTY	TOTAL SHEETS	SHEET NO.
	DRAWN - _____	REVISED - _____					55	(68-2)RS-6, (68-3)RS-4	MONTGOMERY	29	9
	CHECKED - _____	REVISED - _____					CONTRACT NO. 72D32				
DATE - _____	REVISED - _____	SCALE: NTS	SHEET 1 OF 7 SHEETS	STA.	TO STA.	ILLINOIS FED. AID PROJECT					

PAVING SCHEDULE

STA.	STA.	LENGTH (FOOT)	48203037 HMA SHLDRS 10" (SQ YD)	40600290 BIT MATLS (TACK COAT) (POUND)	40605010 POLY HMA BIND CSE, SMA 12.5 N50, 2.5" (TON)	40605015 POLY HMA BIND CSE, SMA 12.5 N80, (TON)	40605005 POLY HMA BIND CSE, SMA 9.5 N80, (TON)	40605024 POLY HMA SURF CSE, SMA 9.5 MIX "E", N80, 1 1/2" (TON)	40602970 HMA BIND CSE IL-9.5 FG, N70, 1 1/4" (TON)	40604152 POLY HMA SURF CSE, IL-9.5, MIX "C", N70, 1 1/2" (TON)	48203100 HMA SHLDRS (TON)	48102100 AGGR WEDGE SHLDRS, TY B (TON)	64200116 SHLDR RUMBLE STRIPS, 16 INCH (FOOT)	40600372 LONGITUDINAL JT SEAL (FOOT)	40600990 TEMP RAMP (SQ YD)	78100100 RAISED REFL PVT MARKER (EACH)	78300200 RAISED REFL PVT MARKER REM (EACH)	
REST AREAS																		
RAMP 1																		
00+00.00	to	03+03.00	303	379		70		26			40	11				15	15	
03+03.00	to	06+62.00	359	844		166		62			109	13				35	35	
RAMP 2																		
24+32.00	to	28+56.00	424	996		196		73			129	16						
28+56.00	to	36+58.00	802	1,003		185		70			140	30						
RAMP 3																		
00+00.00	to	03+03.00	303	379		70		26			40	11				15	15	
03+03.00	to	06+62.00	359	844		166		62			109	13				34	34	
RAMP 4																		
24+29.00	to	28+58.00	429	1,008		198		74			131	16						
28+58.00	to	36+58.00	800	1,000		185		69			105	30						
MEDIAN CROSSOVERS																		
1442+50.00				261							57	3						
1544+00.00				261							57	3						
IL 48/IL127 INTERCHANGE																		
RAMP A																		
00+00.00	to	02+98.00	298	373					30	33	39	11				14	14	
02+98.00	to	05+30.00	232	476					29	35	30	9				24	24	
05+30.00	to	19+12.00	1,382	3,248					172	206	301	51				28	28	
19+12.00	to	19+37.00	25	59					3	4	5	1						
19+37.00	to	21+73.00	236	555					29	35	51	9			175			
RAMP B																		
00+33.00	to	01+56.00	123	289					30	18	27	5			175			
01+56.00	to	01+81.00	25	59					3	4	5	1						
01+81.00	to	16+31.00	1,450	3,408					180	217	316	54						
16+31.00	to	20+29.00	398	816					50	59	87	7						
20+29.00	to	27+83.00	754	943					47	124	99	14						
RAMP C																		
00+00.00	to	03+00.00	300	375					19	45	39	7				15	15	
03+00.00	to	05+89.00	289	592					36	43	38	7				31	31	
05+89.00	to	20+54.00	1,465	3,443					182	219	319	72				22	22	
20+54.00	to	20+79.00	25	59					3	4	5	1						
20+79.00	to	22+33.00	154	362					30	34	34	4			175			
RAMP D																		
00+34.00	to	01+72.00	138	324					28	32	30	5			175			
01+72.00	to	01+97.00	25	59					3	4	5	1						
01+97.00	to	14+36.00	1,239	2,912					154	185	270	46						
14+36.00	to	18+63.00	427	875					53	64	56	8						
18+63.00	to	26+12.00	749	936					93	112	98	14						
TOTAL=				762	220,321	9,990	11,227	11,988	12,500	1,175	1,476	23,935	2,369	95,290	60,440	1,860	1,534	1,534

REV. - MS

MODEL: Default
 FILE: MainE - p:\blider-cw-bentley.com\PROJECTS\DOT\Documents\DOT Offices\District 6\Projects\0672032\CADD\Drawings\0672032_shec-schedule.dgn

USER NAME = Brian.Minder	DESIGNED - _____	REVISED - _____
DRAWN - _____	REVISIONS - _____	
PLOT SCALE = 20.0000 ' / in.	CHECKED - _____	REVISED - _____
PLOT DATE = 8/26/2022	DATE - _____	REVISED - _____

**STATE OF ILLINOIS
DEPARTMENT OF TRANSPORTATION**

SCHEDULE OF QUANTITIES			
SCALE: NTS	SHEET 2	OF 7 SHEETS	STA. TO STA.

F.A.I. RTE.	SECTION	COUNTY	TOTAL SHEETS	SHEET NO.
55	(68-2)RS-6, (68-3)RS-4	MONTGOMERY	29	10
CONTRACT NO. 72D32				
ILLINOIS		FED. AID PROJECT		

STRIPING SCHEDULE

STA.		STA.	LENGTH (FOOT)	78009005 MOD URETHANE PVT MKG - LINE 5" (FOOT)		78011030 GRV FOR RECS D PVT MKG 6" (FOOT)	78009008 MOD URETHANE PVT MKG - LINE 8" (FOOT)	78011045 GRV FOR RECS D PVT MKG 9" (FOOT)	78009012 MOD URETHANE PVT MKG - LINE 12" (FOOT)	78011065 GRV FOR RECS D PVT MKG 13" (FOOT)	78009024 MOD URETHANE PVT MKG - LINE 24" (FOOT)	78011125 GRV FOR RECS D PVT MKG 25" (FOOT)	78009000 MOD URETHANE PVT MKG - LET & SYM (SQ FT)	78011000 GRV FOR RECS D PVT MKG - LET & SYM (SQ FT)	70300100 SHORT-TERM PVT MKG (FOOT)	70300150 SHORT-TERM PVT MKG REM (SQ FT)	63500105 DELINEATORS (EACH)
				WHITE	YELLOW												
NB I-55																	
1353+40.00	to	1354+00.00	60	75	60	135									25	8	
1354+00.00	to	1381+46.00	2,746	3,433	2,746	6,179									1,153	381	
1381+46.00	to	1389+46.00	800	200	800	1,000									336	111	
1389+46.00	to	1392+96.00	350	88	350	438	700	700							147	49	
1392+96.00	to	1410+97.00	1,801	2,251	1,801	4,052									756	250	
1410+97.00	to	1413+62.00	265	66	265	331	530	530	77	77					111	37	
1413+62.00	to	1416+65.00	303	76	303	379									127	42	
1416+65.00	to	1468+58.00	5,193	6,491	5,193	11,684									2,181	720	
1468+58.00	to	1476+07.00	749	187	749	936									315	104	
1476+07.00	to	1480+38.00	431	108	431	539	862	862							181	60	
1480+38.00	to	1505+11.00	2,473	3,091	2,473	5,564									1,039	343	
1505+11.00	to	1507+44.00	233	58	233	291	466	466	75	75					98	32	
1507+44.00	to	1510+41.00	297	74	297	371									125	41	
1510+41.00	to	1620+00.00	10,959	13,699	10,959	24,658									4,603	1,519	
1620+00.00	to	1620+60.00	60	75	60	135									25	8	
SB I-55																	
1353+40.00	to	1354+00.00	60	75	60	135									25	8	
1354+00.00	to	1366+89.00	1,289	1,411	1,289	2,700									541	179	
1366+89.00	to	1369+93.00	304	76	304	380									128	42	
1369+93.00	to	1372+76.00	283	71	283	354	566	566	105	105					119	39	
1372+76.00	to	1390+47.00	1,771	2,214	1,771	3,985									744	245	
1390+47.00	to	1394+07.00	360	90	360	450	720	720							151	50	
1394+07.00	to	1402+09.00	802	201	802	1,003									337	111	
1402+09.00	to	1437+91.00	3,582	4,478	3,582	8,060									1,504	496	
1437+91.00	to	1470+67.00	3,276	4,095	3,276	7,371									1,376	454	
1470+67.00	to	1473+68.00	301	75	301	376									126	42	
1473+68.00	to	1476+56.00	288	72	288	360	576	576	107	107					121	40	
1476+56.00	to	1503+92.00	2,736	3,420	2,736	6,156									1,149	379	
1503+92.00	to	1507+92.00	400	100	400	500	800	800							168	55	
1507+92.00	to	1515+46.00	754	189	754	943									317	105	
1515+46.00	to	1620+00.00	10,454	13,068	10,454	23,522									4,391	1,449	
1620+00.00	to	1620+60.00	60	75	60	135									25	8	

MODEL: Default
 FILE: M:\MSA - Proj\1482-22\benlley.com\PROJECTS\DOT\Documents\DOT\Office\District_6\Projects\0672032\CADD\DATA\CAD\Drawings\0672032_sbs-schedule.dwg

USER NAME = Brian.Minder	DESIGNED - _____	REVISED - _____
DRAWN - _____	CHECKED - _____	REVISED - _____
PLOT SCALE = 20.0000 ' / in.	DATE - _____	REVISED - _____
PLOT DATE = 8/26/2022		

**STATE OF ILLINOIS
DEPARTMENT OF TRANSPORTATION**

SCHEDULE OF QUANTITIES

SCALE: NTS SHEET 3 OF 7 SHEETS STA. TO STA.

F.A.I. RTE.	SECTION	COUNTY	TOTAL SHEETS	SHEET NO.
55	(68-2)RS-6, (68-3)RS-4	MONTGOMERY	29	11
CONTRACT NO. 72D32				
		ILLINOIS	FED. AID PROJECT	

STRIPING SCHEDULE

STA.	STA.	LENGTH (FOOT)	78009005 MOD URETHANE PVT MKG - LINE 5" (FOOT)		78011030 GRV FOR RECS PVT MKG 6" (FOOT)	78009008 MOD URETHANE PVT MKG - LINE 8" (FOOT)	78011045 GRV FOR RECS PVT MKG 9" (FOOT)	78009012 MOD URETHANE PVT MKG - LINE 12" (FOOT)	78011065 GRV FOR RECS PVT MKG 13" (FOOT)	78009024 MOD URETHANE PVT MKG - LINE 24" (FOOT)	78011125 GRV FOR RECS PVT MKG 25" (FOOT)	78009000 MOD URETHANE PVT MKG - LET & SYM (SQ.FT)	78011000 GRV FOR RECS PVT MKG - LET & SYM (SQ.FT)	70300100 SHORT-TERM PVT MKG (FOOT)	70300150 SHORT-TERM PVT MKG REM (SQ.FT)	63500105 DELINEATORS (EACH)	
			WHITE	YELLOW													
REST AREAS																	
RAMP 1																	
00+00.00	to	03+04.00	304	304		304									18	6	2
03+04.00	to	06+62.00	358	358	76	434									43	14	10
RAMP 2																	
24+32.00	to	28+58.00	426	426	67	493									51	17	10
28+58.00	to	36+58.00	800	800		800									48	16	4
RAMP 3																	
00+00.00	to	03+03.00	303	303		303									18	6	2
03+03.00	to	06+62.00	359	359	94	453									43	14	10
RAMP 4																	
24+29.00	to	28+56.00	427	427	82	509									51	17	2
28+56.00	to	36+58.00	802	802		802									48	16	10
IL 48/IL 127 INTERCHANGE																	
RAMP A																	
00+00.00	to	02+97.00	297	297		297									18	6	1
02+97.00	to	05+30.00	233	233		233									14	5	2
05+30.00	to	21+73.00	1,643	1,643	1,643	3,286	160	160	52	52	32	32	32	32	99	33	16
RAMP B																	
00+33.00	to	16+29.00	1,596	1,596	1,596	3,192									96	32	18
16+29.00	to	20+29.00	400	400		400									24	8	3
20+29.00	to	27+83.00	754	754		754									45	15	4
RAMP C																	
00+00.00	to	03+01.00	301	301		301									18	6	1
03+01.00	to	05+89.00	288	288		288									17	6	2
05+89.00	to	22+33.00	1,644	1,644	1,644	3,288	160	160	52	52	32	32	32	32	99	33	17
RAMP D																	
00+34.00	to	14+32.00	1,398	1,398	1,398	2,796									84	28	16
14+32.00	to	18+63.00	431	431		431									26	9	3
18+63.00	to	26+12.00	749	749		749									45	15	4
TOTAL=				133,235		133,235	5,540	5,540	468	468	64	64	64	64	23,350	7,705	137

MODEL: Default
 FILE NAME: p:\blender-cw-bentley.com-P\WIDOT\Documents\DOT Offices\District 6\Projects\0672032\CAD\Drawings\0672032_sbs-schedule.dgn

USER NAME = Brian.Minder	DESIGNED - _____	REVISED - _____
DRAWN - _____	REVISOR - _____	
PLOT SCALE = 20.0000 ' / in.	CHECKED - _____	REVISED - _____
PLOT DATE = 8/26/2022	DATE - _____	REVISED - _____

**STATE OF ILLINOIS
DEPARTMENT OF TRANSPORTATION**

SCHEDULE OF QUANTITIES			
SCALE: NTS	SHEET 4 OF 7 SHEETS	STA.	TO STA.

F.A.I. RTE.	SECTION	COUNTY	TOTAL SHEETS	SHEET NO.
55	(68-2)RS-6, (68-3)RS-4	MONTGOMERY	29	12
CONTRACT NO. 72D32				
ILLINOIS FED. AID PROJECT				

REMOVAL SCHEDULE							
STA.	STA.	LENGTH (FOOT)	40600985 PCC SURF REM - BUTT JT (SQ YD)	44000155 HMA SURF REM, 1 1/2" (SQ YD)	44000160 HMA SURF REM, 2 3/4" (SQ YD)	44000163 HMA SURF REM, 3 1/2" (SQ YD)	
NBI-55							
1353+20.00	to 1354+00.00	80	213	142		213	
1354+00.00	to 1381+46.00	2,746		4,882		7,323	
1381+46.00	to 1392+96.00	1,150		767		3,067	
1392+96.00	to 1410+97.00	1,801		3,202		4,803	
1410+97.00	to 1416+65.00	568		379		1,515	
1416+65.00	to 1442+35.00	2,570		4,569		6,853	
1442+35.00	to 1442+65.00	30		257		80	
1442+65.00	to 1442+80.00	15		50		40	
1442+80.00	to 1445+85.00	305		542		813	
1445+85.00	to 1447+09.00	124		220		331	
1447+09.00	to 1468+58.00	2,149		3,820		5,731	
1468+58.00	to 1480+38.00	1,180		787		3,147	
1480+38.00	to 1505+11.00	2,473		4,396		6,595	
1505+11.00	to 1510+41.00	530		353		1,413	
1510+41.00	to 1543+85.00	3,344		5,945		8,917	
1543+85.00	to 1544+15.00	30		257		80	
1544+15.00	to 1544+30.00	15		50		40	
1544+30.00	to 1547+35.00	305		542		813	
1547+35.00	to 1548+59.00	124		220		331	
1548+59.00	to 1620+00.00	7,141		12,695		19,043	
1620+00.00	to 1620+60.00	60	160	107		160	
SBI-55							
1353+20.00	to 1354+00.00	80	213	142		213	
1354+00.00	to 1366+89.00	1,289		2,292		3,437	
1366+89.00	to 1372+76.00	587		1,044		1,565	
1372+76.00	to 1390+47.00	1,771		3,148		4,723	
1390+47.00	to 1402+09.00	1,162		2,066		3,099	
1402+09.00	to 1437+91.00	3,582		6,368		9,552	
1437+91.00	to 1439+15.00	124		220		331	
1439+15.00	to 1442+20.00	305		542		813	
1442+20.00	to 1470+67.00	2,847		5,061		7,592	
1470+67.00	to 1476+56.00	589		1,047		1,571	
1476+56.00	to 1503+92.00	2,736		4,864		7,296	
1503+92.00	to 1515+46.00	1,154		2,052		3,077	
1515+46.00	to 1539+41.00	2,395		4,258		6,387	
1539+41.00	to 1540+65.00	124		220		331	
1540+65.00	to 1543+70.00	305		542		813	
1543+70.00	to 1620+00.00	7,630		13,564		20,347	
1620+00.00	to 1620+60.00	60	160	107		160	

REMOVAL SCHEDULE							
STA.	STA.	LENGTH (FOOT)	40600985 PCC SURF REM - BUTT JT (SQ YD)	44000155 HMA SURF REM, 1 1/2" (SQ YD)	44000160 HMA SURF REM, 2 3/4" (SQ YD)	44000163 HMA SURF REM, 3 1/2" (SQ YD)	
REST AREAS							
RAMP 1							
00+00.00	to 03+03.00	303		202		539	
03+03.00	to 06+62.00	359	391	399		638	
RAMP 2							
24+32.00	to 28+56.00	424	195	471		754	
28+56.00	to 36+58.00	802		535		1,426	
RAMP 3							
00+00.00	to 03+03.00	303		202		539	
03+03.00	to 06+62.00	359	391	399		638	
RAMP 4							
24+29.00	to 28+58.00	429		477		763	
28+58.00	to 36+58.00	800	195	533		1,422	
IL 48/IL127 INTERCHANGE							
RAMP A							
00+00.00	to 02+98.00	298		199		265	
02+98.00	to 05+30.00	232		258		412	
05+30.00	to 19+12.00	1,382		1,536	2,457		
19+12.00	to 19+37.00	25		28	44		
19+37.00	to 19+57.00	20		22	36		
RAMP B							
01+36.00	to 01+56.00	20		22	36		
01+56.00	to 01+81.00	25		28	44		
01+81.00	to 16+31.00	1,450		1,611	2,578		
16+31.00	to 20+29.00	398		442		708	
20+29.00	to 27+83.00	754		503		670	
RAMP C							
00+00.00	to 03+00.00	300		200		267	
03+00.00	to 05+89.00	289		321		514	
05+89.00	to 20+54.00	1,465		1,628	2,604		
20+54.00	to 20+79.00	25		28	44		
20+79.00	to 20+99.00	20		22	36		
RAMP D							
01+52.00	to 01+72.00	20		22	36		
01+72.00	to 01+97.00	25		28	44		
01+97.00	to 14+36.00	1,239		1,377	2,203		
14+36.00	to 18+63.00	427		474		759	
18+63.00	to 26+12.00	749		499		666	
TOTAL=			1,919	104,185	10,162	153,592	

MODEL: Default
 FILE: MainE - pw\lides-cw\benfley.com\PHWDOT\Documents\DOT Offices\District 6\Projects\0672023\CAD\Drawings\0672023_shs-schedule.dwg

USER NAME = Brian.Minder	DESIGNED - _____	REVISED - _____
DRAWN - _____	CHECKED - _____	REVISED - _____
PLOT SCALE = 20.0000 ' / in.	DATE - _____	REVISED - _____
PLOT DATE = 8/26/2022		

**STATE OF ILLINOIS
DEPARTMENT OF TRANSPORTATION**

SCHEDULE OF QUANTITIES

SCALE: NTS SHEET 5 OF 7 SHEETS STA. _____ TO STA. _____

F.A.I. RTE.	SECTION	COUNTY	TOTAL SHEETS	SHEET NO.
55	(68-2)RS-6, (68-3)RS-4	MONTGOMERY	29	13
CONTRACT NO. 72D32				
ILLINOIS FED. AID PROJECT				

DRAINAGE, EROSION CONTROL, & SEEDING SCHEDULE

STA.			STA.		21400100 GRAD AND SHAP DITCHES (FOOT)	28000500 INLET AND PIPE PROT (EACH)	28100205 STONE RIPRAP, CLASS A3	X0322936 REM EXIST FLRD END SEC (EACH)	54213669 PRE-CST REINF CONC FLRD END SEC, 24"	X0325893 CLEAN EXIST END SEC (EACH)	60920012 PIPE CULV TO BE CLEAN, 12" (FOOT)	60920024 PIPE CULV TO BE CLEAN, 24" (FOOT)	25000210 SEEDING CLASS 2A (ACRE)	25000400 NITROGEN FERT NUTR (POUND)	25000500 PHOSPHORUS FERT NUTR (POUND)	25000600 POTASSIUM FERT NUTR (POUND)	25000700 AGR GROUND LIMESTONE (TON)	25100115 MULCH, METHOD 2 (ACRE)	X0100003 CLEARING AND GRUBBING (SQ YD)	X6650208 WOVEN WIRE FENCE REM AND REPL (FOOT)	
FAI-55																					
1362+71.00	RT	to	1375+84.00	RT	1,313	2							0.301	27.13	27.13	27.13	0.60	0.301			
1376+80.00	RT	to	1387+92.00	RT	1,112								0.255	22.98	22.98	22.98	0.51	0.255			
1389+13.00	RT	to	1398+13.00	RT	1,070		28			4			0.246	22.11	22.11	22.11	0.49	0.246	60		
1397+00.00	RT							1	1												
1396+12.00	LT	to	1408+67.00		1,425								0.327	29.44	29.44	29.44	0.65	0.327			
1473+77.00	CL	to	1473+97.00	CL	20	1							0.005	0.41	0.41	0.41	0.01	0.005			
1474+23.00	CL	to	1474+43.00	CL	20	1							0.005	0.41	0.41	0.41	0.01	0.005			
1489+99.00	LT	to	1490+09.00	LT	10	1			1	10			0.002	0.21	0.21	0.21	0.00	0.002			
1525+49.00	LT	to	1525+69.00	LT	20	1								0.00	0.00	0.00	0.00	0.000			
1525+95.00	LT	to	1526+15.00	LT	20	1							0.005	0.41	0.41	0.41	0.01	0.005			
1541+05.00	LT	to	1541+25.00	LT	20	1							0.005	0.41	0.41	0.41	0.01	0.005			
1541+05.00	CL	to	1541+25.00	CL	20	1							0.005	0.41	0.41	0.41	0.01	0.005			
1579+44.00	LT	to	1579+84.00	LT	40	1							0.009	0.83	0.83	0.83	0.02	0.009			
1577+42.00	RT	to	1579+90.00	RT	248	1							0.057	5.12	5.12	5.12	0.11	0.057			
1579+64.00	CL	to	1579+84.00	CL	20	1					1		0.005	0.41	0.41	0.41	0.01	0.005			
1610+17.00	RT	to	1610+87.00	RT	70	1							0.016	1.45	1.45	1.45	0.03	0.016			
1610+98.00	RT	to	1611+38.00	RT	40	1							0.009	0.83	0.83	0.83	0.02	0.009			
RAMP D I L 48/IL 127																					
11+52.00	RT	to	12+28.00	RT	76								0.017	1.57	1.57	1.57	0.03	0.017		70	
TOTAL=					5,544	14	28	1	1	5	10	1	1.25	113	113	113	2.50	1.25	60	70	

MODEL: Default
 FILE: M:\MSA\...
 PROJECT: ...

USER NAME = Brian.Minder	DESIGNED - _____	REVISED - _____
DRAWN - _____	REVISIONS - _____	
PLOT SCALE = 20.0000' / in.	CHECKED - _____	REVISED - _____
PLOT DATE = 8/26/2022	DATE - _____	REVISED - _____

**STATE OF ILLINOIS
DEPARTMENT OF TRANSPORTATION**

SCHEDULE OF QUANTITIES			
SCALE: NTS	SHEET 6	OF 7 SHEETS	STA. TO STA.

F.A.I. RTE.	SECTION	COUNTY	TOTAL SHEETS	SHEET NO.
55	(68-2)RS-6, (68-3)RS-4	MONTGOMERY	29	14
CONTRACT NO. 72D32				
ILLINOIS FED. AID PROJECT				

UNDERDRAIN OUTLETS					
STA.	X0320157 CLEANING UNDERDRAIN OUTLETS (EACH)				X0322279 OUTLET MARKER (EACH)
	NB I-55		SB I-55		
	OUTSIDE	MEDIAN	MEDIAN	OUTSIDE	
1355+00.00	1	1	1	1	4
1360+00.00	1	1	1	1	4
1363+50.00	1	1	1	1	4
1365+00.00	1	1	1		3
1370+00.00	1	1	1		3
1375+00.00	1	1	1	1	4
1385+00.00	1	1	1	1	4
1390+00.00	1	1	1	1	4
1395+00.00		1	1		2
1397+00.00	1	1	1		3
1402+10.00				1	1
1402+50.00	1	1	1		3
1409+00.00	1				1
1412+50.00		1	1	1	3
1416+00.00	1	1	1	1	4
1420+00.00	1	1	1	1	4
1425+00.00	1	1	1	1	4
1430+00.00	1	1	1	1	4
1435+00.00	1	1	1	1	4
1440+00.00	1	1	1	1	4
1445+00.00	1	1	1	1	4
1450+00.00	1	1	1	1	4
1455+00.00	1	1	1	1	4
1465+00.00	1	1	1	1	4
1470+00.00	1	1	1	1	4
1473+00.00		1	1		2
1475+00.00		1	1		2
1479+00.00				1	1
1480+00.00		1	1		2
1481+00.00	1				1
1485+00.00	1	1	1	1	4
1490+00.00	1	1	1	1	4
1495+00.00	1	1	1	1	4

UNDERDRAIN OUTLETS					
STA.	X0320157 CLEANING UNDERDRAIN OUTLETS (EACH)				X0322279 OUTLET MARKER (EACH)
	NB I-55		SB I-55		
	OUTSIDE	MEDIAN	MEDIAN	OUTSIDE	
1500+00.00	1	1	1	1	4
1502+00.00	1	1	1	1	4
1505+00.00		1	1		2
1510+00.00	1	1	1	1	4
1511+00.00	1	1			2
1514+00.00			1	1	2
1516+00.00	1	1	1		3
1521+00.00	1	1			2
1525+50.00	1	1			2
1526+00.00			1		1
1531+00.00	1	1	1		3
1536+00.00	1	1	1		3
1541+50.00	1	1	1		3
1546+50.00	1	1	1		3
1551+00.00	1	1	1		3
1555+50.00	1	1			2
1556+00.00			1		1
1560+00.00	1	1			2
1569+00.00	1	1	1		3
1574+00.00	1	1	1		3
1579+00.00			1		1
1579+50.00	1	1			2
1584+00.00			1		1
1585+00.00	1	1			2
1590+00.00	1	1			2
1591+00.00			1	1	2
1596+00.00	1	1	1	1	4
1606+00.00	1	1	1	1	4
1610+50.00	1	1	1	1	4
1616+00.00	1	1	1	1	4

UNDERDRAIN OUTLETS					
STA.	X0320157 CLEANING UNDERDRAIN OUTLETS (EACH)				X0322279 OUTLET MARKER (EACH)
	NB I-55		SB I-55		
	OUTSIDE	MEDIAN	MEDIAN	OUTSIDE	
IL 48/IL127 INTERCHANGE					
	LEFT	RIGHT			
RAMP A					
04+00.00		1			1
08+00.00	1	1			2
12+50.00	1	1			2
17+50.00	1	1			2
RAMP B					
02+50.00	1	1			2
07+50.00	1	1			2
12+50.00	1	1			2
16+00.00	1				1
17+50.00		1			1
RAMP C					
04+50.00		1			1
07+50.00	1	1			2
12+50.00	1	1			2
17+50.00	1	1			2
RAMP D					
02+50.00	1	1			2
07+50.00	1	1			2
12+50.00	1	1			2
14+00.00	1				1
16+00.00		1			1
21+00.00		1			1
TOTAL=		216			216

MODEL: Default
 FILE: MainE - pld\lides-2w-bentley.com-PWIDOT\Documents\DOT Offices\District 6\Projects\0672023\CAD\Drawings\0672023_shec-schedule.dgn

USER NAME = Brian.Minder	DESIGNED - _____	REVISED - _____
	DRAWN - _____	REVISED - _____
PLOT SCALE = 20.0000' / in.	CHECKED - _____	REVISED - _____
PLOT DATE = 8/26/2022	DATE - _____	REVISED - _____

**STATE OF ILLINOIS
DEPARTMENT OF TRANSPORTATION**

SCHEDULE OF QUANTITIES			
SCALE: NTS	SHEET 7	OF 7 SHEETS	STA. TO STA.

F.A.I. RTE.	SECTION	COUNTY	TOTAL SHEETS	SHEET NO.
55	(68-2)RS-6, (68-3)RS-4	MONTGOMERY	29	15
CONTRACT NO. 72D32				
ILLINOIS		FED. AID PROJECT		

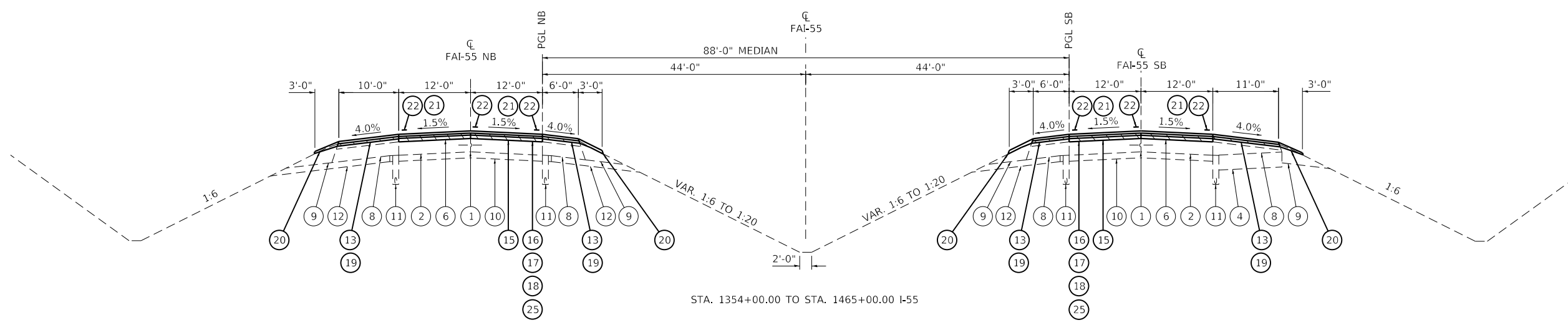
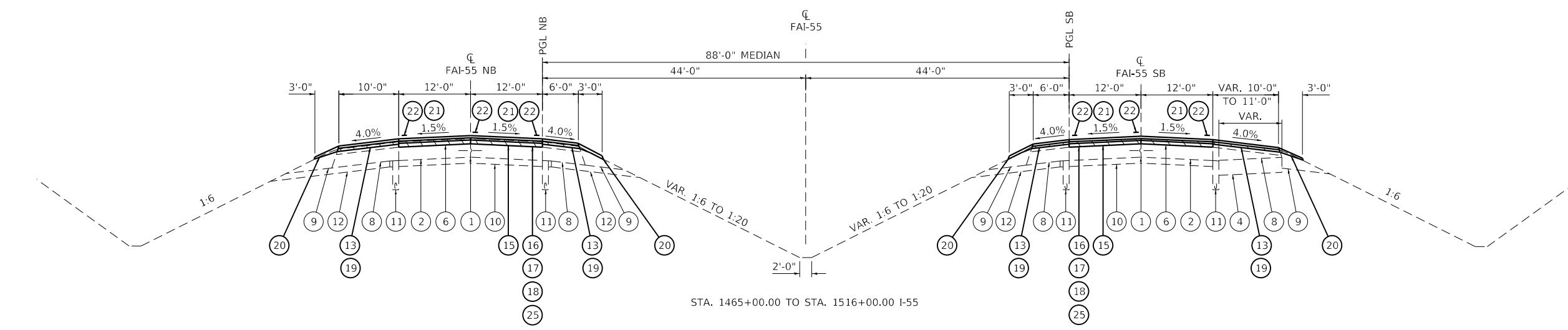

LEGEND

- ① EXIST. LONGITUDINAL JOINT
- ② EXIST. CRC PAVEMENT, 9"
- ③ EXIST. JRC PAVEMENT, 9"
- ④ EXIST. BURIED PCC PAVEMENT, 10"
- ⑤ EXIST. HMA RESURFACING, 2 3/4" (RAMPS)
- ⑥ EXIST. HMA RESURFACING, 3 1/2" (MAINLINE)
- ⑦ EXIST. HMA SHOULDERS, 10 3/4" (RAMPS)
- ⑧ EXIST. HMA SHOULDERS, 11 1/2" (MAINLINE)
- ⑨ EXIST. AGGREGATE SHOULDERS
- ⑩ EXIST. STABILIZED SUBBASE, 4"
- ⑪ EXIST. PIPE UNDERDRAINS, 4"
- ⑫ EXIST. SUBBASE GRANULAR MATERIAL, 4"
- ⑬ PROP. HOT-MIX ASPHALT SURFACE REMOVAL, 1 1/2" (MAINLINE SHOULDERS AND RAMP SHOULDERS)
- ⑭ PROP. HOT-MIX ASPHALT SURFACE REMOVAL, 2 3/4" (RAMPS)
- ⑮ PROP. HOT-MIX ASPHALT SURFACE REMOVAL, 3 1/2" (MAINLINE)
- ⑯ PROP. POLYMERIZED HOT-MIX ASPHALT BINDER COURSE, STONE MATRIX ASPHALT 12.5 N50, 2 1/2" (MAINLINE PASSING LANE, BOTTOM LIFT)
- ⑰ PROP. POLYMERIZED HOT-MIX ASPHALT BINDER COURSE, STONE MATRIX ASPHALT 12.5 N80, 2 1/2" (MAINLINE DRIVING LANE, BOTTOM LIFT)
- ⑱ PROP. POLYMERIZED HOT-MIX ASPHALT SURFACE COURSE, STONE MATRIX ASPHALT 9.5 MIX "E" N80, 1 1/2" (MAINLINE)
- ⑲ PROP. HOT-MIX ASPHALT SHOULDERS (3 1/2" MAINLINE SHOULDERS, 1 1/2" RAMP SHOULDERS)
- ⑳ PROP. AGGREGATE WEDGE SHOULDERS, TYPE B
- ㉑ PROP. GROOVING FOR RECESSED PAVEMENT MARKING 6"
- ㉒ PROP. MODIFIED URETHANE PAVEMENT MARKING - LINE 5"
- ㉓ PROP. HOT-MIX ASPHALT BINDER COURSE, IL-9.5FG, N70 1 1/4"
- ㉔ PROP. HOT-MIX ASPHALT SURFACE COURSE, IL-9.5 MIX "C", N70, 1 1/2"
- ㉕ PROP. POLYMERIZED HOT-MIX ASPHALT BINDER COURSE, STONE MATRIX ASPHALT 9.5 N80, 1 1/2" (MAINLINE DRIVING AND PASSING LANE, TOP LIFT)

NOTES:

- 1) FOR MAINLINE PVT AND RAMP PVT, HMA SURFACE REMOVAL SHALL MILL TO BARE CONCRETE.
- 2) HMA SURFACE REMOVAL ON THE SHOULDERS SHALL BE THE DEPTH SPECIFIED AT THE EOP, AND MAY VARY DUE TO EXISTING SHOULDER SLOPE.

MODEL: D:\default...
 FILE NAME: p:\bldg\sw\benitez.com\PHWDOT\Documents\DOT Offices\District 6\Projects\0672032\CADD\Drawings\0672032_sht14p_acc.dgn

USER NAME = Brian.Minder	DESIGNED -	REVISED -
PLOT SCALE = 20.0000' / in.	DRAWN -	REVISED -
PLOT DATE = 8/26/2022	CHECKED -	REVISED -
	DATE -	REVISED -

**STATE OF ILLINOIS
DEPARTMENT OF TRANSPORTATION**

TYPICAL SECTIONS FAI-55

SCALE: NTS SHEET 1 OF 2 SHEETS STA. TO STA.

F.A.I. RTE.	SECTION	COUNTY	TOTAL SHEETS	SHEET NO.
55	(68-2)RS-6, (68-3)RS-4	MONTGOMERY	29	16
CONTRACT NO. 72D32				
		ILLINOIS	FED. AID PROJECT	

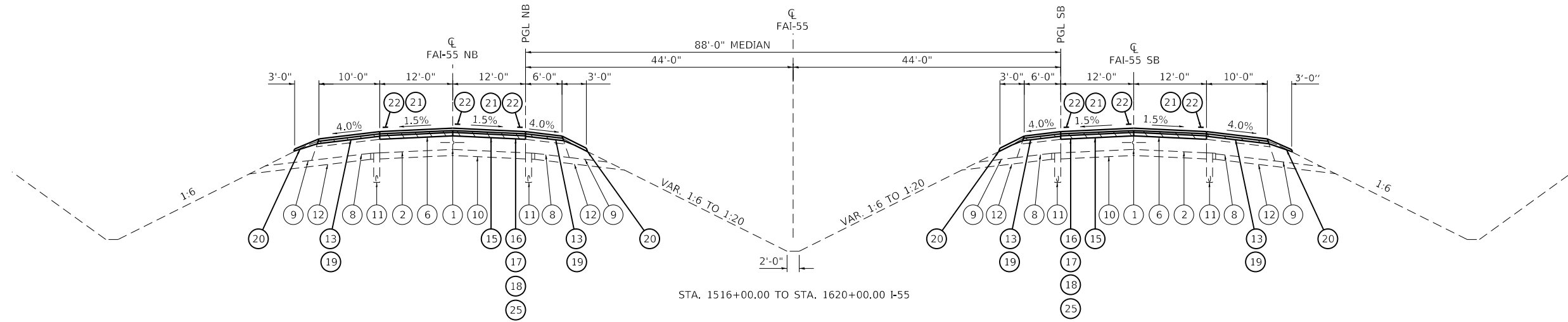

STA. 1516+00.00 TO STA. 1620+00.00 I-55

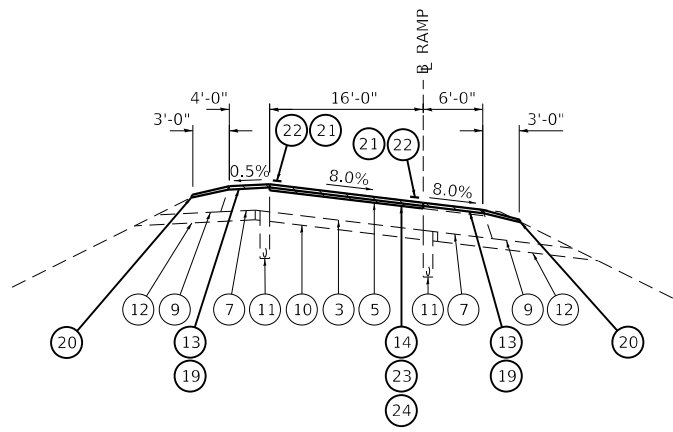

STA. 6+62.20 TO STA. 13+24.74 RAMP A
 STA. 9+94.98 TO STA. 17+32.78 RAMP B
 STA. 6+60.69 TO STA. 13+30.90 RAMP C
 STA. 8+33.29 TO STA. 15+62.73 RAMP D

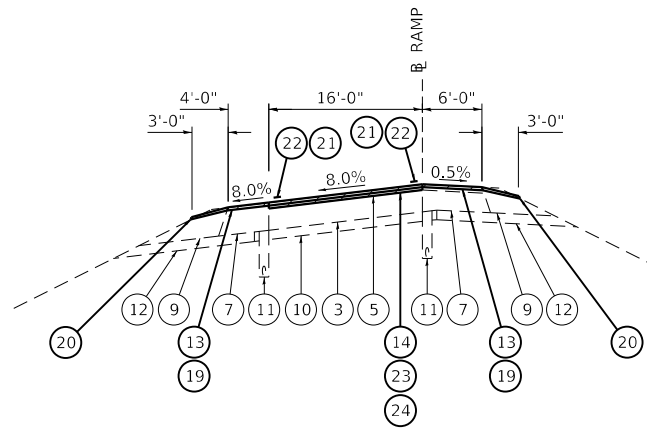

STA. 15+61.37 TO STA. 18+36.69 RAMP A
 STA. 2+47.95 TO STA. 7+55.54 RAMP B
 STA. 15+17.60 TO STA. 19+87.17 RAMP C
 STA. 2+24.51 TO STA. 5+94.20 RAMP D

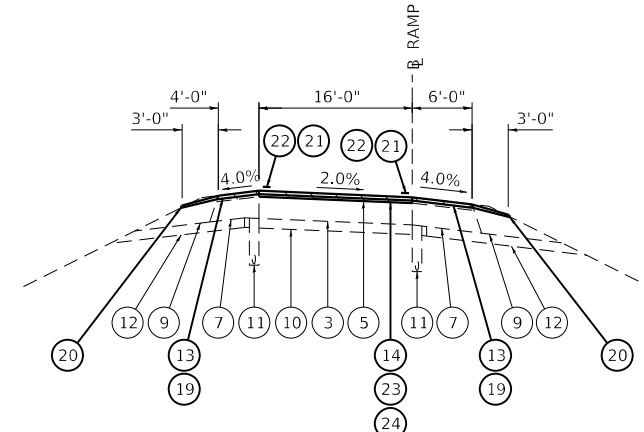

STA. 13+24.74 TO STA. 15+61.37 RAMP A
 STA. 18+36.69 TO STA. 21+07.37 RAMP A
 STA. 7+55.54 TO STA. 9+94.98 RAMP B
 STA. 17+32.78 TO STA. 27+82.50 RAMP B
 STA. 13+30.90 TO STA. 15+72.60 RAMP C
 STA. 19+87.17 TO STA. 22+61.01 RAMP C
 STA. 5+94.20 TO STA. 8+33.29 RAMP D
 STA. 15+62.73 TO STA. 26+12.23 RAMP D

LEGEND

- 1 EXIST. LONGITUDINAL JOINT
- 2 EXIST. CRC PAVEMENT, 9"
- 3 EXIST. JRC PAVEMENT, 9"
- 4 EXIST. BURIED PCC PAVEMENT, 10"
- 5 EXIST. HMA RESURFACING, 2 3/4" (RAMPS)
- 6 EXIST. HMA RESURFACING, 3 1/2" (MAINLINE)
- 7 EXIST. HMA SHOULDERS, 10 3/4" (RAMPS)
- 8 EXIST. HMA SHOULDERS, 11 1/2" (MAINLINE)
- 9 EXIST. AGGREGATE SHOULDERS
- 10 EXIST. STABILIZED SUBBASE, 4"
- 11 EXIST. PIPE UNDERDRAINS, 4"
- 12 EXIST. SUBBASE GRANULAR MATERIAL, 4"
- 13 PROP. HOT-MIX ASPHALT SURFACE REMOVAL, 1 1/2" (MAINLINE SHOULDERS AND RAMP SHOULDERS)
- 14 PROP. HOT-MIX ASPHALT SURFACE REMOVAL, 2 3/4" (RAMPS)
- 15 PROP. HOT-MIX ASPHALT SURFACE REMOVAL, 3 1/2" (MAINLINE)
- 16 PROP. POLYMERIZED HOT-MIX ASPHALT BINDER COURSE, STONE MATRIX ASPHALT 12.5 N50, 2 1/2" (MAINLINE PASSING LANE, BOTTOM LIFT)
- 17 PROP. POLYMERIZED HOT-MIX ASPHALT BINDER COURSE, STONE MATRIX ASPHALT 12.5 N80, 2 1/2" (MAINLINE DRIVING LANE, BOTTOM LIFT)
- 18 PROP. POLYMERIZED HOT-MIX ASPHALT SURFACE COURSE, STONE MATRIX ASPHALT 9.5 MIX "E" N80, 1 1/2" (MAINLINE)
- 19 PROP. HOT-MIX ASPHALT SHOULDERS (3 1/2" MAINLINE SHOULDERS, 1 1/2" RAMP SHOULDERS)
- 20 PROP. AGGREGATE WEDGE SHOULDERS, TYPE B
- 21 PROP. GROOVING FOR RECESSED PAVEMENT MARKING 6"
- 22 PROP. MODIFIED URETHANE PAVEMENT MARKING - LINE 5"
- 23 PROP. HOT-MIX ASPHALT BINDER COURSE, IL-9.5FG, N70 1 1/4"
- 24 PROP. HOT-MIX ASPHALT SURFACE COURSE, IL-9.5 MIX "C", N70, 1 1/2"
- 25 PROP. POLYMERIZED HOT-MIX ASPHALT BINDER COURSE, STONE MATRIX ASPHALT 9.5 N80, 1 1/2" (MAINLINE DRIVING AND PASSING LANE, TOP LIFT)

NOTES:

- 1) FOR MAINLINE PVT AND RAMP PVT, HMA SURFACE REMOVAL SHALL MILL TO BARE CONCRETE.
- 2) HMA SURFACE REMOVAL ON THE SHOULDERS SHALL BE THE DEPTH SPECIFIED AT THE EOP, AND MAY VARY DUE TO EXISTING SHOULDER SLOPE.

MODEL: Default
 FILE NAME: p:\blender-2022\blender.com\PHWDOT\Documents\DOT Offices\District 6\Projects\0672032\CADD\DATA\CAD\Sheet\0672032_sht.txd
 PROJECT: 0672032

USER NAME = Brian.Minder	DESIGNED -	REVISED -
	DRAWN -	REVISED -
PLOT SCALE = 20.0000 ' / in.	CHECKED -	REVISED -
PLOT DATE = 8/26/2022	DATE -	REVISED -

**STATE OF ILLINOIS
 DEPARTMENT OF TRANSPORTATION**

TYPICAL SECTIONS FAI-55

SCALE: NTS SHEET 2 OF 2 SHEETS STA. TO STA.

F.A.I. RTE.	SECTION	COUNTY	TOTAL SHEETS	SHEET NO.
55	(68-2)RS-6, (68-3)RS-4	MONTGOMERY	29	17
CONTRACT NO. 72D32				
ILLINOIS FED. AID PROJECT				

NOTE:

HMA MIXES WILL BE USED ON THE RAMPS BEGINNING ON THE RAMP TERMINALS, AND WILL CONTINUE UP THE RAMP TO THE EOP OF I-55. STONE MATRIX ASPHALT WILL ONLY BE USED ON THE MAINLINE OF I-55.



PVT MARKING LEGEND

- ① PROP. MODIFIED URETHANE PAVEMENT MARKING - LINE 5" (WHITE)
- ② PROP. MODIFIED URETHANE PAVEMENT MARKING - LINE 5" (YELLOW)
- ③ PROP. MODIFIED URETHANE PAVEMENT MARKING - LINE 5" (30' SKIP, 10' DASH)
- ④ PROP. MODIFIED URETHANE PAVEMENT MARKING - LINE 8" (WHITE)
- ⑤ PROP. MODIFIED URETHANE PAVEMENT MARKING - LINE 12" (WHITE)

LEGEND

- ▷ PROP. RAISED REFLECTIVE PAVEMENT MARKER (WHITE)
- ≡ PROP. DELINEATORS (DOUBLE REFLECTORS)
- ◄ PROP. DELINEATORS (SINGLE REFLECTOR)

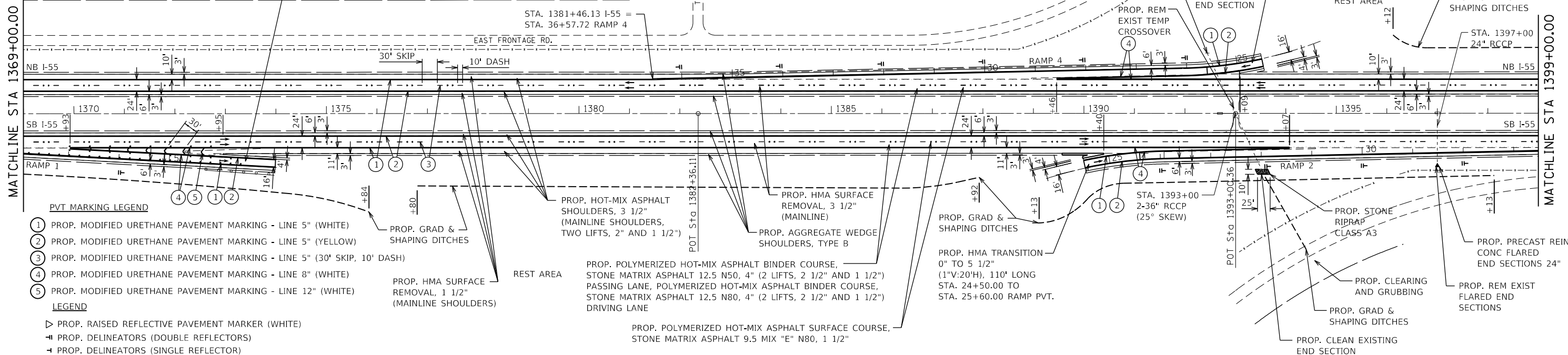
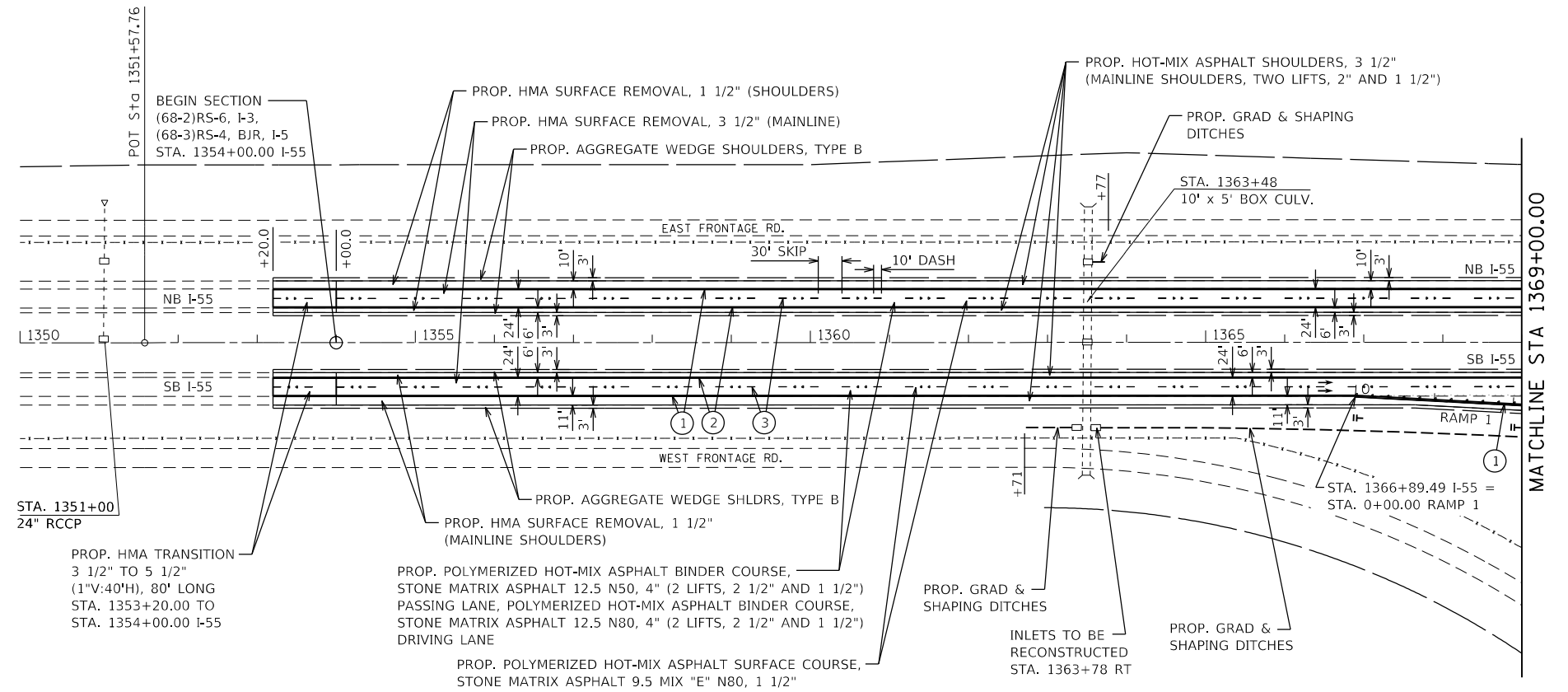

FILE NAME =	USER NAME = Brian.Minder	DESIGNED - EEK	REVISED -
\\dot-pw.bentley.com\PI\DOT\Documents\DOT Offices\District 6\Projects\0672032\CDRAWING\Sheets\0672032-sht-plan.dgn		CHECKED - JM	REVISED -
PLOT SCALE = 200.0000' / in.		DATE -	REVISED -
PLOT DATE = 8/26/2022			

**STATE OF ILLINOIS
DEPARTMENT OF TRANSPORTATION**

I-55 PLAN SHEETS

SCALE: 1" = 100' SHEET NO. OF SHEETS STA. 1354+00.00 TO STA. 1399+00.00

F.A.I. RTE.	SECTION	COUNTY	TOTAL SHEETS	SHEET NO.
55	(68-2)RS-6, (68-3)RS-4	MONTGOMERY	29	18
CONTRACT NO. 72032				
ILLINOIS FED. AID PROJECT				

PVT MARKING LEGEND

- ① PROP. MODIFIED URETHANE PAVEMENT MARKING - LINE 5" (WHITE)
- ② PROP. MODIFIED URETHANE PAVEMENT MARKING - LINE 5" (YELLOW)
- ③ PROP. MODIFIED URETHANE PAVEMENT MARKING - LINE 5" (30' SKIP, 10' DASH)
- ④ PROP. MODIFIED URETHANE PAVEMENT MARKING - LINE 8" (WHITE)
- ⑤ PROP. MODIFIED URETHANE PAVEMENT MARKING - LINE 12" (WHITE)

LEGEND

- ▷ PROP. RAISED REFLECTIVE PAVEMENT MARKER (WHITE)
- ≡ PROP. DELINEATORS (DOUBLE REFLECTORS)
- ┆ PROP. DELINEATORS (SINGLE REFLECTOR)

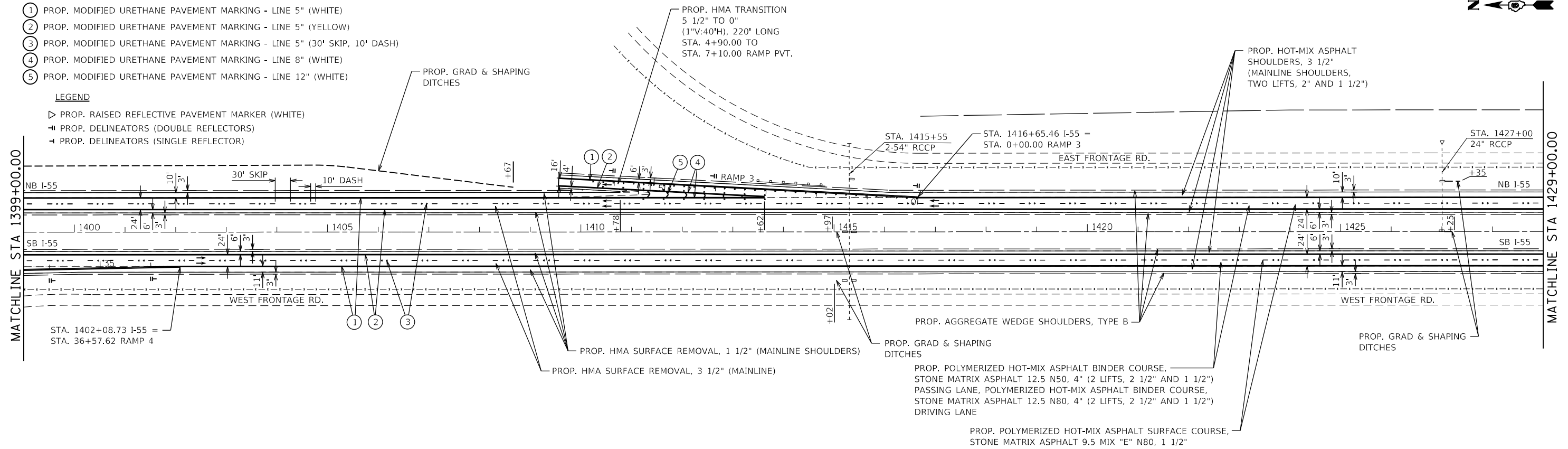

PVT MARKING LEGEND

- ① PROP. MODIFIED URETHANE PAVEMENT MARKING - LINE 5" (WHITE)
- ② PROP. MODIFIED URETHANE PAVEMENT MARKING - LINE 5" (YELLOW)
- ③ PROP. MODIFIED URETHANE PAVEMENT MARKING - LINE 5" (30' SKIP, 10' DASH)
- ④ PROP. MODIFIED URETHANE PAVEMENT MARKING - LINE 8" (WHITE)
- ⑤ PROP. MODIFIED URETHANE PAVEMENT MARKING - LINE 12" (WHITE)

LEGEND

- ▷ PROP. RAISED REFLECTIVE PAVEMENT MARKER (WHITE)
- ≡ PROP. DELINEATORS (DOUBLE REFLECTORS)
- ┆ PROP. DELINEATORS (SINGLE REFLECTOR)

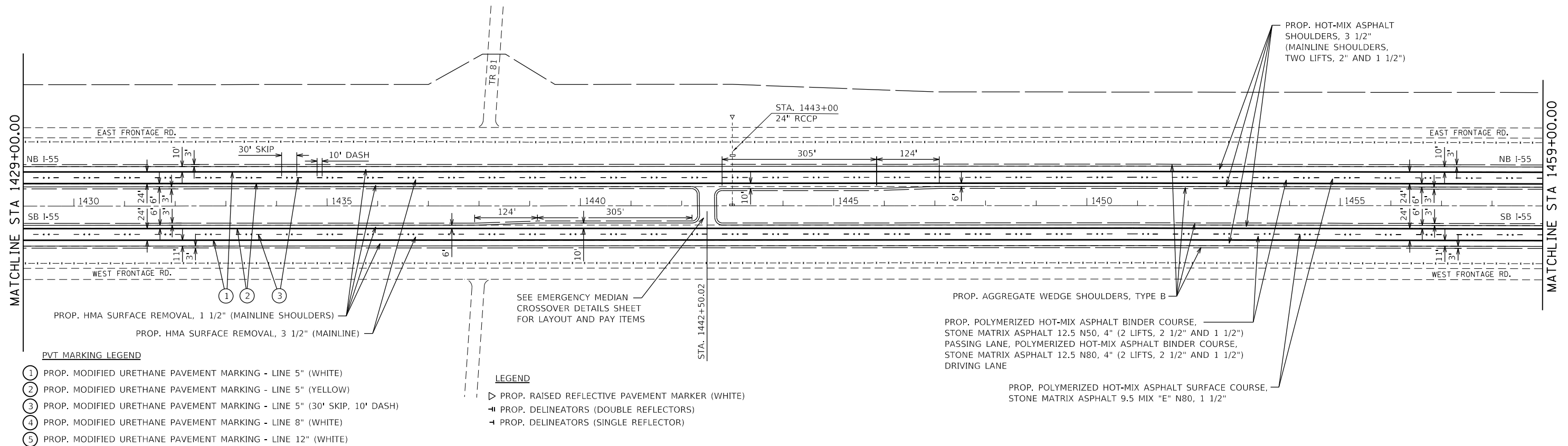

FILE NAME =	USER NAME = Brian.Minder	DESIGNED - EEK	REVISED -
p:\dot-pw\benley.com\PIWIDOT\Documents\DOT Offices\District 6\Projects\0672032\CAD\Drawings\0672032-sht-plan.dgn		CHECKED - JM	REVISED -
PLOT SCALE = 200.0000' / in.		DATE -	REVISED -
PLOT DATE = 8/26/2022			

STATE OF ILLINOIS
DEPARTMENT OF TRANSPORTATION

I-55 PLAN SHEETS

SCALE: 1" = 100' SHEET NO. OF SHEETS STA. 1399+00.00 TO STA. 1459+00.00

F.A.I. RTE.	SECTION	COUNTY	TOTAL SHEETS	SHEET NO.
55	(68-2)RS-6, (68-3)RS-4	MONTGOMERY	29	19
CONTRACT NO. 72032				
ILLINOIS FED. AID PROJECT				

EXIST. CURVE 6
 PI STA. = 1459+97.57
 $\Delta = 0^\circ 17' 52''$ (RT)
 $D = 0^\circ 00' 59''$
 $R = 349,206.70'$
 $T = 907.50'$
 $L = 1,815.00'$
 $E = 1.18'$
 $e = \text{-----}$
 $T.R. = \text{-----}$
 $S.E. RUN = \text{-----}$
 $P.C. STA. = 1450+90.07$
 $P.T. STA. = 1469+05.07$

EXIST. CURVE 623
 PI STA. = 12+28.33
 $\Delta = 54^\circ 33' 58''$ (RT)
 $D = 7^\circ 28' 50''$
 $R = 765.93'$
 $T = 395.04'$
 $L = 729.44'$
 $E = 95.87'$
 $e = 8.00\%$
 $T.R. = \text{-----}$
 $S.E. RUN = \text{-----}$
 $P.C. STA. = 8+33.29$
 $P.T. STA. = 15+62.73$

EXIST. CURVE 7
 PI STA. = 1482+70.11
 $\Delta = 1^\circ 09' 40''$ (LT)
 $D = 0^\circ 05' 58''$
 $R = 57,625.42'$
 $T = 583.91'$
 $L = 1,167.78'$
 $E = 2.96'$
 $e = \text{-----}$
 $T.R. = \text{-----}$
 $S.E. RUN = \text{-----}$
 $P.C. STA. = 1476+86.20$
 $P.T. STA. = 1488+53.98$

EXIST. CURVE 624
 PI STA. = 10+18.94
 $\Delta = 50^\circ 07' 32''$ (RT)
 $D = 7^\circ 28' 45''$
 $R = 766.08'$
 $T = 358.25'$
 $L = 670.21'$
 $E = 79.63'$
 $e = 8.00\%$
 $T.R. = \text{-----}$
 $S.E. RUN = \text{-----}$
 $P.C. STA. = 6+60.69$
 $P.T. STA. = 13+30.90$

EXIST. CURVE 618
 PI STA. = 10+16.00
 $\Delta = 49^\circ 46' 05''$ (RT)
 $D = 7^\circ 30' 42''$
 $R = 762.75'$
 $T = 353.80'$
 $L = 662.54'$
 $E = 78.06'$
 $e = 8.00\%$
 $T.R. = \text{-----}$
 $S.E. RUN = \text{-----}$
 $P.C. STA. = 6+62.20$
 $P.T. STA. = 13+24.74$

EXIST. CURVE 629
 PI STA. = 13+95.56
 $\Delta = 55^\circ 22' 33''$ (RT)
 $D = 7^\circ 30' 20''$
 $R = 763.38'$
 $T = 400.58'$
 $L = 737.80'$
 $E = 98.72'$
 $e = 8.00\%$
 $T.R. = \text{-----}$
 $S.E. RUN = \text{-----}$
 $P.C. STA. = 9+94.98$
 $P.T. STA. = 17+32.78$

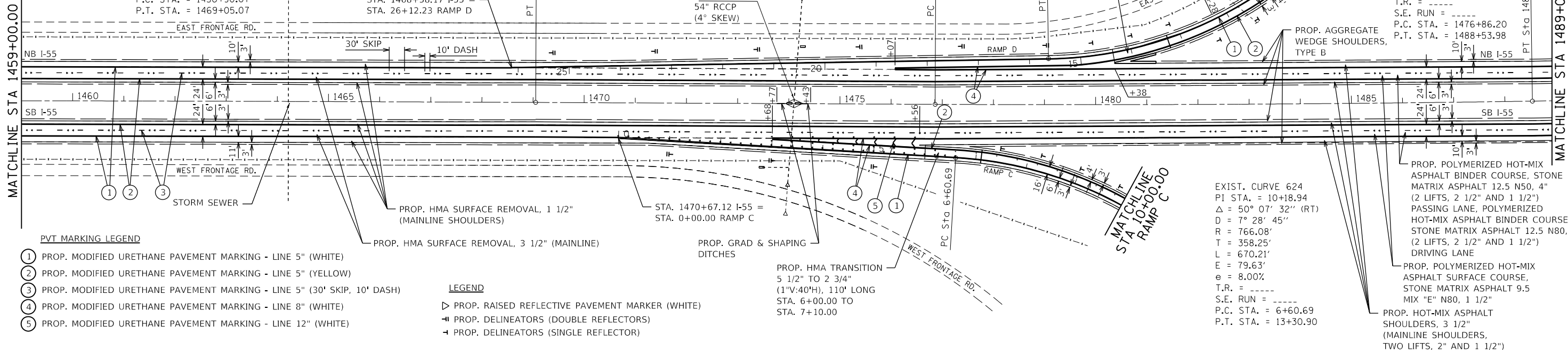

- PVT MARKING LEGEND**
- ① PROP. MODIFIED URETHANE PAVEMENT MARKING - LINE 5" (WHITE)
 - ② PROP. MODIFIED URETHANE PAVEMENT MARKING - LINE 5" (YELLOW)
 - ③ PROP. MODIFIED URETHANE PAVEMENT MARKING - LINE 5" (30' SKIP, 10' DASH)
 - ④ PROP. MODIFIED URETHANE PAVEMENT MARKING - LINE 8" (WHITE)
 - ⑤ PROP. MODIFIED URETHANE PAVEMENT MARKING - LINE 12" (WHITE)
- LEGEND**
- ▷ PROP. RAISED REFLECTIVE PAVEMENT MARKER (WHITE)
 - ≡ PROP. DELINEATORS (DOUBLE REFLECTORS)
 - PROP. DELINEATORS (SINGLE REFLECTOR)

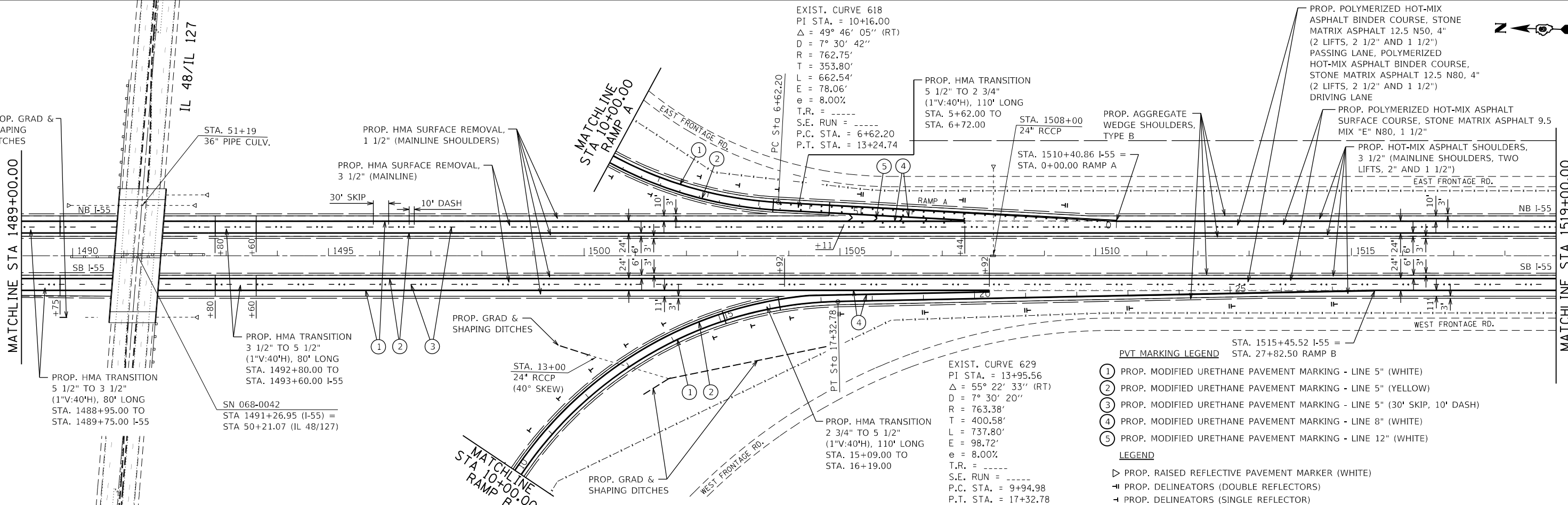

- PVT MARKING LEGEND**
- ① PROP. MODIFIED URETHANE PAVEMENT MARKING - LINE 5" (WHITE)
 - ② PROP. MODIFIED URETHANE PAVEMENT MARKING - LINE 5" (YELLOW)
 - ③ PROP. MODIFIED URETHANE PAVEMENT MARKING - LINE 5" (30' SKIP, 10' DASH)
 - ④ PROP. MODIFIED URETHANE PAVEMENT MARKING - LINE 8" (WHITE)
 - ⑤ PROP. MODIFIED URETHANE PAVEMENT MARKING - LINE 12" (WHITE)
- LEGEND**
- ▷ PROP. RAISED REFLECTIVE PAVEMENT MARKER (WHITE)
 - ≡ PROP. DELINEATORS (DOUBLE REFLECTORS)
 - PROP. DELINEATORS (SINGLE REFLECTOR)

FILE NAME =	USER NAME = Brian.Minder	DESIGNED - EEK	REVISED -	STATE OF ILLINOIS DEPARTMENT OF TRANSPORTATION	I-55 PLAN SHEETS			F.A.I. RTE.	SECTION	COUNTY	TOTAL SHEETS	SHEET NO.
p:\dot-pw.bentley.com\PROJECTS\DOT Documents\DOT Offices\District 6\Projects\0672032\CD\DRAWINGS\0672032-sht-plan.dgn		CHECKED - JM	REVISED -		SCALE: 1" = 100'	SHEET NO.	OF SHEETS	55	(68-2)RS-6, (68-3)RS-4	MONTGOMERY	29	20
PLOT SCALE = 200.0000' / in.		DATE -	REVISED -		STA. 1459+00.00 TO STA. 1519+00.00			CONTRACT NO. 72032				
PLOT DATE = 8/26/2022								ILLINOIS FED. AID PROJECT				

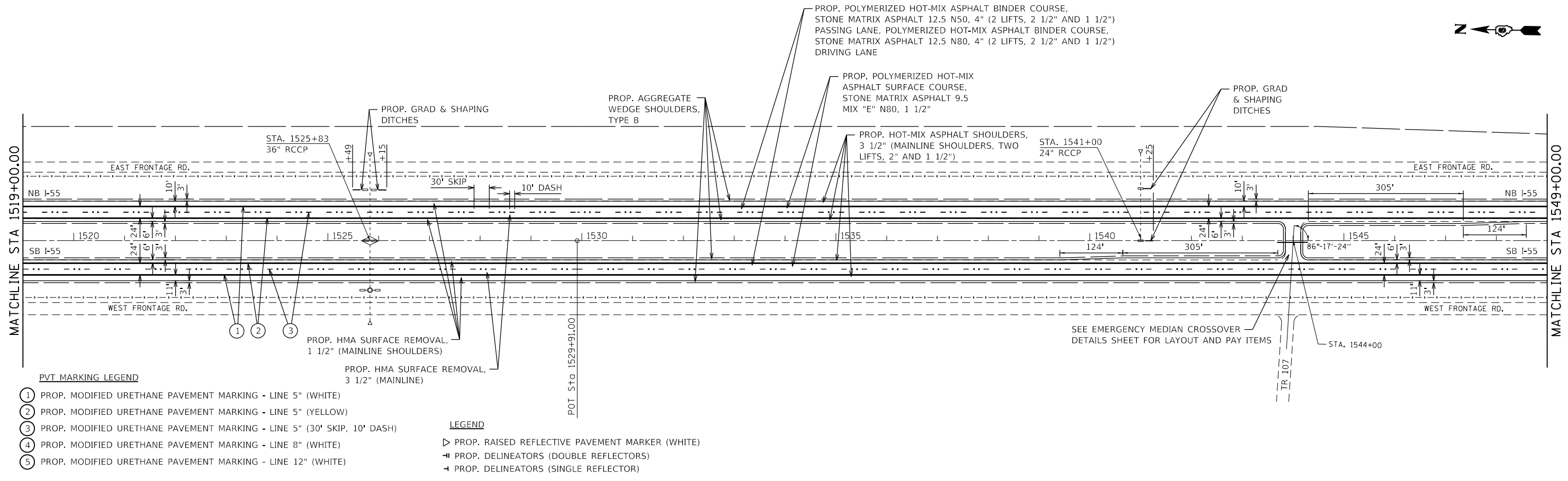

- PVT MARKING LEGEND**
- ① PROP. MODIFIED URETHANE PAVEMENT MARKING - LINE 5" (WHITE)
 - ② PROP. MODIFIED URETHANE PAVEMENT MARKING - LINE 5" (YELLOW)
 - ③ PROP. MODIFIED URETHANE PAVEMENT MARKING - LINE 5" (30' SKIP, 10' DASH)
 - ④ PROP. MODIFIED URETHANE PAVEMENT MARKING - LINE 8" (WHITE)
 - ⑤ PROP. MODIFIED URETHANE PAVEMENT MARKING - LINE 12" (WHITE)

- LEGEND**
- ▷ PROP. RAISED REFLECTIVE PAVEMENT MARKER (WHITE)
 - ≡ PROP. DELINEATORS (DOUBLE REFLECTORS)
 - ≡ PROP. DELINEATORS (SINGLE REFLECTOR)

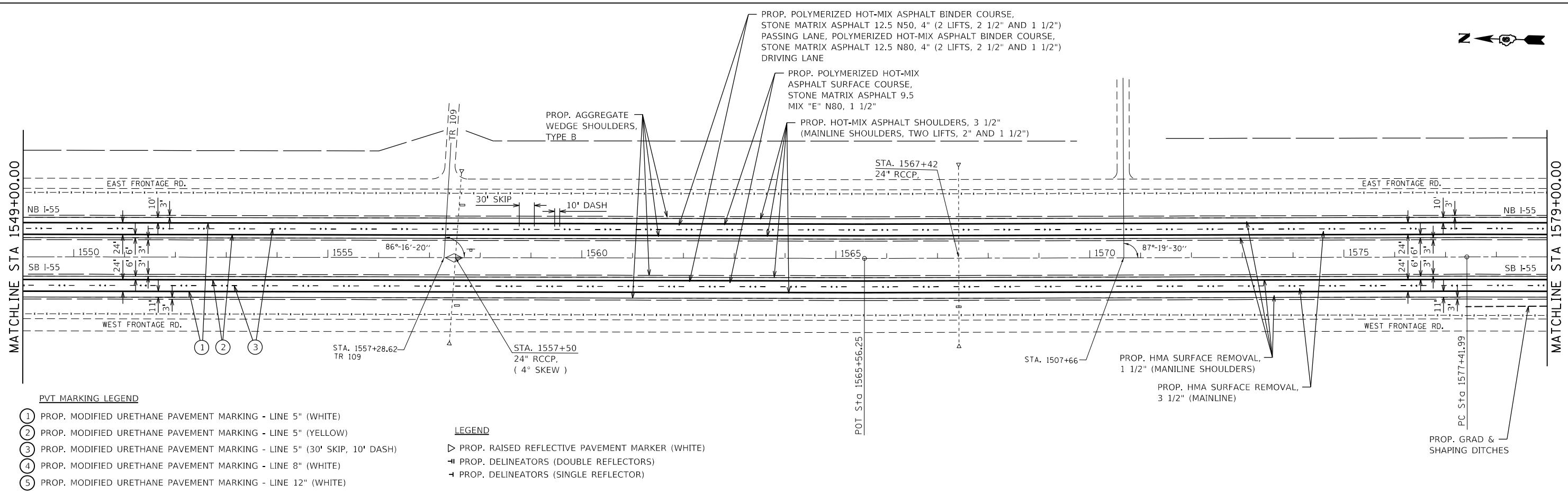

- PVT MARKING LEGEND**
- ① PROP. MODIFIED URETHANE PAVEMENT MARKING - LINE 5" (WHITE)
 - ② PROP. MODIFIED URETHANE PAVEMENT MARKING - LINE 5" (YELLOW)
 - ③ PROP. MODIFIED URETHANE PAVEMENT MARKING - LINE 5" (30' SKIP, 10' DASH)
 - ④ PROP. MODIFIED URETHANE PAVEMENT MARKING - LINE 8" (WHITE)
 - ⑤ PROP. MODIFIED URETHANE PAVEMENT MARKING - LINE 12" (WHITE)

- LEGEND**
- ▷ PROP. RAISED REFLECTIVE PAVEMENT MARKER (WHITE)
 - ≡ PROP. DELINEATORS (DOUBLE REFLECTORS)
 - ≡ PROP. DELINEATORS (SINGLE REFLECTOR)

FILE NAME =	USER NAME = Brian.Minder	DESIGNED - EEK	REVISED -
p:\dot-pw.bentley.com\PIWIDOT\Documents\DOT Offices\District 6\Projects\0672032\CAD\Drawings\Sheets\0672032-sht-plan.dgn		CHECKED - JM	REVISED -
		DATE -	REVISED -

**STATE OF ILLINOIS
DEPARTMENT OF TRANSPORTATION**

I-55 PLAN SHEETS			
SCALE: 1" = 100'	SHEET NO.	OF SHEETS	STA. 1519+00.00 TO STA. 1579+00.00

F.A.I. RTE.	SECTION	COUNTY	TOTAL SHEETS	SHEET NO.
55	(68-2)RS-6, (68-3)RS-4	MONTGOMERY	29	21
CONTRACT NO. 72032				
ILLINOIS FED. AID PROJECT				

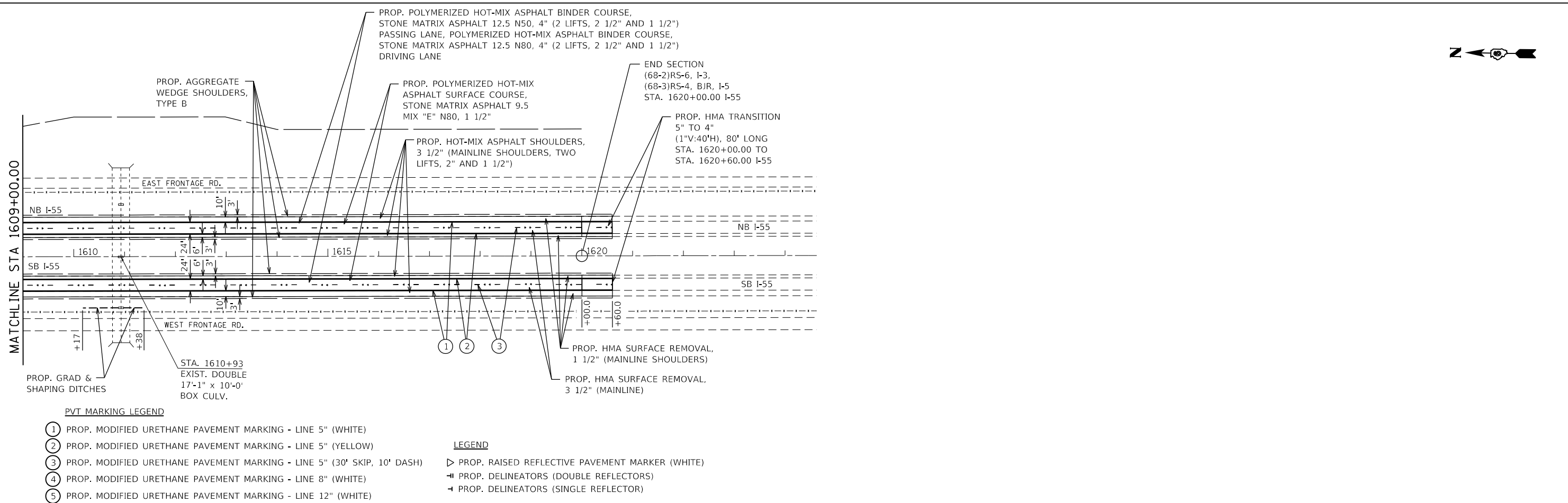
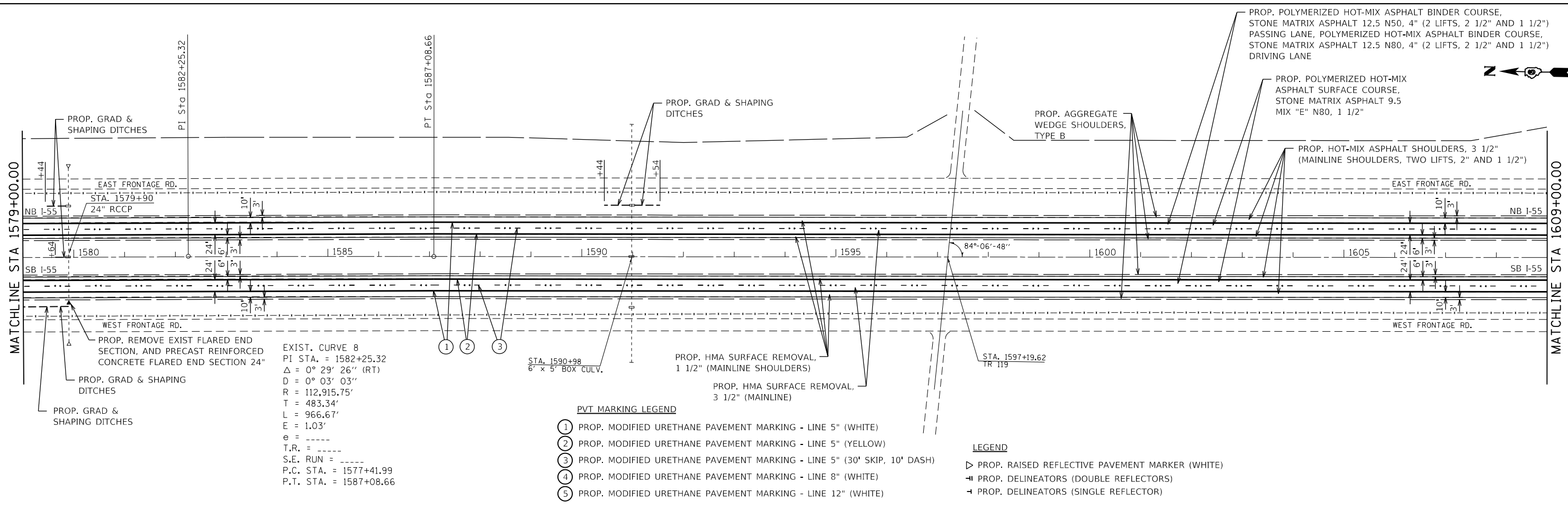

FILE NAME = p:\1\1dot-pw.bentley.com\PROJECTS\DOT Documents\DOT Offices\District 6\Projects\0672032\CAD\Drawings\0672032-sht-plan.dgn	USER NAME = Brian.Minder PLOT SCALE = 200.0000' / in. PLOT DATE = 8/26/2022	DESIGNED - EEK CHECKED - JM DATE -	REVISED - REVISED - REVISED - REVISED -	STATE OF ILLINOIS DEPARTMENT OF TRANSPORTATION	I-55 PLAN SHEETS		F.A.I. RTE. = 55	SECTION = (68-2)RS-6, (68-3)RS-4	COUNTY = MONTGOMERY	TOTAL SHEETS = 29	SHEET NO. = 22
					SCALE: 1" = 100' SHEET NO. OF SHEETS STA. 1579+00.00 TO STA. 1620+00.00		CONTRACT NO. 72032 ILLINOIS FED. AID PROJECT				



EXIST. CURVE 623
 PI STA. = 12+28.33
 $\Delta = 54^\circ 33' 58''$ (RT)
 $D = 7^\circ 28' 50''$
 $R = 765.93'$
 $T = 395.04'$
 $L = 729.44'$
 $E = 95.87'$
 $e = 8.00\%$
 T.R. = -----
 S.E. RUN = -----
 P.C. STA. = 8+33.29
 P.T. STA. = 15+62.73

PROP. HOT-MIX ASPHALT BINDER COURSE, IL-9.5FG, N70 1 1/4"

PROP. HOT-MIX ASPHALT SURFACE COURSE, IL-9.5 MIX "C", N70, 1 1/2"

PROP. HMA SURFACE REMOVAL, 2 3/4" RAMP AND HMA SURFACE REMOVAL, 1 1/2" RAMP SHOULDERS

PROP. AGGREGATE WEDGE SHOULDERS, TYPE B

MATCHLINE STA 10+00.00 RAMP D

EXIST. CURVE 622
 PI STA. = 4+19.02
 $\Delta = 44^\circ 00' 57''$ (LT)
 $D = 11^\circ 54' 22''$
 $R = 481.23'$
 $T = 194.51'$
 $L = 369.69'$
 $E = 37.82'$
 $e = 8.00\%$
 T.R. = -----
 S.E. RUN = -----
 P.C. STA. = 2+24.51
 P.T. STA. = 5+94.20

EXIST. CURVE 619
 PI STA. = 17+03.00
 $\Delta = 33^\circ 08' 52''$ (LT)
 $D = 12^\circ 02' 23''$
 $R = 475.89'$
 $T = 141.63'$
 $L = 275.32'$
 $E = 20.63'$
 $e = 8.00\%$
 T.R. = -----
 S.E. RUN = -----
 P.C. STA. = 15+61.37
 P.T. STA. = 18+36.69

EXIST. CURVE 618
 PI STA. = 10+16.00
 $\Delta = 49^\circ 46' 05''$ (RT)
 $D = 7^\circ 30' 42''$
 $R = 762.75'$
 $T = 353.80'$
 $L = 662.54'$
 $E = 78.06'$
 $e = 8.00\%$
 T.R. = -----
 S.E. RUN = -----
 P.C. STA. = 6+62.20
 P.T. STA. = 13+24.74

PROP. HMA SURFACE REMOVAL, 2 3/4" RAMP AND HMA SURFACE REMOVAL, 1 1/2" RAMP SHOULDERS

PROP. HOT-MIX ASPHALT BINDER COURSE, IL-9.5FG, N70 1 1/4"

PROP. HOT-MIX ASPHALT SURFACE COURSE, IL-9.5 MIX "C", N70, 1 1/2"

PROP. AGGREGATE WEDGE SHOULDERS, TYPE B

PROP. CLEAN EXIST END SECTION

PROP. HOT-MIX ASPHALT SHOULDERS, 1 1/2"

EXIST. CURVE 7
 PI STA. = 1482+70.11
 $\Delta = 1^\circ 09' 40''$ (LT)
 $D = 0^\circ 05' 58''$
 $R = 57,625.42'$
 $T = 583.91'$
 $L = 1,167.78'$
 $E = 2.96'$
 $e =$
 T.R. = -----
 S.E. RUN = -----
 P.C. STA. = 1476+86.20
 P.T. STA. = 1488+53.98

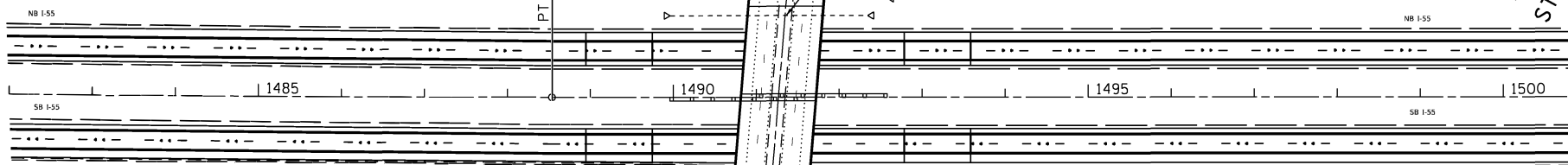

STA. 51+19
 36" PIPE CULV.

STA. 10+25
 24" RCCP

MATCHLINE STA 10+00.00 RAMP C

PROP. AGGREGATE WEDGE SHOULDERS, TYPE B

PROP. HOT-MIX ASPHALT SHOULDERS, 1 1/2"

PROP. HOT-MIX ASPHALT SURFACE COURSE, IL-9.5 MIX "C" N70, 1 1/2"

PROP. HOT-MIX ASPHALT BINDER COURSE, IL-9.5FG, N70 1 1/4"

EXIST. CURVE 624
 PI STA. = 10+18.94
 $\Delta = 50^\circ 07' 32''$ (RT)
 $D = 7^\circ 28' 45''$
 $R = 766.08'$
 $T = 358.25'$
 $L = 670.21'$
 $E = 79.63'$
 $e = 8.00\%$
 T.R. = -----
 S.E. RUN = -----
 P.C. STA. = 6+60.69
 P.T. STA. = 13+30.90

EXIST. CURVE 625
 PI STA. = 17+93.11
 $\Delta = 49^\circ 52' 22''$ (LT)
 $D = 11^\circ 58' 20''$
 $R = 478.57'$
 $T = 222.52'$
 $L = 416.57'$
 $E = 49.20'$
 $e = 8.00\%$
 T.R. = -----
 S.E. RUN = -----
 P.C. STA. = 15+70.60
 P.T. STA. = 19+87.17

EXIST. CURVE 628
 PI STA. = 5+28.77
 $\Delta = 60^\circ 58' 44''$ (LT)
 $D = 12^\circ 00' 48''$
 $R = 476.93'$
 $T = 280.82'$
 $L = 507.59'$
 $E = 76.53'$
 $e = 8.00\%$
 T.R. = -----
 S.E. RUN = -----
 P.C. STA. = 2+47.95
 P.T. STA. = 7+55.54

LEGEND

- ▷ PROP. RAISED REFLECTIVE PAVEMENT MARKER (WHITE)
- ≡ PROP. DELINEATORS (DOUBLE REFLECTORS)
- ≡ PROP. DELINEATORS (SINGLE REFLECTOR)

PVT MARKING LEGEND

- ① PROP. MODIFIED URETHANE PAVEMENT MARKING - LINE 5" (WHITE)
- ② PROP. MODIFIED URETHANE PAVEMENT MARKING - LINE 5" (YELLOW)
- ③ PROP. MODIFIED URETHANE PAVEMENT MARKING - LINE 5" (30' SKIP, 10' DASH)
- ④ PROP. MODIFIED URETHANE PAVEMENT MARKING - LINE 8" (WHITE)
- ⑤ PROP. MODIFIED URETHANE PAVEMENT MARKING - LINE 12" (WHITE)
- ⑥ PROP. MODIFIED URETHANE PAVEMENT MARKING - LINE 24" (WHITE)
- ⑦ PROP. MODIFIED URETHANE PAVEMENT MARKING - LETTERS AND SYMBOLS (WHITE)

MATCHLINE STA 10+00.00 RAMP B

PROP. AGGREGATE WEDGE SHOULDERS, TYPE B

PROP. HOT-MIX ASPHALT SHOULDERS, 1 1/2"

PROP. HOT-MIX ASPHALT SURFACE COURSE, IL-9.5 MIX "C", N70, 1 1/2"

PROP. HOT-MIX ASPHALT BINDER COURSE, IL-9.5FG, N70 1 1/4"

EXIST. CURVE 629
 PI STA. = 13+95.56
 $\Delta = 55^\circ 22' 33''$ (RT)
 $D = 7^\circ 30' 20''$
 $R = 763.38'$
 $T = 400.58'$
 $L = 737.80'$
 $E = 98.72'$
 $e = 8.00\%$
 T.R. = -----
 S.E. RUN = -----
 P.C. STA. = 9+94.98
 P.T. STA. = 17+32.78

PROP. HMA SURFACE REMOVAL, 2 3/4" RAMP AND HMA SURFACE REMOVAL, 1 1/2" RAMP SHOULDERS

**STATE OF ILLINOIS
 DEPARTMENT OF TRANSPORTATION**

I-55 PLAN SHEETS

FILE NAME =	USER NAME = Brian.Minder	DESIGNED -	REVISED -	SCALE: 1" = 100'	SHEET OF SHEETS STA. TO STA.	F.A.I. RTE.	SECTION	COUNTY	TOTAL SHEETS	SHEET NO.	
pw:\idot-pw.bentley.com\PI\DOT\Documents\IDOT Offices\District 6\Projects\0672032\CDRAWN\Drawings\0672032-sht-plan.dgn		REVISOR -	REVISION -			55	(68-2)RS-6, (68-3)RS-4	MONTGOMERY	29	23	
PLOT SCALE = 200.0000' / in.	CHECKED -	REVISOR -	REVISION -			CONTRACT NO. 72032					
Default	DATE -	REVISOR -	REVISION -			ILLINOIS FED. AID PROJECT					

REV. - MS

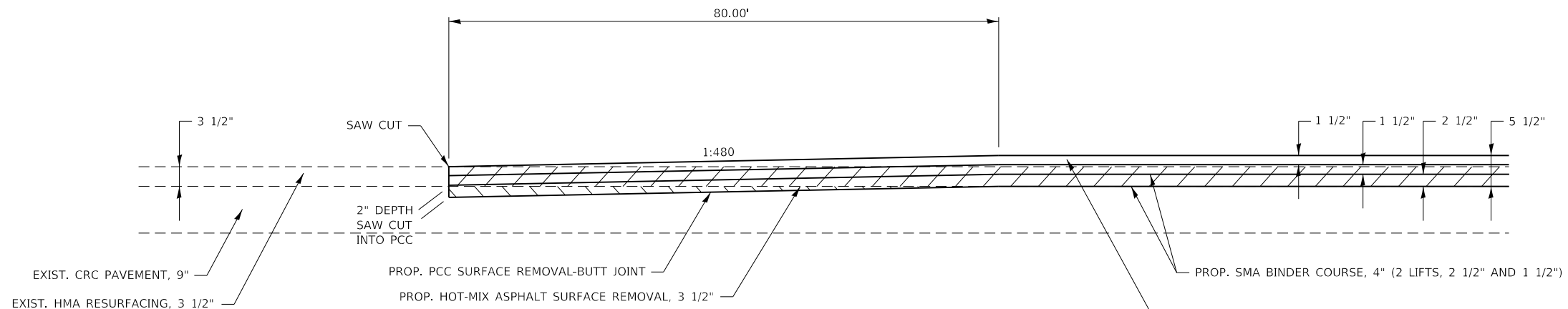

DETAIL BEGINNING OF RESURFACING, MAINLINE

STA. 1353+20.00 TO STA. 1354+00.00 NB AND SB I-55
 STA. 24+31.90 TO STA. 25+11.90 ENTRANCE RAMP FOR REST AREA SB I-55
 STA. 24+31.90 TO STA. 25+11.90 ENTRANCE RAMP FOR REST AREA NB I-55

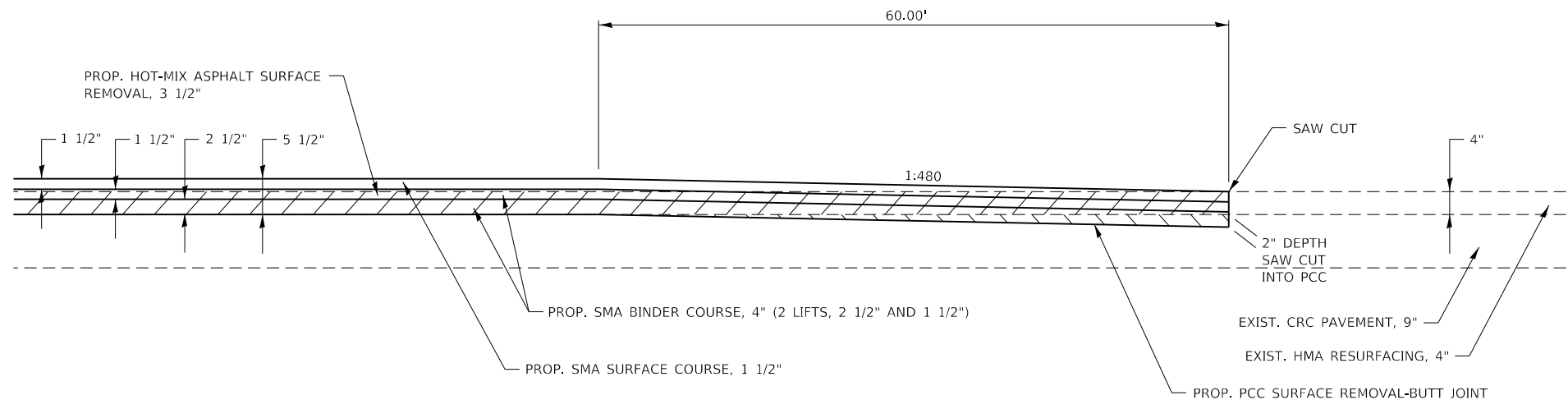

DETAIL END OF RESURFACING, MAINLINE

STA. 1620+00.00 TO STA. 1620+60.00 NB AND SB I-55
 STA. 5+82.40 TO STA. 6+62.40 EXIT RAMP FOR REST AREA SB I-55
 STA. 5+82.40 TO STA. 6+62.40 EXIT RAMP FOR REST AREA NB I-55

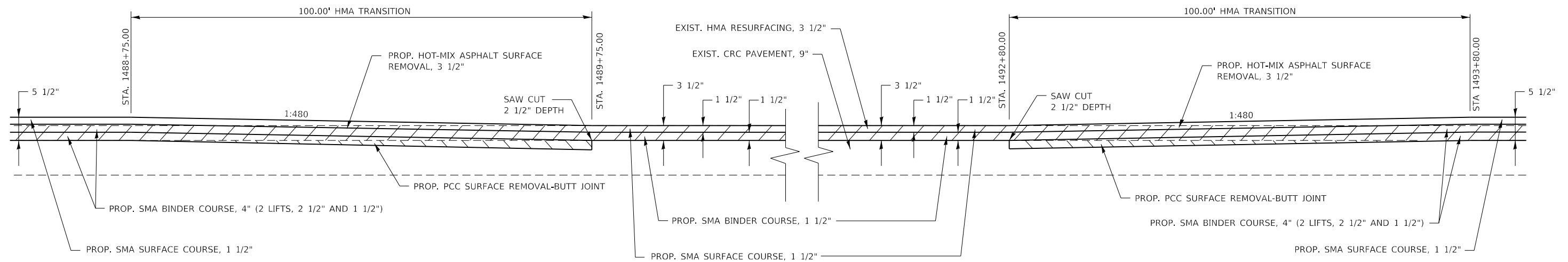

DETAIL MAINLINE UNDER BRIDGE AT IL 48 INTERCHANGE

STA. 1488+75.00 TO STA. 1493+80.00 NB AND SB I-55

FILE NAME =	USER NAME = Brian.Minder	DESIGNED -	REVISED -
p:\11dot-pw.bentley.com\PWIDOT\Documents\IDOT Offices\District 6\Projects\0672032\CAD\Drawings\Drawings\0672032 sht-details.dgn		CHECKED -	REVISED -
Default	PLOT DATE = 8/26/2022	DATE -	REVISED -

**STATE OF ILLINOIS
 DEPARTMENT OF TRANSPORTATION**

HMA TRANSITION DETAILS

SCALE: NTS SHEET 1 OF 1 SHEETS STA. TO STA.

F.A.I. RTE.	SECTION	COUNTY	TOTAL SHEETS	SHEET NO.
55	(68-2)RS-6, (68-3)RS-4	MONTGOMERY	29	24
CONTRACT NO. 72032				
ILLINOIS FED. AID PROJECT				

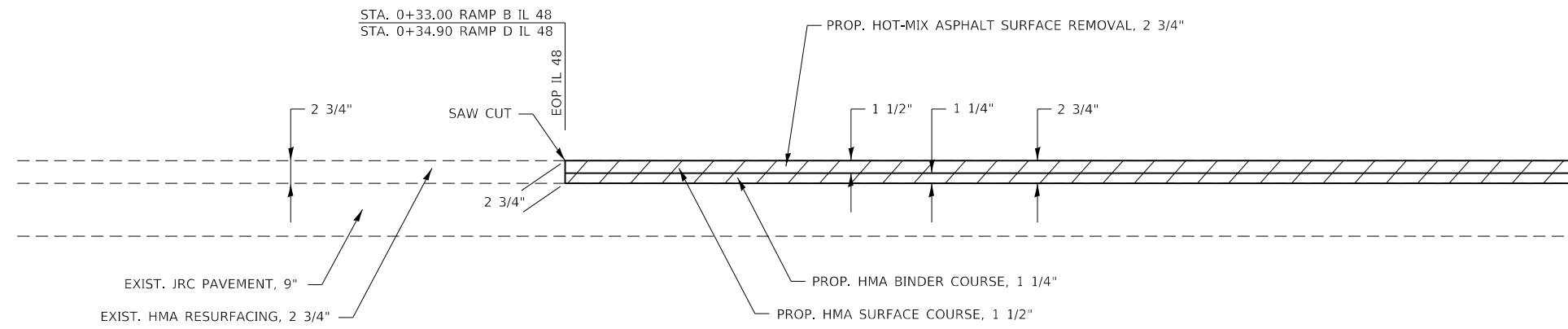

DETAIL RAMP PVT. BEGINNING OF RESURFACING

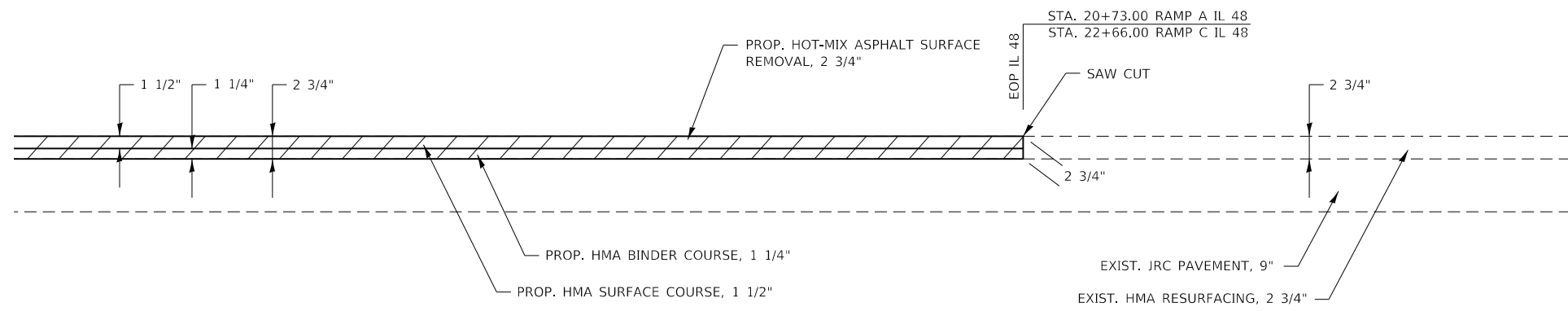

DETAIL RAMP PVT. END OF RESURFACING

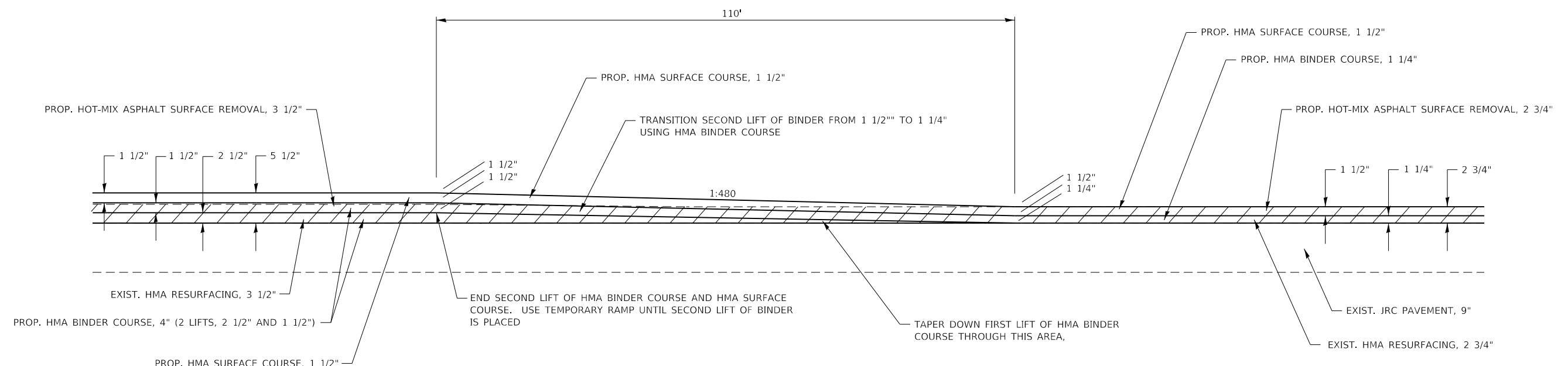

HMA TRANSITION 5 1/2" RESURFACING MAINLINE TO 2 3/4" RESURFACING RAMP

5+62 TO 6+72 RAMP A IL 48
 15+09 TO 16+19 RAMP B IL 48
 6+00 TO 7+10 RAMP C IL 48
 13+26 TO 14+36 RAMP D IL 38

FILE NAME =	USER NAME = Brian.Minder	DESIGNED -	REVISED -	STATE OF ILLINOIS DEPARTMENT OF TRANSPORTATION	HMA TRANSITION DETAILS			F.A.I. RTE.	SECTION	COUNTY	TOTAL SHEETS	SHEET NO.	
Default	\\idot-pw.bentley.com\idot\Documents\IDOT Offices\District 6\Projects\0672032\CAD\Drawings\0672032 sht-details.dgn	CHECKED -	REVISED -		SCALE: NTS	SHEET 1	OF 1 SHEETS	STA.	TO STA.	55	(68-2)RS-6, (68-3)RS-4	MONTGOMERY	29 25
	PLOT SCALE = 20.0000' / in.	DATE -	REVISED -		CONTRACT NO. 72032								
	PLOT DATE = 8/26/2022				ILLINOIS FED. AID PROJECT								

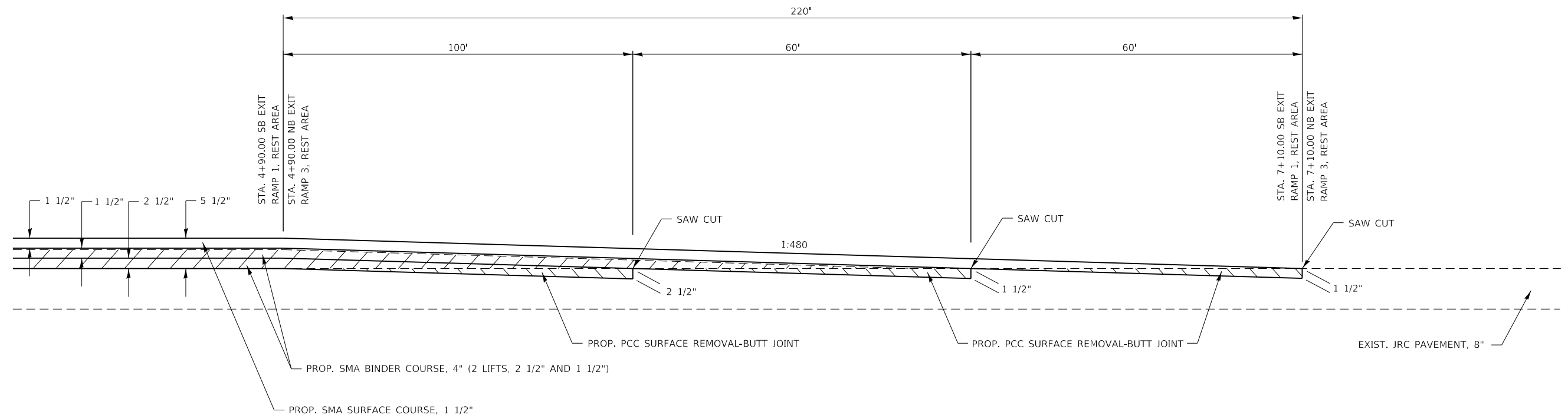

HMA TRANSITION 5 1/2" RESURFACING MAINLINE TO 0" RESURFACING REST AREAS EXIT RAMP

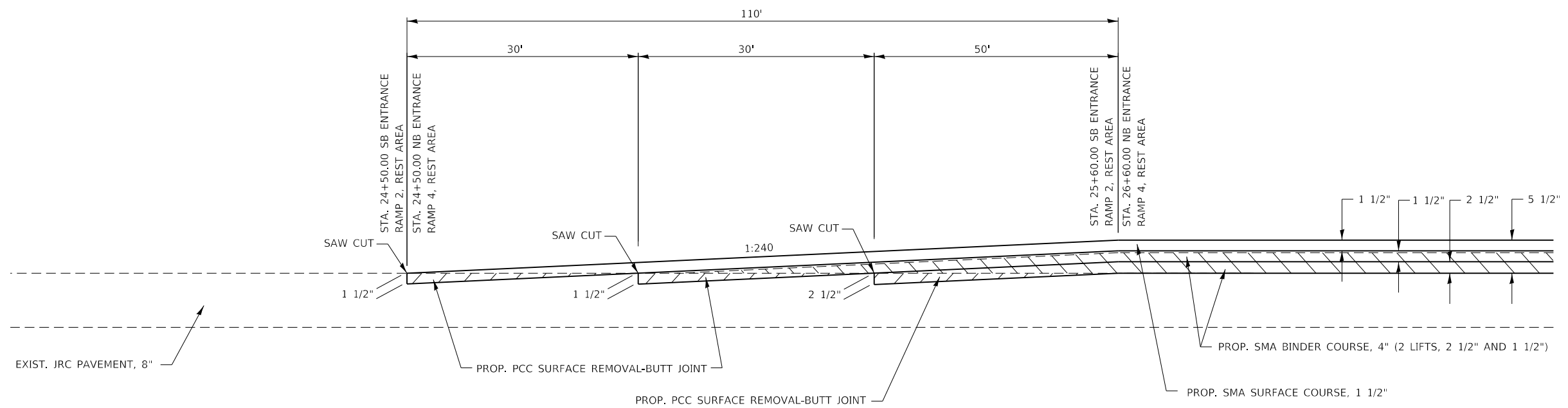

HMA TRANSITION 0" RESURFACING REST AREA ENTRANCE RAMP TO 5 1/2" RESURFACING MAINLINE

FILE NAME =	USER NAME = Brian.Minder	DESIGNED -	REVISED -	STATE OF ILLINOIS DEPARTMENT OF TRANSPORTATION	HMA TRANSITION DETAILS			F.A.I. RTE.	SECTION	COUNTY	TOTAL SHEETS	SHEET NO.
p:\dot-pw.bentley.com\PWIDOT\Documents\IDOT Offices\District 6\Projects\D672032\CAD\Drawings\Drawings\0672032 sht-details.dgn	PLOT SCALE = 20.0000' / in.	CHECKED -	REVISED -					55	(68-2)RS-6, (68-3)RS-4	MONTGOMERY	29	26
Default	PLOT DATE = 8/26/2022	DATE -	REVISED -		SCALE: NTS SHEET 1 OF 1 SHEETS STA. TO STA.			CONTRACT NO. 72032				
ILLINOIS FED. AID PROJECT												

EMERGENCY MEDIAN CROSSOVERS

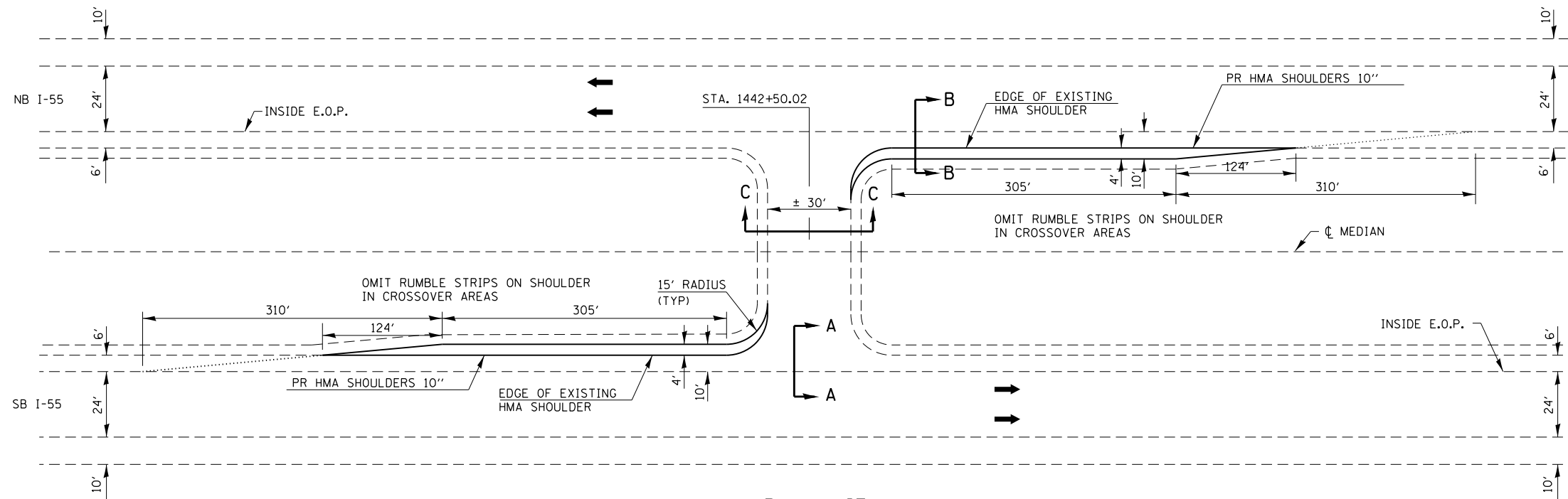

PLAN VIEW

STA. 1442+50.00
STA. 1544+00.00

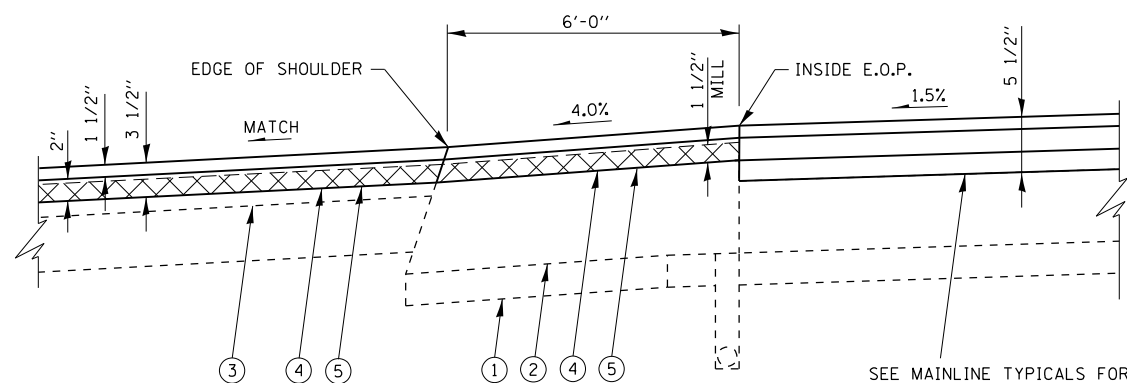

SECTION A - A

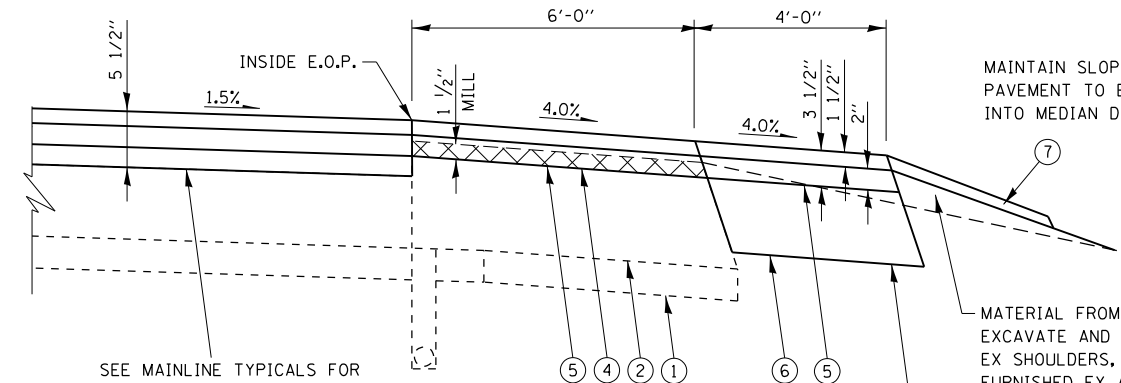

SECTION B - B

MAINTAIN SLOPES AWAY FROM MAINLINE PAVEMENT TO ENSURE PROPER DRAINAGE INTO MEDIAN DITCHES.

MATERIAL FROM EXCAVATE AND GRADE EX SHOULDERS, AND FURNISHED EX AS NEEDED.

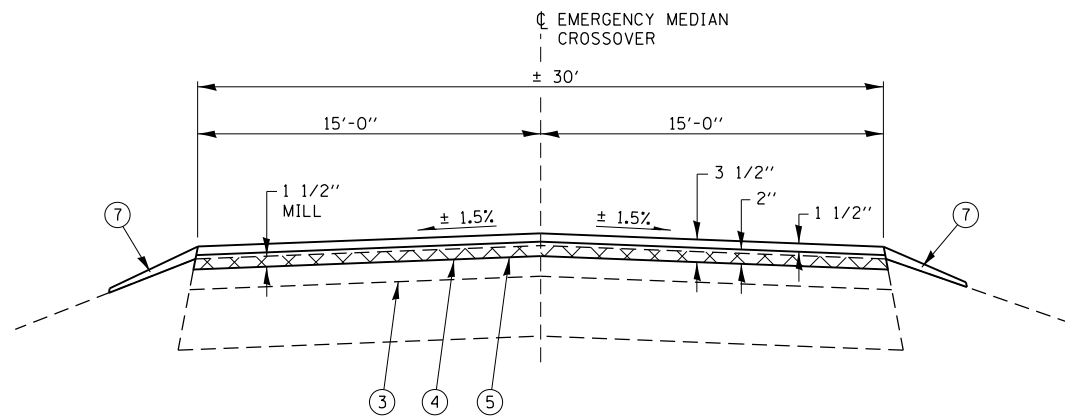

SECTION C - C

LEGEND	
①	EX SUBBASE GRANULAR MATERIAL, 4"
②	EX HOT-MIX ASPHALT SHOULDERS, 1 1/2"
③	EX HOT-MIX ASPHALT OVERLAY
④	PR HOT-MIX ASPHALT SURFACE REMOVAL, 1 1/2"
⑤	PR HOT-MIX ASPHALT SHOULDERS 3 1/2"
⑥	PR HOT-MIX ASPHALT SHOULDERS 10"
⑦	PR AGGR WEDGE SHOULDERS

NOTES:

TWO DELINEATORS SHALL BE PLACED IN ADVANCE OF THE MEDIAN CROSSOVERS. ONE SHALL BE AT THE CROSSOVER, THE OTHER 800 FT IN ADVANCE OF THE FIRST. THE DELINEATOR AT THE CROSSOVER SHALL HAVE TWO REFLECTORS, AND THE DELINEATOR 800 FT IN ADVANCE SHALL HAVE THREE REFLECTORS

FILE NAME =	USER NAME = Brian.Minder	DESIGNED -	REVISED -	STATE OF ILLINOIS DEPARTMENT OF TRANSPORTATION	EMERGENCY MEDIAN CROSSOVER DETAILS			F.A.I. RTE.	SECTION	COUNTY	TOTAL SHEETS	SHEET NO.		
Default	p:\dot-pw\bentley.com\PWIDOT\Documents\DOT Offices\District 6\Projects\D672032\CADD\Drawings\Drawings\0672032 sht-details.dgn	CHECKED -	REVISED -		SCALE: NTS	SHEET 1	OF 1 SHEETS	STA.	TO STA.	55	(68-2)RS-6, (68-3)RS-4	MONTGOMERY	29	27
	PLOT SCALE = 20.0000' / in.	DATE -	REVISED -								CONTRACT NO. 72032			
	PLOT DATE = 8/26/2022										ILLINOIS FED. AID PROJECT			

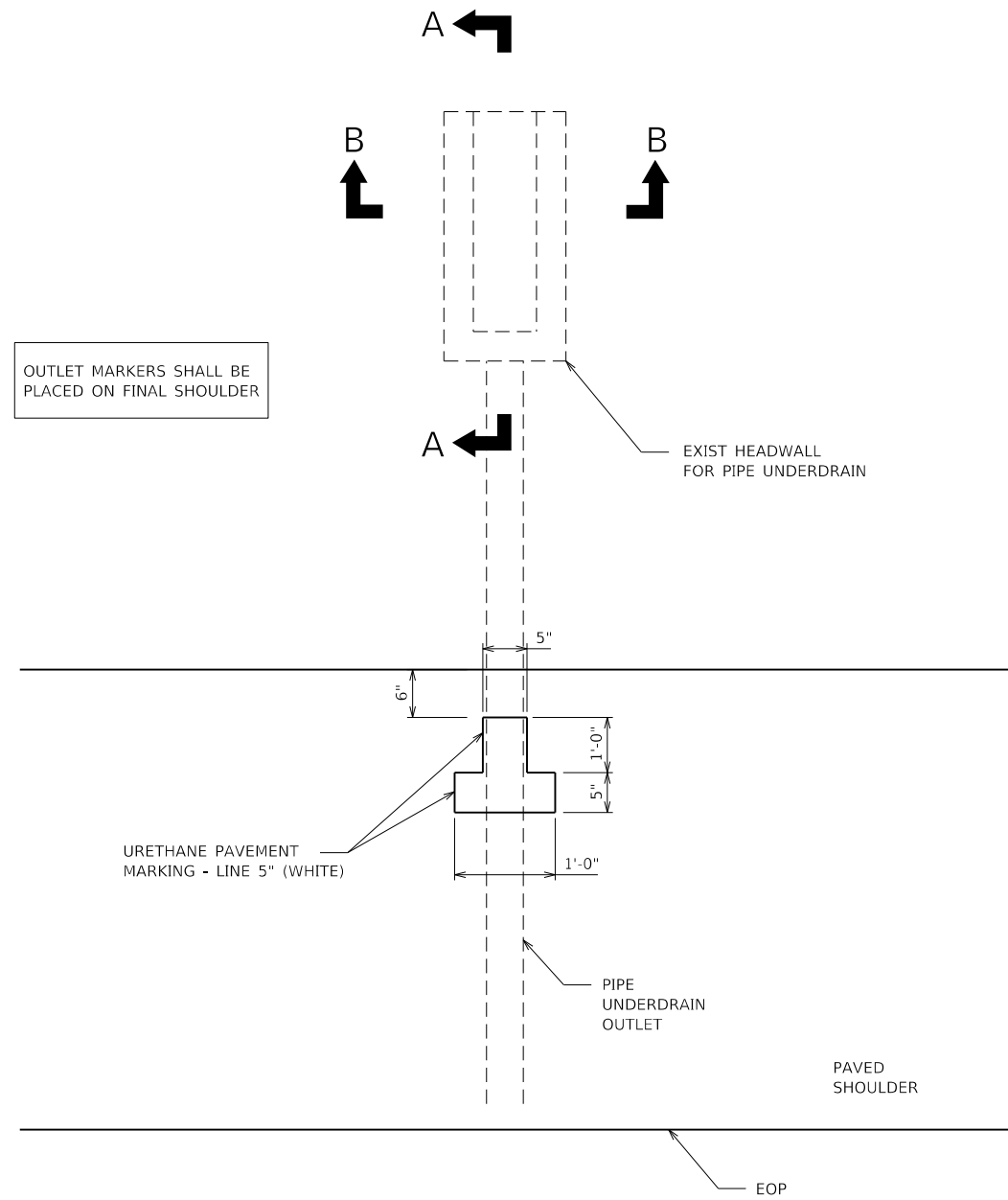

TYPICAL PIPE UNDERDRAIN MARKER DETAIL

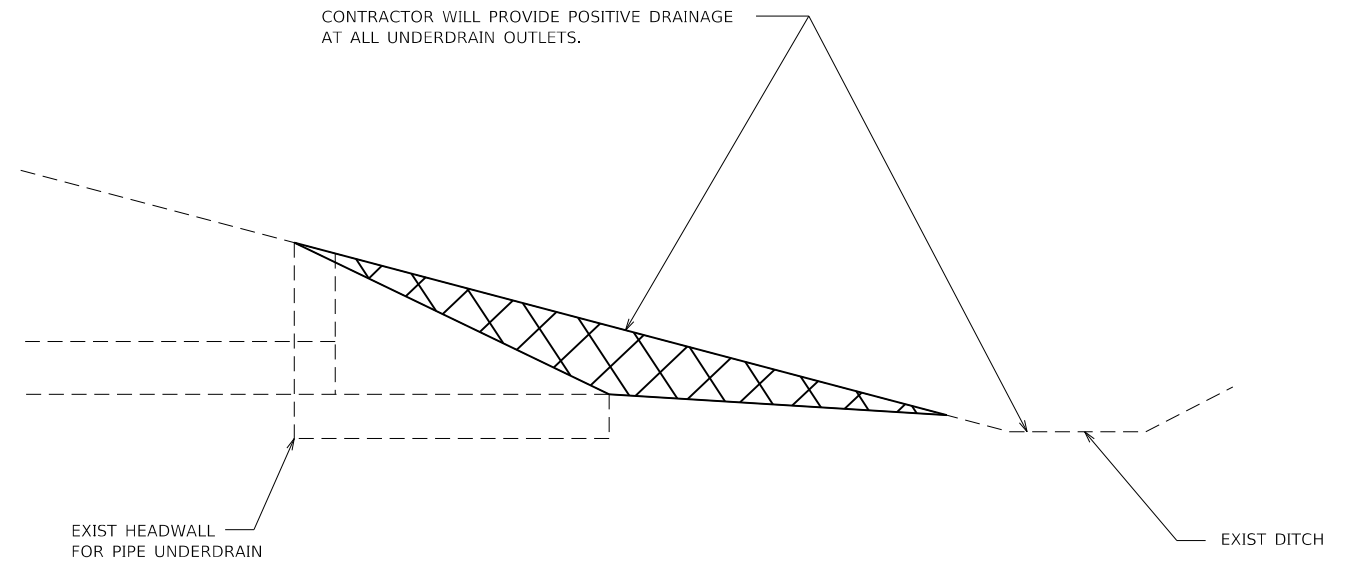

SECTION A-A

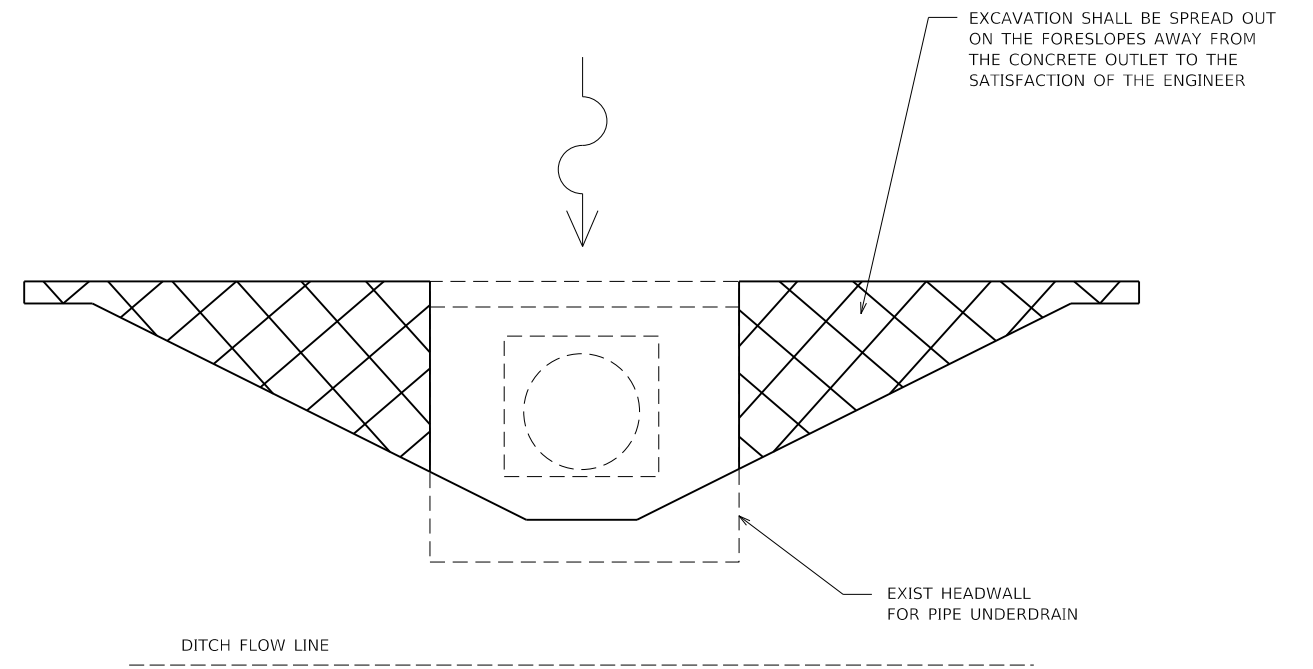

SECTION B-B

FILE NAME =	USER NAME = Brian.Minder	DESIGNED -	REVISED -
p:\dot\pw\entley.com\PIDOT\Documents\IDOT Offices\District 6\Projects\0672032\CAD\Drawings\Drawings\0672032 sht-details.dgn		DRAWN -	REVISED -
Default	PLOT SCALE = 20.0000' / in.	CHECKED -	REVISED -
	PLOT DATE = 8/26/2022	DATE -	REVISED -

STATE OF ILLINOIS
DEPARTMENT OF TRANSPORTATION

OUTLET MARKER DETAIL

SCALE: NTS SHEET 1 OF 1 SHEETS STA. TO STA.

F.A.I. RTE.	SECTION	COUNTY	TOTAL SHEETS	SHEET NO.
55	(68-2)RS-6, (68-3)RS-4	MONTGOMERY	29	28
CONTRACT NO. 72032				
ILLINOIS FED. AID PROJECT				

PR EROSION CONTROL BLANKET

PR CONC APRON

EX CONC APRON

A

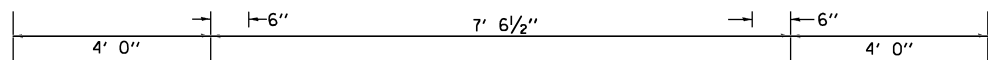
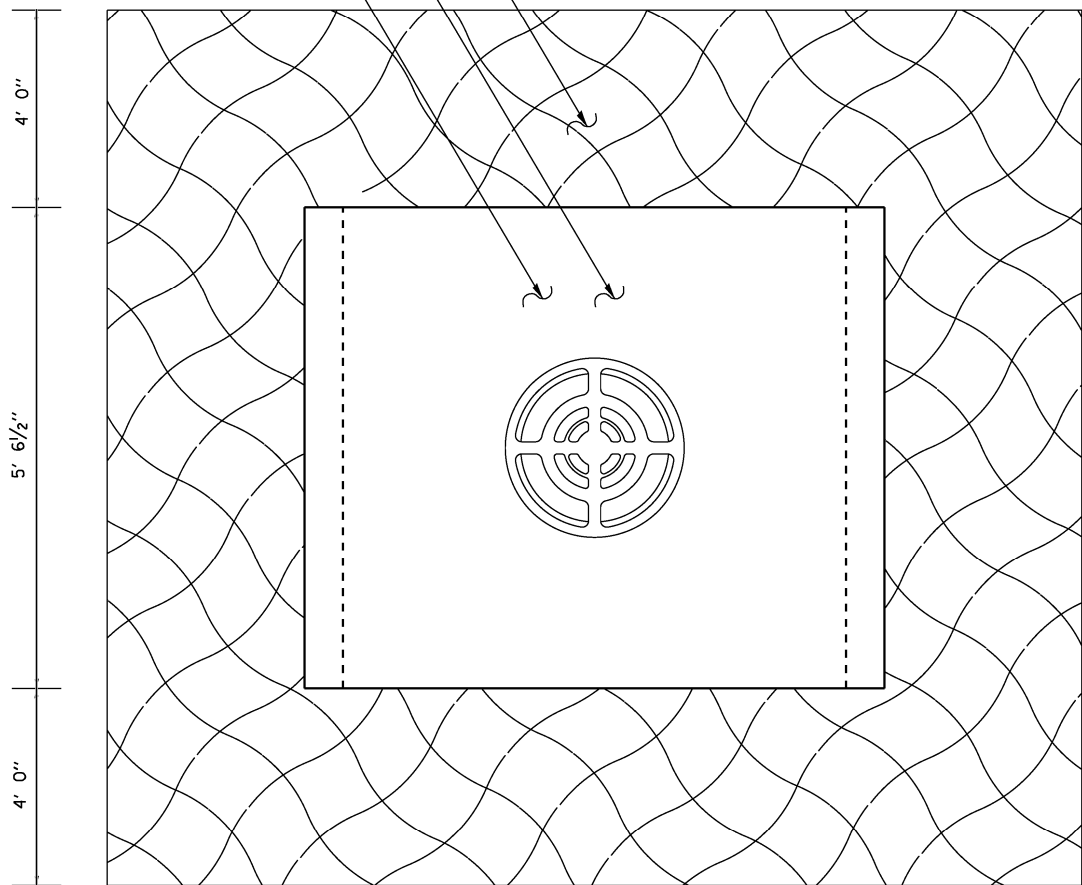

A

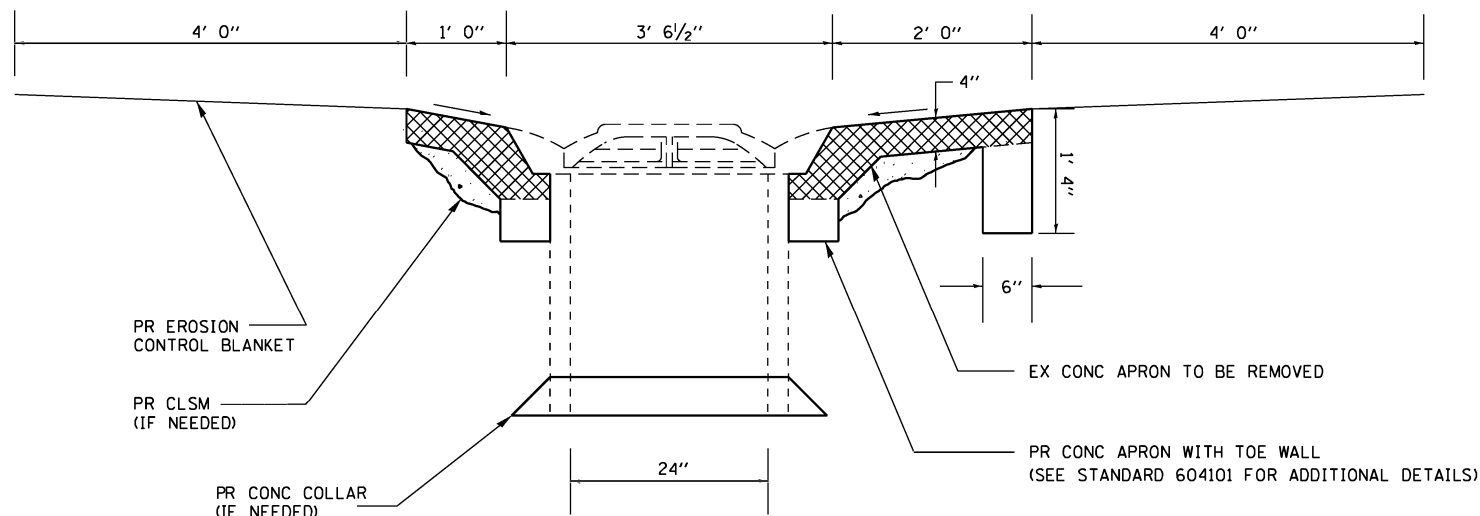

SECTION A-A

REPAIRS TO INLET STANDARD 2250

LOCATION	INLET TO BE RECONSTRUCTED WITH SALVAGED FRAME AND GRATE (EACH)	EROSION CONTROL BLANKET (SQ YD)	CONTROLLED LOW STRENGTH MATERIAL (CU YD)	CONCRETE COLLAR (CU YD)
RT STA 1363+78	1	18.7	1.5	0.2

NOTES:

- 1) SEE STANDARD 604101 FOR ADDITIONAL DETAILS NOT SHOWN. THE TOE WALL AT THE LONG END OF THE APRON IS IN ADDITION TO WHAT IS SHOWN IN STANDARD 604101.
- 2) CONTROLLED LOW STRENGTH MATERIAL AND/OR CONCRETE COLLAR TO BE USED IF DEEMED NECESSARY BY THE ENGINEER, THE QUANTITY IN THE ABOVE SCHEDULE IS ESTIMATED. ACTUAL QUANTITY TO BE DETERMINED BY THE ENGINEER IN THE FIELD.

REV. - MS

FILE NAME =	USER NAME = Brian.Minder	DESIGNED -	REVISED -	STATE OF ILLINOIS DEPARTMENT OF TRANSPORTATION	INLETS TO BE RECONSTRUCTED DETAIL		F.A.I. RTE.	SECTION	COUNTY	TOTAL SHEETS	SHEET NO.
pw:\idot-pw.bentley.com\PI\DOT\Documents\IDOT Offices\District 6\Projects\0672032\CAD\DRAWINGS\Details\0672032_sht-details.dgn	PLLOT SCALE = 20.0000' / in.	CHECKED -	REVISED -				55		MONTGOMERY	29	29
Default	PLLOT DATE = 8/26/2022	DATE -	REVISED -		SCALE: NTS		SHEET 1 OF 1 SHEETS		STA. TO STA.	CONTRACT NO. 72032	
					ILLINOIS FED. AID PROJECT						