

SHEET PILING AND ANCHOR DETAIL

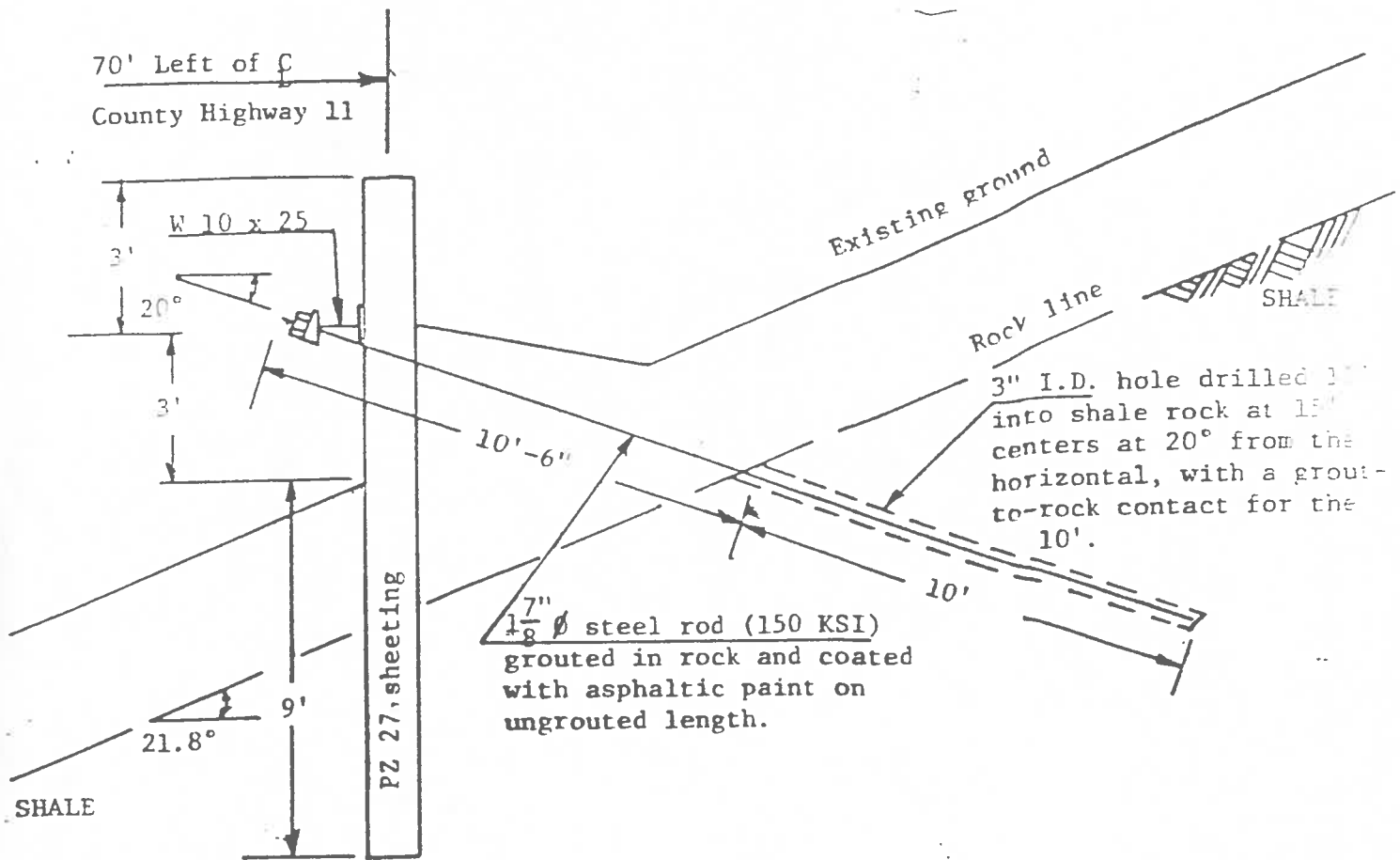

UNDERDRAIN DETAIL

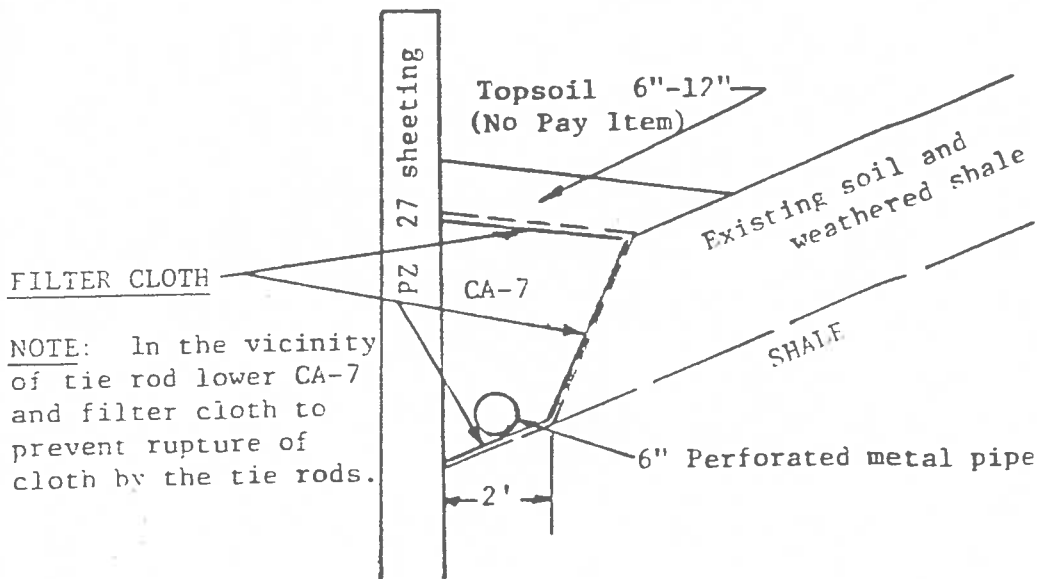

NOTE: In the vicinity of tie rod lower CA-7 and filter cloth to prevent rupture of cloth by the tie rods.

The following data was secured by hand augers or power-driven flight augers as requested to supplement that furnished on July 21, 1981:

<u>Location & Elevation</u>	<u>Data</u>
Station 71'L, 43+00, 596.3	0-4.5' Depth Gray Silty Clay 4.5-10.0' Tan Silty Clay Loam (Probable weathered Shale) (Hard Drilling) 10-17.5' Tan Shale (Auger Refusal) 17.5-21.0' Gray Shale
Station 71'L, 43+55, 597.9	0-2.5' Depth Gray Silty Clay 2.5-5.5' Tan Silty Clay Loam (Probable weathered Shale) (Hard Drilling) 5.5-11.0' Gray Shale (Auger Refusal) 11.0-14.0' Tan to Brown Shale
Station 73'L, 44+00, 600.8	0-3.0' Gray Silty Clay 3.0-7.0' Brown Silty Clay Loam (Probable weathered Shale) (Hard Drilling) 7.0-13.0' Tan Shale (Auger Refusal) 13.0-16.0' Gray Shale
Station 75'L, 44+50, 600.4	0-1.0' Gray Silty Clay 1.0-7.0' Shale & Clay Brown (Weathered Shale) (Hard Drilling) 7.0-12.0' Tan Shale (Auger Refusal) 12.0-16.0' Gray Shale
Station 73'L, 45+00, 600.9	(Hand Auger) 0-1.5' Gray Silty Clay 1.5-3.5' Tan Silty Clay Loam (Weathered Shale) 3.5-4.0' Hard Gray Shale
Station 74'L, 45+50, 600.9	(Hand Auger) 0-2.0' Gray Silty Clay 2.0-4.0' Tan to Brown Silty Clay (Weathered Shale) 4.0-5.0' Tan Hard Shale
Station 73'L, 45+00, 603.4	(Hand Auger) 0-2.0' Tan to Gray Silty Clay 2.0-3.0' Hard Gray Shale

STANDARD DESIGN PAVED DITCH

PAVED DITCH TYPE "A"

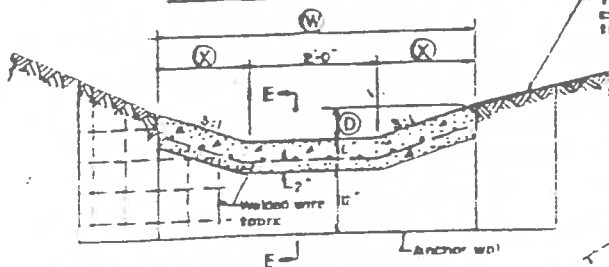

CROSS SECTION.

Table for Paved Ditch Type "A"

TYPE	(D)	(W)	(E)	Area ²
A-6	6"	5'-0"	1'-0"	1.75
A-9	9"	6'-6"	2'-3"	3.15
A-12	12"	8'-0"	3'-0"	5.00
A-15	15"	9'-6"	3'-9"	7.15
A-18	18"	11'-0"	4'-6"	9.75
A-21	21"	12'-6"	5'-3"	12.65
A-24	24"	14'-0"	6'-0"	16.00

PAVED DITCH TYPE "B"

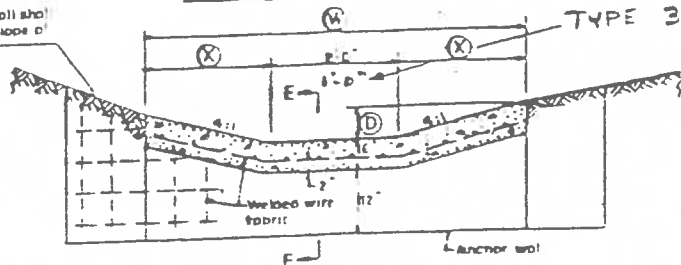

CROSS SECTION.

Table for Paved Ditch Type "B"

TYPE	(D)	(W)	(E)	Area ²
B-6	6"	6'-0"	2'-0"	2.00
B-9	9"	6'-0"	3'-0"	3.75
B-12	12"	10'-0"	4'-0"	6.00
B-15	15"	12'-0"	5'-0"	8.75
B-18	18"	14'-0"	6'-0"	12.00
B-21	21"	16'-0"	7'-0"	15.75
B-24	24"	18'-0"	8'-0"	20.00
3	6"	3'-0"	1'-0"	

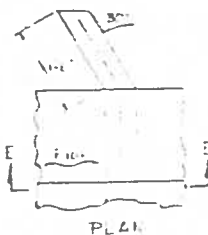

PLAN

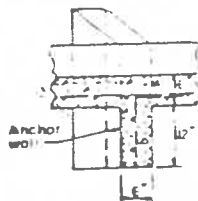

SECTION E-E
DETAIL OF ANCHOR WALL

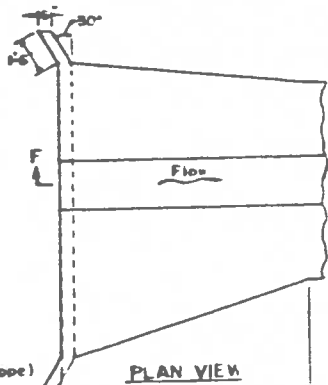

PLAN VIEW

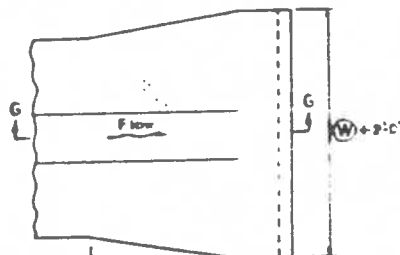

PLAN VIEW

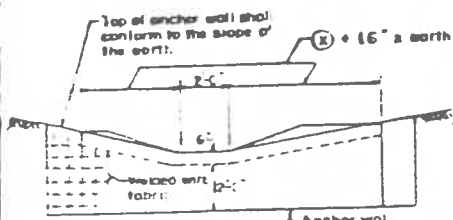

END VIEW

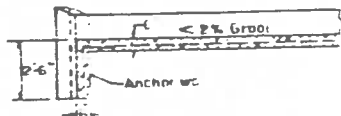

SECTION F-F

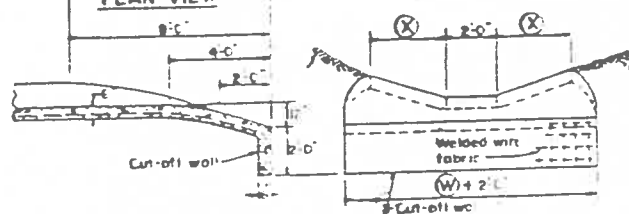

END VIEW

SECTION G-G
DETAIL OF DOWNSTREAM END

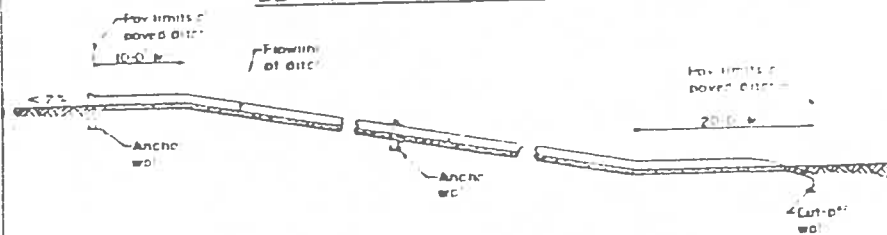

LOCATION AND LIMITS OF PAVED DITCH

NOTES

- Class X Concrete shall be used throughout.
- Welded wire fabric shall be 6" x 6" mesh, #4 gage, 58 lbs per 100 sq ft., conforming to the requirements of AASHTO W-51.
- 1/2 inch pre-molded joint filler shall be placed at the junction of paved ditch with any other structure.
- Anchor walls shall be spaced at not more than 50 foot intervals.
- Anchor walls and cut-off wall shall be constructed monolithically with the paved ditch.
- At the option of the Contractor, #3 reinforcing bars placed at 12 inch centers longitudinally in paved ditch and vertically in anchor and cut-off walls may be used in lieu of the welded wire fabric.
- The cost of furnishing and placing the joint filler and the welded wire fabric or the #3 reinforcing bars will be considered incidental to the cost of the paved ditch.

STATE OF ILLINOIS DEPARTMENT OF TRANSPORTATION		ISSUED 8-1-68	
		REVISIONS	
PASSED	AUG 25 1976	W.F.	13-18-70
APPROVED		D.W.K.	2-1-74
		D.W.W.	8-25-76