

LOCATION NO. 9: SN 022-0143  
IL 59 OVER RR - UP & CN  
CITY OF WEST CHICAGO

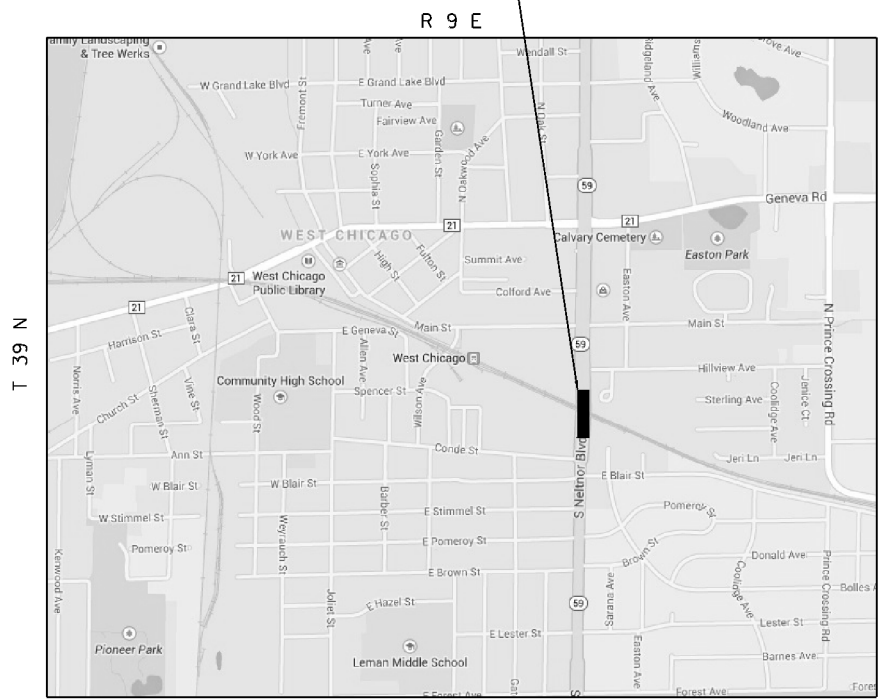

WINFIELD TOWNSHIP

LOCATION NO. 11: SN 022-0158  
IL 64 OVER SALT CREEK  
VILLAGE OF VILLA PARK

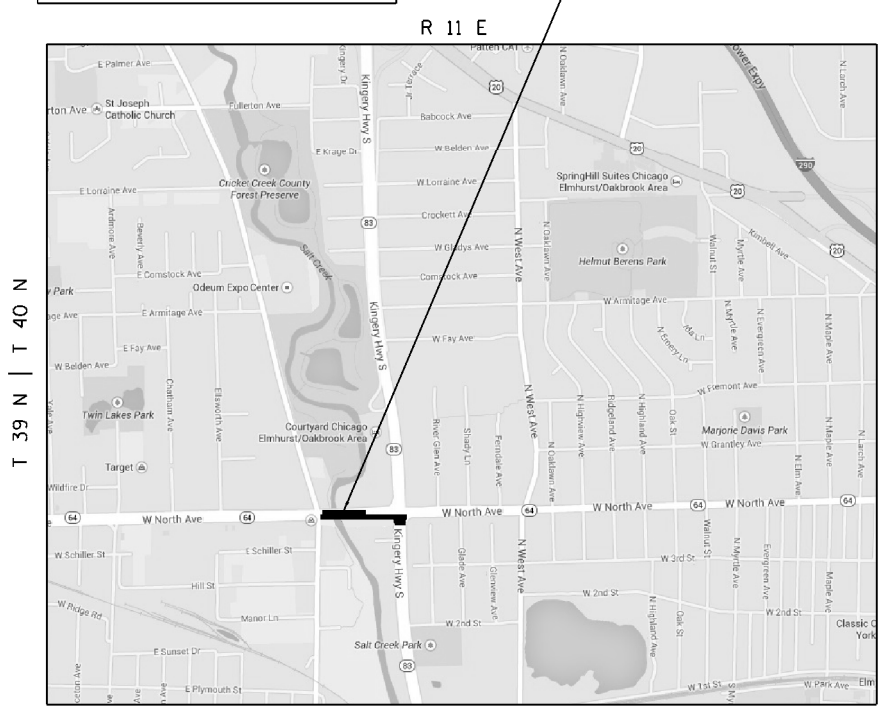

YORK TOWNSHIP

LOCATION NO. 10: SN 022-0147  
IL 19 OVER SALT CREEK  
CITY OF WOOD DALE

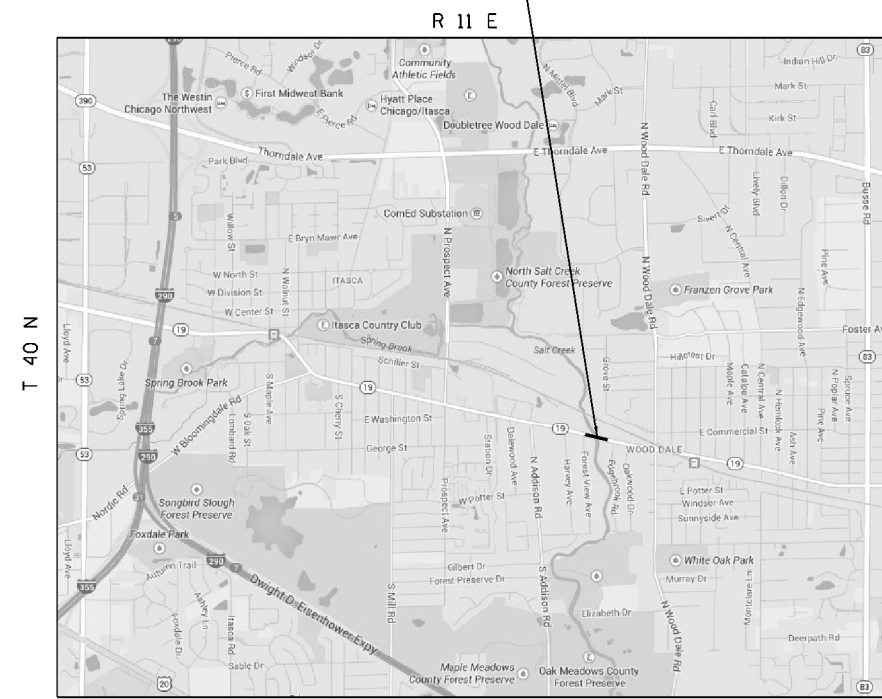

ADDISON TOWNSHIP

LOCATION NO. 12: SN 022-0160  
IL 64 OVER E BR DU PAGE RIVER  
VILLAGE OF GLEN ELLYN

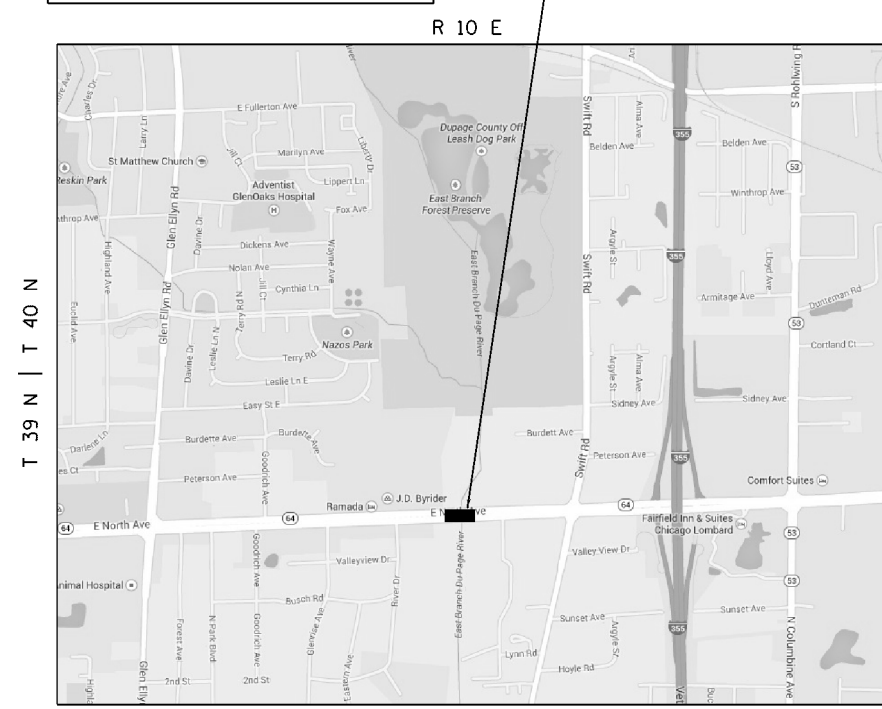

MILTON TOWNSHIP

**TRAFFIC DATA**

LOCATION NO. 9: IL 59 OVER RR - UP & CN  
2013 ADT = 37700  
SPEED LIMIT = 35 MPH

LOCATION NO. 10: IL 19 OVER SALT CREEK  
2013 ADT = 26200  
SPEED LIMIT = 35 MPH

LOCATION NO. 11: IL 64 OVER SALT CREEK  
2013 ADT = 41600  
SPEED LIMIT = 35 MPH

LOCATION NO. 12: IL 64 OVER E BR DU PAGE RIVER  
2013 ADT = 30750  
SPEED LIMIT = 45 MPH

FILE NAME =	USER NAME = rozeqm	DESIGNED -	REVISED -
Default	Default	DRAWN -	REVISED -
		CHECKED -	REVISED -
		DATE -	REVISED -

**STATE OF ILLINOIS  
DEPARTMENT OF TRANSPORTATION**

**LOCATION MAPS  
LOCATION NUMBERS 9 - 12**

SCALE: SHEET 3 OF 6 SHEETS STA. TO STA.

F.A.	SECTION	COUNTY	TOTAL SHEETS	SHEET NO.
VARIOUS	2014-0381	DUPAGE	33	7
			CONTRACT NO. 60Y32	
ILLINOIS FED. AID PROJECT				