

STATE OF ILLINOIS
DEPARTMENT OF TRANSPORTATION
DIVISION OF HIGHWAYS

PROPOSED
HIGHWAY PLANS

Loc 1) F.A.P. ROUTE 559: IL 58 (GOLF RD.)
OVER SALT CREEK
Loc 2) F.A.P. ROUTE 374: IL 21 (MILWAUKEE AVE.)
OVER RR-UP
SECTION 2014-049I
BRIDGE JOINT REPAIR
COOK COUNTY

F.A.P. RTE.	SECTION	COUNTY	TOTAL SHEETS	SHEET NO.
201559 201574	2014-049I	COOK	9	1
ILLINOIS CONTRACT NO. 60Y63				

D-91-441-14



LOCATION OF SECTION INDICATED THUS: —

FOR INDEX OF SHEETS, SEE SHEET NO. 2

IMPROVEMENTS ARE LOCATED IN THE
VILLAGES OF ROLLING MEADOWS AND
GLENVIEW

TRAFFIC DATA

IL 21
2013 ADT = 31,700
SPEED LIMIT = 45 MPH

IL 58
2013 ADT = 33,100
SPEED LIMIT = 45 MPH

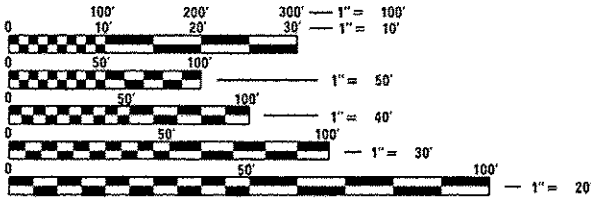

FULL SIZE PLANS HAVE BEEN PREPARED USING STANDARD
ENGINEERING SCALES. REDUCED SIZED PLANS WILL NOT
CONFORM TO STANDARD SCALES. IN MAKING MEASUREMENTS
ON REDUCED PLANS, THE ABOVE SCALES MAY BE USED.

J.U.L.I.E.
JOINT UTILITY LOCATION INFORMATION FOR EXCAVATION
1-800-892-0123
OR 811

PROJECT ENGINEER: J. ALAIN MIDY (847) 221-3056
PROJECT MANAGER: ISSAM RYAN

CONTRACT NO. 60Y63

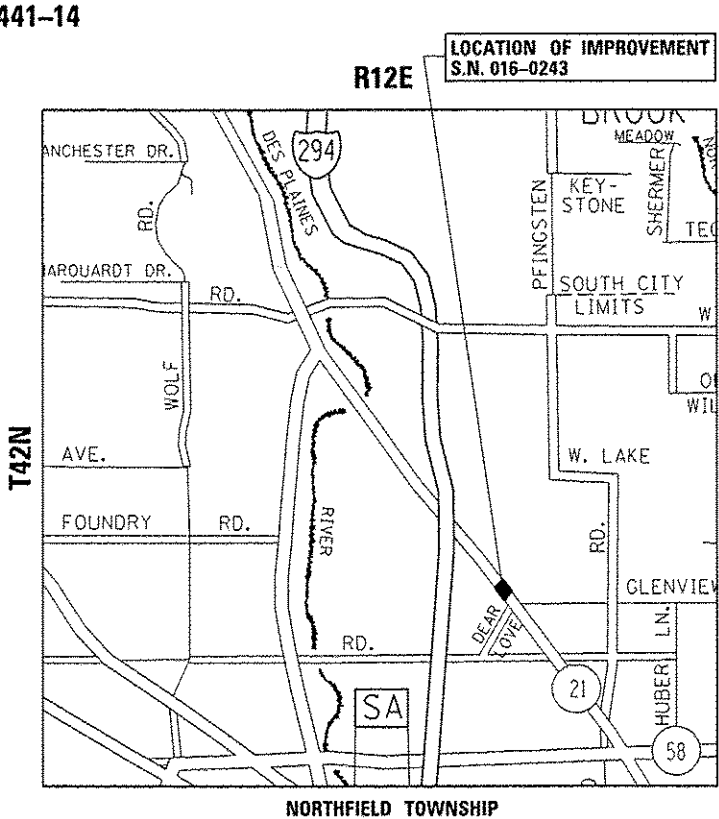
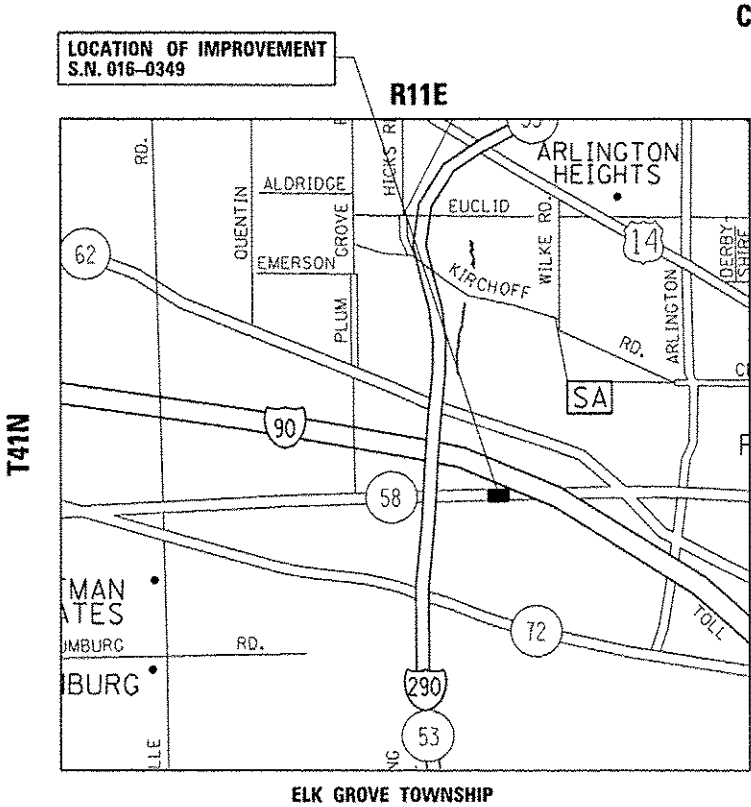

GROSS AND NET LENGTH = 240.3 FT. = .045 MILE

STATE OF ILLINOIS
DEPARTMENT OF TRANSPORTATION
DIVISION OF HIGHWAYS

SUBMITTED August 1, 2014
John F. Entenza Jr.
DEPUTY DIRECTOR OF HIGHWAYS, REGION ENGINEER

OCT 17 2014
John P. Baranzelli Jr.
ENGINEER OF DESIGN AND ENVIRONMENT

OCT 17 2014
Orme Osmani Jr.
DIRECTOR OF HIGHWAYS, CHIEF ENGINEER

PRINTED BY THE AUTHORITY
OF THE STATE OF ILLINOIS