

ELEVATION

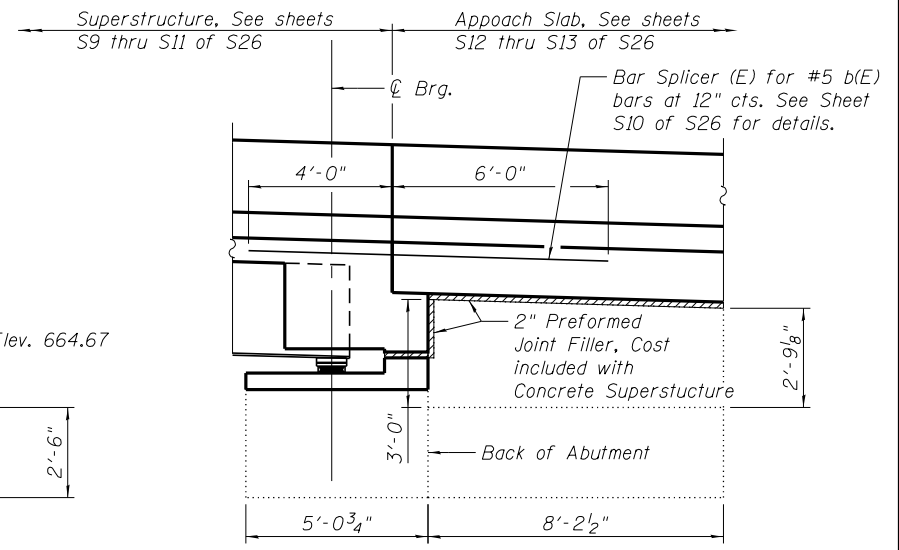

VIEW B-B

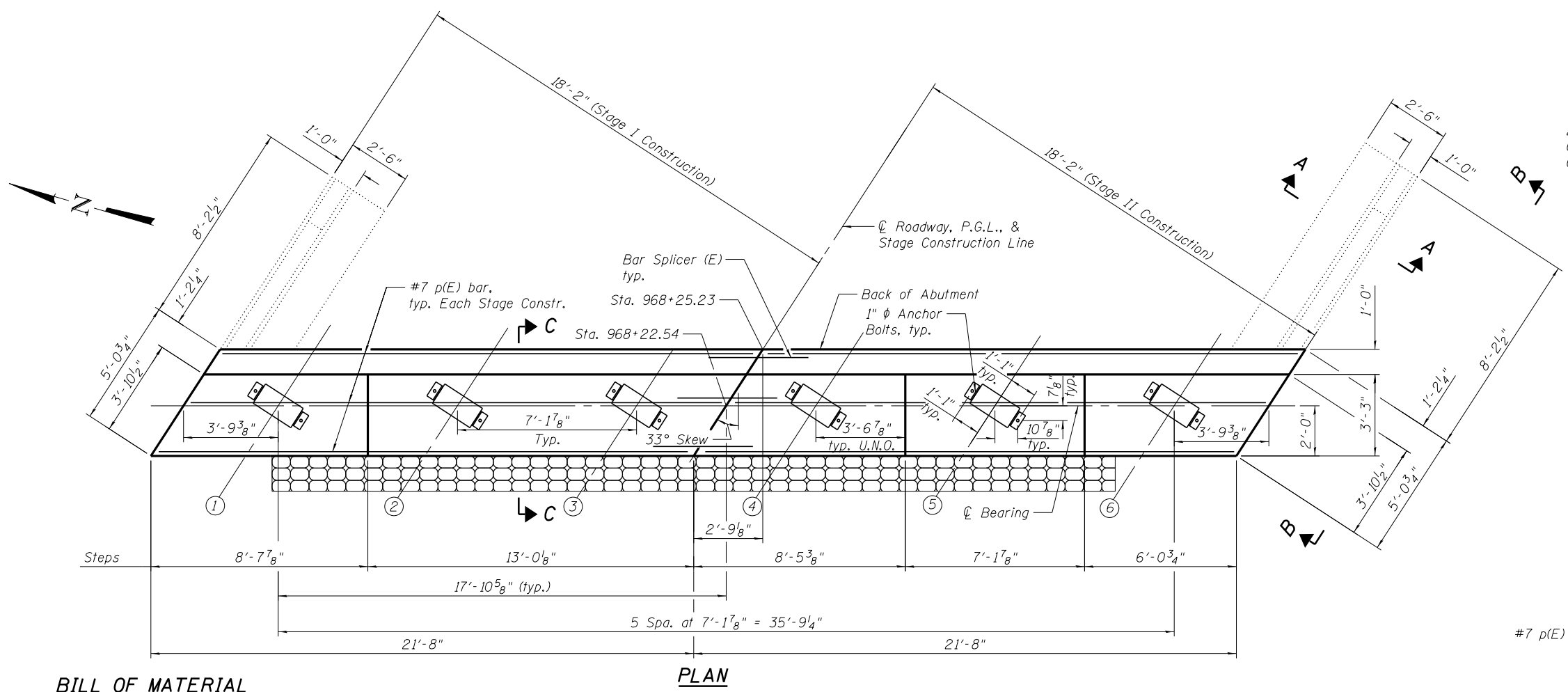

PLAN

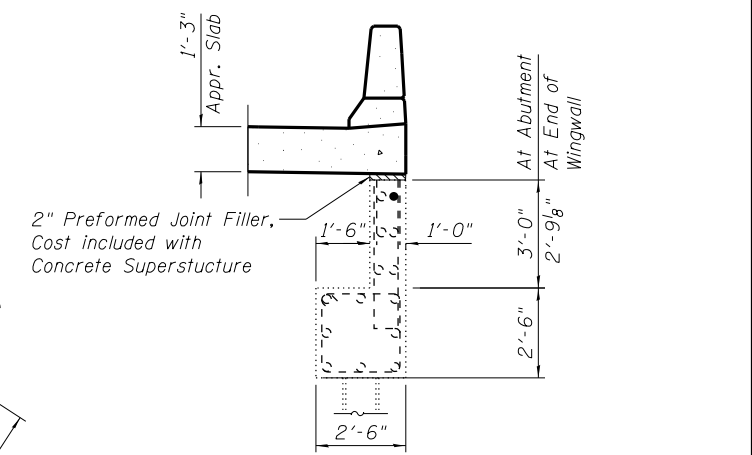

SECTION A-A

(Horiz. dim. @ Rt. L's)

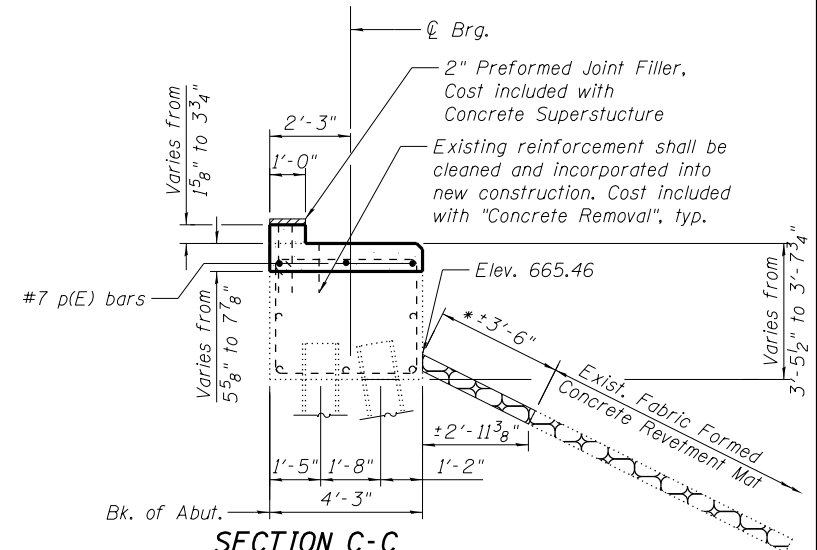

SECTION C-C

(Horiz. dim. @ Rt. L's)

BILL OF MATERIAL

Bar	No.	Size	Length	Shape
p(E)	6	#7	21'-4"	
Concrete Structures			Cu. Yd.	4.5
Structure Excavation			Cu. Yd.	48
Fabric Formed Concrete Revetment Mat			Sq. Yd.	14
Reinforcement Bars, Epoxy Coated			Pound	270

* New Fabric Formed Concrete Revetment Mat shall be placed against Existing Fabric Formed Concrete Revetment Mat. Prior to placing New Revetment Mat, Existing Revetment Mat surface shall be cleaned of debris and soil build up. Cost included with Fabric Formed Concrete Revetment Mat.



USER NAME = carpenter_dj
 DESIGNED - KO
 CHECKED - BCM
 PLOT SCALE = N/A
 PLOT DATE = 8/1/2014

DESIGNED - KO
 CHECKED - BCM
 DRAWN - KO
 CHECKED - 7/31/2012

REVISED
 REVISED
 REVISED
 REVISED

**STATE OF ILLINOIS
 DEPARTMENT OF TRANSPORTATION**

**REPAIR DETAILS FOR EAST ABUTMENT
 STRUCTURE NO. 006-0140**

SHEET NO. S19 OF S26 SHEETS

F.A.P. RTE.	SECTION	COUNTY	TOTAL SHEETS	SHEET NO.
613	(8D-BR) BR	BUREAU	63	41
CONTRACT NO. 66A17				

ILLINOIS FED. AID PROJECT