

- LEGEND**
- Concrete Removal
 - Structural Repair of Concrete (Depth Equal To Or Less Than 5 Inches)
 - Structural Repair of Concrete (Depth Greater Than 5 Inches)
 - Steel Beam Seat Removal ***
 - Polymer Modified Portland Cement Mortar
 - H.L. - Hairline Crack - Not to be sealed

* Cost of existing bearing removal is included in Concrete Removal cost.

*** Removal cost of existing Steel beam seats is included with Removal of Existing Superstructures cost, typ.

Note:
Structural Repair of Concrete includes both existing damage to substructure and repair due to Steel Beam Seat Removal.

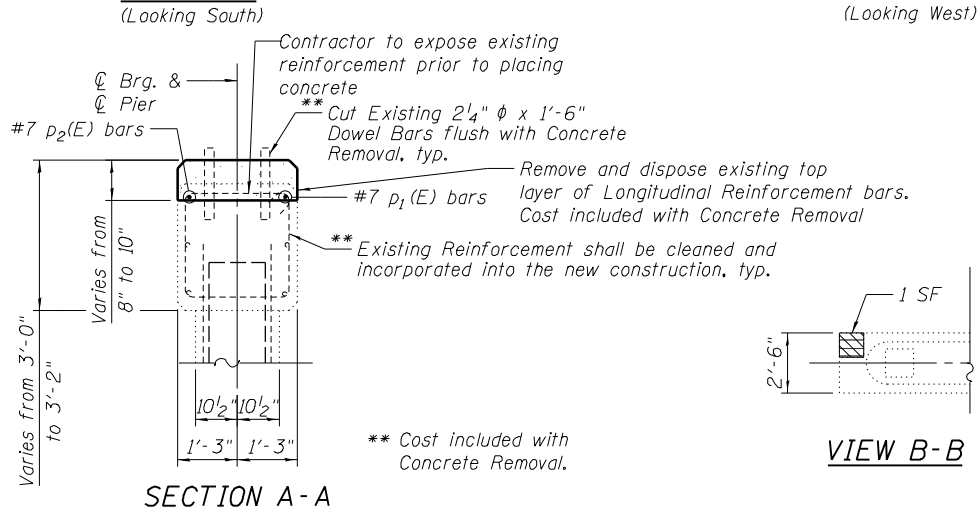
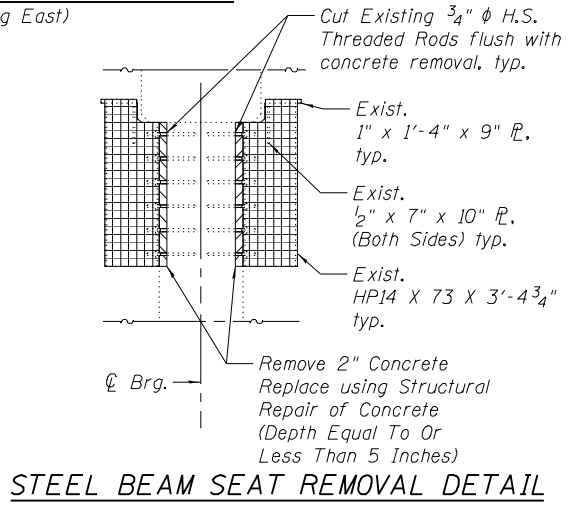

BILL OF MATERIAL

Bar	No.	Size	Length	Shape
p ₁ (E)	2	#7	21'-4"	
p ₂ (E)	2	#7	22'-11"	
Stone Riprap, Class A5			Sq. Yd.	44
Filter Fabric			Sq. Yd.	28
Concrete Removal			Cu. Yd.	4.8
Concrete Structures			Cu. Yd.	3.2
Reinforcement Bars, Epoxy Coated			Pound	190
Structural Repair of Concrete (Depth Greater Than 5 Inches)			Sq. Ft.	5
Structural Repair of Concrete (Depth Equal To Or Less Than 5 Inches)			Sq. Ft.	237
Polymer Modified Portland Cement Mortar			Sq. Ft.	1

FILENAME: F:\3-1308 IDDT\dwt_3\3-1308B_US34\coal\Submittals\Comments\2014 BP 11 BBS Comments Responses\CAD Files\0060140-66A17-021-Pier2.dgn



USER NAME = bmattas	DESIGNED - KO	REVISED
PLOT SCALE = N/A	CHECKED - BCM	REVISED
PLOT DATE = 9/11/2014	DRAWN - KO	REVISED
	CHECKED - 7/31/2012	REVISED

STATE OF ILLINOIS
DEPARTMENT OF TRANSPORTATION

PIER 2 DETAILS
STRUCTURE NO. 006-0140
SHEET NO. S21 OF S26 SHEETS

F.A.P. RTE. 613	SECTION (8D-BR) BR	COUNTY BUREAU	TOTAL SHEETS 63	SHEET NO. 43
CONTRACT NO. 66A17				
ILLINOIS FED. AID PROJECT				