

SIGNS SHALL BE POST MOUNTED ON LONG POINT ROAD JUST TO THE WEST OF IL 23

PLACE EB TRAFFIC SIGNALS ON MINIMUM RECALL TO GIVE CALL FOR PRIVATE DRIVE

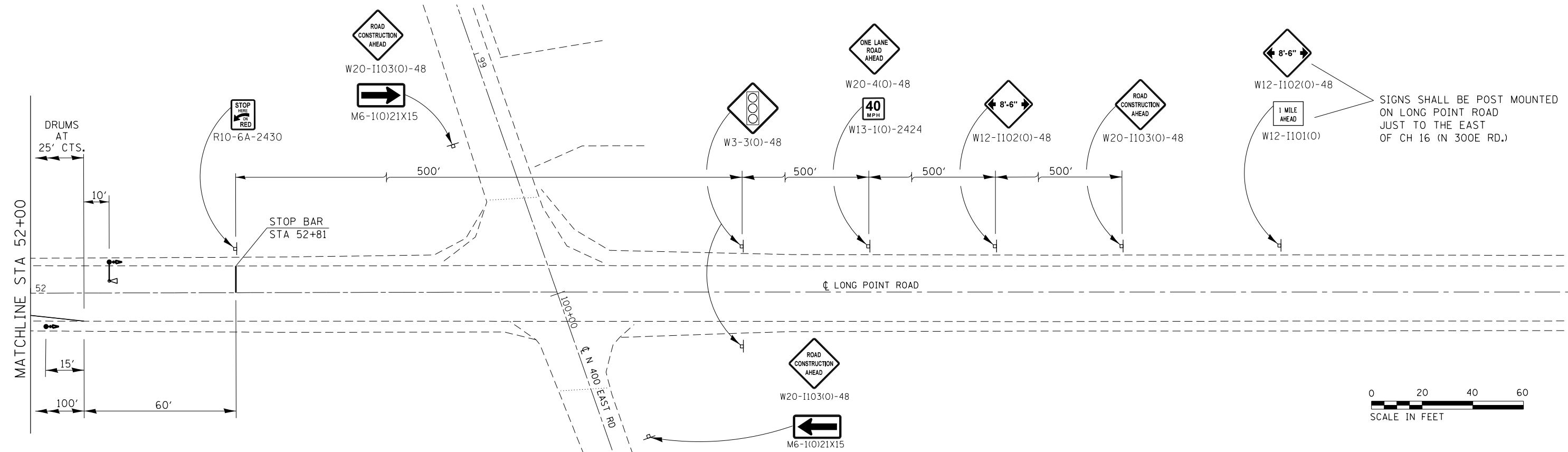

SIGNS SHALL BE POST MOUNTED ON LONG POINT ROAD JUST TO THE EAST OF CH 16 (N 300E RD.)



FILE NAME =	USER NAME = Schwankerg	DESIGNED -	REVISED -
ei:\pw\work\p\idot\schwankerg\d0179226\066A18-sht-staging.dgn		DRAWN -	REVISED -
	PLOT SCALE = 40.0000' / in.	CHECKED -	REVISED -
MODELNAME	PLOT DATE = 8/13/2014	DATE -	REVISED -

**STATE OF ILLINOIS
DEPARTMENT OF TRANSPORTATION**

STAGE I			
SCALE:	SHEET 2 OF 4 SHEETS	STA.	TO STA.

F.A.S. RTE.	SECTION	COUNTY	TOTAL SHEETS	SHEET NO.
370	(102 BR) BR	LIVINGSTON	65	17
CONTRACT NO. 66A18			ILLINOIS FED. AID PROJECT	