

- REMOVAL LEGEND**
- PAVEMENT REMOVAL
  - DRAINAGE STRUCTURE TO BE REMOVED
  - COMB. CONC. CURB AND GUTTER REMOVAL
  - PIPE CULVERT/STORM SEWER REMOVAL
  - TREE REMOVAL
  - DRIVEWAY PAVEMENT REMOVAL
  - PAVED SHOULDER REMOVAL
  - REMOVAL OF EXISTING STRUCTURES
  - ISLAND PAVEMENT REMOVAL
  - BUILDING REMOVAL
  - HMA SURFACE REMOVAL

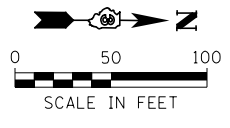
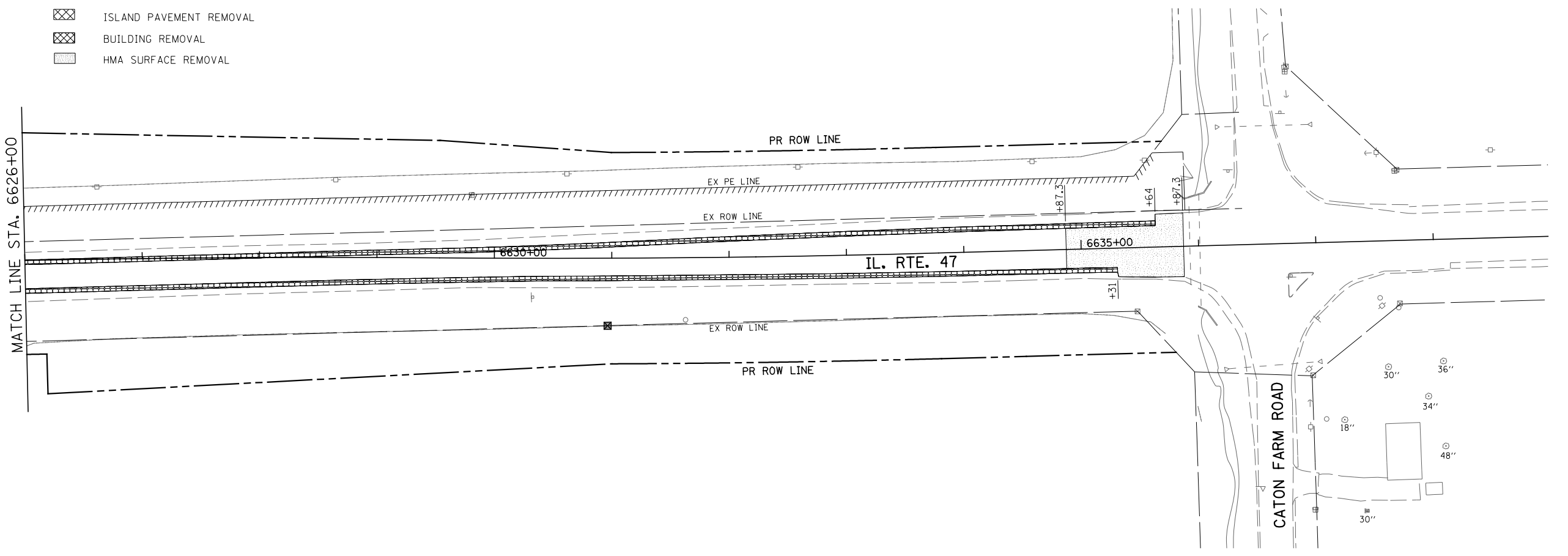
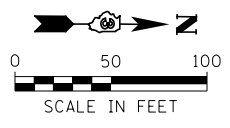

FILE NAME = V:\3195\66884 (North Section)\CADD Sheets\ND366884-shr-rem-13.dgn	USER NAME = bdecreane	DESIGNED - KU	REVISED -	<b>STATE OF ILLINOIS DEPARTMENT OF TRANSPORTATION</b>	<b>IL. RTE. 47 REMOVAL PLANS</b>			F.A.P. RTE. 326	SECTION (109, 110R-1)	COUNTY KENDALL	TOTAL SHEETS 619	SHEET NO. 90
*MODELNAME*	PLOT SCALE = 100.0000' / in.	CHECKED - ST	REVISED -		SCALE: 1"=50'	SHEET NO. 13 OF 19 SHEETS	STA. 6611+00 TO STA. 6639+00	CONTRACT NO. 66884				
	PLOT DATE = 7/14/2014	DATE - 7/01/2014	REVISED -		ILLINOIS FED. AID PROJECT							