

W21-1115(O)-3618  
R2-1-3648  
R10-19aP-3618  
R2-1106-3618

WORK ZONE  
SPEED LIMIT  
45  
PHOTO ENFORCED  
#375 FINE MINIMUM

- LEGEND**
- ↑ DIRECTION INDICATOR BARRICADE WITH STEADY BURN MONDIRECTIONAL LIGHT
  - ↓ TYPE II BARRICADE, DRUM OR VERTICAL BARRICADE WITH STEADY BURN BI-DIRECTIONAL LIGHT
  - ↕ TYPE III BARRICADE WITH FLASHING LIGHT (2-EA.)
  - ▬ DOUBLE VERTICAL PANEL
  - ▨ WORK AREA
  - ➔ ARROW BOARD
  - ⊕ CONSTRUCTION SIGN
  - ➔ DIRECTION OF TRAFFIC
  - ▬ TEMPORARY CONCRETE BARRIER
  - ▬ IMPACT ATTENUATOR, TEMPORARY (FULLY DIRECTIONAL, NARROW), TEST LEVEL 3
  - ⊙ FLASHING MONO-DIRECTIONAL LIGHT

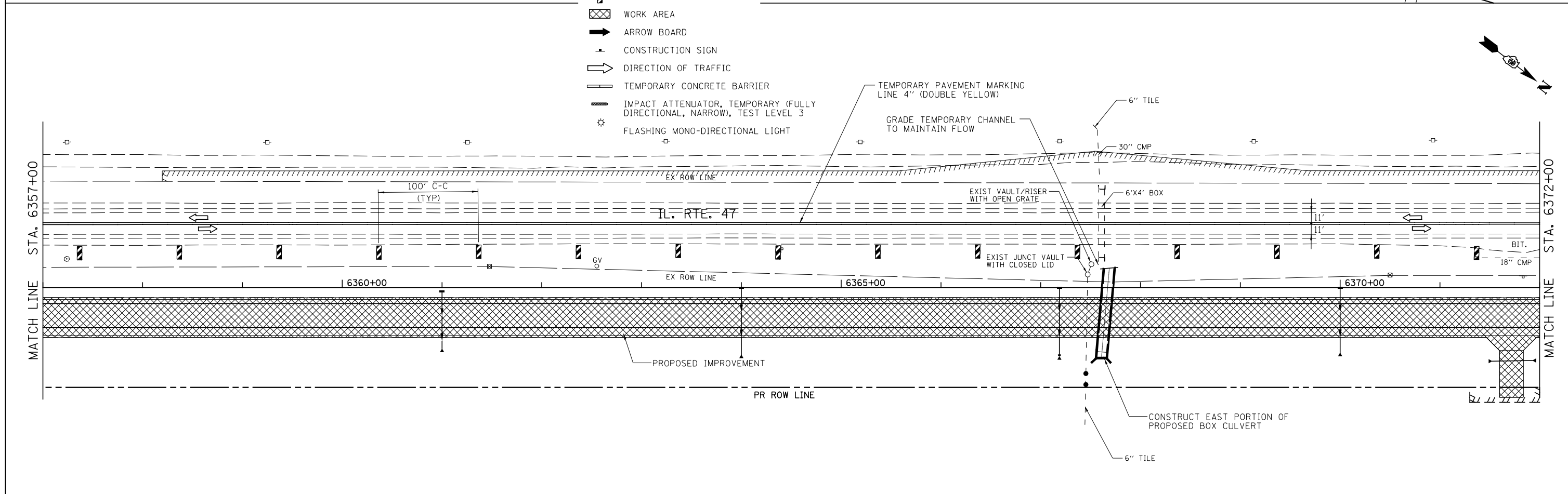

FILE NAME = V:\3195\66884 (North Section)\CADD Sheets\ND366884-sh1-MOT-Stage1-04.dgn	USER NAME = bdecreane	DESIGNED - HLC	REVISED -	<b>STATE OF ILLINOIS DEPARTMENT OF TRANSPORTATION</b>	<b>IL. RTE. 47 STAGE 1 CONSTRUCTION &amp; TRAFFIC CONTROL</b>	F.A.P. RTE. 326	SECTION (109, 110R-1)	COUNTY KENDALL	TOTAL SHEETS 619	SHEET NO. 148		
PLOT SCALE = 100.0000' / 1".	CHECKED - CAS	REVISED -	SCALE: 1"=50'			SHEET 4 OF 20 SHEETS	STA. 6342+00 TO STA. 6372+00	CONTRACT NO. 66884		ILLINOIS FED. AID PROJECT		
PLOT DATE = 7/14/2014	DATE - 7/01/2014	REVISED -										
<p>CONTRACT NO. 66884</p>												