

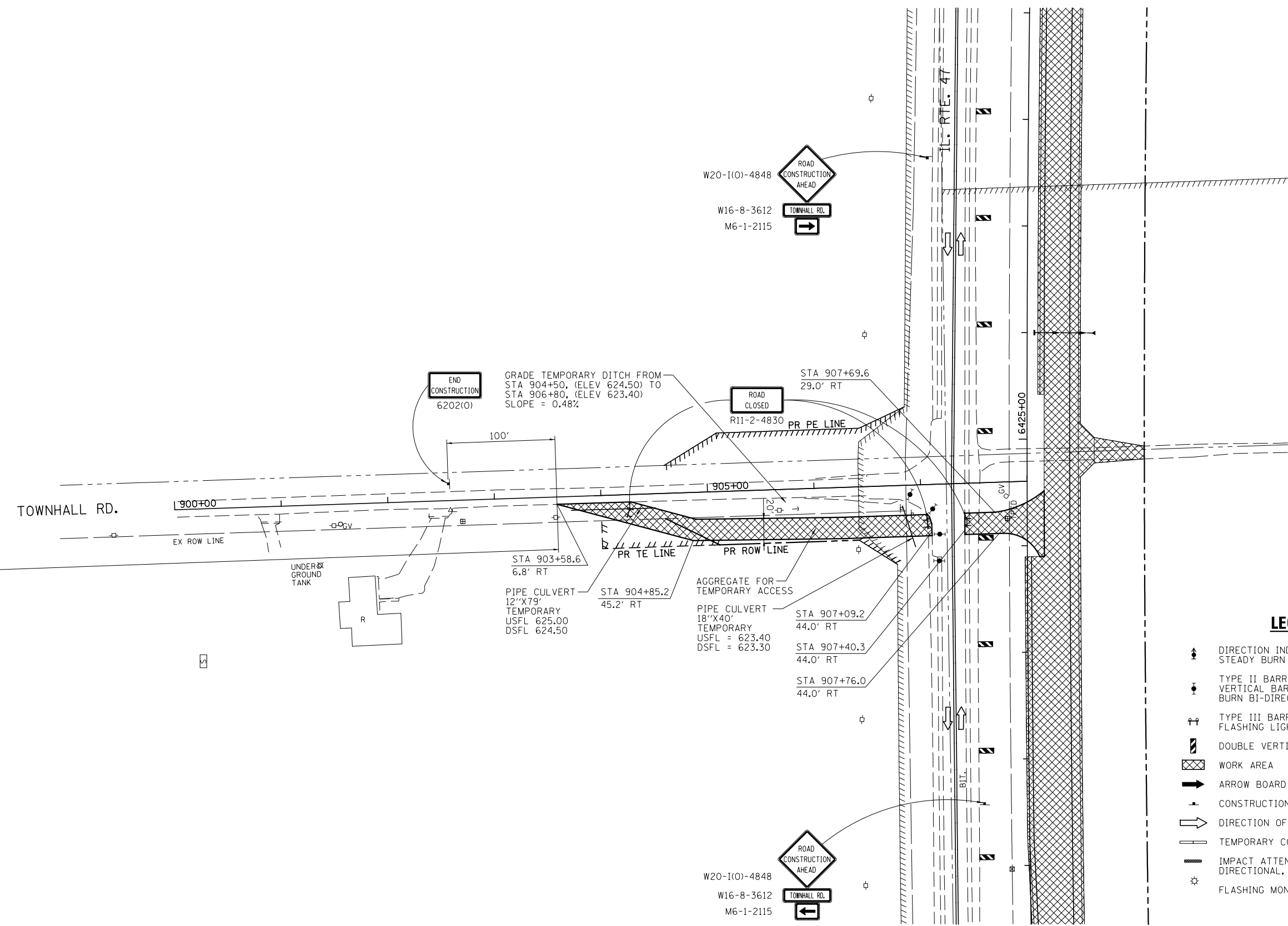

W20-1-4848



END CONSTRUCTION 6202(O)

W20-1(0)-4848  
ROAD CONSTRUCTION AHEAD  
W16-8-3612  
TOWNHALL RD.  
M6-1-2115

ROAD CLOSED R11-2-4830

W20-1(0)-4848  
ROAD CONSTRUCTION AHEAD  
W16-8-3612  
TOWNHALL RD.  
M6-1-2115

**LEGEND**

- DIRECTION INDICATOR BARRICADE WITH STEADY BURN MONDIRECTIONAL LIGHT
- TYPE II BARRICADE, DRUM OR VERTICAL BARRICADE WITH STEADY BURN BI-DIRECTIONAL LIGHT
- TYPE III BARRICADE WITH FLASHING LIGHT (2-EA.)
- DOUBLE VERTICAL PANEL
- WORK AREA
- ARROW BOARD
- CONSTRUCTION SIGN
- DIRECTION OF TRAFFIC
- TEMPORARY CONCRETE BARRIER
- IMPACT ATTENUATOR, TEMPORARY (FULLY DIRECTIONAL, NARROW), TEST LEVEL 3
- FLASHING MONO-DIRECTIONAL LIGHT

FILE NAME = V:\3195\66884 (North Section)\CADD Sheets\ND366884-sh1-MOT-Stage1-15.dgn	USER NAME = bdecreene	DESIGNED - HLC	REVISED -
PLOT SCALE = 100.0000' / in.	CHECKED - CAS	DRAWN - HLC	REVISED -
PLOT DATE = 7/14/2014	DATE - 7/01/2014		REVISED -

**STATE OF ILLINOIS  
DEPARTMENT OF TRANSPORTATION**

**TOWNHALL RD.  
STAGE 1 CONSTRUCTION AND TRAFFIC CONTROL**

SCALE: 1"=50' SHEET 16 OF 20 SHEETS STA. 900+00 TO STA. 908+00

F.A.P. RTE.	SECTION	COUNTY	TOTAL SHEETS	SHEET NO.
326	(109, 110)R-1	KENDALL	619	160
CONTRACT NO. 66884				
ILLINOIS FED. AID PROJECT				