

LEGEND

- ▲ DIRECTION INDICATOR BARRICADE WITH STEADY BURN MONDIRECTIONAL LIGHT
- TYPE II BARRICADE, DRUM OR VERTICAL BARRICADE WITH STEADY BURN BI-DIRECTIONAL LIGHT
- ⚡ TYPE III BARRICADE WITH FLASHING LIGHT (2-EA.)
- ▬ DOUBLE VERTICAL PANEL
- ▨ WORK AREA
- ➔ ARROW BOARD
- ⚠ CONSTRUCTION SIGN
- ➡ DIRECTION OF TRAFFIC
- ▬ TEMPORARY CONCRETE BARRIER
- ▬ IMPACT ATTENUATOR, TEMPORARY (FULLY DIRECTIONAL, NARROW), TEST LEVEL 3
- ⚡ FLASHING MONO-DIRECTIONAL LIGHT

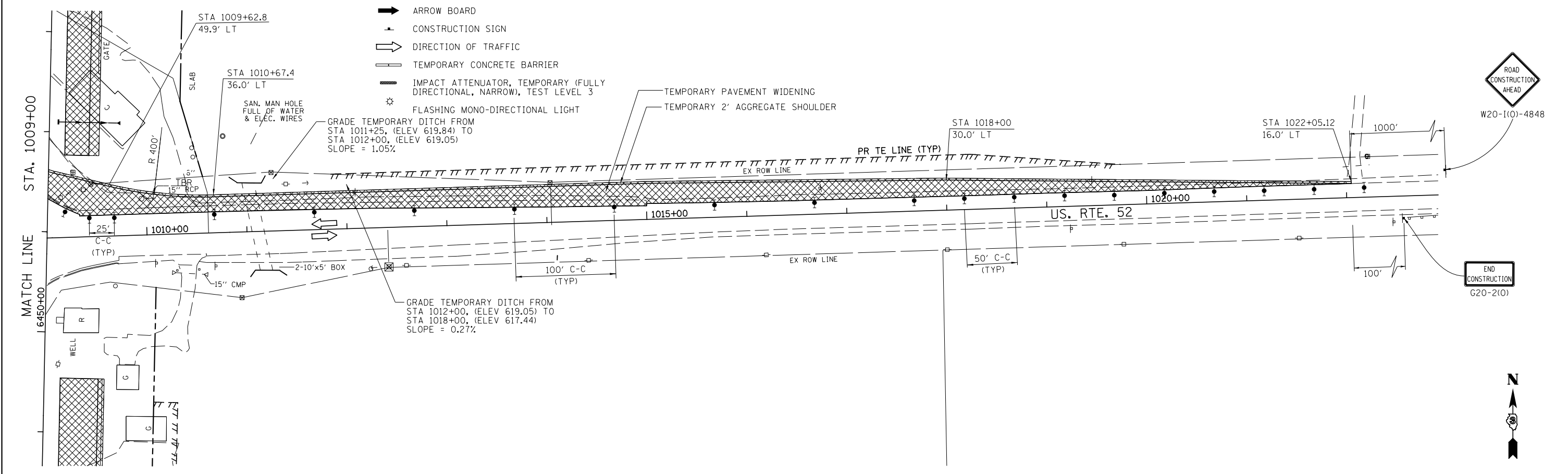

FILE NAME = V:\3195\66884 (North Section)\CADD Sheets\0366884-sh1-MOT-Stage1-16.dgn	USER NAME = bdecreane	DESIGNED - HLC	REVISED -
PLOT SCALE = 100.0000' / 1" / 1" / 1"	PLOT DATE = 7/14/2014	DRAWN - HLC	REVISED -
		CHECKED - CAS	REVISED -
		DATE - 7/01/2014	REVISED -

**STATE OF ILLINOIS
DEPARTMENT OF TRANSPORTATION**

**US. RTE. 52
STAGE 1 CONSTRUCTION AND TRAFFIC CONTROL**

SCALE: 1"=50' SHEET 17 OF 20 SHEETS STA. 995+00 TO STA. 1022+00

F.A.P. RTE.	SECTION	COUNTY	TOTAL SHEETS	SHEET NO.
326	(109, 110)R-1	KENDALL	619	161
CONTRACT NO. 66884				
ILLINOIS FED. AID PROJECT				