

**LEGEND**

- DIRECTION INDICATOR BARRICADE WITH STEADY BURN MONDIRECTIONAL LIGHT
- TYPE II BARRICADE, DRUM OR VERTICAL BARRICADE WITH STEADY BURN BI-DIRECTIONAL LIGHT
- TYPE III BARRICADE WITH FLASHING LIGHT (2-EA.)
- DOUBLE VERTICAL PANEL
- WORK AREA
- ARROW BOARD
- CONSTRUCTION SIGN
- DIRECTION OF TRAFFIC
- TEMPORARY CONCRETE BARRIER
- IMPACT ATTENUATOR, TEMPORARY (FULLY REDIRECTIVE, NARROW), TEST LEVEL 3
- FLASHING MONO-DIRECTIONAL LIGHT

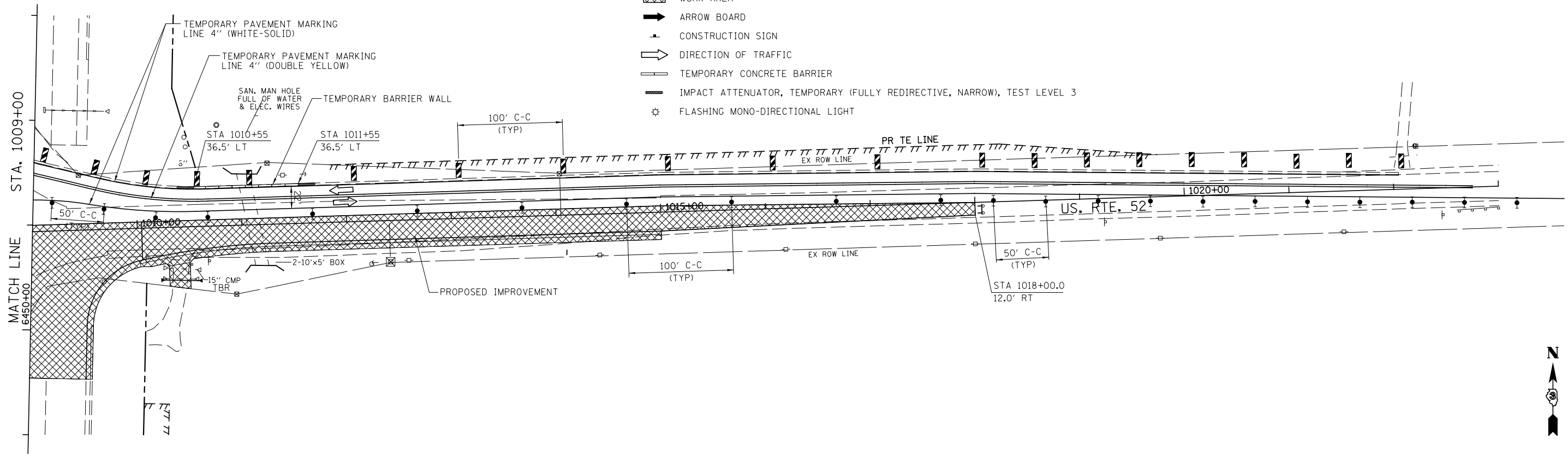

FILE NAME =	USER NAME = bdecreane	DESIGNED - HLC	REVISED -
V:\3195\66884 (North Section)\CADD Sheets\ND366884-sh1-MOT-Stage1A-15.dgn		DRAWN - HLC	REVISED -
	PLOT SCALE = 100.0000' / in.	CHECKED - CAS	REVISED -
#MODELNAME#	PLOT DATE = 7/14/2014	DATE - 7/01/2014	REVISED -

**STATE OF ILLINOIS  
DEPARTMENT OF TRANSPORTATION**

**US. RTE. 52  
STAGE 1A CONSTRUCTION AND TRAFFIC CONTROL**

SCALE: 1"=50' SHEET 2 OF 2 SHEETS STA. 995+00 TO STA. 1022+00

F.A.P. RTE.	SECTION	COUNTY	TOTAL SHEETS	SHEET NO.
326	(109, 110)R-1	KENDALL	619	166
CONTRACT NO. 66884				
ILLINOIS FED. AID PROJECT				