

- LEGEND**
- DIRECTION INDICATOR BARRICADE WITH STEADY BURN MONDIRECTIONAL LIGHT
 - TYPE II BARRICADE, DRUM OR VERTICAL BARRICADE WITH STEADY BURN BI-DIRECTIONAL LIGHT
 - TYPE III BARRICADE WITH FLASHING LIGHT (2-EA.)
 - DOUBLE VERTICAL PANEL
 - WORK AREA
 - ARROW BOARD
 - CONSTRUCTION SIGN
 - DIRECTION OF TRAFFIC
 - TEMPORARY CONCRETE BARRIER
 - IMPACT ATTENUATOR, TEMPORARY (FULLY REDIRECTIVE, NARROW), TEST LEVEL 3
 - FLASHING MONO-DIRECTIONAL LIGHT

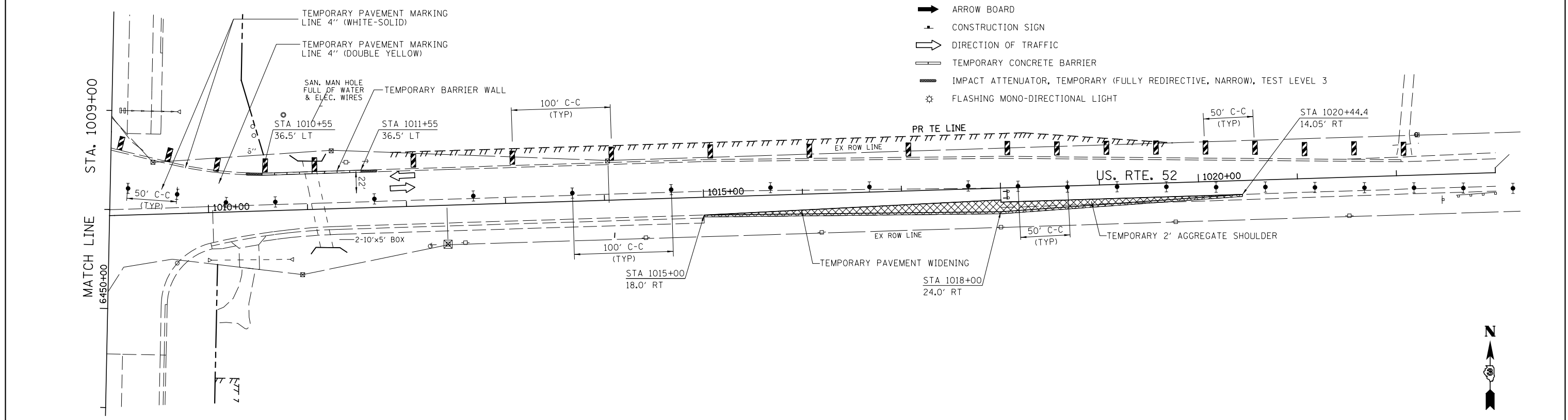

FILE NAME = V:\3195\66884 (North Section)\CADD Sheets\ND366884-sh1-MOT-Stage1B-15.dgn	USER NAME = bdecreene	DESIGNED - HLC	REVISED -	STATE OF ILLINOIS DEPARTMENT OF TRANSPORTATION	US. RTE. 52 STAGE 1B CONSTRUCTION AND TRAFFIC CONTROL	F.A.P. RTE. 326	SECTION (109, 110)R-1	COUNTY KENDALL	TOTAL SHEETS 619	SHEET NO. 167		
PLOT SCALE = 100.0000' / in.	CHECKED - CAS	REVISIED -	REVISIED -			SCALE: 1"=50'	SHEET 1 OF 1 SHEETS	STA. 995+00	TO STA. 1022+00	CONTRACT NO. 66884		
PLOT DATE = 7/14/2014	DATE - 7/01/2014	REVISIED -	REVISIED -			ILLINOIS FED. AID PROJECT						