

**STAGE 2 TYPICAL SECTION**

**IL. RTE. 47**

STA. 6629+00.00 TO STA. 6631+10

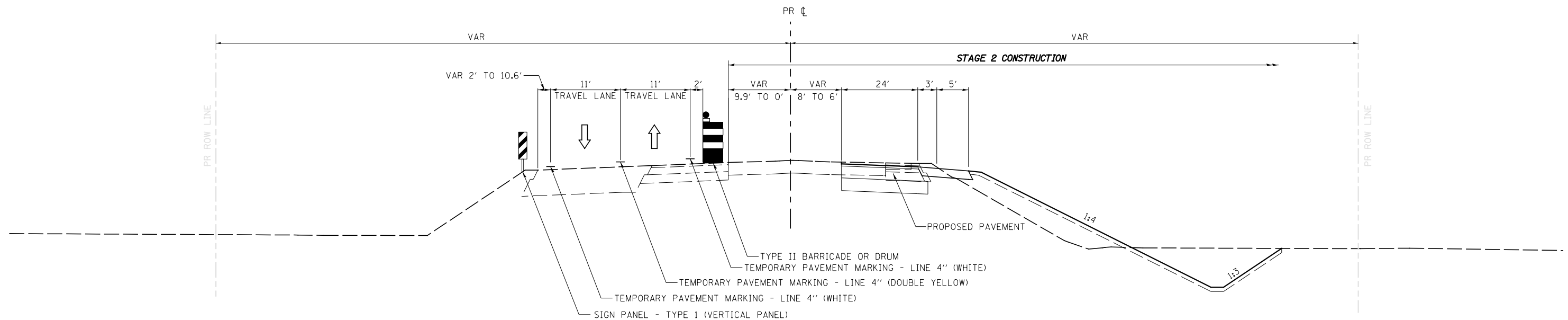

**STAGE 2 TYPICAL SECTION**

**IL. RTE. 47**

STA. 6631+10 TO STA. 6635+81.87

FILE NAME =	USER NAME = bdecreene	DESIGNED - HLC	REVISED -
V:\3195\66884 (North Section)\CADD Sheets\ND366884-sh1-MOT-Stage2-0E.dgn		DRAWN - HLC	REVISED -
	PLOT SCALE = 16.0000' / in.	CHECKED - CAS	REVISED -
\$MODELNAME\$	PLOT DATE = 7/14/2014	DATE - 7/01/2014	REVISED -

**STATE OF ILLINOIS  
DEPARTMENT OF TRANSPORTATION**

<b>IL. RTE. 47</b>			
<b>STAGE 2 CONSTRUCTION NOTES &amp; TYPICAL SECTIONS</b>			
SCALE: N/A	SHEET 5 OF 6 SHEETS	STA. N/A	TO STA. N/A

F.A.P. RTE.	SECTION	COUNTY	TOTAL SHEETS	SHEET NO.
326	(109,110) R-1	KENDALL	619	172
CONTRACT NO. 66884				
ILLINOIS FED. AID PROJECT				