

- LEGEND**
- DIRECTION INDICATOR BARRICADE WITH STEADY BURN MONODIRECTIONAL LIGHT
 - TYPE II BARRICADE, DRUM OR VERTICAL BARRICADE WITH STEADY BURN BI-DIRECTIONAL LIGHT
 - TYPE III BARRICADE WITH FLASHING LIGHT (2-EA.)
 - DOUBLE VERTICAL PANEL
 - WORK AREA
 - ARROW BOARD
 - CONSTRUCTION SIGN
 - DIRECTION OF TRAFFIC
 - TEMPORARY CONCRETE BARRIER
 - IMPACT ATTENUATOR, TEMPORARY (FULLY REDIRECTIVE, NARROW), TEST LEVEL 3
 - FLASHING MONO-DIRECTIONAL LIGHT

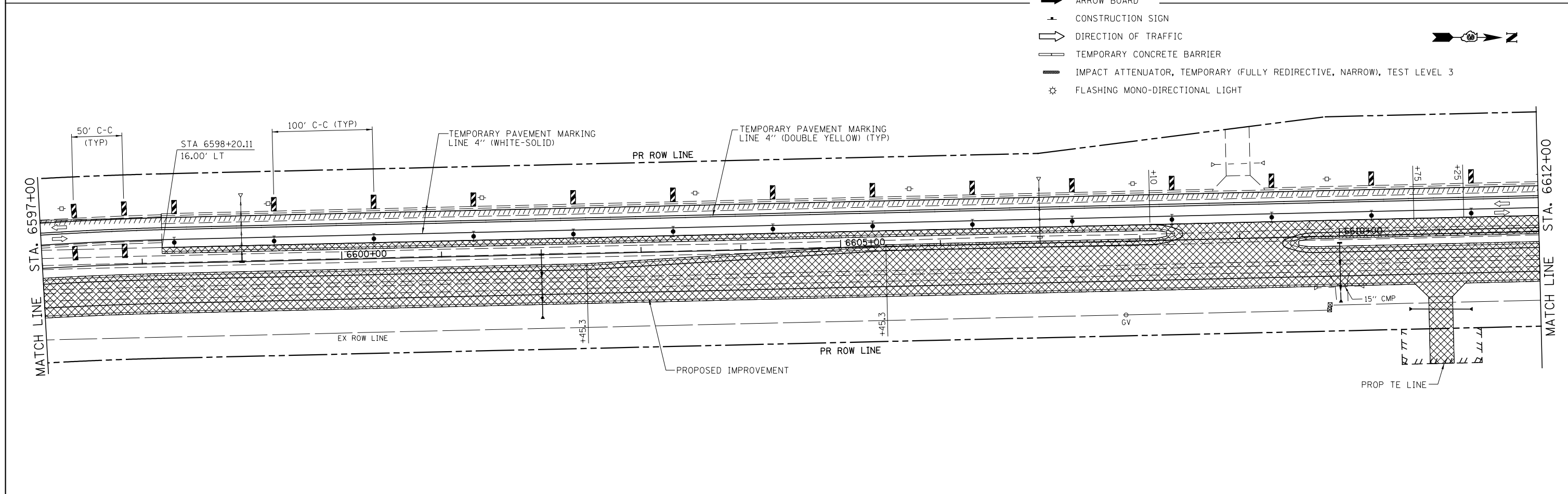

| | | | | | | | | | | | | |
|---|-----------------------|------------------|-----------|---|--|---------------------------|-----------------------|------------------------------|------------------|--------------------|--|--|
| FILE NAME = V:\3195\66884 (North Section)\CADD Sheets\0366884-sh1-MOT-Stage2-03.dgn | USER NAME = bdecreane | DESIGNED - HLC | REVISED - | STATE OF ILLINOIS DEPARTMENT OF TRANSPORTATION | IL RTE. 47 STAGE 2 CONSTRUCTION & TRAFFIC CONTROL | F.A.P. RTE. 326 | SECTION (109, 110R-1) | COUNTY KENDALL | TOTAL SHEETS 619 | SHEET NO. 175 | | |
| *MODELNAME# | PLOT DATE = 7/14/2014 | DRAWN - HLC | REVISED - | | | SCALE: 1"=50' | SHEET 2 OF 4 SHEETS | STA. 6582+00 TO STA. 6612+00 | | CONTRACT NO. 66884 | | |
| | | CHECKED - CAS | REVISED - | | | ILLINOIS FED. AID PROJECT | | | | | | |
| | | DATE - 7/01/2014 | REVISED - | | | | | | | | | |