

TRAFFIC CONTROL AND PROTECTION WHEN CLOSED

LEGEND

- DIRECTION INDICATOR BARRICADE WITH STEADY BURN MONDIRECTIONAL LIGHT
- TYPE II BARRICADE, DRUM OR VERTICAL BARRICADE WITH STEADY BURN BI-DIRECTIONAL LIGHT
- TYPE III BARRICADE WITH FLASHING LIGHT (2-EA.)
- DOUBLE VERTICAL PANEL
- WORK AREA
- ARROW BOARD
- CONSTRUCTION SIGN
- DIRECTION OF TRAFFIC
- TEMPORARY CONCRETE BARRIER
- IMPACT ATTENUATOR, TEMPORARY (FULLY REDIRECTIVE, NARROW), TEST LEVEL 3
- FLASHING MONO-DIRECTIONAL LIGHT

- NOTES:
1. SEE TEMPORARY INFORMATION SIGNING DETAIL.
 2. THE CONTRACTOR MUST MAINTAIN THE MEDIAN OPENING ON IL. RTE. 47 STA 6577+00 TO ALLOW TRUCK ACCESS FROM IL. RTE. 47 TO THE GRAIN FACILITY AT ALL TIMES WHEN THE WEST LEG OF HELMAR RD. IS CLOSED.
 3. NO WORK WILL BE ALLOWED ON HELMAR RD. (WEST) BETWEEN MARCH 15 AND JUNE 30 OR BETWEEN SEPTEMBER 15 AND NOVEMBER 30 UNLESS TEMPORARY ACCESS CAN BE MAINTAINED AT ALL TIMES.

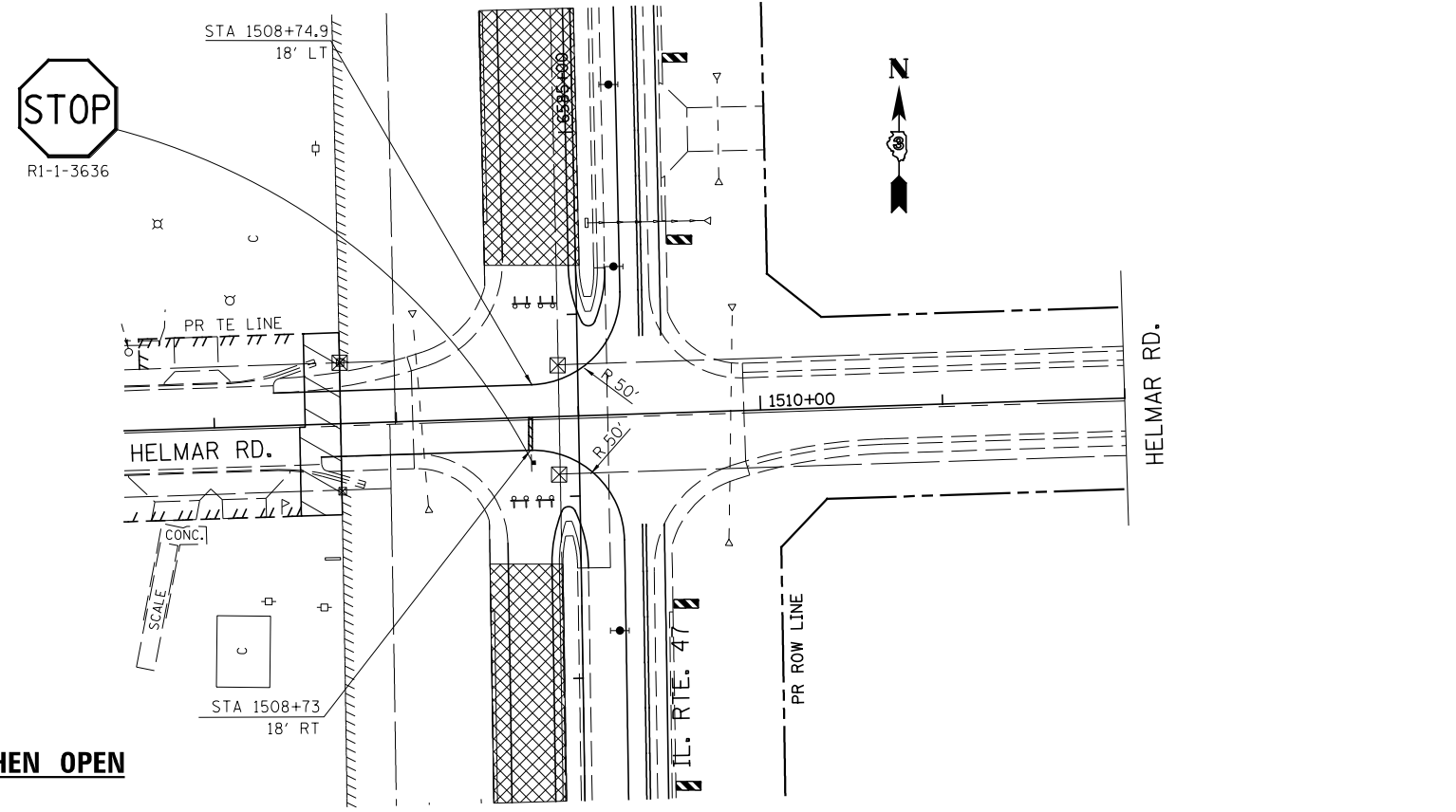

TRAFFIC CONTROL AND PROTECTION WHEN OPEN

FILE NAME = V:\3195\66884 (North Section)\CADD Sheets\0366884-sh1-MOT-Stage3-17.dgn	USER NAME = bdecreane	DESIGNED - HLC	REVISED -	STATE OF ILLINOIS DEPARTMENT OF TRANSPORTATION	HELMAR RD. STAGE 3 CONSTRUCTION AND TRAFFIC CONTROL	F.A.P. RTE. 326	SECTION (109, 110)R-1	COUNTY KENDALL	TOTAL SHEETS 619	SHEET NO. 203		
*MODELNAME#	PLOT SCALE = 100.0000' / 1in.	CHECKED - CAS	REVISED -			SCALE: 1"=50'	SHEET 18 OF 18 SHEETS	STA. 1501+00 TO STA. 1509+00	CONTRACT NO. 66884			
	PLOT DATE = 7/14/2014	DATE - 7/01/2014	REVISED -			ILLINOIS FED. AID PROJECT						