

PLAN	SURVEYED	DATE
	PLOTTED	BY
	GRADES CHECKED	
	STRUCTURE NOTATIONS CHECKED	
	NO.	

PROFILE	SURVEYED	DATE
	PLOTTED	BY
	GRADES CHECKED	
	STRUCTURE NOTATIONS CHECKED	
	NO.	

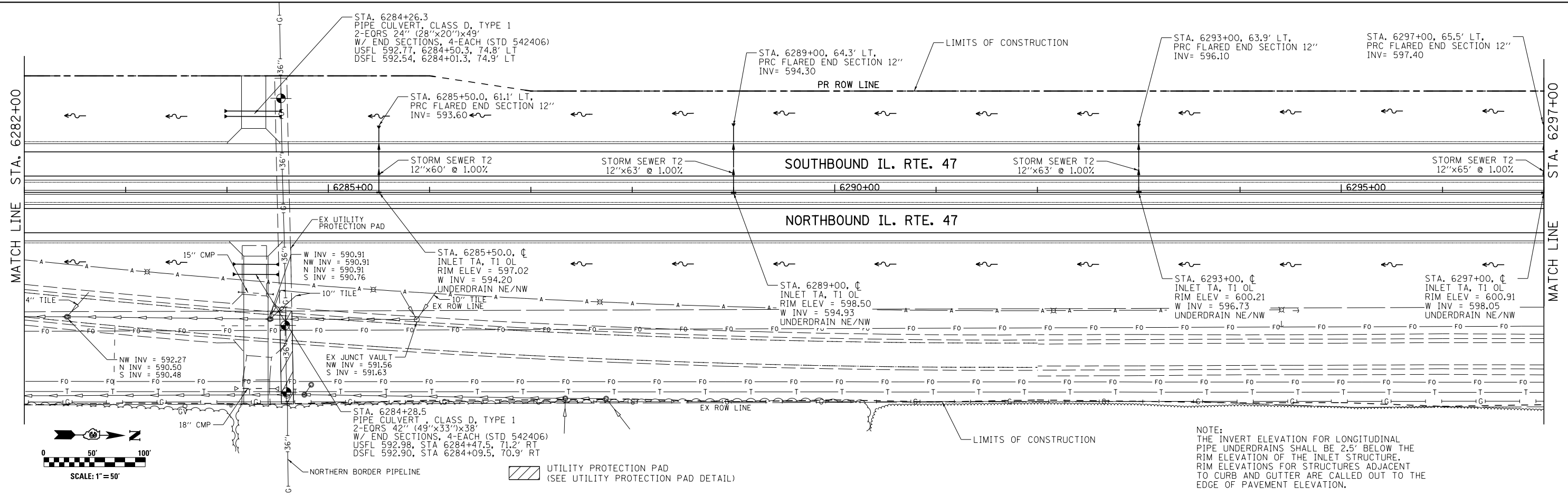

NOTE:
THE INVERT ELEVATION FOR LONGITUDINAL PIPE UNDERDRAINS SHALL BE 2.5' BELOW THE RIM ELEVATION OF THE INLET STRUCTURE. RIM ELEVATIONS FOR STRUCTURES ADJACENT TO CURB AND GUTTER ARE CALLED OUT TO THE EDGE OF PAVEMENT ELEVATION.

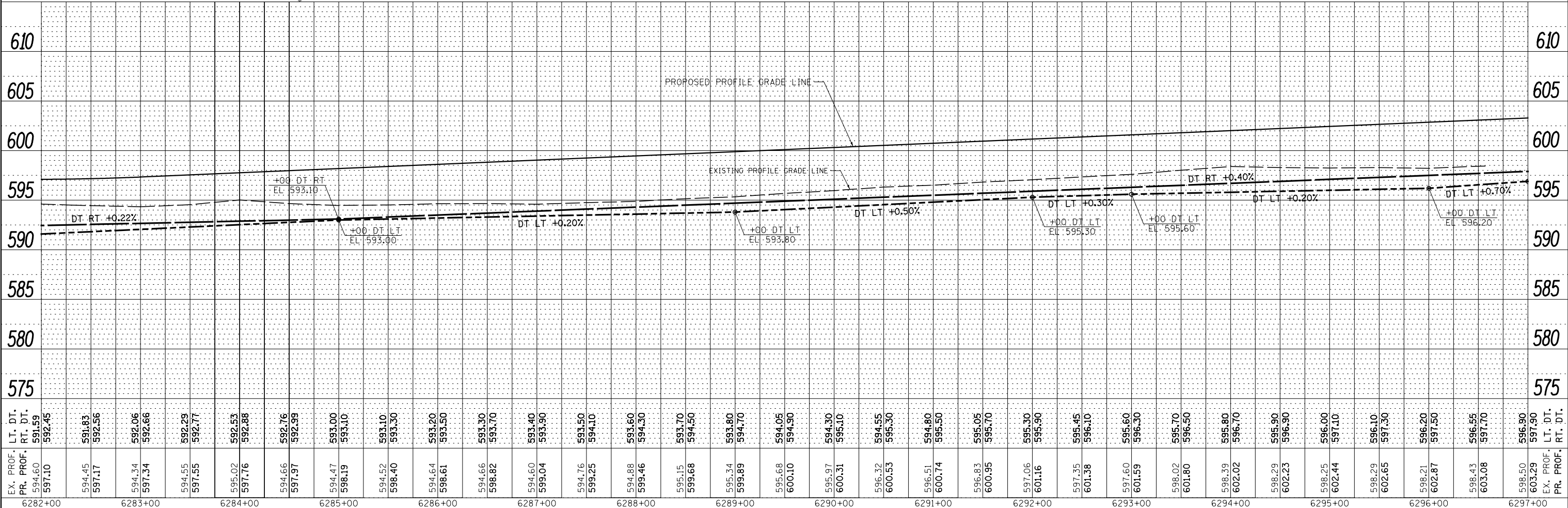

EX. PROF. PR. PROF.	LT. DT. RT. DT.	6282+00	6283+00	6284+00	6285+00	6286+00	6287+00	6288+00	6289+00	6290+00	6291+00	6292+00	6293+00	6294+00	6295+00	6296+00	6297+00																																								
597.10 594.60	592.45 591.59	594.45 591.83	592.56 592.56	594.34 592.86	597.34 592.86	594.55 592.29	592.77 592.77	595.02 592.53	592.88 592.88	594.66 592.76	592.99 592.99	593.00 593.10	593.10 593.30	593.20 593.50	594.64 598.61	594.66 598.82	593.30 593.70	594.40 593.90	593.40 593.50	594.10 594.10	594.88 593.60	593.60 594.30	595.15 593.70	594.50 594.50	593.80 594.70	595.34 594.05	594.90 594.90	595.68 600.10	594.30 600.31	595.10 595.10	596.32 600.53	594.80 600.74	595.50 600.74	596.83 600.95	595.05 595.70	597.06 601.16	595.30 595.90	597.35 601.38	595.45 596.10	597.60 601.59	595.60 596.30	598.02 601.80	595.70 596.50	598.39 602.02	595.80 596.70	598.29 602.23	595.90 596.90	598.25 602.44	597.10 597.10	598.29 602.65	596.10 597.30	598.21 602.87	596.20 597.50	598.43 603.08	596.55 597.70	598.50 603.29	597.90 597.90
FILE NAME =		USER NAME = bdecreane		DESIGNED - JUR		REVISED -		DRAWN - JUR		REVISED -		CHECKED - GRE		REVISED -		DATE - 7/01/2014		REVISI -		SCALE: H=50 V=5		SHEET 3 OF 39 SHEETS		STA. 6282+00 TO STA. 6297+00		F.A.P. RTE. 326		SECTION (109, 110R-1)		COUNTY KENDALL		TOTAL SHEETS 619		SHEET NO. 243		CONTRACT NO. 66884		ILLINOIS FED. AID PROJECT																			

STATE OF ILLINOIS
DEPARTMENT OF TRANSPORTATION

IL. RTE. 47
STORM SEWER AND UTILITIES PLAN & PROFILE