

DATE	
BY	
SURVEYED	
PLANNED	
NOTED	
NO.	

DATE	
BY	
SURVEYED	
PLANNED	
NOTED	
NO.	

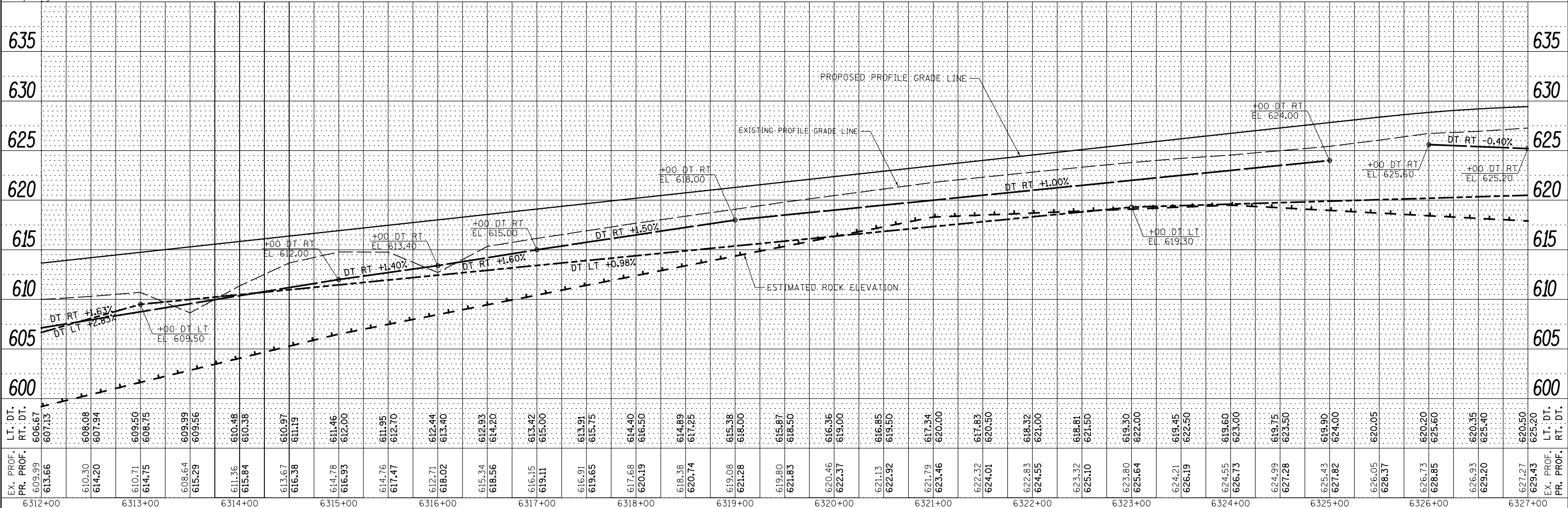

NOTE:
THE INVERT ELEVATION FOR LONGITUDINAL
PIPE UNDERDRAINS SHALL BE 2.5' BELOW THE
RIM ELEVATION OF THE INLET STRUCTURE.
RIM ELEVATIONS FOR STRUCTURES ADJACENT
TO CURB AND GUTTER ARE CALLED OUT TO THE
EDGE OF PAVEMENT ELEVATION.

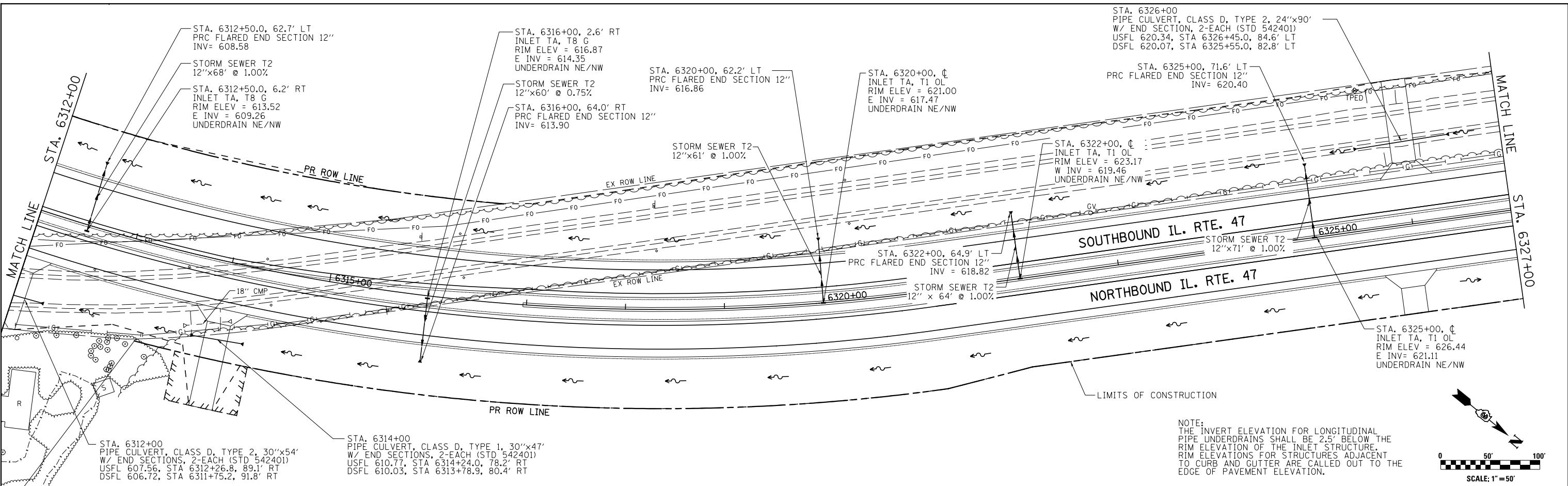
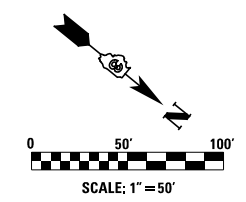

FILE NAME =	USER NAME = bdcraene	DESIGNED -	JJR	REVISED -		STATE OF ILLINOIS DEPARTMENT OF TRANSPORTATION		IL. RTE. 47 STORM SEWER AND UTILITIES PLAN & PROFILE		F.A.P. RTE.	SECTION	COUNTY	TOTAL SHEETS	SHEET NO.
V:\3195\66884 (North Section)\CADD Sheets\3366884-sht-drain-5.dgn		DRAWN -	JJR	REVISED -		SCALE: H=50 V=5		SHEET 5 OF 39 SHEETS		326	(109, 110IR-1)	KENDALL	619	245
SHT_PLNPROF	PLOT SCALE = 100.0000' / in.	CHECKED -	GRE	REVISED -		DATE = 7/01/2014		STA. 6312+00 TO STA. 6327+00		CONTRACT NO. 66884				
											ILLINOIS FED. AID PROJECT			