

PLAN	SURVEYED	DATE
	PLOTTED	BY
	GRADES CHECKED	
	STRUCTURE NOTATIONS CHECKED	
	NOTE BOOK NO.	
	CADD FILE NAME	

PROFILE	SURVEYED	DATE
	PLOTTED	BY
	GRADES CHECKED	
	STRUCTURE NOTATIONS CHECKED	
	NOTE BOOK NO.	
	CADD FILE NAME	

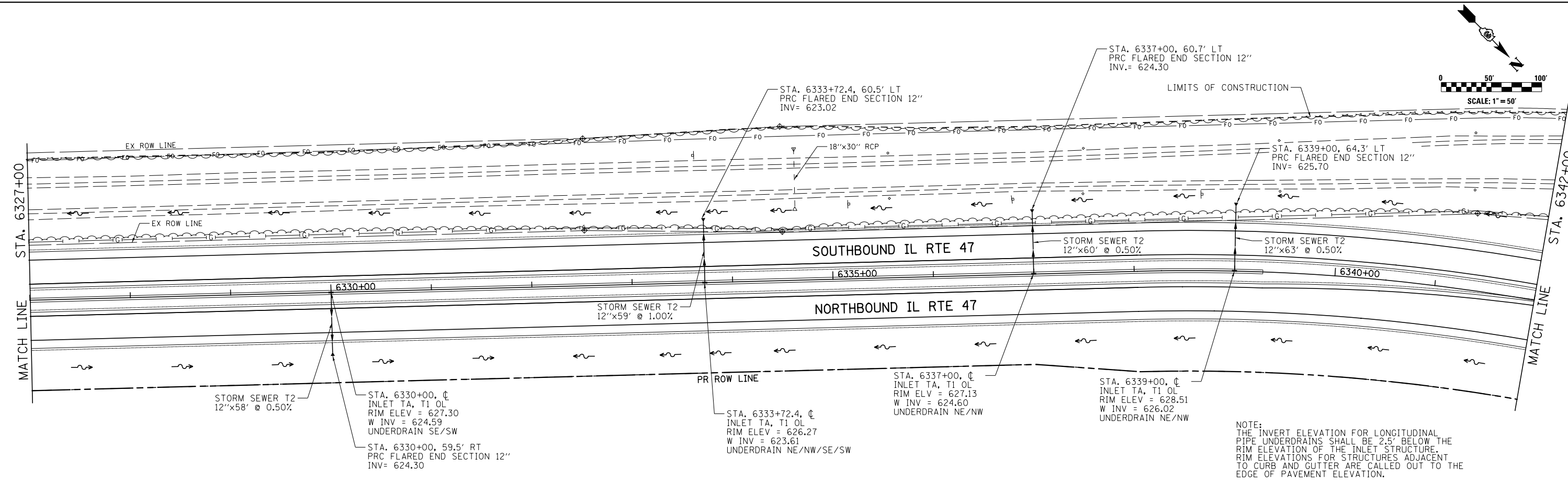

NOTE:
 THE INVERT ELEVATION FOR LONGITUDINAL PIPE UNDERDRAINS SHALL BE 2.5' BELOW THE RIM ELEVATION OF THE INLET STRUCTURE. RIM ELEVATIONS FOR STRUCTURES ADJACENT TO CURB AND GUTTER ARE CALLED OUT TO THE EDGE OF PAVEMENT ELEVATION.

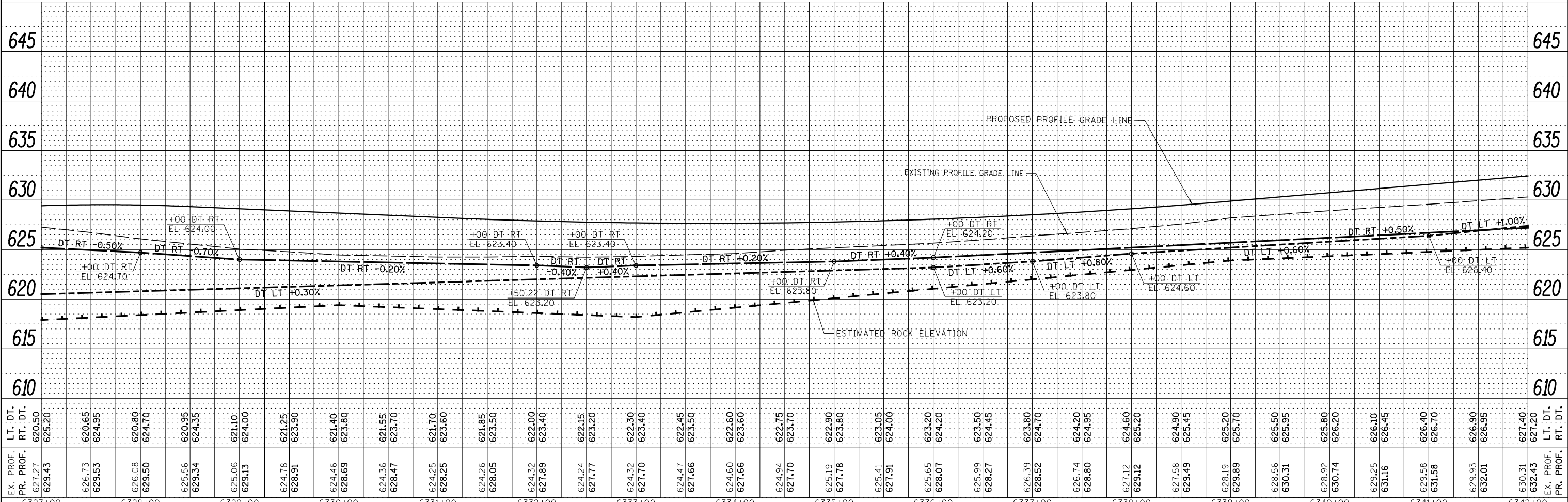

FILE NAME =	USER NAME = bdecreane	DESIGNED -	JJR	REVISED -	
V:\3195\66884 (North Section)\CADD Sheets\0366884-sht-drain-6.dgn		DRAWN -	JJR	REVISED -	
SHT_PLNPROF		CHECKED -	GRE	REVISED -	
		DATE -	7/01/2014	REVISED -	

STATE OF ILLINOIS
 DEPARTMENT OF TRANSPORTATION

IL. RTE. 47
 STORM SEWER AND UTILITIES PLAN & PROFILE

SCALE: H=50 V=5 SHEET 6 OF 39 SHEETS STA. 6327+00 TO STA. 6342+00

F.A.P. R.E.	SECTION	COUNTY	TOTAL SHEETS	SHEET NO.
326	(109, 110)R-1	KENDALL	619	246
CONTRACT NO. 66884				
ILLINOIS FED. AID PROJECT				