

PLAN	SURVEYED	DATE
	PLOTTED	
	ALIGNED	
	CHECKED	
	FILED	
	NO.	

PROFILE	SURVEYED	DATE
	PLOTTED	
	GRADES	
	CHECKED	
	STRUCTURE	
	NOTATIONS	
	CHKD	
	NO.	

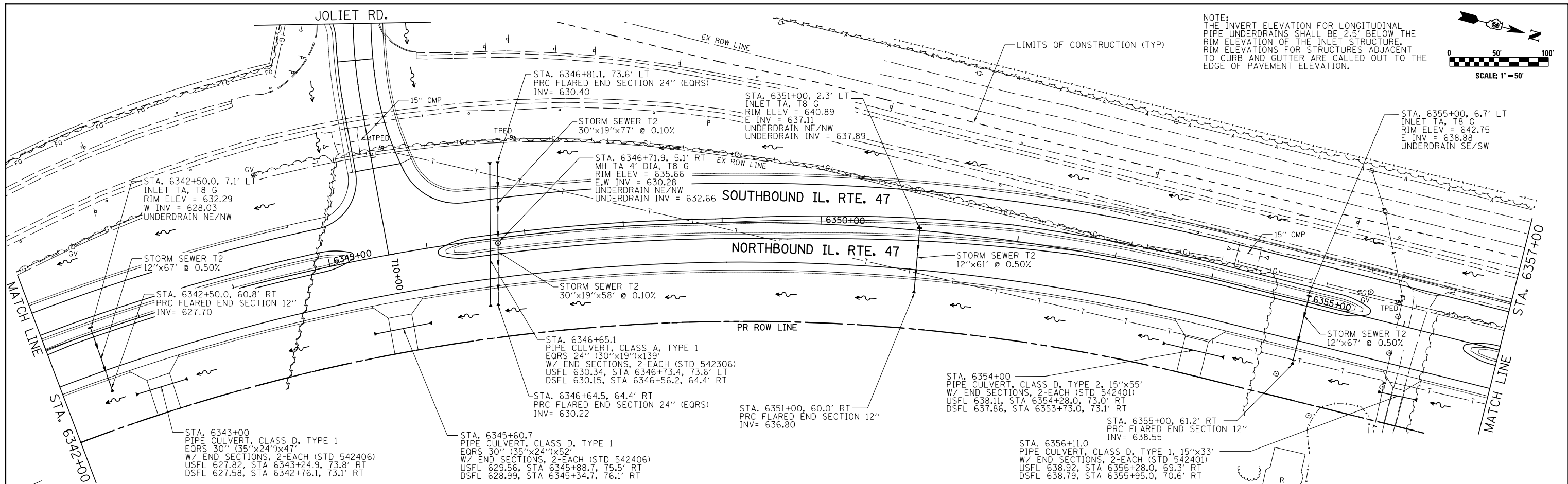

NOTE:
 THE INVERT ELEVATION FOR LONGITUDINAL PIPE UNDERDRAINS SHALL BE 2.5' BELOW THE RIM ELEVATION OF THE INLET STRUCTURE. RIM ELEVATIONS FOR STRUCTURES ADJACENT TO CURB AND GUTTER ARE CALLED OUT TO THE EDGE OF PAVEMENT ELEVATION.

SCALE: 1" = 50'

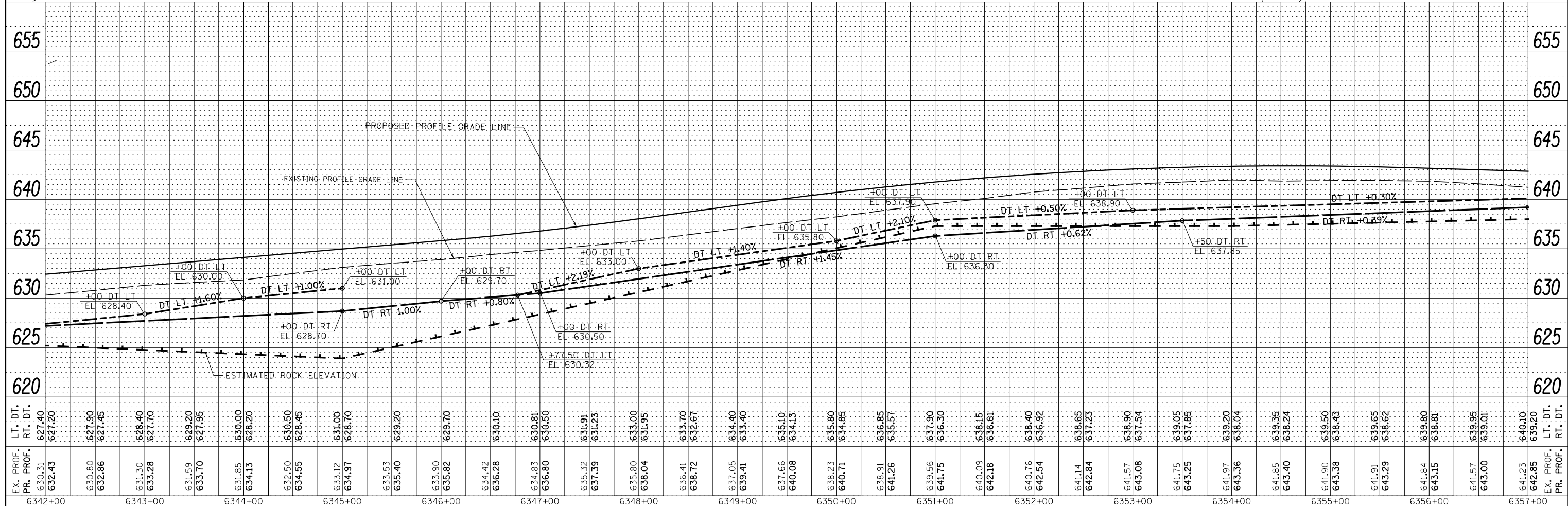

FILE NAME =	USER NAME = bdecreane	DESIGNED - JUR	REVISED -	F.A.P. RTE. 326	SECTION (109, 110IR-1)	COUNTY KENDALL	TOTAL SHEETS 619	SHEET NO. 247
V:\3195\66884 (North Section)\CADD Sheets\0366884-shd-drain-7.dgn		DRAWN - JUR	REVISED -	STATE OF ILLINOIS DEPARTMENT OF TRANSPORTATION				CONTRACT NO. 66884
PLOT SCALE = 100.0000' / in.		CHECKED - GRE	REVISED -	IL. RTE. 47 STORM SEWER AND UTILITIES PLAN & PROFILE				
PLOT DATE = 7/14/2014		DATE - 7/01/2014	REVISED -	SCALE: H=50 V=5 SHEET 7 OF 39 SHEETS STA. 6342+00 TO STA. 6357+00				ILLINOIS FED. AID PROJECT