

PLAN	SURVEYED	DATE
	PLOTTED	
	ALIGNED	
	CHECKED	
	DESIGNED	
	BY	
	NO.	

PROFILE	SURVEYED	DATE
	PLOTTED	
	GRADES	
	CHECKED	
	DESIGNED	
	BY	
	NO.	

STA 6490+51.3-30° RT AHD (PROP. SN 047-2032)
 PROPOSED 2-12"x6' PCBC
 USFL 627.99
 DSLF 627.82

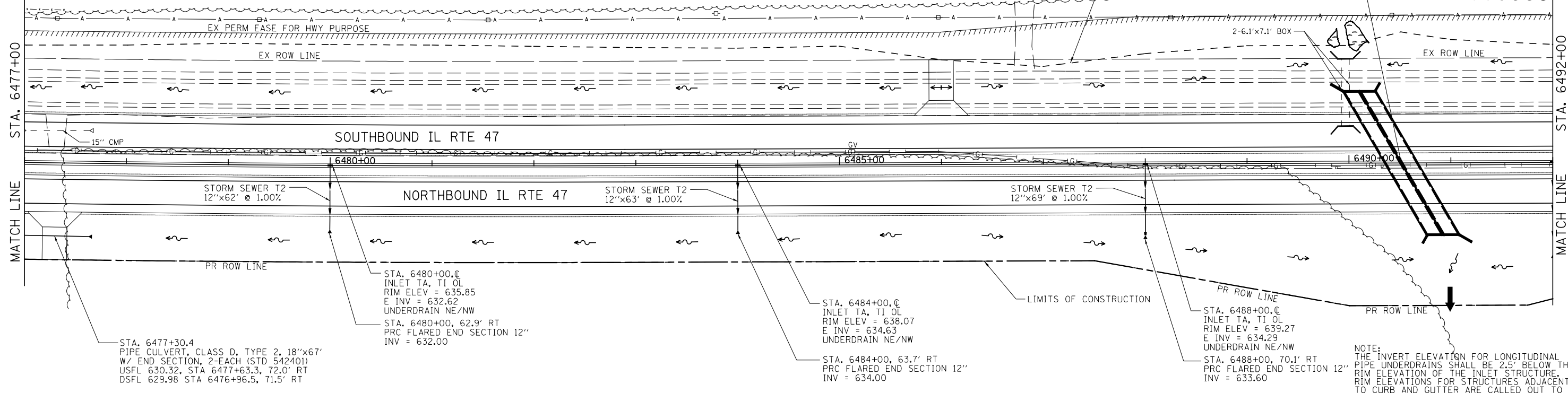
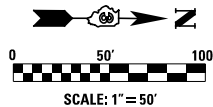

STA. 6477+30.4
 PIPE CULVERT, CLASS D, TYPE 2, 18"x67"
 W/ END SECTION, 2-EACH (STD 542401)
 USFL 630.32, STA 6477+63.3, 72.0' RT
 DSFL 629.98 STA 6476+96.5, 71.5' RT

STA. 6480+00, C
 INLET TA, TI OL
 RIM ELEV = 635.85
 E INV = 632.62
 UNDERDRAIN NE/NW
 STA. 6480+00, 62.9' RT
 PRC FLARED END SECTION 12"
 INV = 632.00

STA. 6484+00, C
 INLET TA, TI OL
 RIM ELEV = 638.07
 E INV = 634.63
 UNDERDRAIN NE/NW
 STA. 6484+00, 63.7' RT
 PRC FLARED END SECTION 12"
 INV = 634.00

STA. 6488+00, C
 INLET TA, TI OL
 RIM ELEV = 639.27
 E INV = 634.29
 UNDERDRAIN NE/NW
 STA. 6488+00, 70.1' RT
 PRC FLARED END SECTION 12"
 INV = 633.60

NOTE:
 THE INVERT ELEVATION FOR LONGITUDINAL
 PIPE UNDERDRAINS SHALL BE 2.5' BELOW THE
 RIM ELEVATION OF THE INLET STRUCTURE.
 RIM ELEVATIONS FOR STRUCTURES ADJACENT
 TO CURB AND GUTTER ARE CALLED OUT TO THE
 EDGE OF PAVEMENT ELEVATION.

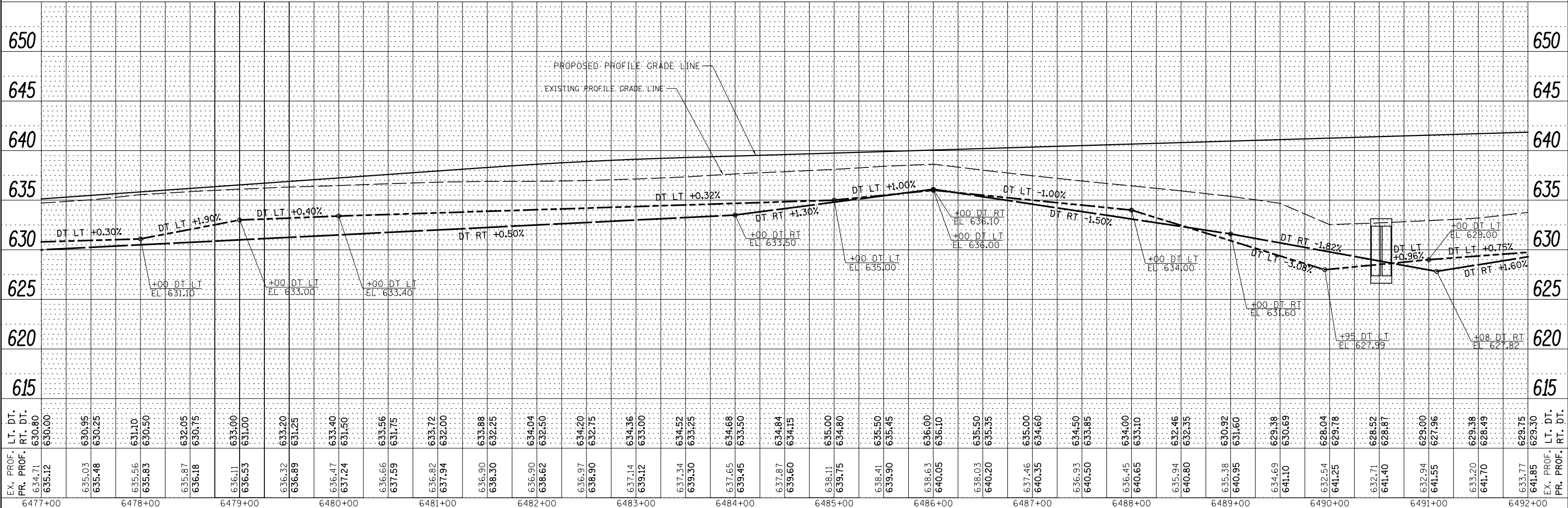

EX. PROF. PR. PROF.	LT. DT. RT. DT.	6477+00	6478+00	6479+00	6480+00	6481+00	6482+00	6483+00	6484+00	6485+00	6486+00	6487+00	6488+00	6489+00	6490+00	6491+00	6492+00	EX. PROF. PR. PROF.	LT. DT. RT. DT.
634.71 635.12	630.80 630.00																	641.85 641.85	629.30 629.30
635.03 635.48	630.95 630.25																	633.77 633.77	629.75 629.75
635.56 635.83	631.10 630.50																	633.20 633.20	629.38 629.38
635.87 636.18	632.05 630.75																	632.71 632.71	628.52 628.52
636.11 636.53	633.00 631.00																	632.40 632.40	628.87 628.87
636.32 636.89	633.20 631.25																	632.94 632.94	629.00 629.00
636.47 637.24	633.40 631.50																	633.00 633.00	629.38 629.38
636.66 637.59	633.56 631.75																	633.03 633.03	629.49 629.49
636.82 637.94	633.72 632.00																	633.11 633.11	629.75 629.75
636.90 638.30	633.88 632.25																	633.15 633.15	629.96 629.96
636.90 638.62	634.04 632.50																	633.18 633.18	630.00 630.00
636.97 638.90	634.20 632.75																	633.25 633.25	630.38 630.38
637.14 639.12	634.36 633.00																	633.35 633.35	630.69 630.69
637.34 639.50	634.52 633.25																	633.40 633.40	631.00 631.00
637.65 639.45	634.68 633.50																	633.45 633.45	631.60 631.60
637.87 639.60	634.84 634.15																	633.50 633.50	632.00 632.00
638.11 639.75	635.00 634.80																	633.55 633.55	632.35 632.35
638.41 639.90	635.50 635.45																	633.60 633.60	632.46 632.46
638.63 640.05	636.00 636.10																	633.65 633.65	632.99 632.99
638.03 640.20	635.50 635.35																	633.70 633.70	633.00 633.00
637.46 640.35	635.00 634.60																	633.75 633.75	633.35 633.35
636.93 640.50	634.50 633.85																	633.80 633.80	633.60 633.60
636.45 640.65	634.00 633.10																	633.85 633.85	634.00 634.00
635.94 640.80	632.46 632.35																	633.90 633.90	634.46 634.46
635.38 640.95	630.92 631.60																	633.95 633.95	634.95 634.95
634.69 641.10	629.38 630.69																	634.00 634.00	635.00 635.00
632.54 641.25	628.04 629.78																	634.05 634.05	635.50 635.50
632.71 641.40	628.52 628.87																	634.10 634.10	636.00 636.00
632.94 641.55	629.00 629.96																	634.15 634.15	636.50 636.50
633.20 641.70	629.38 628.49																	634.20 634.20	637.00 637.00
633.77 641.85	629.75 629.30																	634.25 634.25	637.50 637.50

STATE OF ILLINOIS
 DEPARTMENT OF TRANSPORTATION

IL. RTE. 47
 STORM SEWER AND UTILITIES PLAN & PROFILE

SCALE: H=5' V=5' SHEET 16 OF 39 SHEETS STA. 6477+00 TO STA. 6492+00

F.A.P. RTE.	SECTION	COUNTY	TOTAL SHEETS	SHEET NO.
326	(109, 110R-1)	KENDALL	619	256
CONTRACT NO. 66B84			ILLINOIS FED. AID PROJECT	