

PLAN	SURVEYED	DATE
	PLOTTED	BY
	NOTE BOOK	
	NO.	
	CADD FILE NAME	

PROFILE	SURVEYED	DATE
	PLOTTED	BY
	NOTE BOOK	
	NO.	
	CADD FILE NAME	

IMPROVEMENT BEGINS  
STA 701+00

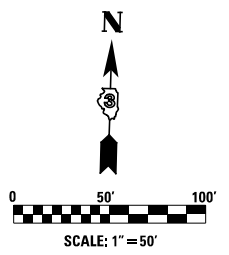
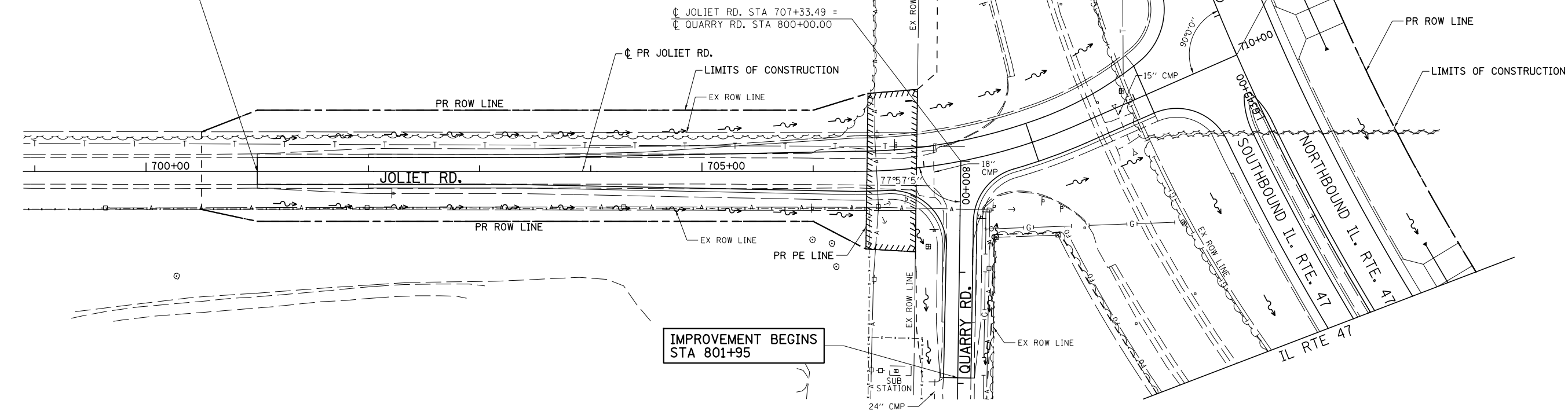

IMPROVEMENT BEGINS  
STA 801+95

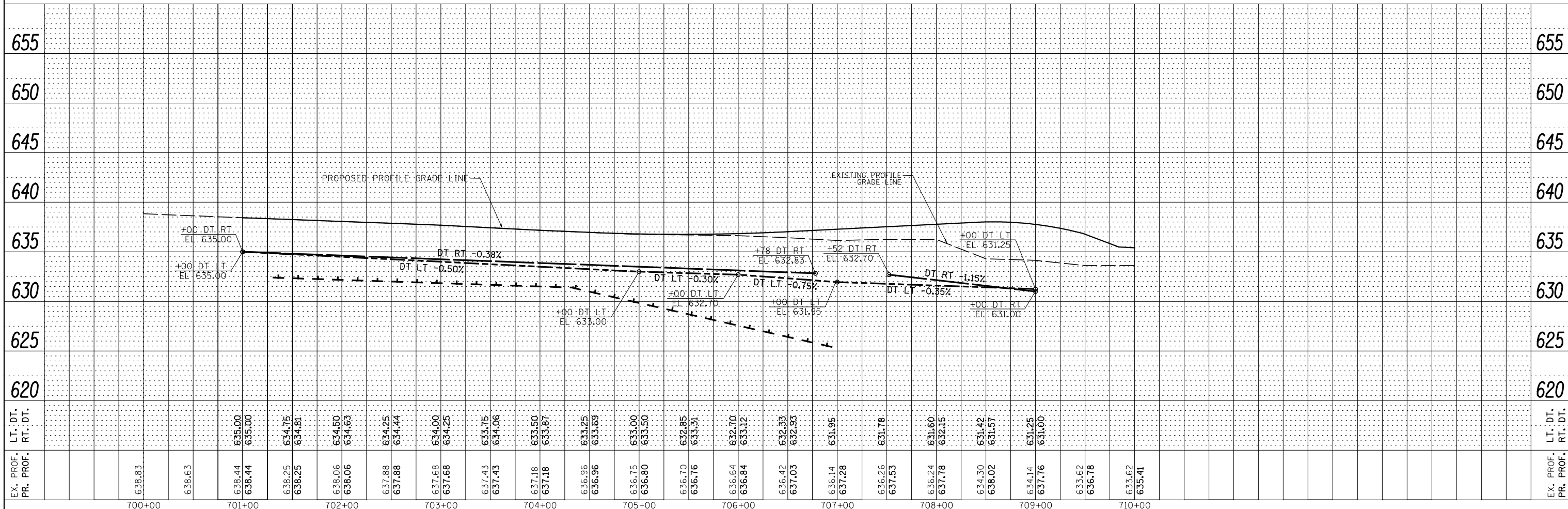

FILE NAME =	USER NAME = bdcraene	DESIGNED - JUR	REVISED -	<b>STATE OF ILLINOIS DEPARTMENT OF TRANSPORTATION</b>	<b>JOLIET RD. STORM SEWER AND UTILITIES PLAN &amp; PROFILE</b>		F.A.P. RTE. 326	SECTION (109, 110IR-1)	COUNTY KENDALL	TOTAL SHEETS 619	SHEET NO. 268	
V:\3195\66884 (North Section)\CADD Sheets\0366884-shr-drain-28.dgn	PLOT SCALE = 100.0000' / in.	DRAWN - JUR	REVISED -		SCALE: H=50 V=5	SHEET 28 OF 36 SHEETS	STA. 700+00 TO STA. 710+00	CONTRACT NO. 66884				
SHT_PLNPROF	PLOT DATE = 7/14/2014	CHECKED - GRE	REVISED -		ILLINOIS FED. AID PROJECT							
		DATE - 7/01/2014	REVISED -									