

PLAN	SURVEYED	DATE
	PLOTTED	
	NOTE BOOK	
	NO.	
	CHECKED	
	FILE NAME	

PROFILE	SURVEYED	DATE
	PLOTTED	
	GRADES CHECKED	
	NO.	
	STRUCTURE	
	NOTATIONS CHECKED	

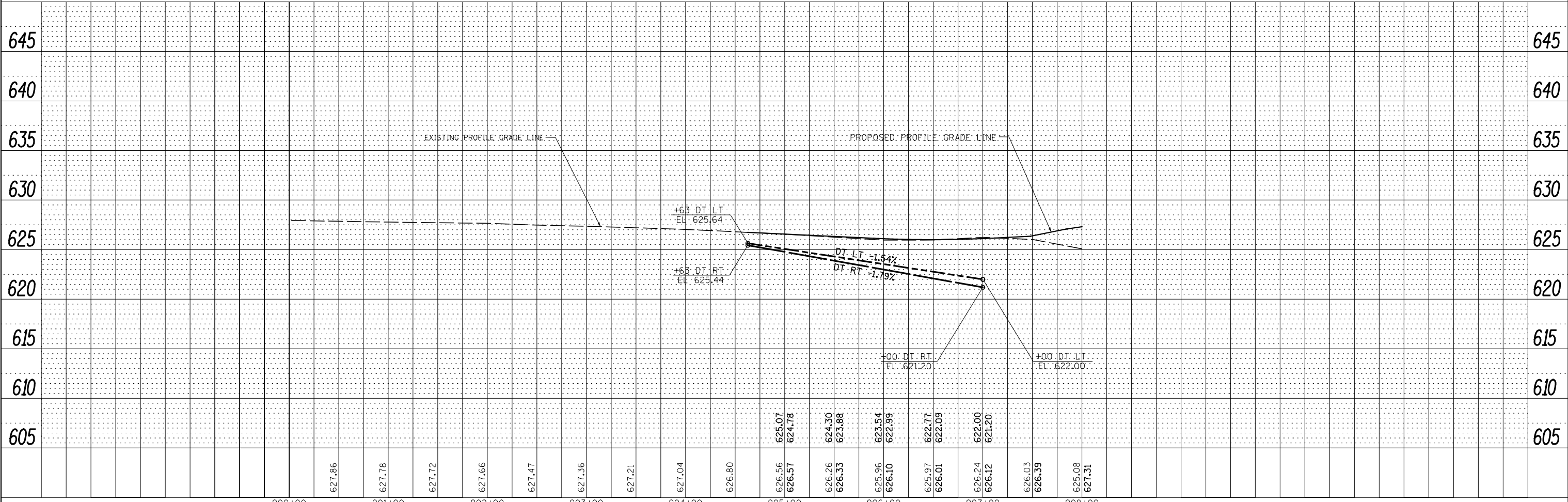
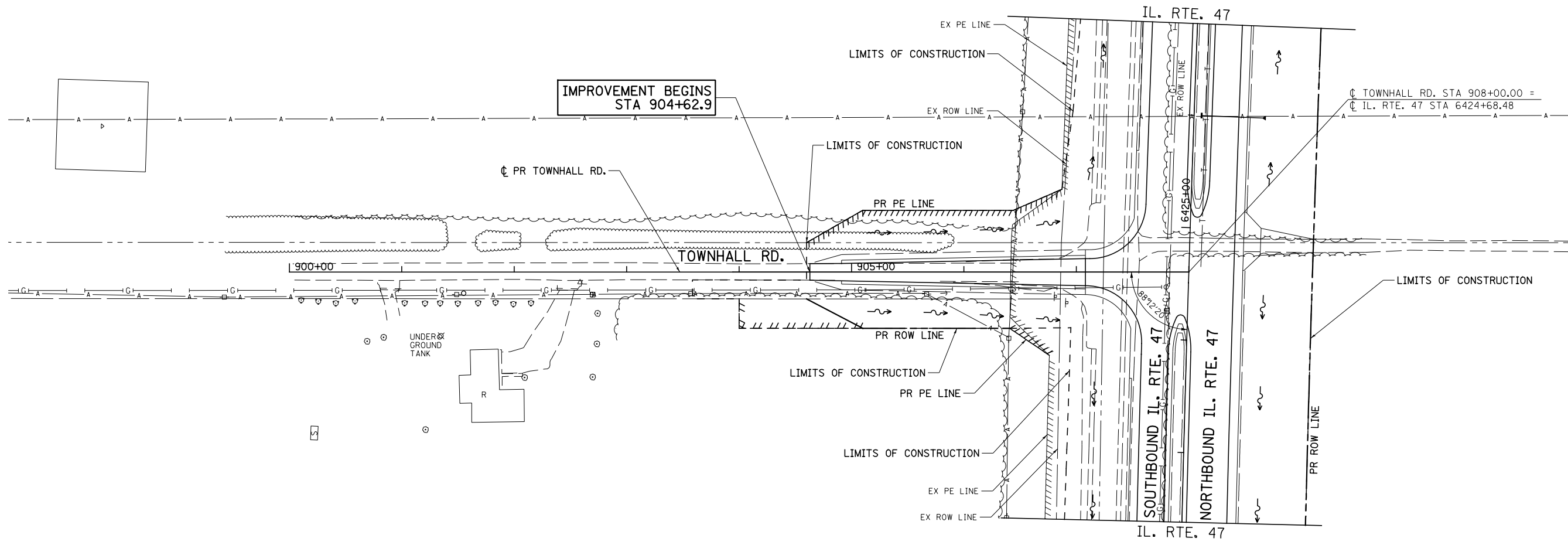

FILE NAME =	USER NAME = bdecreane	DESIGNED - JUR	REVISED -	<b>STATE OF ILLINOIS DEPARTMENT OF TRANSPORTATION</b>	<b>TOWNHALL RD. STORM SEWER AND UTILITIES PLAN &amp; PROFILE</b>				F.A.P. RTE. 326	SECTION (109, 110)R-1	COUNTY KENDALL	TOTAL SHEETS 619	SHEET NO. 270
V:\3195\66884 (North Section)\CADD Sheets\0366884-sht-drain-30.dgn	PLOT SCALE = 100.0000' / in.	DRAWN - JUR	REVISED -		SCALE: H=50 V=5	SHEET 30	OF 39 SHEETS	STA. 900+00	TO STA. 908+00	CONTRACT NO. 66884			
SHT_PLNPROF	PLOT DATE = 7/14/2014	CHECKED - GRE	REVISED -		ILLINOIS FED. AID PROJECT								
		DATE - 7/01/2014	REVISED -										