

PAVEMENT MARKING LEGEND

- | | |
|--|---|
| ① MODIFIED URETHANE PM - LINE 4" (SOLID WHITE) | ⑨ MODIFIED URETHANE PM - LINE 12" (SOLID WHITE) |
| ② MODIFIED URETHANE PM - LINE 4" (SOLID YELLOW) | ⑩ MODIFIED URETHANE PM - LINE 24" (SOLID WHITE) |
| ③ MODIFIED URETHANE PM LINE (WHITE 2' DASH-6' SKIP) | ⑪ RAISED REFLECTIVE PM (ONE-WAY CRYSTAL) |
| ④ PREFORMED PLASTIC PM TB INL L6 (WHITE 10' DASH-30' SKIP) | ⑫ PRISMATIC CURB REFLECTOR |
| ⑤ MODIFIED URETHANE PM - LINE 4" (DOUBLE YELLOW) | ⑬ MODIFIED URETHANE PM - LETTERS & SYMBOLS |
| ⑥ MODIFIED URETHANE PM - LINE 8" (WHITE 2' DASH-6' SKIP) | ⑭ GROOVING FOR RECESSED PAVEMENT MARKING 5" |
| ⑦ MODIFIED URETHANE PM - LINE 8" (SOLID WHITE) | ⑮ GROOVING FOR RECESSED PAVEMENT MARKING 7" |
| ⑧ MODIFIED URETHANE PM - LINE 12" (SOLID YELLOW) | ⑯ GROOVING FOR RECESSED PAVEMENT MARKING 9" |
| | ⑰ RAISED REFLECTIVE PM (TWO-WAY AMBER) |

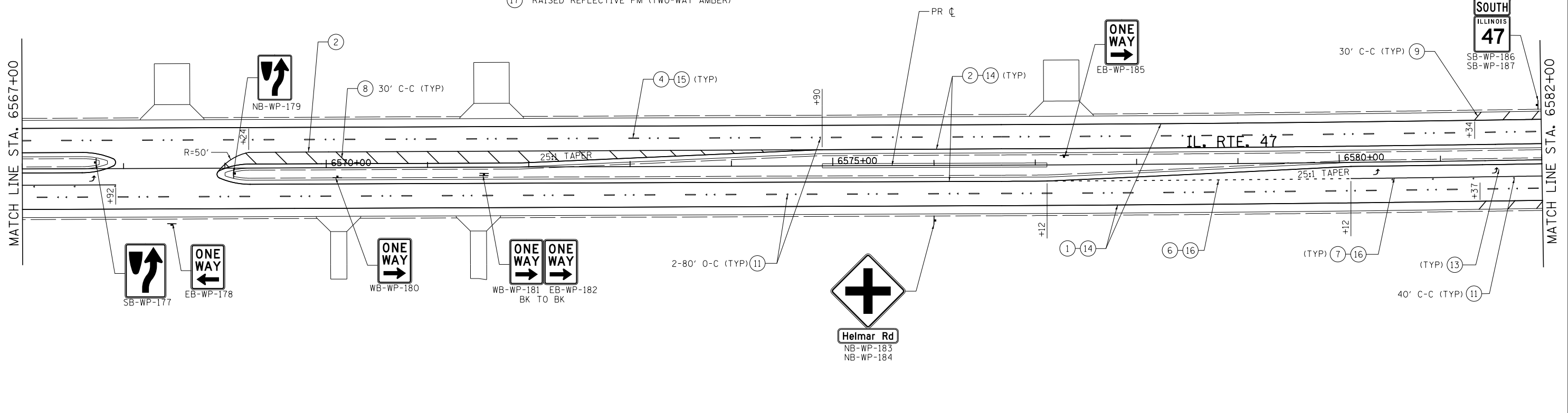

FILE NAME =	USER NAME = bdecreene	DESIGNED - SL	REVISED -	STATE OF ILLINOIS DEPARTMENT OF TRANSPORTATION	IL. RTE. 47 PAVEMENT MARKING AND SIGNING PLANS	F.A.P. RTE.	SECTION	COUNTY	TOTAL SHEETS	SHEET NO.	
W:\3195\66884 (North Section)\CADD Sheets\0366884-sht\pmk-11.dgn	PLOT SCALE = 100.0000' / in.	DRAWN - SL	REVISED -			326	(109, 110R-1)	KENDALL	619	324	
SHT_DOUBLE PLAN	PLOT DATE = 7/14/2014	CHECKED - ST	REVISED -			CONTRACT NO. 66884					
		DATE - 7/01/2014	REVISED -			ILLINOIS FED. AID PROJECT					