

NOTE

1. INSTALL 2" P.V.C. CONDUIT RACEWAY IN PROPOSED FOUNDATION FOR FUTURE EXPANSION OF LIGHTING SYSTEM. EXTEND 2' OUT FROM FOUNDATION. CAP AND SEAL. COST OF CONDUIT RACEWAY SHALL BE CONSIDERED INCLUDED IN COST OF "LIGHT POLE FOUNDATION".
2. INSTALL ADDITIONAL 2" GALVANIZED RIGID CONDUIT RACEWAY IN PROPOSED STREET LIGHTING CONTROLLER FOUNDATION FOR FUTURE CONNECTION TO COMBINATION TRAFFIC/LIGHTING POLE LUMINAIRES. EXTEND 2' OUT FROM FOUNDATION. CAP AND SEAL CONDUIT. COST OF CONDUIT RACEWAY SHALL BE CONSIDERED INCLUDED IN COST OF "LIGHTING CONTROLLER, PEDESTAL MOUNTED, 480 VOLT, 60 AMP".

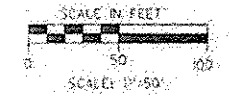
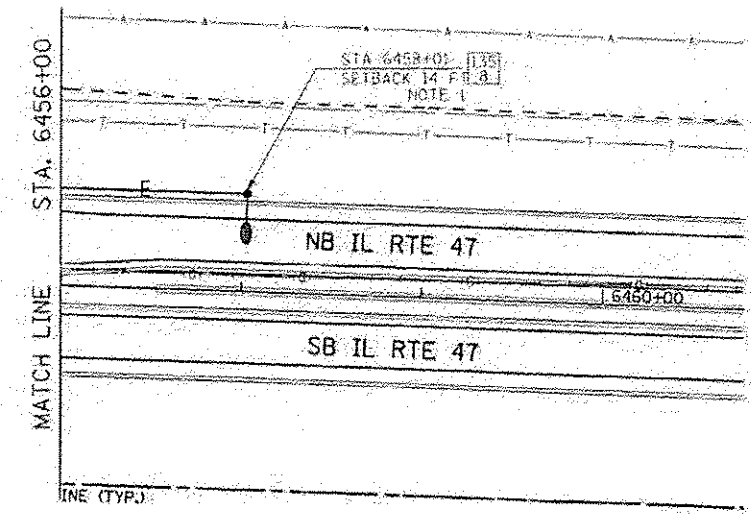
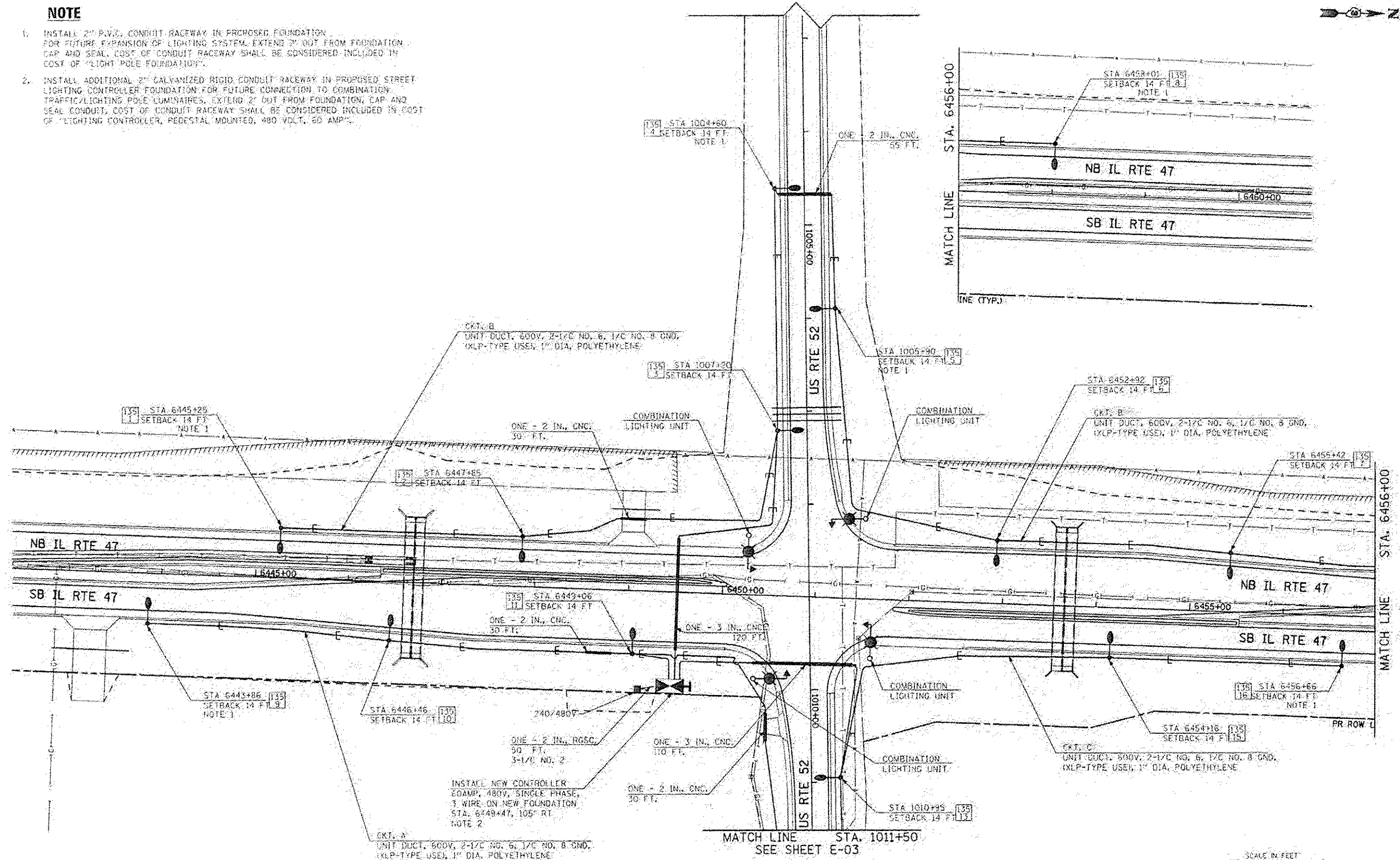
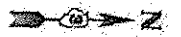

FILE NAME: \\V:\305166804\North\Geospatial\ASD\Sheet\20255804-lighting 2.dgn	USER NAME: jbidartene	DESIGNED: BG	EJM ENGINEERING, INC. 411 South Wells Street, Suite 1000 Chicago, Illinois 60607	STATE OF ILLINOIS DEPARTMENT OF TRANSPORTATION	ILLINOIS ROUTE 47 AT US 52 LIGHTING PLAN	FLAT: 100%	SECTION: 1109, 1109R, 1109R & BR-1	COUNTY: GRUNDY	TOTAL SHEETS: 619	SHEET NO.: 365		
PLT SCALE: 1/8"=1'-0"	CHECKED: VR	DATE: 7/01/2014				SCALE: 1"=50'	SHEET: 2 OF 4 SHEETS	STA: 6442+80 TO STA: 6459+05	PRELIMINARY	UNDESIGNED	AS PROJECT	CONTRACT NO. 66884
PLT DATE: 7/14/2014	DATE: 7/01/2014											

E-02