

EXIST. CURVE 1571R0-5
 PI STA. = 216+54.70
 $\Delta = 44^\circ 20' 26''$ (LT)
 $D = 0^\circ 45' 00''$
 $R = 7,639.63'$
 $T = 3,113.05'$
 $L = 5,912.22'$
 $E = 609.92'$
 $e = 0.0263$
 P.C. STA. = 185+41.65
 P.T. STA. = 244+53.87
 SUPER TRANSITIONS
 STA. 184+43.86 TO STA. 185+67.86
 STA. 244+27.66 TO STA. 245+51.66

BENCHMARKS						
NO.	NORTHING	EASTING	STATION	OFFSET	ELEVATION	DESCRIPTION
1167	1538919.6340	1086597.9300	1167+47.56	0.2146' LT	671.60	SURV MARK-BRASS PLUG
105			105+00.00	83' RT	674.13	80d SPIKE IN GUARDRAIL POST
109			108+35.00	82' RT	673.09	80d SPIKE IN GUARDRAIL POST
112			112+08.00	83' RT	669.92	CHIS "CJ" TOP CENTER HEADWALL
118			117+72.00	72' RT	669.36	CHIS "X" NE BOLT LIGHT FDN
122	1536850.0730	1085763.9040	122+31.02	0.1080' LT	666.35	SURV MARK-BRASS PLUG
127			127+43.00	12' LT	667.20	CHIS "CJ" TOP CENTER HEADWALL
132			132+00.00	2.0' LT	667.14	CHIS "CJ" TOP CENTER HEADWALL
134	1535738.6450	1085315.9210	134+12.31	123.94' LT	666.45	SURV MARK-BRASS PLUG
140			140+00.00	107' RT	667.36	CHIS "CJ" TOP CENTER HEADWALL
146	1534992.5060	1084332.6570	146+20.00	161' RT	668.05	ASHKUM YARD-BRASS PLUG
151			151+00.00	100' RT	672.40	TOP ROW MARKER
157			156+73.00	100' RT	670.42	80d SPIKE IN FENCE POST
161			161+00.00	100' RT	670.00	TOP ROW MARKER
166			166+97.89		663.43	SURV MARK-BRASS PLUG
176			176+00.00	100' RT	670.69	TOP ROW MARKER
180			180+00.00	83.5' RT	672.61	CHIS "CJ" TOP NW COR HEADWALL
185	1532136.6790	1081641.1480	185+40.98	0.0424' RT	670.59	SURV MARK-BRASS PLUG
191			191+00.00	105' RT	668.74	TOP ROW MARKER
200	1531022.9970	1080703.1810	199+99.84	0.0256' RT	667.47	SURV MARK-BRASS PLUG
204			204+69.76	93.5' RT	663.61	CHIS "CJ" TOP NW COR HEADWALL
209			209+40.00	100' RT	670.47	80d SPIKE IN FENCE POST
214	1529714.9300	1079997.7300	214+98.02	0.1445' LT	665.99	SURV MARK-BRASS PLUG
220			220+23.00	100' RT	667.13	TOP ROW MARKER
230	1528286.4900	1079519.8390	230+00.49	0.0241' RT	665.51	SURV MARK-BRASS PLUG
234			234+59.00	105' RT	666.50	80d SPIKE IN FENCE POST
240			240+00.00	100' RT	666.36	TOP ROW MARKER
244	1526845.1050	1079351.0080	244+53.92	0.0267' LT	668.84	SURV MARK-BRASS PLUG
250			248+92.00	100' RT	670.47	80d SPIKE IN FENCE POST
254			253+91.00	100' RT	668.38	80d SPIKE IN FENCE POST
259	1525399.3570	1079319.7990	259+00.00	0.0688' RT	665.95	SURV MARK-BRASS PLUG
262	1525099.4560	1079313.3230	261+99.97	0.0908' RT	664.98	SURV MARK-BRASS PLUG
271			271+00.00	100' RT	663.99	TOP ROW MARKER
277	1523600.0640	1079281.0920	276+99.71	0.0539' RT	663.22	SURV MARK-BRASS PLUG
284			283+79.45	100' RT	669.31	TOP ROW MARKER
288			287+64.00	100' RT	664.26	80d SPIKE IN FENCE POST
295	1521771.2330	1079241.7950	295+28.97	0.0067' LT	661.05	SURV MARK-BRASS PLUG
300			299+81.00	100' RT	659.27	80d SPIKE IN FENCE POST
306			305+82.00	109' RT	659.21	80d SPIKE IN FENCE POST
315			315+30.00	83.5' RT	658.33	CHIS "CJ" TOP NW COR HEADWALL
320	1519411.7820	1078360.0360	320+95.93	0.3076' RT	657.58	SURV MARK-BRASS PLUG
327	1518938.1800	1077966.5760	327+11.65	0.1116' RT	661.08	SURV MARK-BRASS PLUG
332			331+67.00	100' RT	663.88	80d SPIKE IN FENCE POST
337			336+61.00	100' RT	661.07	80d SPIKE IN FENCE POST
342			341+51.00	100' RT	660.81	80d SPIKE IN FENCE POST
348			348+04.00	68' RT	660.17	CHIS "CJ" TOP NW COR WINGWALL
351	1516755.3660	1077092.9410	351+01.56	0.0024' LT	665.22	SURV MARK-BRASS PLUG

HORIZONTAL CONTROL POINTS - I-57					
POINT	NORTHING	EASTING	STATION	OFFSET	DESCRIPTION
1086	1546461.6540	1089636.6590	1086+16.39	0.0271' RT	PT-PERMANENT SURVEY MARKER
1100	1545178.0430	1089119.5720	1100+00.24	0.0959' LT	POT-PERMANENT SURVEY MARKER
1110	1544250.6430	1088745.8910	1110+00.10	0.1019' LT	POT-PERMANENT SURVEY MARKER
1120	1543323.3440	1088372.2480	1119+99.84	0.1055' LT	POT-PERMANENT SURVEY MARKER
1130	1542395.7290	1087998.4840	1129+99.93	0.1149' LT	POT-PERMANENT SURVEY MARKER
1140	1541468.5560	1087624.8190	1039+99.56	0.0510' LT	POT-PERMANENT SURVEY MARKER
1150	1540540.3490	1087250.8900	1150+00.26	0.1287' LT	POT-PERMANENT SURVEY MARKER
1160	1539612.6670	1086877.1120	1160+00.41	0.1501' LT	POT-PERMANENT SURVEY MARKER
1167	1538919.6340	1086597.9300	1167+47.56	0.2146' LT	POT-PERMANENT SURVEY MARKER
122	1536850.0730	1085763.9040	122+31.02	0.1080' LT	PC-PERMANENT SURVEY MARKER
129	1536185.8592	1085445.0974	129+68.28	0.0169' LT	BRIDGE DECK
134	153738.6450	1085315.9210	134+12.31	123.94' LT	PJ
145	1534899.6986	1084460.0878	145+93.74		PT
185	1532136.6790	1081641.1480	185+40.98	0.0424' RT	PC-PERMANENT SURVEY MARKER
200	1531022.9970	1080703.1810	199+99.84	0.0256' RT	POC-PERMANENT SURVEY MARKER
214	1529714.9300	1079977.7300	214+98.02	0.1445' LT	POC-PERMANENT SURVEY MARKER
230	1528286.4900	1079519.8390	230+00.49	0.0241' RT	POC-PERMANENT SURVEY MARKER
244	1526845.1050	1079351.0080	244+53.92	0.0267' LT	PT-PERMANENT SURVEY MARKER
259	1525399.3570	1079319.7990	259+00.00	0.0688' RT	POT
260	1525251.7930	1079316.6460	260+47.60	0.0462' RT	BRIDGE DECK
262	1525099.4560	1079313.3230	261+99.97	0.0908' RT	POT
277	1523600.0640	1079281.0920	276+99.71	0.0539' RT	POT
295	1521771.2330	1079241.7950	295+28.97	0.0067' LT	PC-PERMANENT SURVEY MARKER
314	1519983.1860	1078750.0880	314+02.85	2.9874' RT	BRIDGE DECK
320	1519411.7820	1078360.0360	320+95.93	0.3076' RT	PT-PERMANENT SURVEY MARKER
327	1518938.1800	1077966.5760	327+11.65	0.1116' RT	PC-PERMANENT SURVEY MARKER
351	1516755.3660	1077092.9410	351+01.56	0.0024' LT	PT-PERMANENT SURVEY MARKER

HORIZONTAL CONTROL POINTS					
POINT	NORTHING	EASTING	STATION	OFFSET	DESCRIPTION
2500N					
139	1525189.8304	1077817.9746	0+00.00		POT
140	1525214.3831	1078442.5522	6+25.06		POT
141	1525251.7920	1079316.6921	15+00.00		POT
142	1525286.4726	1080127.0804	23+11.13		POT
143	1525360.4670	1081865.5900	40+51.21		POT
2400N					
135	1519893.0620	1076818.7460	10+63.03		POT
136	1519939.2727	1077821.1894	20+66.54		POT
137	1519983.3524	1078753.6080	30+00.00		POT
138	1520039.1180	1079933.2190	41+80.93		POT

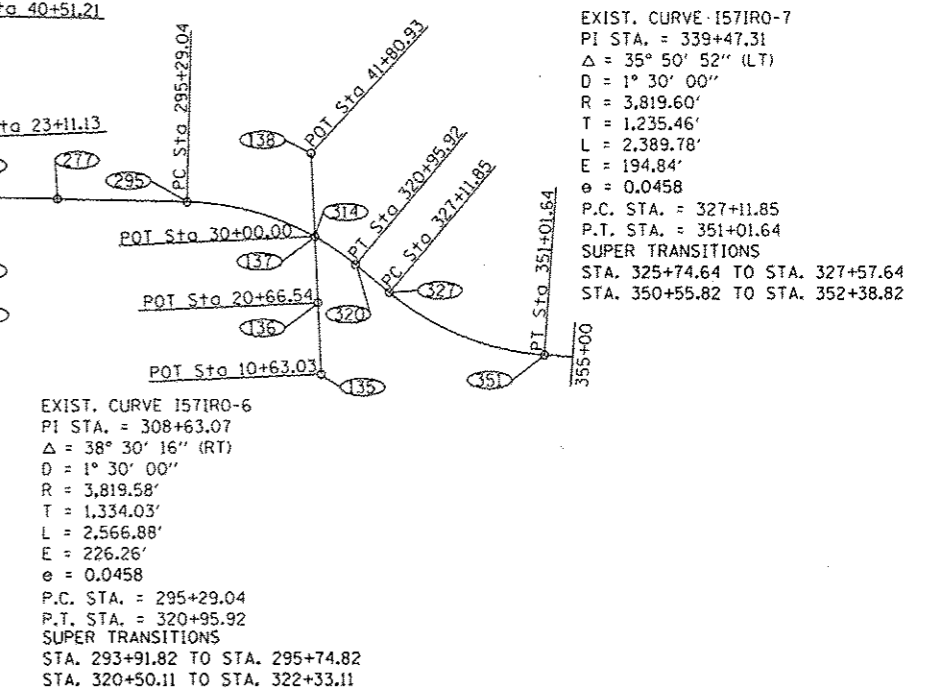

EXIST. CURVE 1571R0-7
 PI STA. = 339+47.31
 $\Delta = 35^\circ 50' 52''$ (LT)
 $D = 1^\circ 30' 00''$
 $R = 3,819.60'$
 $T = 1,235.46'$
 $L = 2,389.78'$
 $E = 194.84'$
 $e = 0.0458$
 P.C. STA. = 327+11.85
 P.T. STA. = 351+01.64
 SUPER TRANSITIONS
 STA. 325+74.64 TO STA. 327+57.64
 STA. 350+55.82 TO STA. 352+38.82

EXIST. CURVE 1571R0-6
 PI STA. = 308+63.07
 $\Delta = 38^\circ 30' 16''$ (RT)
 $D = 1^\circ 30' 00''$
 $R = 3,819.58'$
 $T = 1,334.03'$
 $L = 2,566.88'$
 $E = 226.26'$
 $e = 0.0458$
 P.C. STA. = 295+29.04
 P.T. STA. = 320+95.92
 SUPER TRANSITIONS
 STA. 293+91.82 TO STA. 295+74.82
 STA. 320+50.11 TO STA. 322+33.11