

PNT 76 POT STA. 0+00 RAMP C

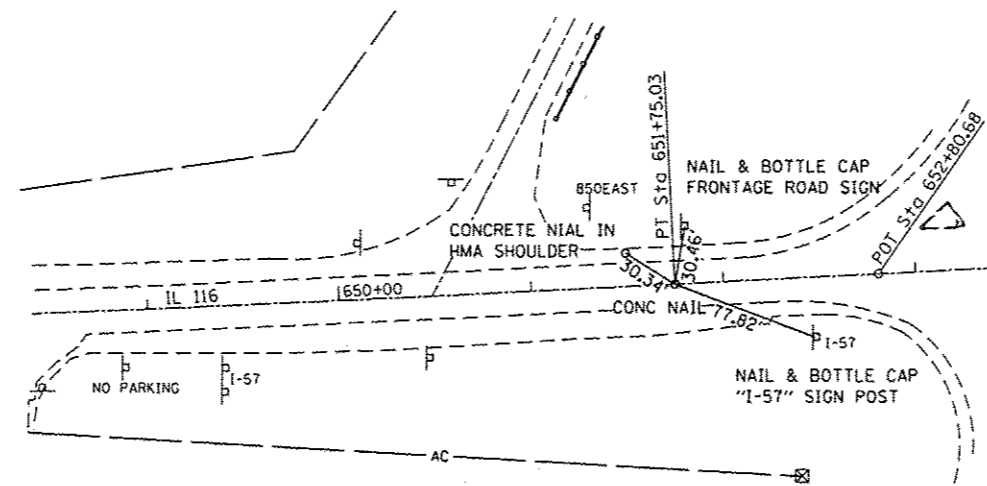

PNT PT116CL-1 PT STA. 651+75.03 IL 116

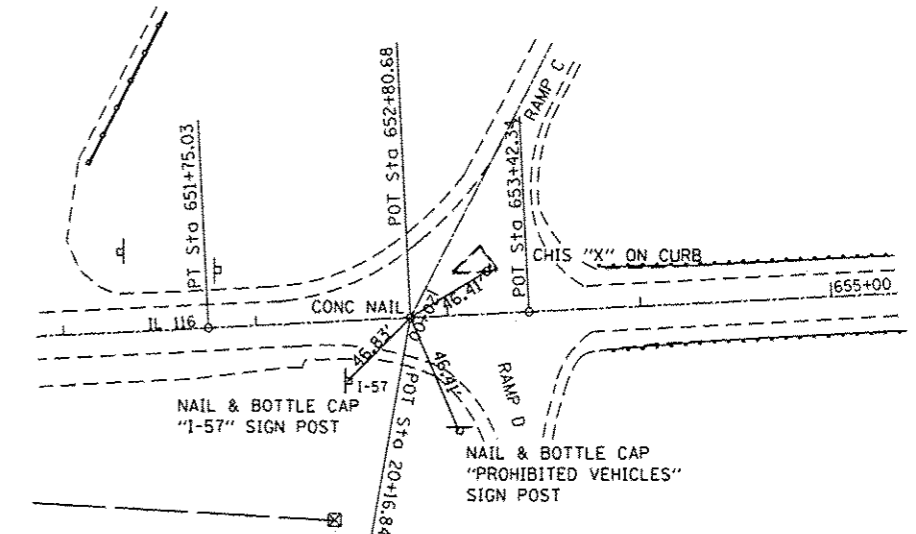

PNT 77 POT STA. 20+16.84 RAMP C
PNT 81 POT STA. 652+80.68 IL 116

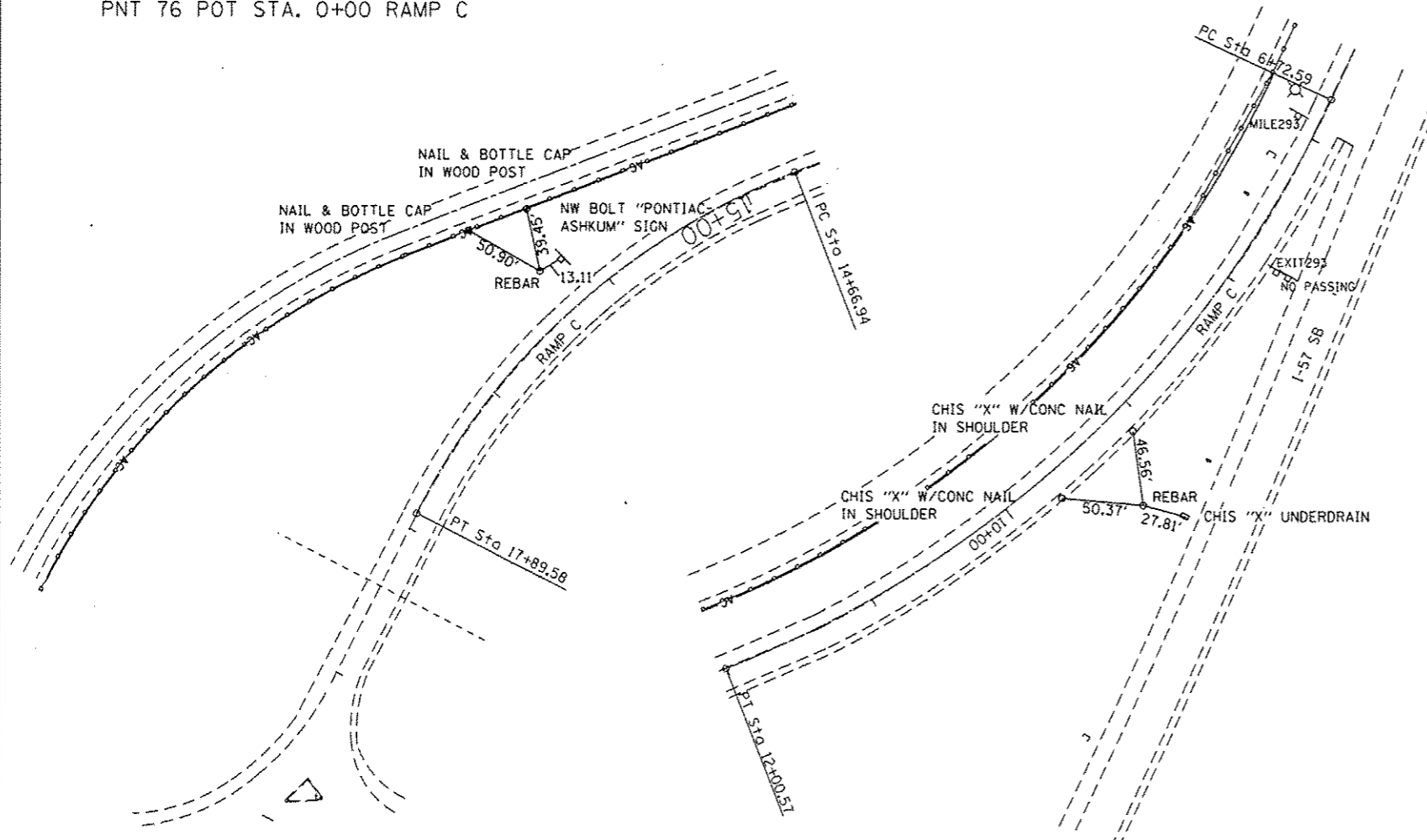

PNT 108 PI STA. 16+35.76 RAMP C

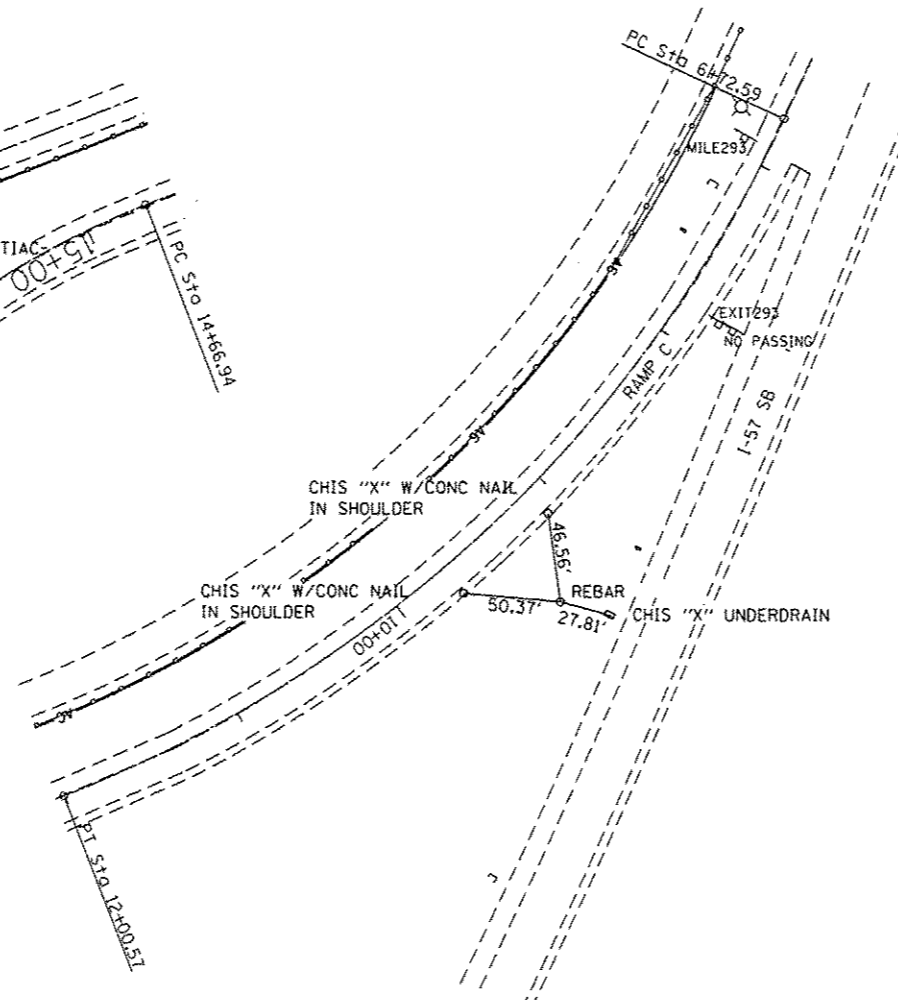

PNT 107 PI STA. 9+50.26 RAMP C

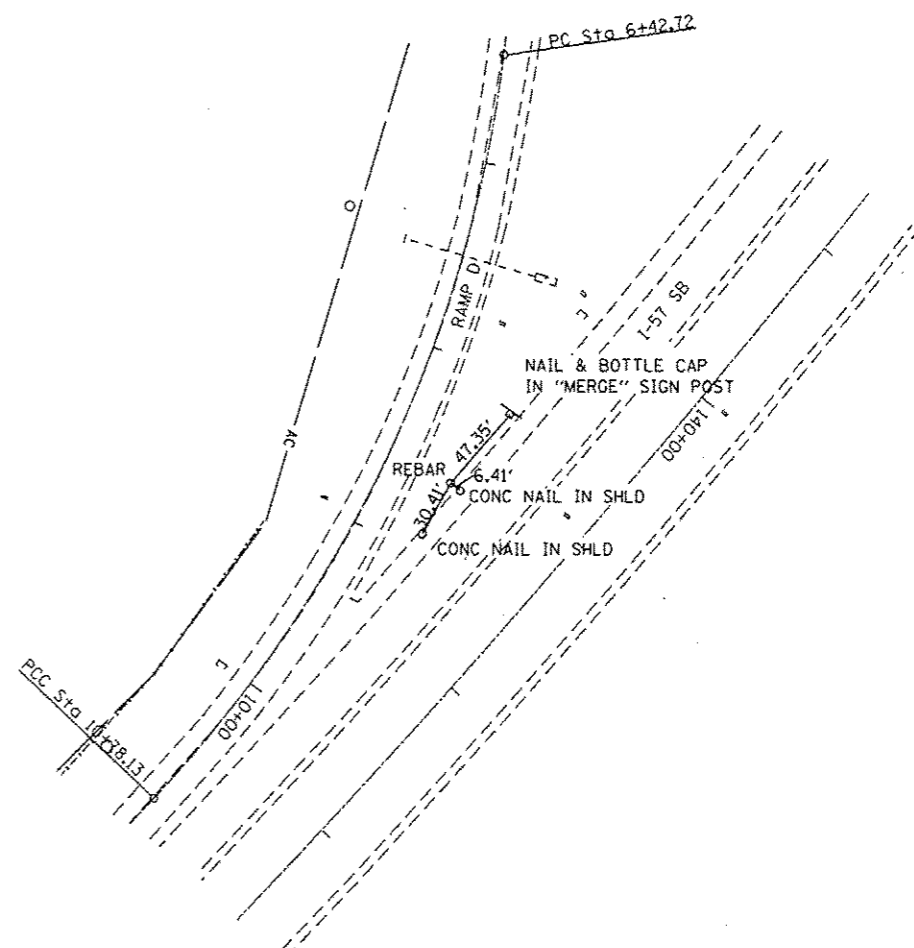

PNT 109 PI STA. 8+67.95 RAMP D

FILE NAME: c:\pwworkspace\p1dot\duncanbd\10315542\036653-aht-alignment-ties.dgn	USER NAME: duncanbd	DESIGNED: -	REVISED: -	STATE OF ILLINOIS DEPARTMENT OF TRANSPORTATION	ALIGNMENT & SURVEY TIES		F.A.I. RTE. 57	SECTION (38-31RS-2)	COUNTY IROQUOIS	TOTAL SHEETS 186	SHEET NO. 20	
PLOT SCALE: 1/8" = 1'-0"	CHECKED: -	REVISED: -	REVISED: -		SCALE:	SHEET NO. 4 OF 6 SHEETS	STA. TO STA.	CONTRACT NO. 66C53				
PLOT DATE: 6/18/2014	DATE: -	REVISED: -	REVISED: -		ILLINOIS FED. AID PROJECT							