

EXIST. CURVE 1571R0-5
 PI STA. = 216+54.70
 $\Delta = 44^\circ 20' 26''$ (LT)
 $D = 0^\circ 45' 00''$
 $R = 7,639.63'$
 $T = 3,113.05'$
 $L = 5,912.22'$
 $E = 609.92'$
 $e = 0.0263$
 P.C. STA. = 185+41.65
 P.T. STA. = 244+53.87

SUPER TRANSITIONS
 STA. 184+43.86 TO STA. 185+67.86
 STA. 244+27.66 TO STA. 245+51.66

STA. 216+92
 MEDIAN INLET
 36"X5' RCCP
 NO WORK

STA. 205+14
 SB 24"X98' RCCP
 NO WORK

STA. 217+00
 SB 36"X159' RCCP
 NO WORK

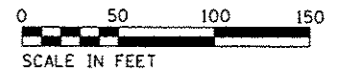

DATE	
BY	
REVISIONS	
PLANNED	
ALIGNED	
CHECKED	
NO. 1	
NO. 2	
NO. 3	
NO. 4	
NO. 5	
NO. 6	
NO. 7	
NO. 8	
NO. 9	
NO. 10	
NO. 11	
NO. 12	
NO. 13	
NO. 14	
NO. 15	
NO. 16	
NO. 17	
NO. 18	
NO. 19	
NO. 20	
NO. 21	
NO. 22	
NO. 23	
NO. 24	
NO. 25	
NO. 26	
NO. 27	
NO. 28	
NO. 29	
NO. 30	
NO. 31	
NO. 32	
NO. 33	
NO. 34	
NO. 35	
NO. 36	
NO. 37	
NO. 38	
NO. 39	
NO. 40	
NO. 41	
NO. 42	
NO. 43	
NO. 44	
NO. 45	
NO. 46	
NO. 47	
NO. 48	
NO. 49	
NO. 50	
NO. 51	
NO. 52	
NO. 53	
NO. 54	
NO. 55	
NO. 56	
NO. 57	
NO. 58	
NO. 59	
NO. 60	
NO. 61	
NO. 62	
NO. 63	
NO. 64	
NO. 65	
NO. 66	
NO. 67	
NO. 68	
NO. 69	
NO. 70	
NO. 71	
NO. 72	
NO. 73	
NO. 74	
NO. 75	
NO. 76	
NO. 77	
NO. 78	
NO. 79	
NO. 80	
NO. 81	
NO. 82	
NO. 83	
NO. 84	
NO. 85	
NO. 86	
NO. 87	
NO. 88	
NO. 89	
NO. 90	
NO. 91	
NO. 92	
NO. 93	
NO. 94	
NO. 95	
NO. 96	
NO. 97	
NO. 98	
NO. 99	
NO. 100	

DATE	
BY	
REVISIONS	
PLANNED	
CHECKED	
NO. 1	
NO. 2	
NO. 3	
NO. 4	
NO. 5	
NO. 6	
NO. 7	
NO. 8	
NO. 9	
NO. 10	
NO. 11	
NO. 12	
NO. 13	
NO. 14	
NO. 15	
NO. 16	
NO. 17	
NO. 18	
NO. 19	
NO. 20	
NO. 21	
NO. 22	
NO. 23	
NO. 24	
NO. 25	
NO. 26	
NO. 27	
NO. 28	
NO. 29	
NO. 30	
NO. 31	
NO. 32	
NO. 33	
NO. 34	
NO. 35	
NO. 36	
NO. 37	
NO. 38	
NO. 39	
NO. 40	
NO. 41	
NO. 42	
NO. 43	
NO. 44	
NO. 45	
NO. 46	
NO. 47	
NO. 48	
NO. 49	
NO. 50	
NO. 51	
NO. 52	
NO. 53	
NO. 54	
NO. 55	
NO. 56	
NO. 57	
NO. 58	
NO. 59	
NO. 60	
NO. 61	
NO. 62	
NO. 63	
NO. 64	
NO. 65	
NO. 66	
NO. 67	
NO. 68	
NO. 69	
NO. 70	
NO. 71	
NO. 72	
NO. 73	
NO. 74	
NO. 75	
NO. 76	
NO. 77	
NO. 78	
NO. 79	
NO. 80	
NO. 81	
NO. 82	
NO. 83	
NO. 84	
NO. 85	
NO. 86	
NO. 87	
NO. 88	
NO. 89	
NO. 90	
NO. 91	
NO. 92	
NO. 93	
NO. 94	
NO. 95	
NO. 96	
NO. 97	
NO. 98	
NO. 99	
NO. 100	

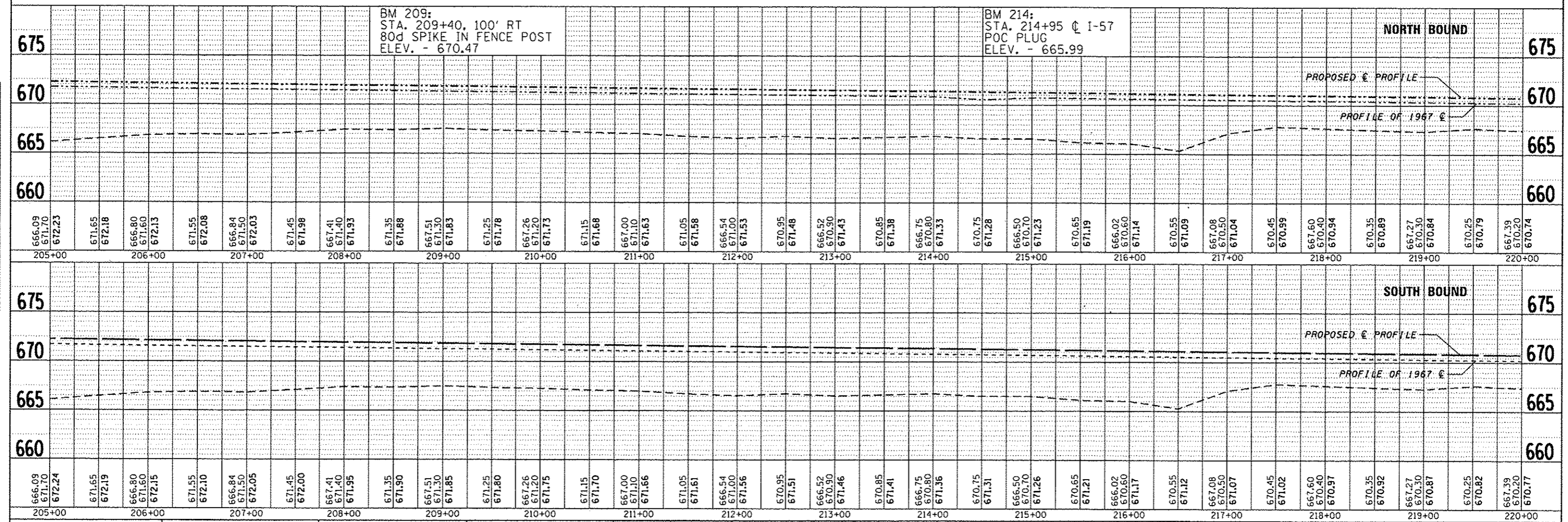

BM 209:
 STA. 209+40, 100' RT
 80d SPIKE IN FENCE POST
 ELEV. - 670.47

BM 214:
 STA. 214+95 @ I-57
 POC PLUG
 ELEV. - 665.99

NORTH BOUND

SOUTH BOUND

PROPOSED PROFILE

PROFILE OF 1967

PROPOSED PROFILE

PROFILE OF 1967

FILE NAME :	USER NAME :	DESIGNED :	REVISED :	F.A.I. RTE. :	SECTION :	COUNTY :	TOTAL SHEETS :	SHEET NO. :
c:\pwork\pwork\dunonbd\0315542\036503-plansheets.dgn	dunonbd	CHECKED :	REVISED :	57	(38-3RS-2)	IROQUOIS	186	31
PLOT SCALE :	PLOT DATE :	DRAWN :	REVISED :	CONTRACT NO. 66C53				
1"=50'	6/10/2014	CHECKED :	REVISED :	FED. ROAD DIST. NO. ILLINOIS FED. AID PROJECT				
STATE OF ILLINOIS DEPARTMENT OF TRANSPORTATION				PLAN AND PROFILE				
SCALE: 1"=50'				SHEET NO. 9 OF 31 SHEETS		STA. 205+00 TO STA. 220+00		