



STA. 287+00  
24"x76" RCCP  
W/ MEDIAN INLET

FENCE REPAIR - 40 FT  
STA. 281±05 TO STA. 281±45

AERIAL SPEED CHECK MARKING  
STA. 286±50

STA. 287+00  
SB 24"x76" RCCP

MAINLINE RESURFACING  
STA. 286+75

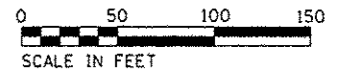
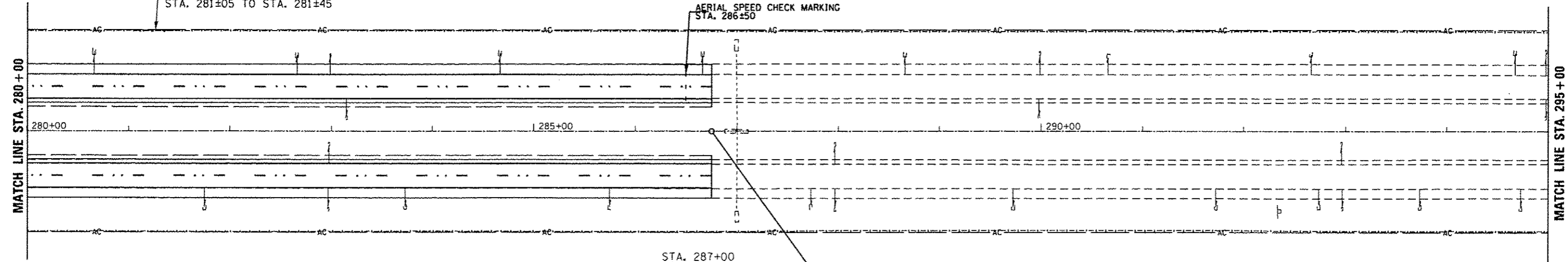

BM 284:  
STA. 283+79 100' RT  
TOP ROW MARKER  
ELEV. - 665.39

BM 288:  
STA. 287+64, 100' RT  
80d SPIKE IN FENCE POST  
ELEV. - 664.25

NORTH BOUND

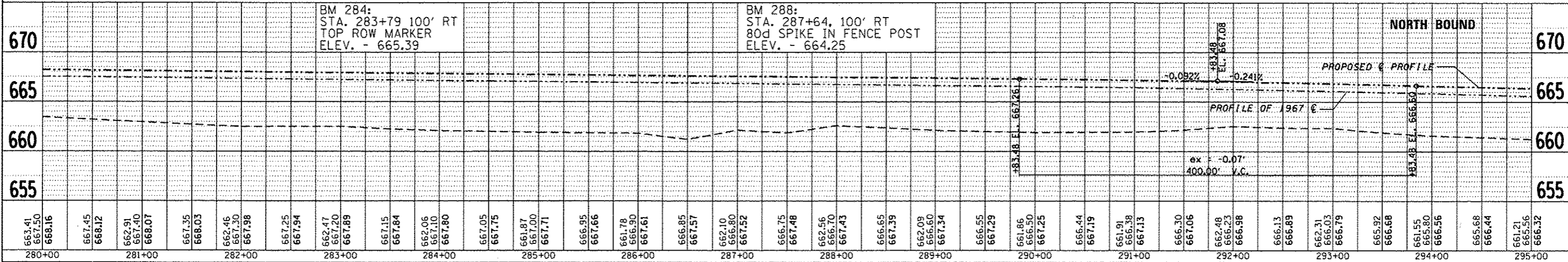

SOUTH BOUND

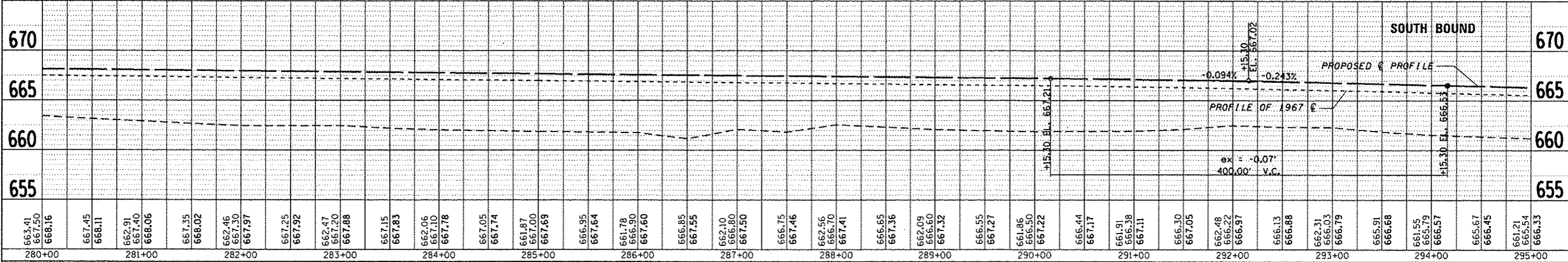

DATE	
BY	
REVISION	
PLANNED	
ALIGNED	
CHECKED	
DATE	
NO.	

DATE	
BY	
REVISION	
PLANNED	
CHECKED	
DATE	
NO.	

FILE NAME :	USER NAME :	DESIGNED :	REVISED :	<b>STATE OF ILLINOIS</b> <b>DEPARTMENT OF TRANSPORTATION</b>	<b>PLAN AND PROFILE</b>	F.A.I. RTE. :	SECTION :	COUNTY :	TOTAL SHEETS :	SHEET NO. :
ct:\pwork\spic\d\duanobd\315542\036623-plansheets.dgn	duanobd	CHECKED :	REVISED :			57	(38-3)RS-2	IROQUOIS	186	36
PLDT SCALE = 1/80.0000' / 1"		DRAWN :	REVISED :			CONTRACT NO. 66C53				
PLDT DATE = 6/10/2014		CHECKED :	REVISED :			FED. ROAD DIST. NO. ILLINOIS FED. AID PROJECT				