

FOR INFORMATION ONLY

FILE NO.	SECTION	COUNTY	TOTAL SHEETS	SHEET NO.
55	*	LEWISTON	22	6
STA.	TO STA.			
FED. AID PROJ. NO.	PLAN	FILE NO. PROJECT		
+ 53-6 & 53-5 RA-L				

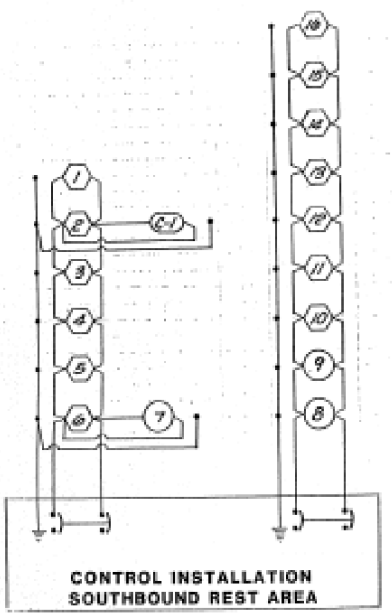
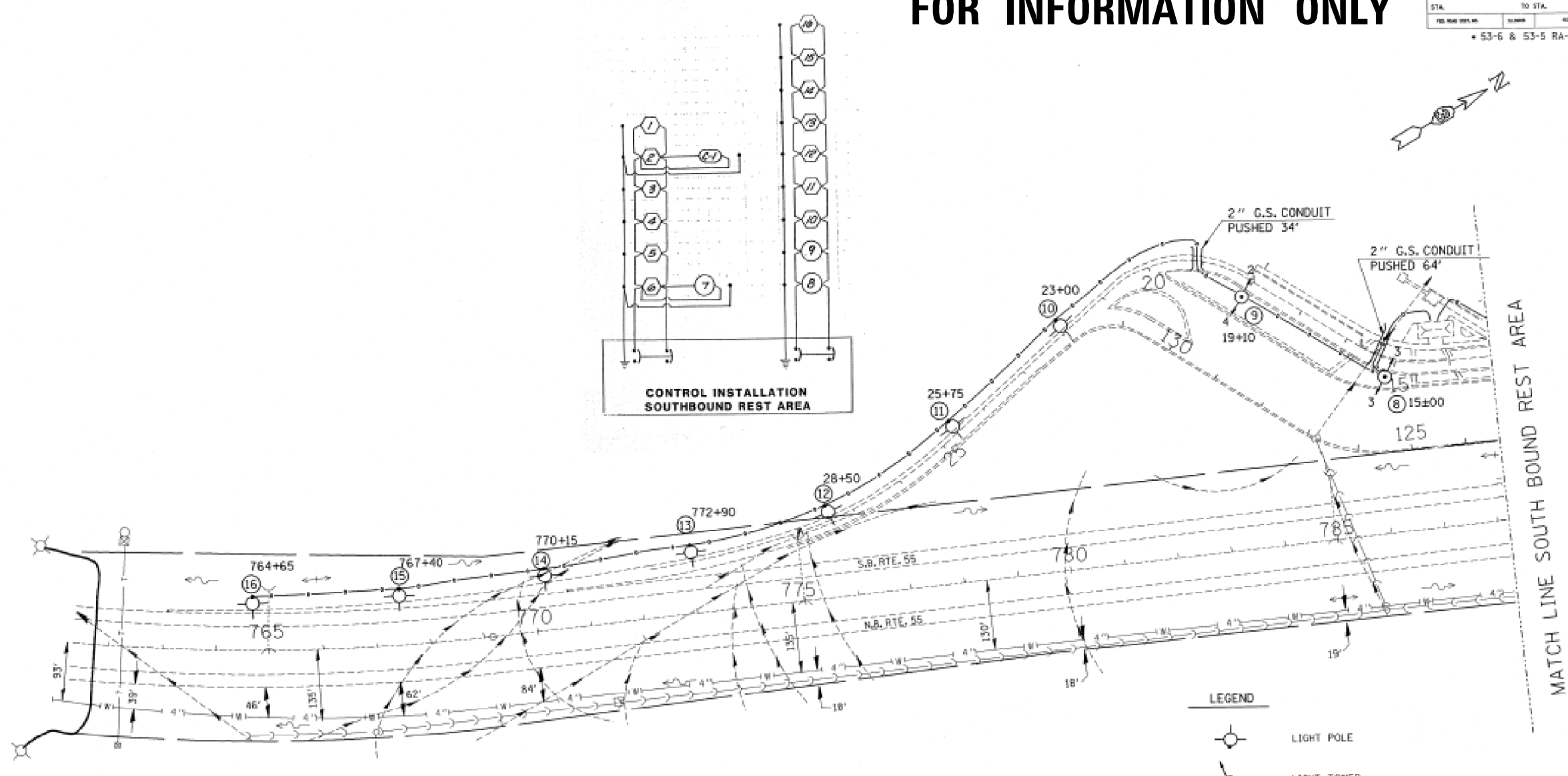

LEGEND

- LIGHT POLE
- LIGHT TOWER
- BURIED CABLE
- PUSHED CONDUIT
- CANTILEVER SIGN STRUCTURE
- EXIST. FIELD TILE

NOTE:
HIGH MAST LIGHTS ARE SUBJECT TO MINOR LOCATION ADJUSTMENTS. TO BE DETERMINED BY THE ENGINEER.

LIGHTING CONTROL CABINETS TO BE LOCATED INSIDE MAIN REST AREA BUILDING.



REVISIONS	
NAME	DATE
LMT	12-22-88
LMT	1-3-89

ILLINOIS DEPARTMENT OF TRANSPORTATION
DRAWN BY C.A.D.D.
**SOUTH BOUND
REST AREA
LIGHTING LOCATIONS**
DRAWN BY L.M.T.
DATE 12-30-88 CHECKED BY

9-JAN-89 11:47:46
ZF:\MIS2\00333031698\LDONL