

LEGEND:

(A) WATER VALVE TO BE ADJUSTED BY CITY OF NORMAL

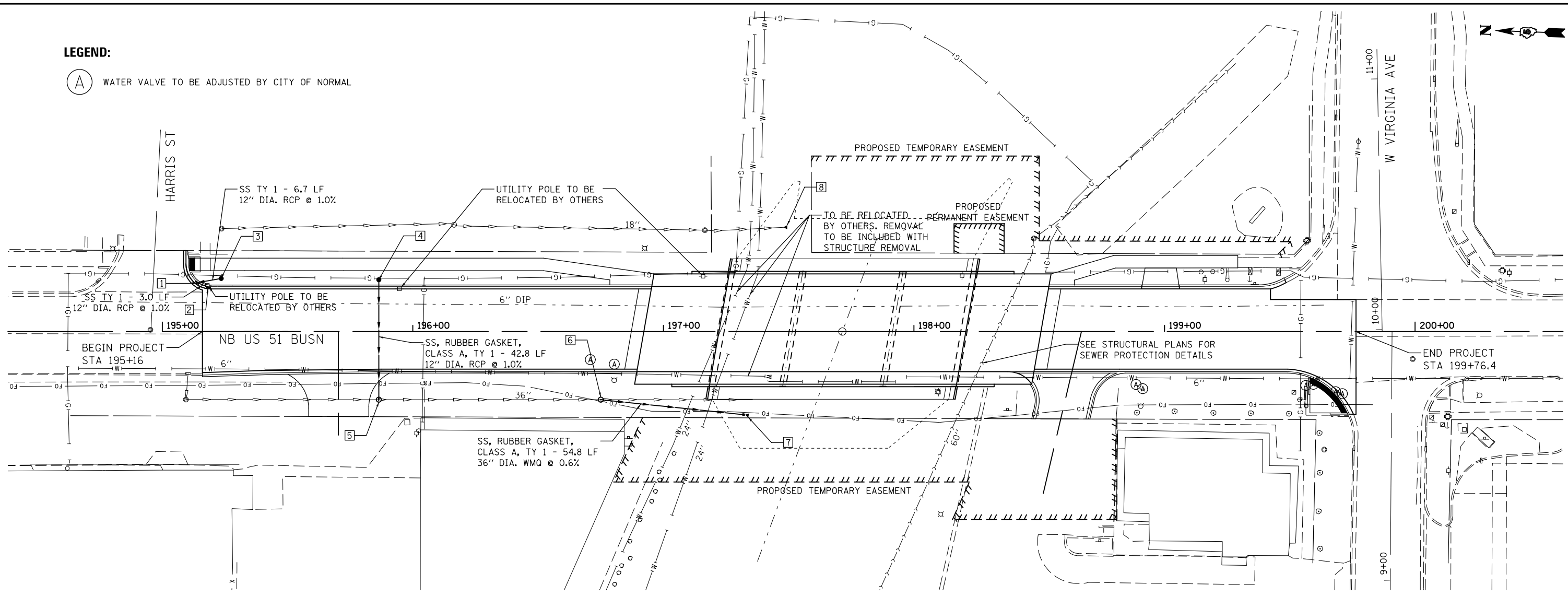

DRAINAGE STRUCTURE SCHEDULE

STRUCTURE NUMBER	STATION	OFFSET	RIM ELEV.	INVERT ELEV	PRECAST REINFORCED CONCRETE FLARED END SECTIONS 18" 54213663	PRECAST REINFORCED CONCRETE FLARED END SECTIONS 36" 54213681	CATCH BASINS, TYPE A, 4'-DIAMETER, TYPE 1 FRAME, OPEN LID 60200105	MANHOLES, TYPE A, 6'-DIAMETER, TYPE 1 FRAME, OPEN LID 60223700	INLETS, TYPE A, TYPE 11 FRAME AND GRATE 60236800
1	195+14.	19.5' LT	758.98	756.73 S, 756.06 SW, MEET EX. NW				1	
2	195+18.5	17.6' LT	759.09	756.09 NE				1	
3	195+23.5	21.2' LT	759.47	756.8 NW			1		
4	195+86.4	20.6' LT	760.04	756.71W			1		
5	195+86.4	27.2' RT	759.8	753.21N, 753.19 S, 756.28 E				1	
6	196+75.	27.2' RT	760.52	752.67 N, 752.57 SW				1	
7	197+34.	33.2' RT	N/A	752.3		1			
8	197+47.9	41.6' LT	N/A	752.4	1				
TOTALS:					1	1	2	2	2

NOTES:

- CONTRACTOR SHALL VERIFY EXISTING SEWER LOCATIONS AND INVERT ELEVATIONS TO ENSURE POSITIVE DRAINAGE.
- ALL SEWERS CROSSING WATER MAINS TO BE IEPA PRESSURE TESTED.

ACTUAL STATIONS AND OFFSETS OF THE FIELD TILE JUNCTION VAULTS AND STORM SEWERS WILL NEED TO BE FIELD VERIFIED AFTER THE EXPLORATORY TRENCH OPERATIONS LOCATE THE STORM SEWER CROSSING UNDER US 51 BUSN AND ALONG THE WEST SIDE OF US 51 BUSN. THE DEPTH OF THE VAULTS AND STORM SEWER INVERTS SHALL BE FIELD VERIFIED AFTER THE DEPTH OF THE EXISTING STORM SEWERS ARE DETERMINED.

PIPE SCHEDULE

LOCATION				STORM SEWERS, RUBBER GASKET, CL A, TYPE 1 12" 550A2320	STORM SEWERS, RUBBER GASKET, CL A, TYPE 2 36" 550A2600	TRENCH BACKFILL 20800150
LT/RT	STA	TO	STA	FOOT	FOOT	CU YD
LT	195+18.5		195+14.	3		0.8
LT	195+23.5		195+14.	6.7		1.2
	195+86.4 LT		195+86.4 RT	42.8		8.7
RT	196+75.		197+34.		54.8	48.8
TOTAL				52.5	54.8	59.5
ROUND TO				53.0	55.0	60.0

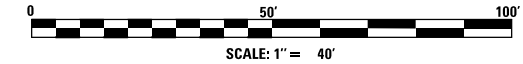

USER NAME = ceorlockjd	DESIGNED - MRS	REVISED
FILE NAME = \$FILES\$	DRAWN - MRS	REVISED
PLOT SCALE = 40.0000' / in.	CHECKED - AJK	REVISED
PLOT DATE = 8/12/2014	DATE - 1/25/13	REVISED

**STATE OF ILLINOIS
DEPARTMENT OF TRANSPORTATION**

DRAINAGE AND UTILITIES

SCALE: 1" = 40' SHEET NO. 1 OF 1 SHEETS STA. 195+16 TO STA. 198+76.4

F.A.P. RTE.	SECTION	COUNTY	TOTAL SHEETS	SHEET NO.
730	62-ZBR	MCLEAN	65	23
CONTRACT NO. 70540				
ILLINOIS FED. AID PROJECT				