

**PIER 1 PILE DATA**

Type: Metal Shell - 14 in. Dia. x 0.25 in. Walls with Pile Shoes  
 Nominal Required Bearing: 342 kips  
 Factored Resistance Available: 180 kips  
 Est. Length: 38 ft.  
 No. Production Piles: 8  
 No. Test Piles: 1

**PIER 2 PILE DATA**

Type: Metal Shell - 14 in. Dia. x 0.25 in. Walls with Pile Shoes  
 Nominal Required Bearing: 342 kips  
 Factored Resistance Available: 180 kips  
 Est. Length: 34 ft.  
 No. Production Piles: 8  
 No. Test Piles: 1

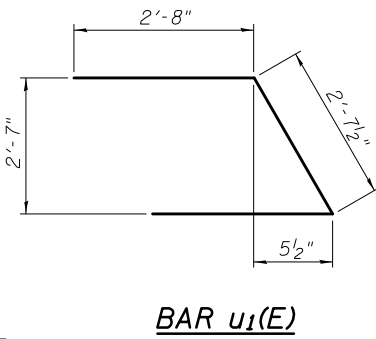
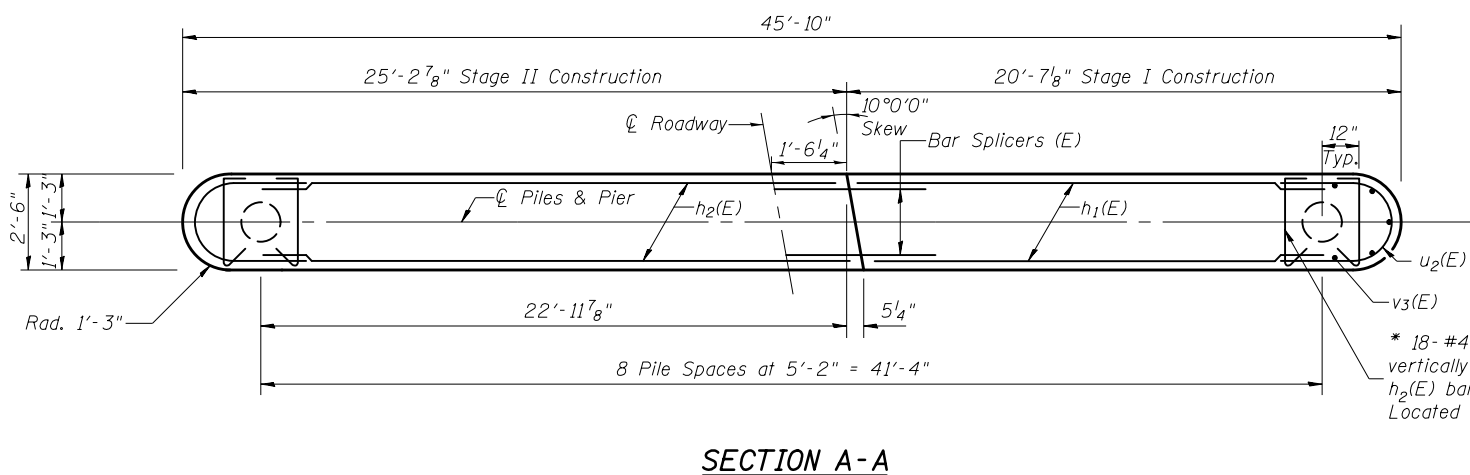
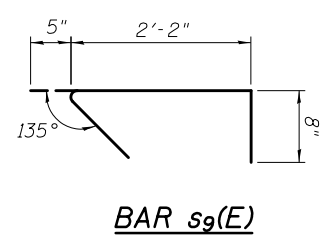
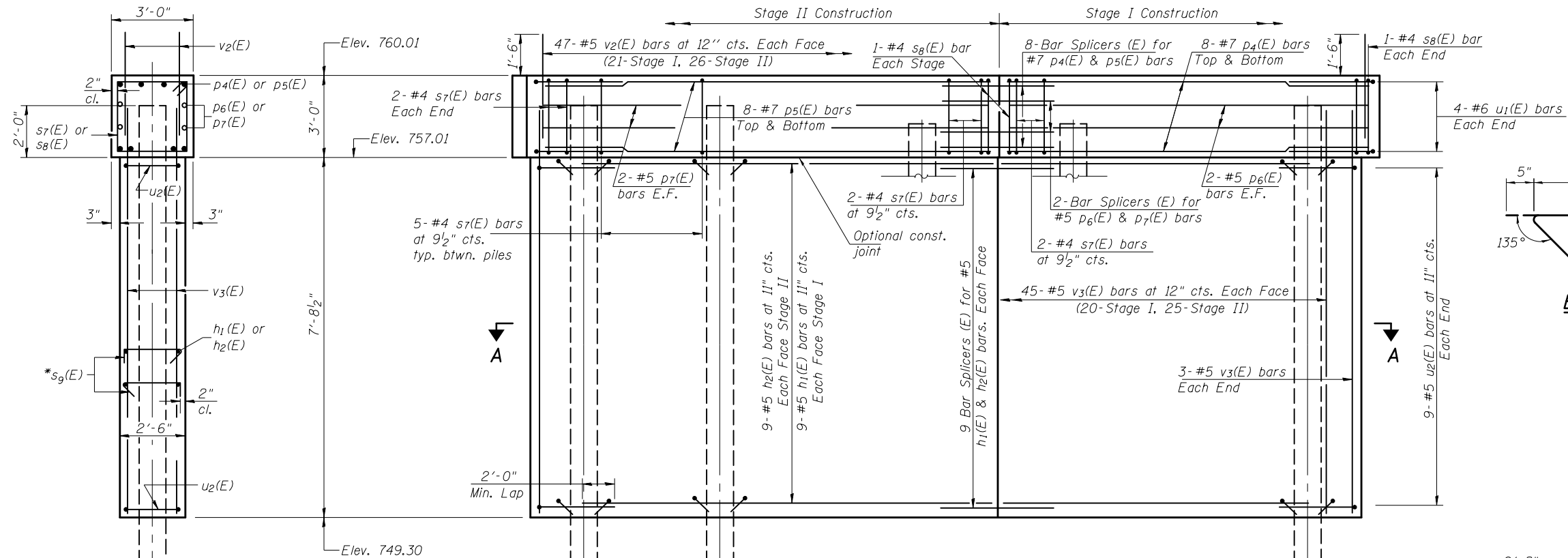
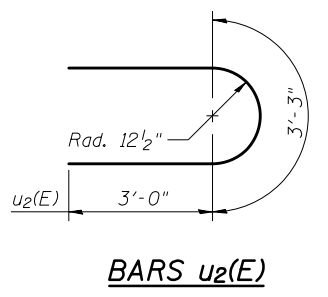
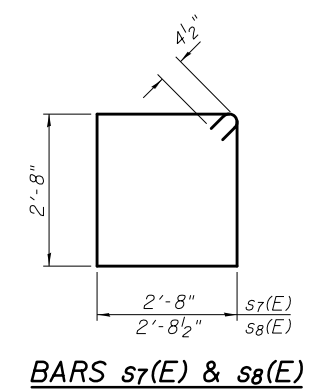
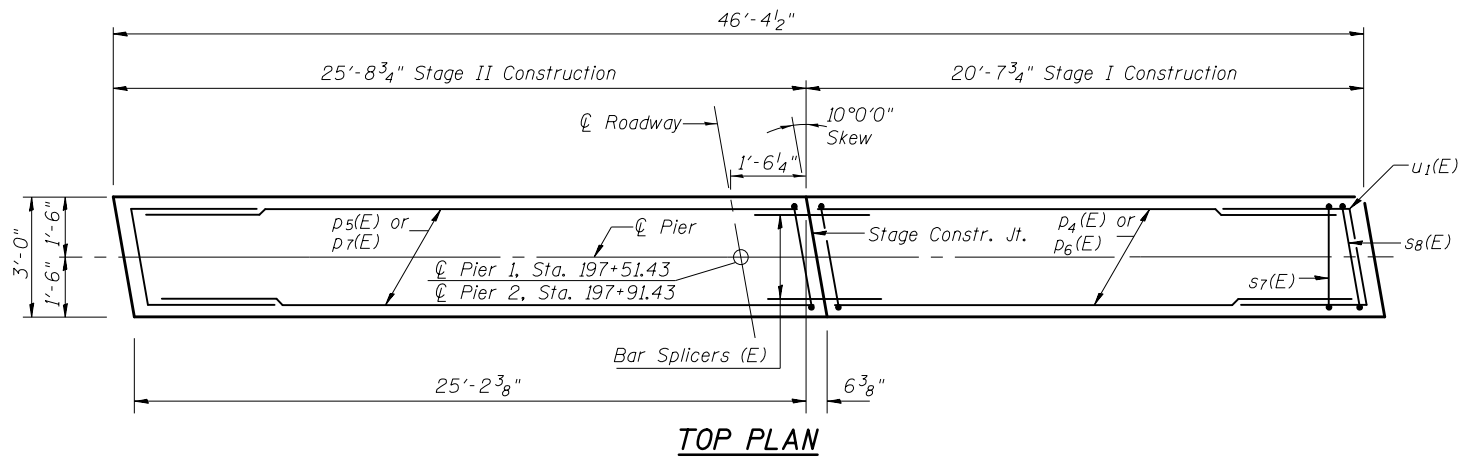

**BILL OF MATERIAL TWO PIERS**

Bar	No.	Size	Length	Shape
h1(E)	36	#5	18'-5"	—
h2(E)	36	#5	23'-0"	—
p4(E)	16	#7	20'-3"	—
p5(E)	16	#7	25'-4"	—
p6(E)	8	#5	20'-3"	—
p7(E)	8	#5	25'-4"	—
s7(E)	86	#4	11'-5"	□
s8(E)	8	#4	11'-6"	□
s9(E)	324	#4	3'-3"	∟
u1(E)	16	#6	8'-0"	∩
u2(E)	36	#5	9'-3"	U
v2(E)	188	#5	3'-0"	—
v3(E)	192	#5	9'-6"	—
Structure Excavation		Cu. Yd.	77	
Concrete Structures		Cu. Yd.	88.6	
Reinforcement Bars, Epoxy Coated		Pound	7,880	
Furnishing Metal Shell Piles 14" x 0.250"		Foot	576	
Driving Piles		Foot	576	
Test Pile Metal Shells		Each	2	
Pile Shoes		Each	18	

Notes:  
 For details of piles, see sheet 20 of 23.  
 See sheet 21 of 23 for Bar Splicer Assembly Details.

\* s9(E) bars shall enclose both the vertical and horizontal bars. Alternate the position of the 90 and 135 degree hooked ends both vertically and horizontally.

\* 18-#4 s9(E) bars spaced vertically with h1(E) and h2(E) bars (9 rows). Located each side of pile.

**SECTION A-A**