

SECTION B-B

SECTION C-C

ELEVATION

SECTION A-A

Symmetrical about C Pier

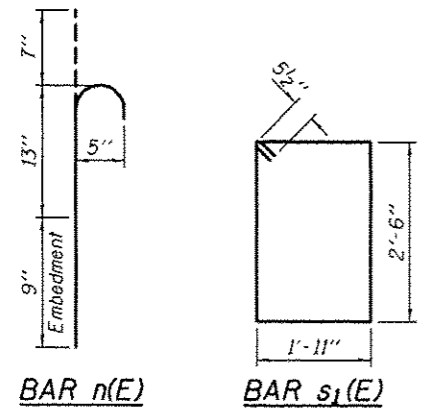

* Epoxy grout n(E) bars in 9" min. holes according to Article 584 of the Standard Specifications.

BILL OF MATERIAL

Bar	No.	Size	Length	Shape
h2(E)	21	#5	10'-4"	—
h3(E)	14	#5	7'-4"	—
n(E)	128	#5	2'-5"	U
s1(E)	49	#5	9'-9"	□
Concrete Structures			Cu. Yd.	11.4
Reinforcement Bars, Epoxy Coated			Pound	1150

DESIGNED DAB
 CHECKED TLC
 DRAWN baliva
 CHECKED DAB TLC

EXAMINED
 PASSED
 ACTING ENGINEER OF STRUCTURAL SERVICES
 ACTING ENGINEER OF BRIDGES AND STRUCTURES

DATE SEPTEMBER 12, 2014
 REVISED
 REVISED

STATE OF ILLINOIS
 DEPARTMENT OF TRANSPORTATION

CRASHWALL EXTENSION PIERS 2
 SN 084-0117

SHEET NO. 3 OF 3 SHEETS

F.A.I. RTE.	SECTION	COUNTY	TOTAL SHEETS	SHEET NO.
55	184-A-1185-5	SANGAMON	39	21
CONTRACT NO. 72647				
ILLINOIS FED. AID PROJECT				