

STATE OF ILLINOIS
DEPARTMENT OF TRANSPORTATION

ROUTE NO.	SEC.	COUNTY	TOTAL SHEETS	SHEET NO.	SHEET NO.:
FA-008	125BR	MACOUPIN	33	7	17
SHEETS: 17					

BENCH MARK:
B.M. #7 ELEVATION 533.16; CHISELED SQUARE IN NORTHWEST WINGWALL OF BRIDGE 12.8' RT. STA. 1005+27

EXISTING STRUCTURE:
STA. 1005+80, FAP RTE. 608, MARKED IL RTE. 111 SECTION 125BR, STRUCTURE NUMBER 059-0014 YEAR BUILT 1929 SUPERSTRUCTURE: 3 SIMPLE SPANS CAST-IN-PLACE REINFORCED T-BEAM

SUBSTRUCTURE: 2 CLOSED ABUTMENTS & 2 SOLID PIERS THE EXISTING SUPERSTRUCTURE IS TO BE REMOVED WITH NO SALVAGE. EXISTING ABUTMENTS & PIERS SHALL BE WIDENED AND REUSED.

STATION 1005+80.00
BUILT 199 BY
STATE OF ILLINOIS
F.A. ROUTE 608 SEC. 125BR
F.A. PROJ. ACBHF-608(12)

LOADING HS-20
STR. NO. 059-0014

NAME PLATE
(SEE STD. 2113)

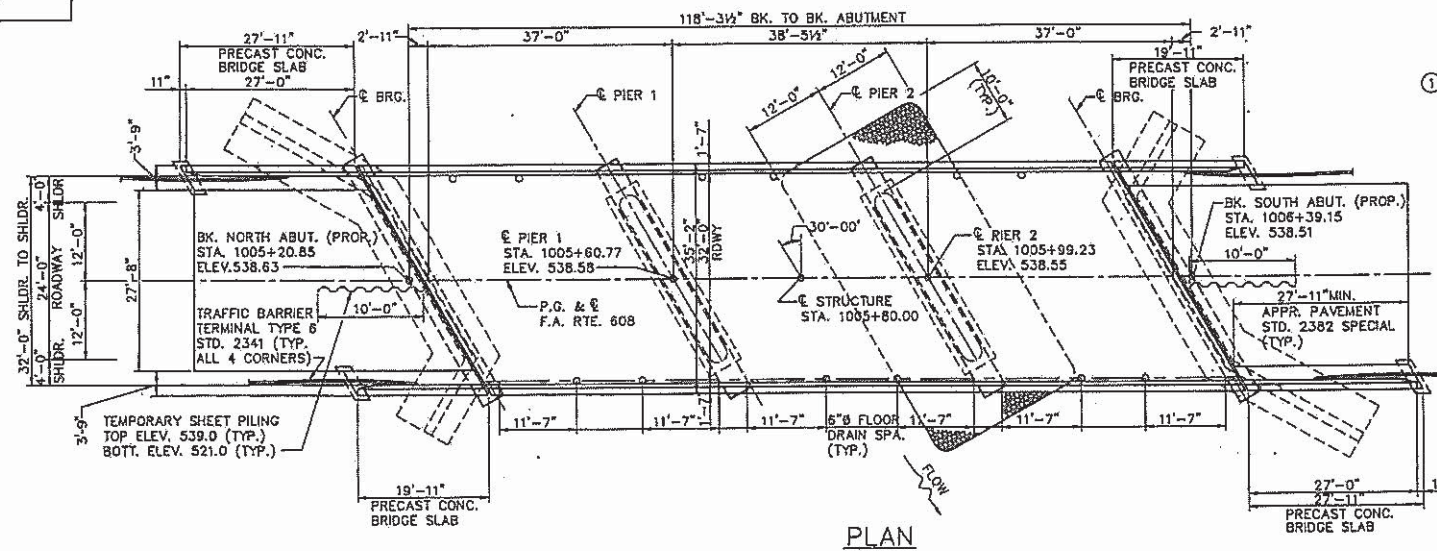
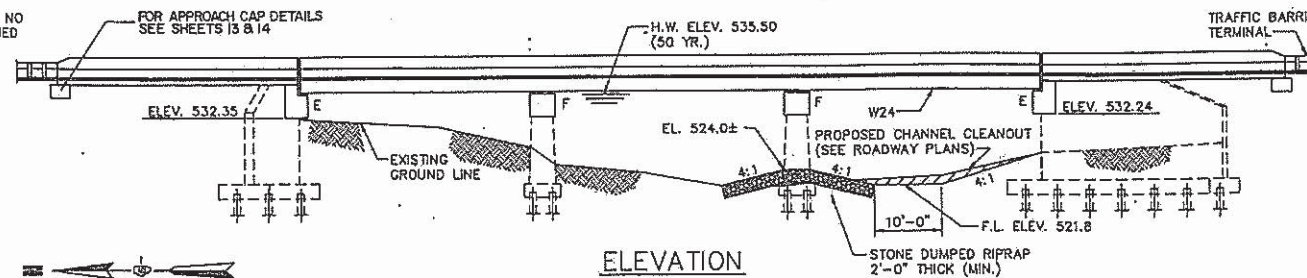

PLAN

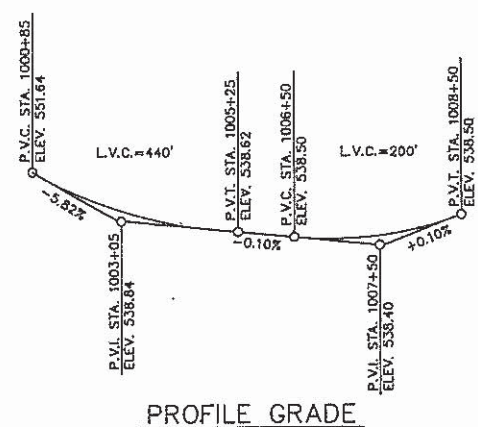

PROFILE GRADE

WATERWAY INFORMATION

FLOOD YEAR	FREQ. C.F.S.	OPENING SQ. FT.	NAT. EXIST. H.W.E.	HEAD FT.	HEADWATER ELEV.		
DESIGN 50	5940	730	765	535.5	1.81	537.11	537.11
BASE 100	6802	730	765	536.0	2.11	538.11	538.11
OVERTOPPING 100	6802						
MAX. CALC. 500							

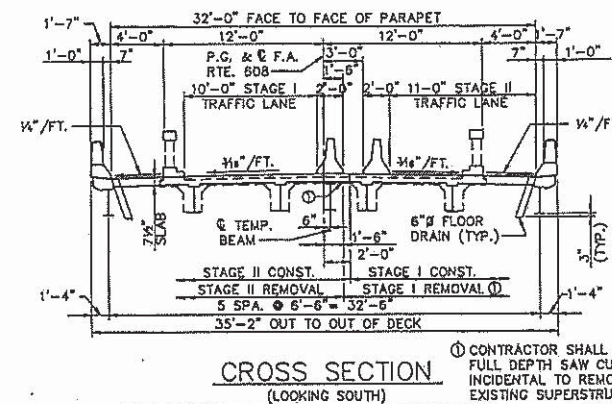

CROSS SECTION
(LOOKING SOUTH)

CONTRACTOR SHALL PROVIDE FULL DEPTH SAW CUT, COST INCIDENTAL TO REMOVAL OF EXISTING SUPERSTRUCTURES.

DESIGN STRESSES

FIELD UNITS:

FC = 3,500 PSI
FY = 60,000 PSI (REINFORCEMENT)
FY = 50,000 PSI (STRUCTURAL STEEL) AASHTO M223, GRADE 50
FY = 36,000 PSI (STRUCTURAL STEEL) AASHTO M183

PRECAST UNITS:

FC = 4,500 PSI
FC = 1,800 PSI
FS = 24,000 PSI
N = 8

LOADINGS

HS 20-44 (ALLOW 25#/FT² FOR FUTURE WEARING SURFACE)

SPECIFICATIONS

1983 AASHTO AND INTERIM SPECIFICATIONS 1984 THRU 1988

TOTAL BILL OF MATERIALS

ITEM	UNIT	SUPER	SUBSTR.	TOTAL
REMOVAL OF EXISTING SUPERSTRUCTURES	L. SUM	1		1
CONCRETE REMOVAL	CU. YD.		40.2	40.2
FLOOR DRAINS	EACH	12		12
PREFORMED JOINT SEAL, 2 1/2"	LIN. FT.	82		82
CLASS X CONCRETE SUPERSTRUCTURE	CU. YD.	133.9		133.9
PROTECTIVE COAT	SO. YD.	539.1		539.1
ELASTOMERIC BEARING ASSEMBLY, TYPE I	EACH	12		12
CLASS X CONCRETE	CU. YD.		80.9	80.9
PRECAST CONCRETE BRIDGE SLAB	SO. FT.	358		358
FURNISHING & ERECTING STRUCTURAL STEEL	L. SUM	1		1
STUD SHEAR CONNECTORS	EACH	2052		2052
REINFORCEMENT BARS	POUND		3080	3080
REINFORCEMENT BARS (EPOXY COATED)	POUND	29560	4220	33780
NAME PLATES	EACH	1		1
STONE DUMPED RIPRAP, CLASS A5	TON		165	165
TEMPORARY SUPPORT SYSTEM	L. SUM	1		1
BRIDGE SEAT SEALER	L. SUM		1	1
STRUCTURE EXCAVATION	CU. YD.		42	42
TEMPORARY SHEET PILING	SO. FT.		360	360
FILTER FABRIC FOR USE W/ RIPRAP	SO. YD.		118	118

① INCLUDES BRIDGE DECK & PARAPET SURFACES

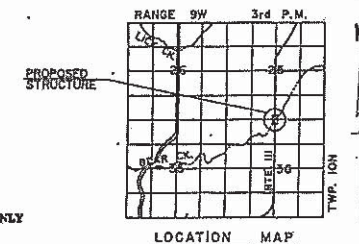

LOCATION MAP

APPROVED
FOR STRUCTURAL ADEQUACY ONLY

John W. Clark
Registered Structural Engineer

PLANS PREPARED BY:
VOLLMER ASSOCIATES
CONSULTING ENGINEERS



GENERAL PLAN
ILLINOIS ROUTE 111 OVER
BEAR CREEK
F.A. RTE. 608 SECTION 125BR
MACOUPIN COUNTY
STATION 1005 + 80.00
STRUCTURE NO. 059-0014