

084-0077

ROUTE	SECTION	COUNTY	TOTAL SHEETS	SHEET NO.
FA 319	*	SANGAMON	4	2

\*(84-9-4HB-2)I

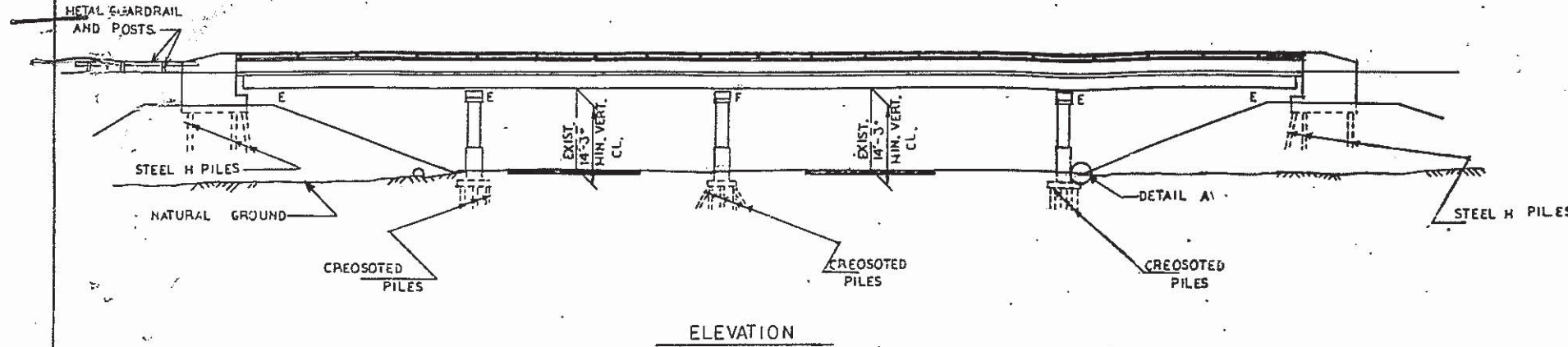

GENERAL NOTES

REINFORCEMENT BARS SHALL CONFORM TO THE REQUIREMENTS OF AASHTO CLASSIFICATION M-31, M-42 OR M-53 GRADE 60. TRAFFIC CONTROL SHALL BE DETERMINED BY THE DISTRICT. PRIOR TO POURING THE NEW CONCRETE FOR THE DECK, ALL LOOSE RUST, LOOSE MILL SCALE, LOOSE PAINT AND ALL OTHER FOREIGN MATERIAL SHALL BE REMOVED FROM THE EMBEDDED PORTIONS OF FLANGES OF STRINGERS (GIRDERS). THE REMOVAL SHALL BE ACCOMPLISHED IN ACCORDANCE WITH THE REQUIREMENTS OF THE SSPC SURFACE PREPARATION SPECIFICATIONS SP11 FOR POWER TOOL CLEANING OR SP2 FOR HAND TOOL CLEANING. COST SHALL BE INCIDENTAL TO CONCRETE REMOVAL.

PLAN DIMENSIONS AND DETAILS RELATIVE TO EXISTING STRUCTURE HAVE BEEN TAKEN FROM EXISTING PLANS AND ARE SUBJECT TO NOMINAL CONSTRUCTION VARIATIONS. IT SHALL BE THE CONTRACTOR'S RESPONSIBILITY TO VERIFY SUCH DIMENSIONS AND DETAILS IN THE FIELD AND MAKE NECESSARY APPROVED ADJUSTMENTS PRIOR TO CONSTRUCTION OR ORDERING OF MATERIALS. SUCH VARIATIONS SHALL NOT BE CAUSE FOR ADDITIONAL COMPENSATION FOR A CHANGE IN THE SCOPE OF THE WORK, HOWEVER, THE CONTRACTOR WILL BE PAID FOR THE QUANTITY ACTUALLY FURNISHED AT THE UNIT PRICE BID FOR THE WORK.

EXPANSION JOINT PLATES AND ATTACHED BARS SHALL BE SHOP PAINTED WITH THE ZINC-SILICATE PRIMER.

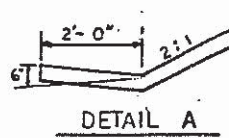
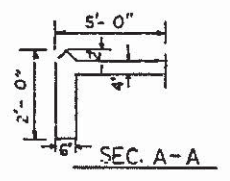
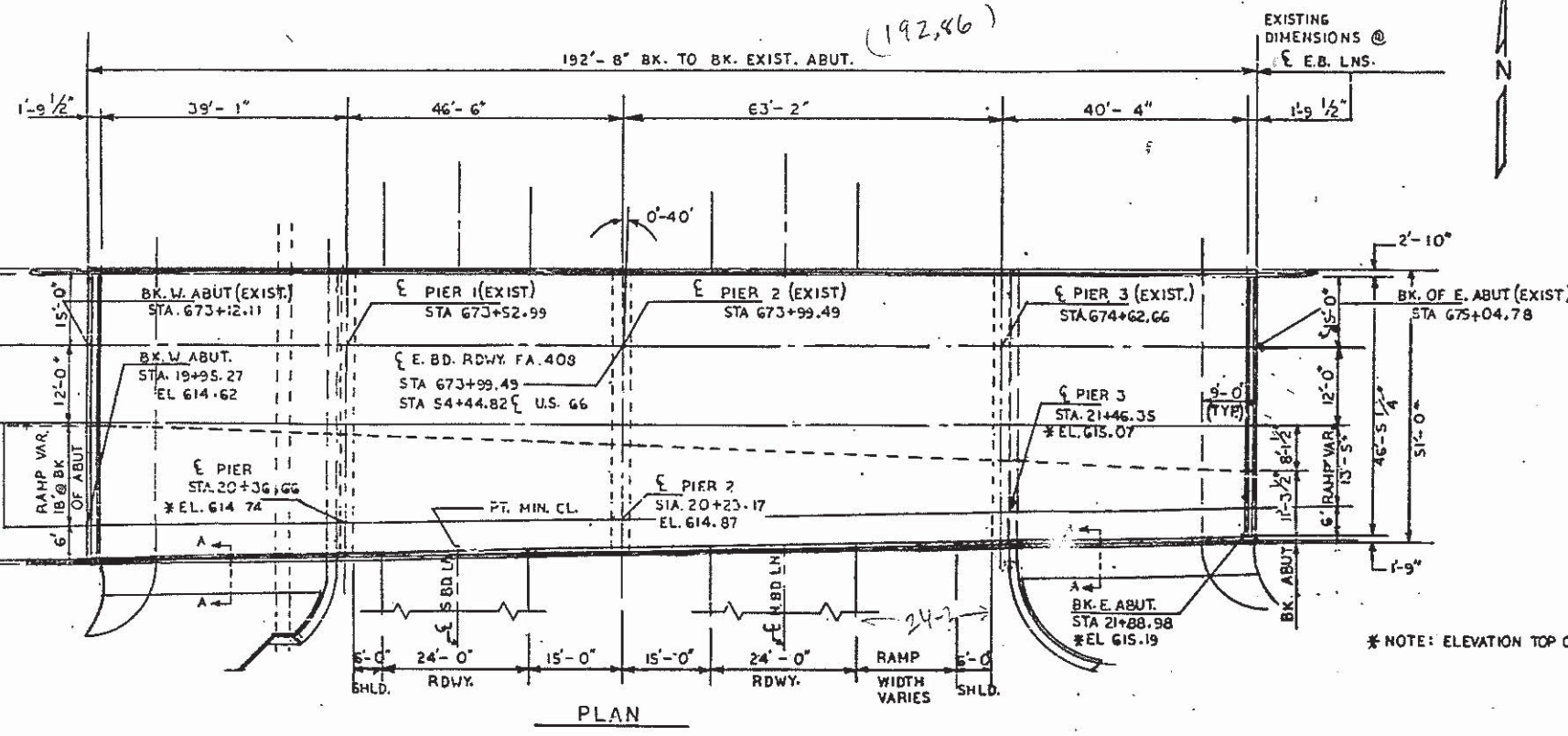

EXAMINED	19
DISTRICT TRAFFIC ENGINEER	19
EXAMINED	19
DISTRICT MAINTENANCE ENGINEER	19
EXAMINED	19
DISTRICT CONSTRUCTION ENGINEER	19
EXAMINED	19
DISTRICT MATERIALS ENGINEER	19
EXAMINED	19
DISTRICT DESIGN ENGINEER	19

EXAMINED	19
DISTRICT TRAFFIC ENGINEER	19
EXAMINED	19
DISTRICT MAINTENANCE ENGINEER	19
EXAMINED	19
DISTRICT CONSTRUCTION ENGINEER	19
EXAMINED	19
DISTRICT MATERIALS ENGINEER	19
EXAMINED	19
DISTRICT DESIGN ENGINEER	19

GENERAL PLAN & ELEVATION  
EAST-BOUND BRIDGE  
E.A. ROUTE 319 (U.S. 36)  
SECTION (84-9-4HB-2)I  
SANGAMON COUNTY  
STATION 673+99-49

084-0077