

F.A.P. RTE.	SECTION	COUNTY	TOTAL SHEETS	SHEET NO.
781	109B-1	LAWRENCE	34	1
FED. ROAD DIST. NO.	ILLINOIS	CONTRACT NO. 74105		

D-97-034-05 #34+1=35

STATE OF ILLINOIS  
DEPARTMENT OF TRANSPORTATION  
DIVISION OF HIGHWAYS

**PROPOSED  
HIGHWAY PLANS**

FAP RTE 781 (IL 33)  
SECTION 109B-1

LAWRENCE COUNTY

C - 97 - 069 - 05

STRUCTURE REPLACEMENT  
OVER UNNAMED STREAM

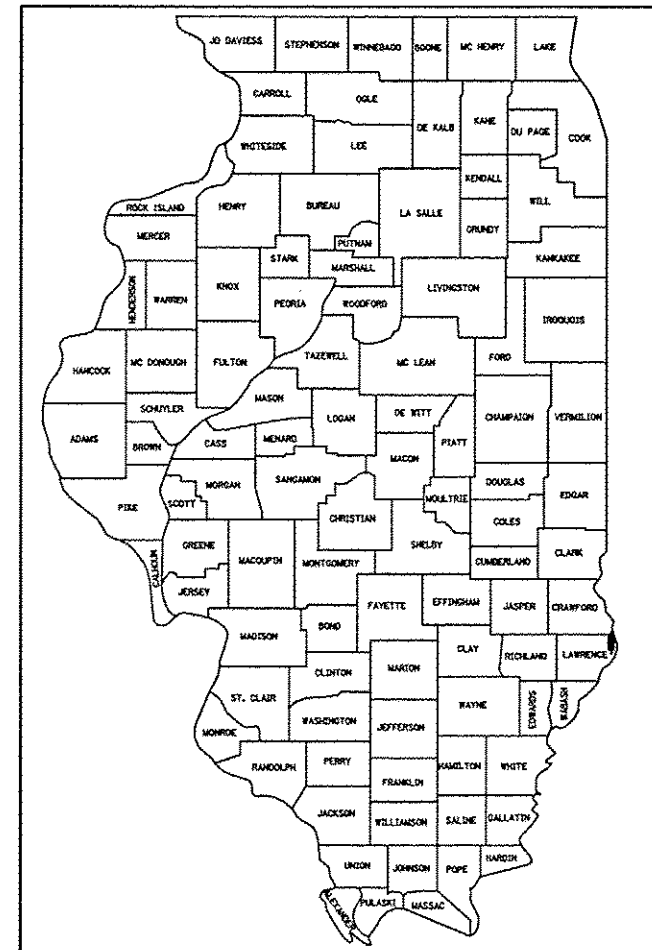

LOCATION OF SECTION INDICATED THUS: - [rectangle] -

**FUNCTIONAL CLASSIFICATION: RURAL MINOR ARTERIAL**  
**DESIGN SPEED: 55 mph**  
**POSTED SPEED: 55 mph**  
**ADT: 859(2011)**  
**PV: 88.7%**  
**SU: 5.0%**  
**MU: 6.3%**

STATE OF ILLINOIS  
DEPARTMENT OF TRANSPORTATION  
DIVISION OF HIGHWAYS

SUBMITTED July 2 2014  
*Roger L. Drishill*  
DEPUTY DIRECTOR OF HIGHWAYS, REGION ENGINEER

June 27 2014  
*John D. Baranzelli* P.E.  
acting ENGINEER OF DESIGN AND ENVIRONMENT

June 27 2014  
*Omer Osman* P.E.  
DIRECTOR OF HIGHWAYS, CHIEF ENGINEER

**INDEX OF SHEETS**

SHEET NO.	DESCRIPTION
<b>ROADWAY PLANS</b>	
1.	COVER SHEET
2.	GENERAL NOTES
3.	STANDARDS
4.	SUMMARY OF QUANTITIES
5.	TYPICAL SECTIONS
6.	SCHEDULES OF QUANTITIES
7.-9.	FAP RTE 781 (IL 33) PLAN AND PROFILE
10.-11.	STAGE CONSTRUCTION PLANS
12.	STAGE CONSTRUCTION DETAILS
13.	EROSION CONTROL AND DRAINAGE PLAN
14.	MISCELLANEOUS DETAILS
<b>STRUCTURE PLANS</b>	
15.	GENERAL PLAN
16.	GENERAL DATA
17.-18.	STAGE CONSTRUCTION DETAILS
19.-20.	BOX CULVERT DETAILS
21.	STEEL SHEET PILING WALL DETAILS
22.	BAR SPLICER ASSEMBLY DETAILS
23.	TEMPORARY CONCRETE BARRIER FOR STAGE CONSTRUCTION
24.	BORING LOGS
<b>EXISTING STRUCTURE PLANS</b>	
25.-28.	EXISTING STRUCTURE PLANS
<b>CROSS SECTIONS</b>	
29.-34.	FAP 781 (IL 33) CROSS SECTIONS

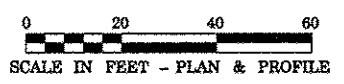

FULL SIZE PLANS HAVE BEEN PREPARED USING STANDARD ENGINEERING SCALES. REDUCED SIZED PLANS WILL NOT CONFORM TO STANDARD SCALES. IN MAKING MEASUREMENTS ON REDUCED PLANS, THE ABOVE SCALES MAY BE USED.

MICROFILMED \_\_\_\_\_  
 REEL NUMBER \_\_\_\_\_  
 AWARDED \_\_\_\_\_  
 RESIDENT ENGINEER \_\_\_\_\_  
 AS BUILT CHANGES WERE MADE ON THE FOLLOWING SHEETS \_\_\_\_\_

J.U.L.I.E.  
 JOINT UTILITY LOCATION INFORMATION FOR EXCAVATION  
 1-800-892-0123  
 OR 811

DISTRICT 7 NO. (217) 342-3951  
 PROJECT ENGINEER: TOM RONAN  
 UNIT CHIEF:  
 TOWNSHIP: RUSSELL  
 CONTRACT NO.: 74105



*Richard D. Payne*  
 DATE: 083041  
 ILLINOIS PROFESSIONAL LICENSE NO. 37421  
 (EXPIRATION DATE: 11-30-11)

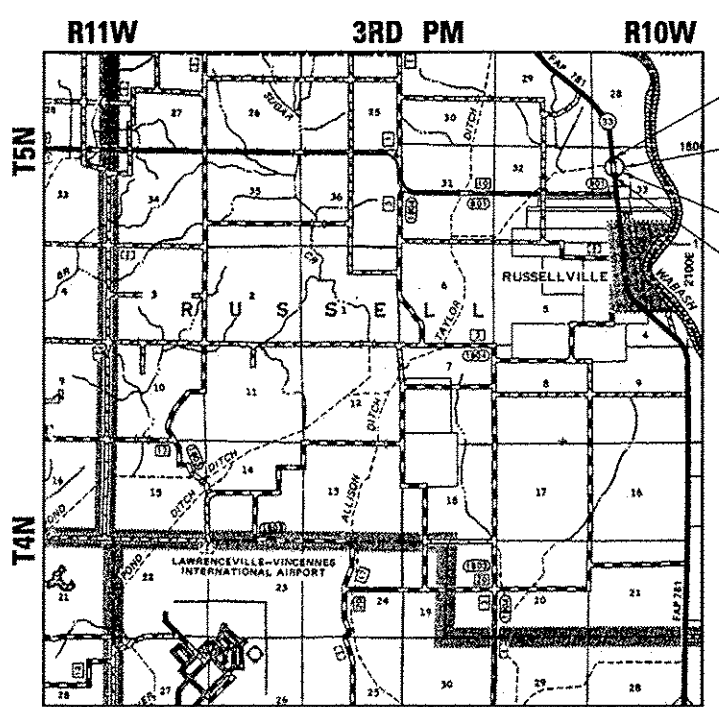

LOCATION MAP

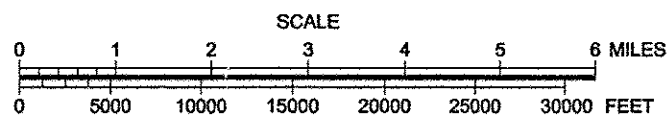

GROSS LENGTH = 720.5 FT. = 0.136 MI.  
 NET LENGTH = 720.5 FT. = 0.136 MI.

IMPROVEMENTS BEGIN  
STA 701+89.5

STA 705+40  
PROPOSED SN 051-2008  
TRIPLE 11' SPAN x 9' HEIGHT  
BOX CULVERT

EXISTING SN 051-0035

IMPROVEMENTS END  
STA 709+10

**DESIGN DESIGNATION  
N.A.**

**PRINTED BY THE AUTHORITY  
OF THE STATE OF ILLINOIS**