

* Order a(E), a₁(E), a₃(E), and a₄(E) bars full length. Cut to fit skew and use remainder of bars in opposite end.

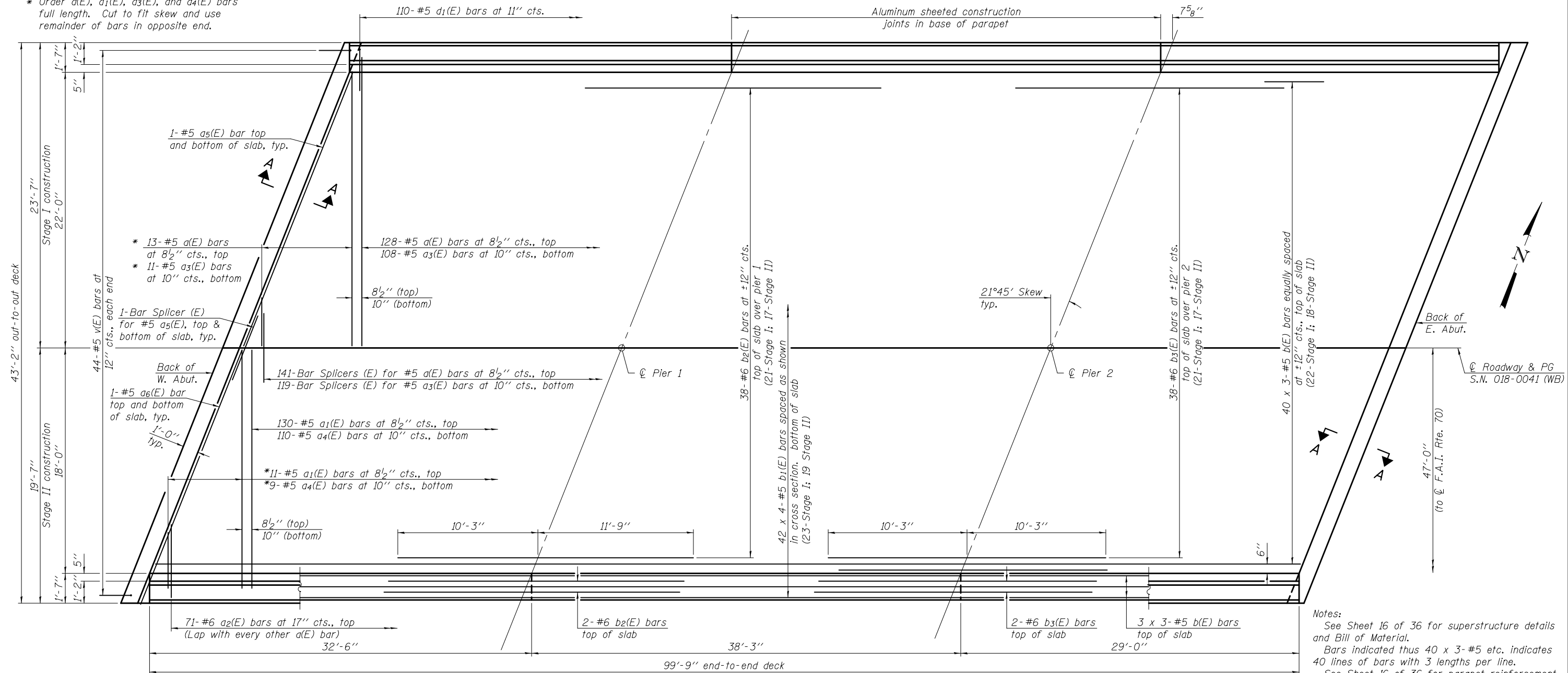

Notes:
 See Sheet 16 of 36 for superstructure details and Bill of Material.
 Bars indicated thus 40 x 3-#5 etc. indicates 40 lines of bars with 3 lengths per line.
 See Sheet 16 of 36 for parapet reinforcement.
 See sheet 17 of 36 for diaphragm details and Section A-A.

PLAN

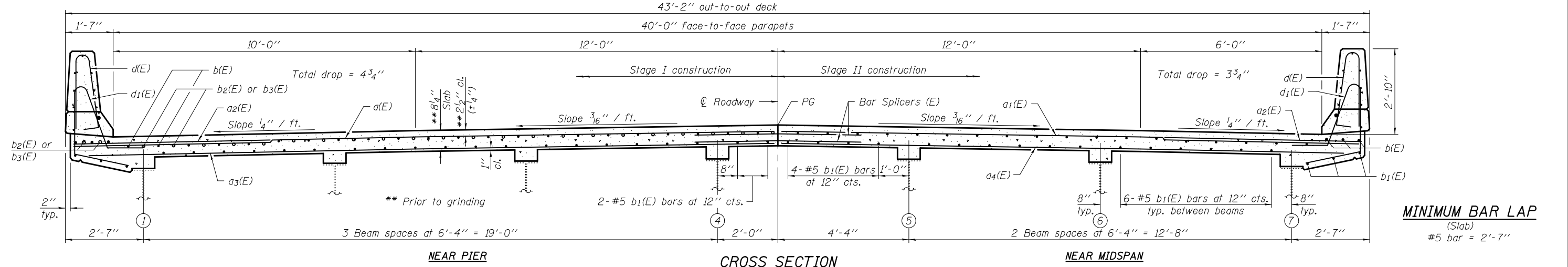

MINIMUM BAR LAP
 (Slab)
 #5 bar = 2'-7"

DESIGNED - FESSEHA TEKLEHAIMANOT	EXAMINED - <i>Jaime F. Joffe</i> ACTING ENGINEER OF BRIDGE DESIGN	DATE - SEPTEMBER 16, 2014	STATE OF ILLINOIS DEPARTMENT OF TRANSPORTATION	SUPERSTRUCTURE STRUCTURE NO. 018 - 0041 (WB)	F.A.I. R.T.E. - 70	SECTION - (18-45HB-1)BR	COUNTY - CUMBERLAND	TOTAL SHEETS - 43	SHEET NO. - 21	
CHECKED - JOSUE ORTIZ-VARELA	PASSED - <i>Carl Perry</i> ACTING ENGINEER OF BRIDGES AND STRUCTURES	REVISED			CONTRACT NO. 74187					
DRAWN - MICHAEL B. MOSSMAN		REVISED			SHEET NO. 14 OF 36 SHEETS					
CHECKED - F.T. / J.O.V. / G.R.A.					ILLINOIS FED. AID PROJECT					