

* Order a(E), a1(E), a3(E), and a4(E) bars full length. Cut to fit skew and use remainder of bars in opposite end.

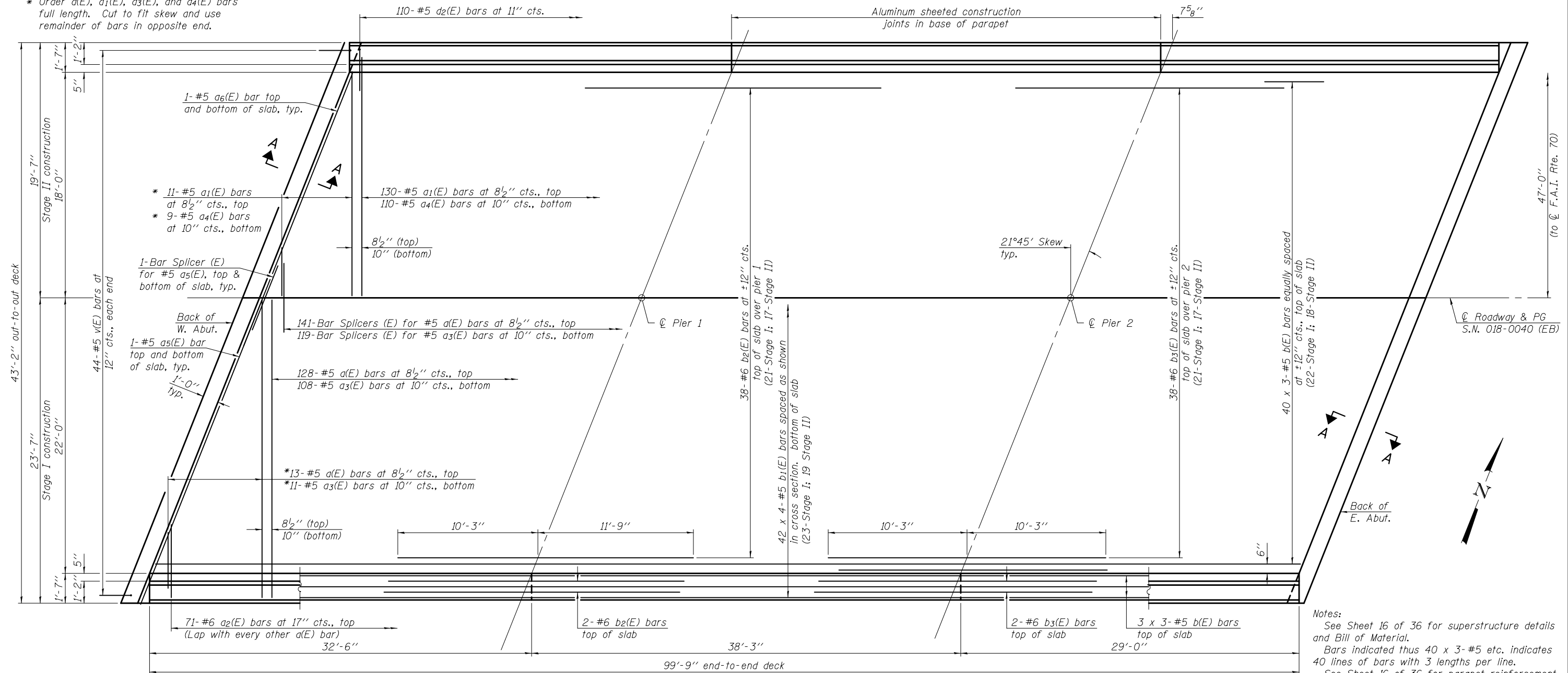

PLAN

Notes:
See Sheet 16 of 36 for superstructure details and Bill of Material.
Bars indicated thus 40 x 3- #5 etc. indicates 40 lines of bars with 3 lengths per line.
See Sheet 16 of 36 for parapet reinforcement.
See sheet 17 of 36 for diaphragm details and Section A-A.

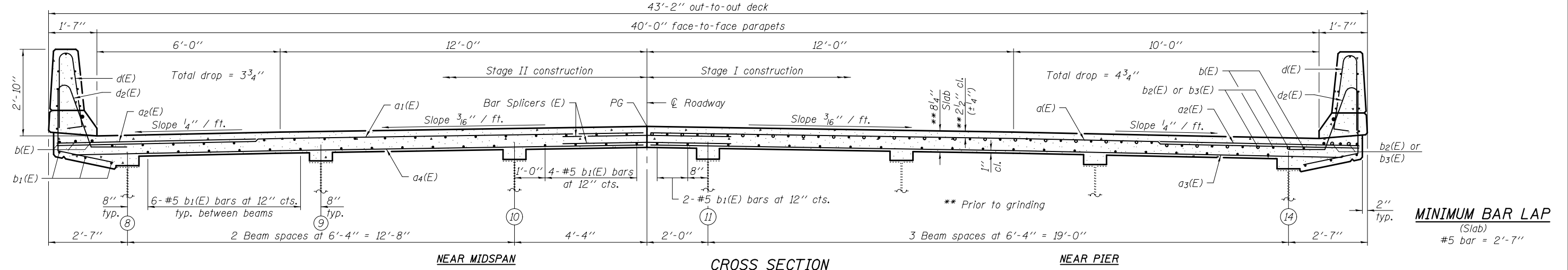

NEAR MIDSPAN

CROSS SECTION

NEAR PIER

DESIGNED - FESSEHA TEKLEHAIMANOT	EXAMINED - <i>James F. J. [Signature]</i>	DATE - SEPTEMBER 16, 2014	STATE OF ILLINOIS DEPARTMENT OF TRANSPORTATION	SUPERSTRUCTURE STRUCTURE NO. 018 - 0040 (EB)	F.A.I. R.E. 70	SECTION (18-45HB-1)BR	COUNTY CUMBERLAND	TOTAL SHEETS 43	SHEET NO. 22	
CHECKED - JOSUE ORTIZ-VARELA	PASSED - <i>Carl [Signature]</i>	REVISED			CONTRACT NO. 74187			ILLINOIS FED. AID PROJECT		
DRAWN - MICHAEL B. MOSSMAN	ACTING ENGINEER OF BRIDGES AND STRUCTURES	REVISED			SHEET NO. 15 OF 36 SHEETS					
CHECKED - F.T. / J.O.V. / G.R.A.										