

PLAN

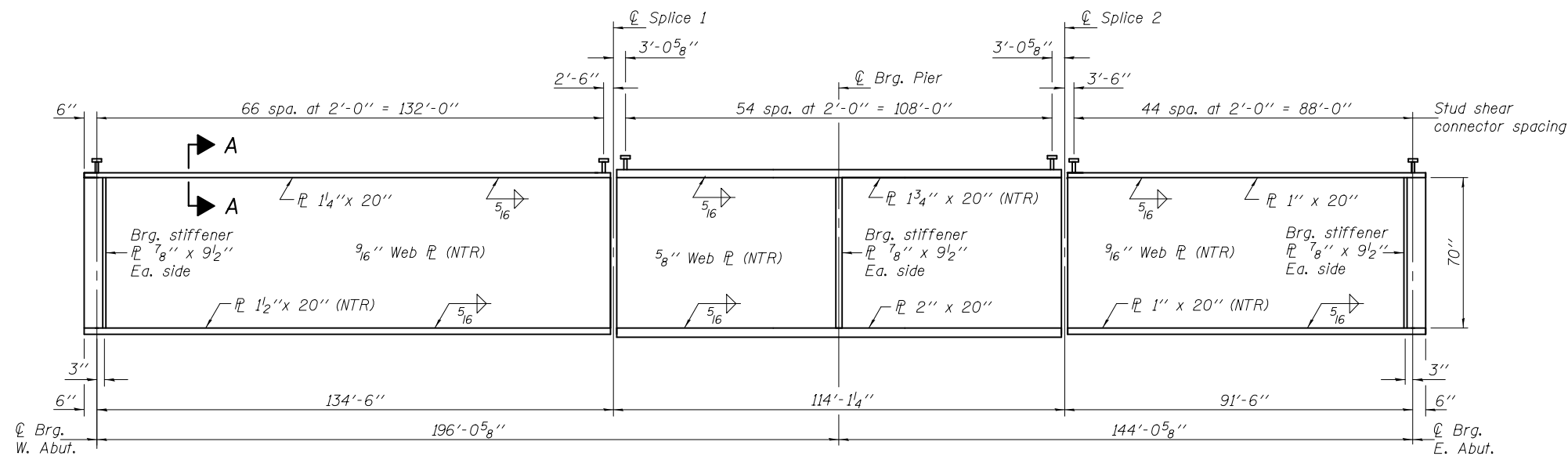

GIRDER ELEVATION

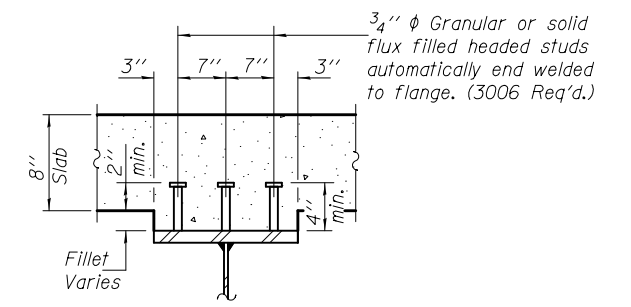

SECTION A-A

⌀ 1 1/2" φ holes in girder for m₁(E) thru m₂(E) bars. Typ. for all girders. See sheet 11 of 31.

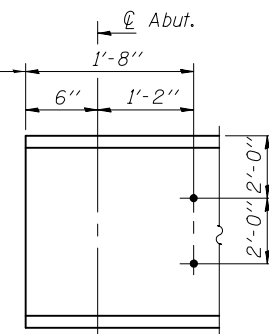

END OF GIRDER ELEVATION

Notes: Load carrying components designated "NTR" shall conform to the Impact Testing Requirement, Zone 2.
 All cross frames shall be installed as steel is erected and secured with erection pins and bolts except as otherwise noted. Individual cross frames at supports may be temporarily disconnected to install bearing anchor rods.
 All girder plates, including bearing stiffeners shall be AASHTO M 270 Grade 50.

DESIGNED - Justin T. Belue
 CHECKED - David H. Richter
 DRAWN - h.t. duong
 CHECKED - JTB/DHR

EXAMINED
 PASSED
 ACTING ENGINEER OF BRIDGES AND STRUCTURES

DATE - OCTOBER 16, 2014

REVISED
 REVISED

**STATE OF ILLINOIS
 DEPARTMENT OF TRANSPORTATION**

**STRUCTURAL STEEL
 STRUCTURE NO. 015-0076**

SHEET NO. 17 OF 31 SHEETS

F.A.P. RTE.	SECTION	COUNTY	TOTAL SHEETS	SHEET NO.
749	(122BR)B-1	COLES	60	34
CONTRACT NO. 74350				

ILLINOIS FED. AID PROJECT