

STATE OF ILLINOIS
DEPARTMENT OF TRANSPORTATION
DIVISION OF HIGHWAYS

**PROPOSED
HIGHWAY PLANS**

FAI ROUTE 57 (I-57)
SECTION (25-6,7)RS-2

RESURFACING (INT-2ND)
EFFINGHAM COUNTY

C-97-084-13

F.A.I. RTE.	SECTION	COUNTY	TOTAL SHEETS	SHEET NO.
57	(25-6,7)RS-2	EFFINGHAM	63	1
ILLINOIS			CONTRACT NO. 74638	

* 63 + 18 = 81 TOTAL SHEETS

D-97-038-13



LOCATION OF SECTION INDICATED THUS: -- [black rectangle] --

FOR INDEX OF SHEETS, SEE SHEET NO. 2

ADT = 15,900 (2013)

FAI ROUTE 57 (I-57)
SECTION (25-6,7)RS-2
PROJECT BEGINS
STATION 4625 + 56 (NBL)
STATION 4625 + 53 (SBL)

FAI ROUTE 57 (I-57)
SECTION (25-6,7)RS-2
PROJECT ENDS
STATION 5015 + 43 (NBL)
STATION 5009 + 14 (SBL)

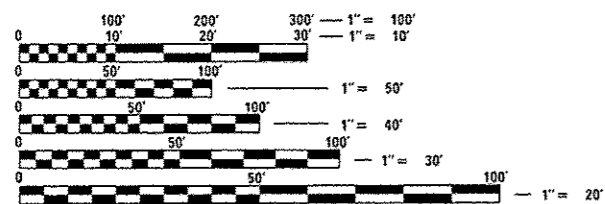

FULL SIZE PLANS HAVE BEEN PREPARED USING STANDARD ENGINEERING SCALES. REDUCED SIZED PLANS WILL NOT CONFORM TO STANDARD SCALES. IN MAKING MEASUREMENTS ON REDUCED PLANS, THE ABOVE SCALES MAY BE USED.

J.U.L.I.E.
JOINT UTILITY LOCATION INFORMATION FOR EXCAVATION
1-800-892-0123
OR 811

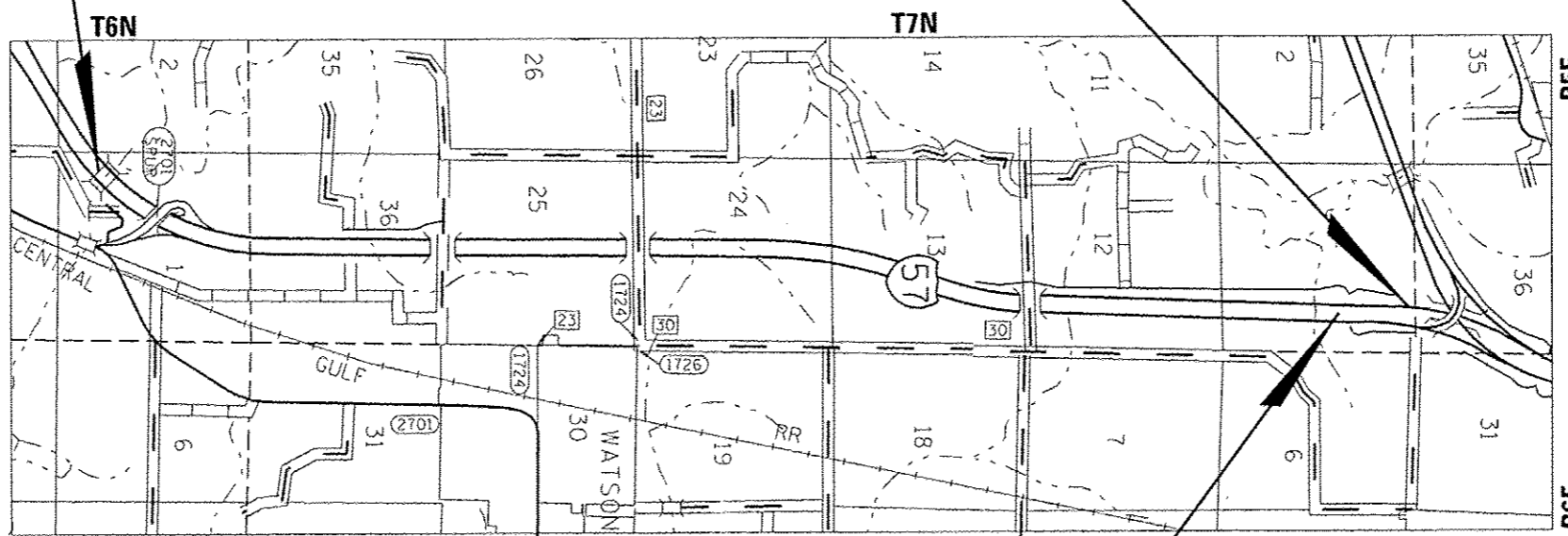

GROSS LENGTH = 36,674.27 FT. = 6.946 MILE
NET LENGTH = 36,674.27 FT. = 6.946 MILE

STATION EQUATION
4976 + 87.27 BK = 5000 + 00.00 AH (NBL)
4976 + 85.60 BK = 5000 + 00.00 AH (SBL)

PROJECT ENGINEER: MARK DAUGHERTY
PROJECT MANAGER: MATT BOWER

CONTRACT NO. 74638

STATE OF ILLINOIS
DEPARTMENT OF TRANSPORTATION
DIVISION OF HIGHWAYS

SUBMITTED Sept. 08 20 14
Roger L. Orshel
DEPUTY DIRECTOR OF HIGHWAYS, REGION ENGINEER

Oct 17 20 14
John D. Baranzelli, P.E.
ENGINEER OF DESIGN AND ENVIRONMENT

Oct 17 20 14
Omer Osman, P.E.
DIRECTOR OF HIGHWAYS, CHIEF ENGINEER

PRINTED BY THE AUTHORITY
OF THE STATE OF ILLINOIS