

CURVE DATA
 C.L. SURVEY FAI RTE. 57
 P.I. STATION 4647+81.80
 $\Delta = 58 -00' -00''$
 $D = 0 -50' -00''$
 $R = 6875.55'$
 $T = 3812.12'$
 $L = 6961.44'$
 $E = 986.09'$
 $S.E. = 0.015 \text{ ft./ft.}$
 ATTAINED IN 200'

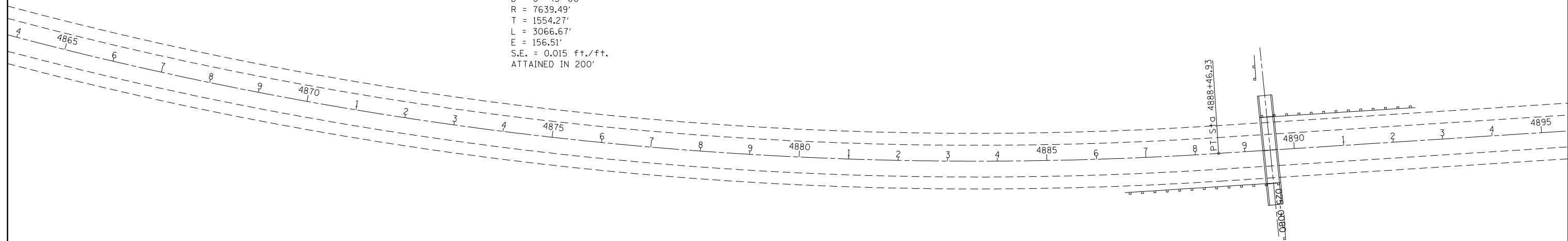

CURVE DATA
 C.L. SURVEY FAI RTE. 57
 P.I. STATION 4873+34.54
 $\Delta = 23 -00' -00''$
 $D = 0 -45' -00''$
 $R = 7639.49'$
 $T = 1554.27'$
 $L = 3066.67'$
 $E = 156.51'$
 $S.E. = 0.015 \text{ ft./ft.}$
 ATTAINED IN 200'

FILE NAME =	USER NAME = steffenmk	DESIGNED -	REVISED -
ei:\pw\work\p\dot\stevfenmk\d0401616\07	4638-sh1-plan.dgn	DRAWN -	REVISED -
Default	PLOT SCALE = 200.0000' / in.	CHECKED -	REVISED -
	PLOT DATE = 9/8/2014	DATE -	REVISED -

**STATE OF ILLINOIS
 DEPARTMENT OF TRANSPORTATION**

PLAN SHEETS

SCALE: 100 SHEET 5 OF 7 SHEETS STA. TO STA.

F.A.I. RTE.	SECTION	COUNTY	TOTAL SHEETS	SHEET NO.
57	(25-6, 7)RS-2	EFFINGHAM	63	19
CONTRACT NO. 74638			ILLINOIS FED. AID PROJECT	