

FRAMING PLAN
SPAN 8

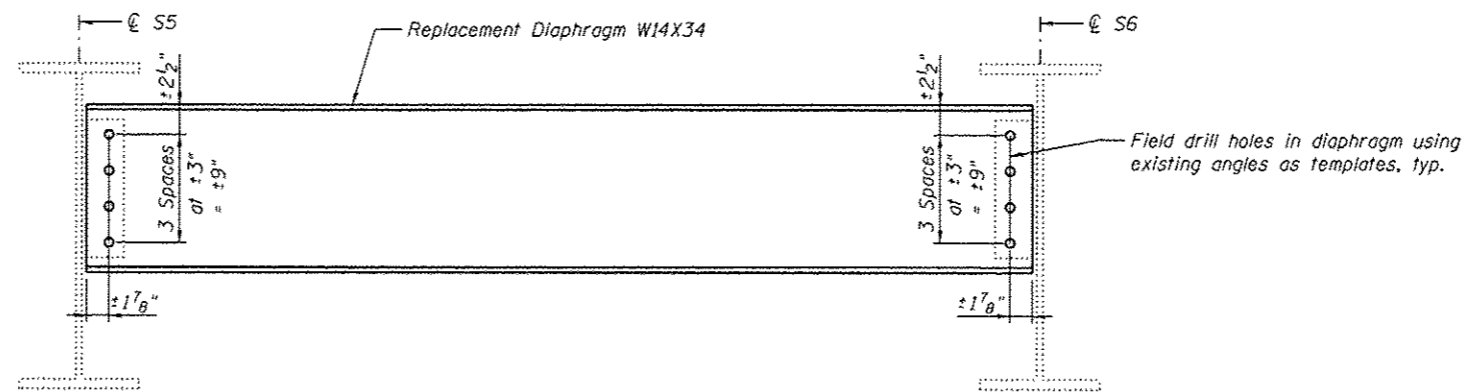

DETAIL 1
(Looking East)

BILL OF MATERIAL

Item	Unit	Total
Structural Steel Repair	Pound	230

Notes:
All bolted connections shown on this sheet shall be made with 3/4" dia. H.S. bolts.
Clip diaphragm flanges as approved by the Engineer if required for installation.



USER NAME *	DESIGNED - CDB	REVISED
	CHECKED - JMH	REVISED
PLOT SCALE *	DRAWN - AEC	REVISED
PLOT DATE *	CHECKED - CDB	REVISED

STATE OF ILLINOIS
DEPARTMENT OF TRANSPORTATION

MISSOURI APPROACH SPAN 8 DIAPHRAGM REPLACEMENT
S.N. 082-6001 MLK BRIDGE OVER MISSISSIPPI RIVER

SHEET NO. S44 OF S138 SHEETS

F.A.P. RTE.	SECTION	COUNTY	TOTAL SHEETS	SHEET NO.
799	IBR, ORS-2	ST. CLAIR	156	62
			CONTRACT NO. 76B03	
ILLINOIS FED. AID PROJECT				