

Existing Structure: S.N. 031-0016 consists of a three span continuous steel stringer superstructure supported on open abutments founded on precast concrete piles and protected by concrete slopewalls and individual pile bent piers founded on precast concrete piles.

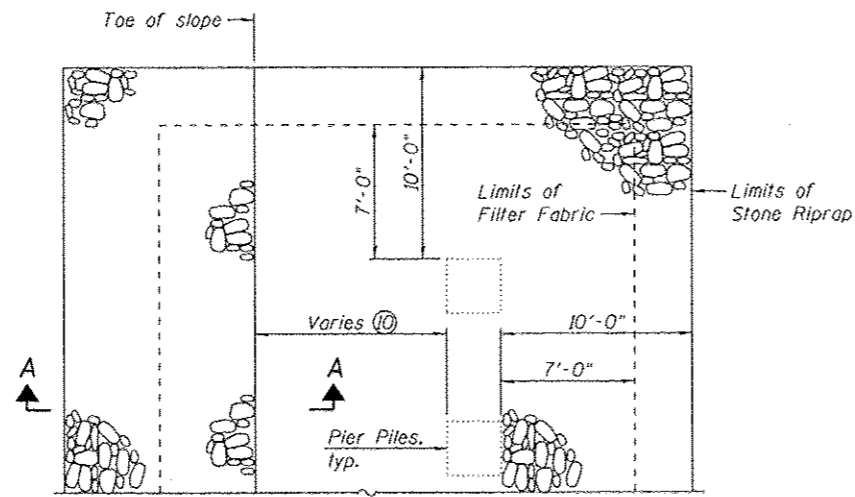

RIPRAP PROTECTION AT PIER

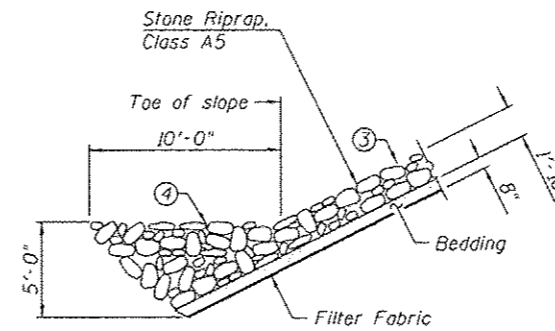

SECTION A-A

- Notes:
- ① The Contractor shall field verify existing dimensions, details, and conditions affecting new construction and make necessary approved adjustments prior to construction or ordering of materials. Such variations shall not be cause for additional compensation for a change in scope of the work, however, the Contractor will be paid for the quantity actually furnished based upon the unit price bid for the work.
 - ② Layout of the slope protection system may be varied to suit ground conditions in the field as directed by the Engineer. Slope protection system shall be placed in a manner that does not reduce the total waterway opening or block the flow of the drainage ditches below the structure.
 - ③ Grade channel bank to a slope that will provide a stable base for riprap as directed by the Engineer. Cost included in Channel Excavation.
 - ④ Grade streambed so that the top of the Stone Riprap approximately matches the existing stream profile as directed by the Engineer. Cost included in Channel Excavation.
 - ⑤ Additional excavation and reshaping of channel and bank may be required to facilitate proper placement of Stone Riprap as directed by the Engineer.
 - ⑥ Channel Excavation shall include the cost of removing and disposing of existing riprap, brick, block, rubble, or other material as encountered.
 - ⑦ Contractor to locate existing underground utilities. Where existing underground utilities conflict with riprap placement, the Contractor shall adjust the layout as directed by the Engineer.
 - ⑧ Elevation view shown as of January 30, 2014. Actual conditions may vary.
 - ⑨ Estimated quantities. Actual quantities to be determined in the field.
 - ⑩ Stone Riprap shall extend to the toe of the slope.



ELEVATION VIEW ⑧
(Looking South)

TOTAL BILL OF MATERIAL ⑨

CODE NO.	ITEM	UNIT	TOTAL
20300100	Channel Excavation	Cu. Yd.	15
28100109	Stone Riprap, Class A5	Sq. Yd.	485
28200200	Filter Fabric	Sq. Yd.	360

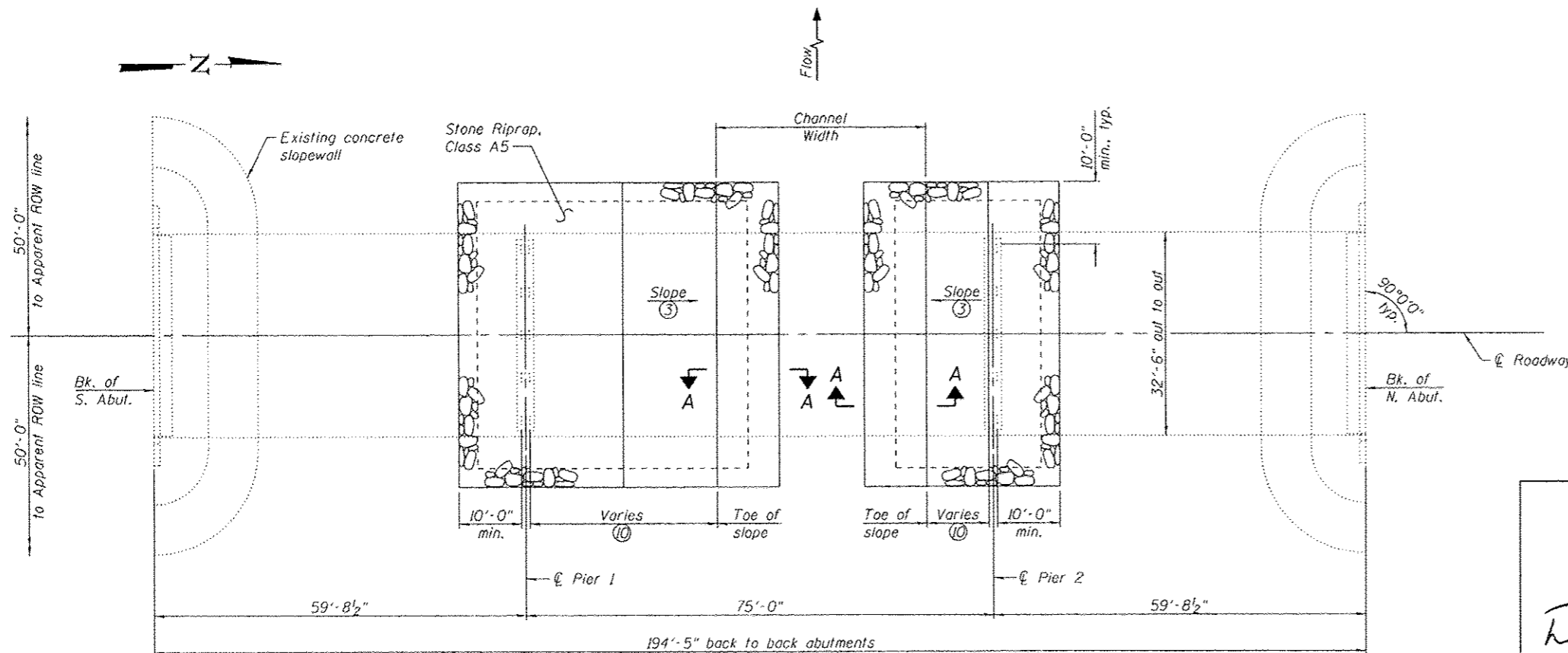

PLAN

DANIEL GEORGE LUZ
062-060383
LICENSED PROFESSIONAL ENGINEER OF ILLINOIS

DATE: 8/15/2014
EXPIRATION: 11/30/2015

IL ROUTE 267 OVER LICK CREEK
STRUCTURE NO. 031-0016



USER NAME *	DESIGNED - MAG	REVISIONS
DESIGNED BY	CHECKED - JAD	REVISIONS
DESIGNED DATE	DRAWN - MAG	REVISIONS
DESIGNED BY	CHECKED - JAD	REVISIONS

STATE OF ILLINOIS
DEPARTMENT OF TRANSPORTATION

SHEET NO. 1 OF 1 SHEETS

F.A. RTE.	SECTION	COUNTY	TOTAL SHEETS	SHEET NO.
		GREENE	9	8
			CONTRACT NO. 76H42	
ILLINOIS FED. AID PROJECT				