

SEC. 17, T7S, R8E, 3RD P.M.

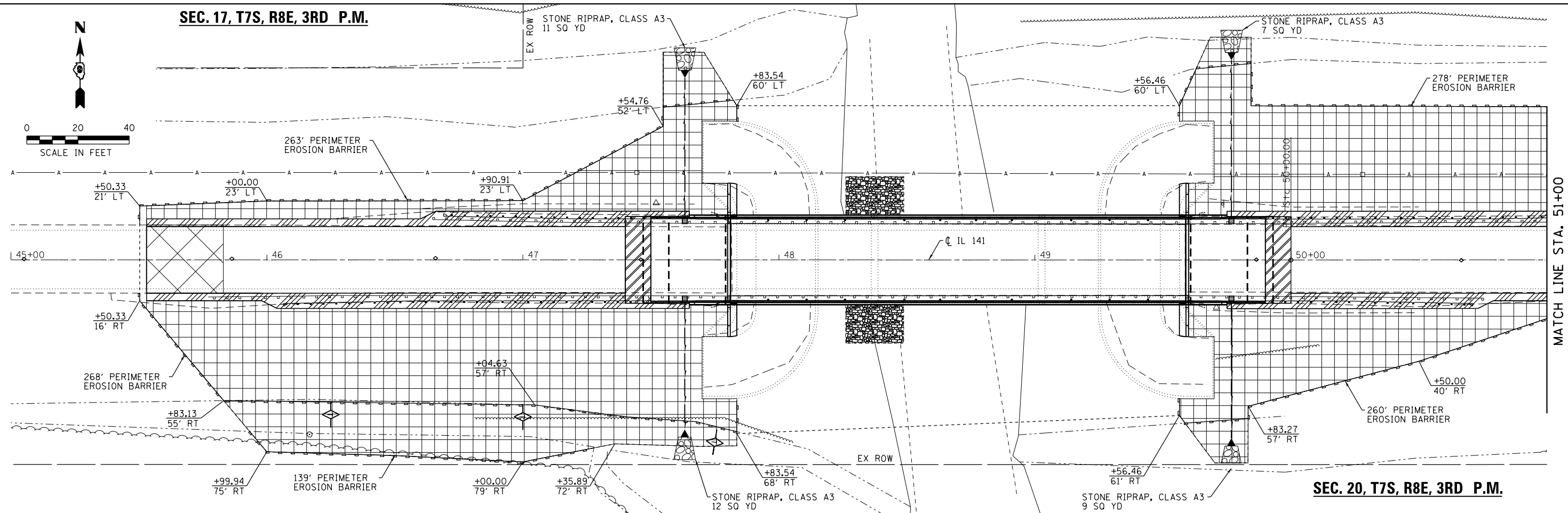

MATCH LINE STA. 51+00

SEC. 20, T7S, R8E, 3RD P.M.

SEC. 16, T7S, R8E, 3RD P.M.

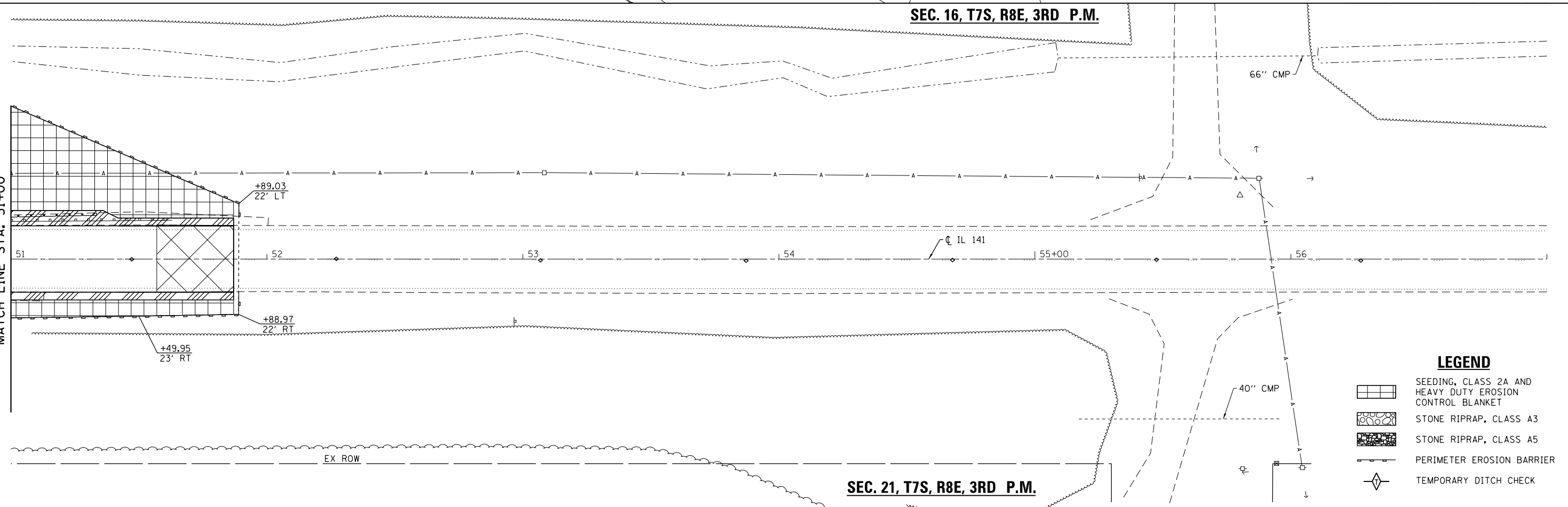

MATCH LINE STA. 51+00

LEGEND

- SEEDING, CLASS 2A AND HEAVY DUTY EROSION CONTROL BLANKET
- STONE RIPRAP, CLASS A3
- STONE RIPRAP, CLASS A5
- PERIMETER EROSION BARRIER
- TEMPORARY DITCH CHECK

SEC. 21, T7S, R8E, 3RD P.M.

FILE NAME = c:\new-work\p\midot\halstead\80406687\0978231-shr-eros.dgn
MODEL = \$MODEL\$
PLOT DRIVER = \$PLTDRVS\$



USER NAME = halsteadw	DESIGNED - MCV	REVISED -
FILE NAME = 0978231-shr-eros.dgn	DRAWN - CMM	REVISED -
PLOT SCALE = 40.0000' / in.	CHECKED - MTM	REVISED -
PLOT DATE = 7/14/2014	DATE -	REVISED -

**STATE OF ILLINOIS
DEPARTMENT OF TRANSPORTATION**

**ILLINOIS ROUTE 141
EROSION AND SEDIMENT CONTROL PLAN**

SCALE: 1" = 20" SHEET NO. 1 OF 1 SHEETS STA. 45+00.00 TO STA. 57+00.00

F.A.P. RTE.	SECTION	COUNTY	TOTAL SHEETS	SHEET NO.
877	100B-1	WHITE	54	15
CONTRACT NO. 78231				
ILLINOIS FED. AID PROJECT				