

Notes:
 See sheet 10 of 22 for Sections C-C & D-D and View E-E.
 $a_2(E)$, $a_4(E)$ and $a_5(E)$ bar spacings measured along C.Rdwy.
 Order all bars full length. Cut bars in field to clear inlet boxes.

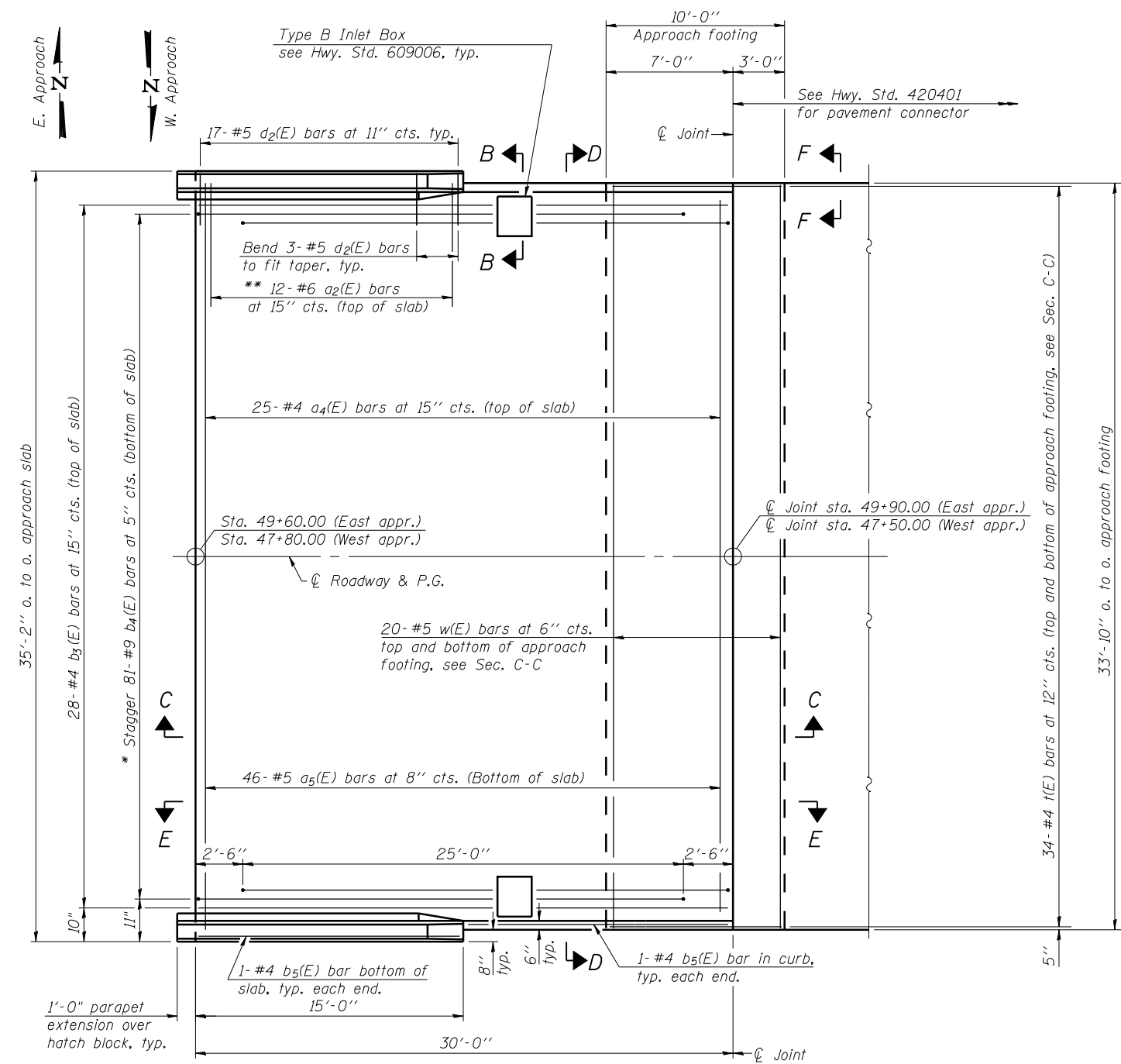

PLAN

* Tilt #9 $b_4(E)$ bars as required to maintain clearance.
 ** Space between $a_4(E)$ bars, typ. ea. parapet.

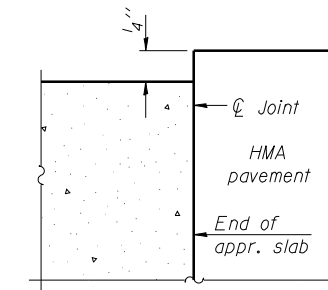

FLEXIBLE PAVEMENT

DETAIL A

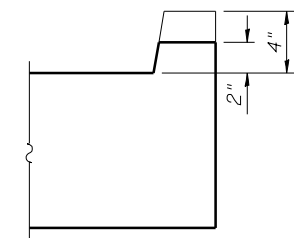

VIEW F-F

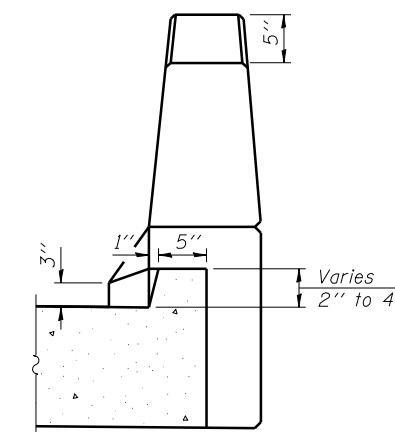

VIEW B-B

(Sheet 1 of 2)



USER NAME = kah	DESIGNED - SHL 02/13	REVISED -
ESCA PROJECT NO. 988.14	CHECKED - RDP 02/13	REVISED -
	DRAWN - DWH 02/13	REVISED -
PLOT DATE = 7/3/2014 8:38:57 AM	CHECKED - SHL 05/13	REVISED -

STATE OF ILLINOIS
 DEPARTMENT OF TRANSPORTATION

BRIDGE APPROACH SLAB DETAILS
 STRUCTURE NO. 097-0027

SHEET NO. 9 OF 22 SHEETS

F.A.P. RTE.	SECTION	COUNTY	TOTAL SHEETS	SHEET NO.
877	100B-1	WHITE	54	28
CONTRACT NO. 78231				

ILLINOIS FED. AID PROJECT AID