

RUBBLIZATION STAGING TYPICAL SECTIONS

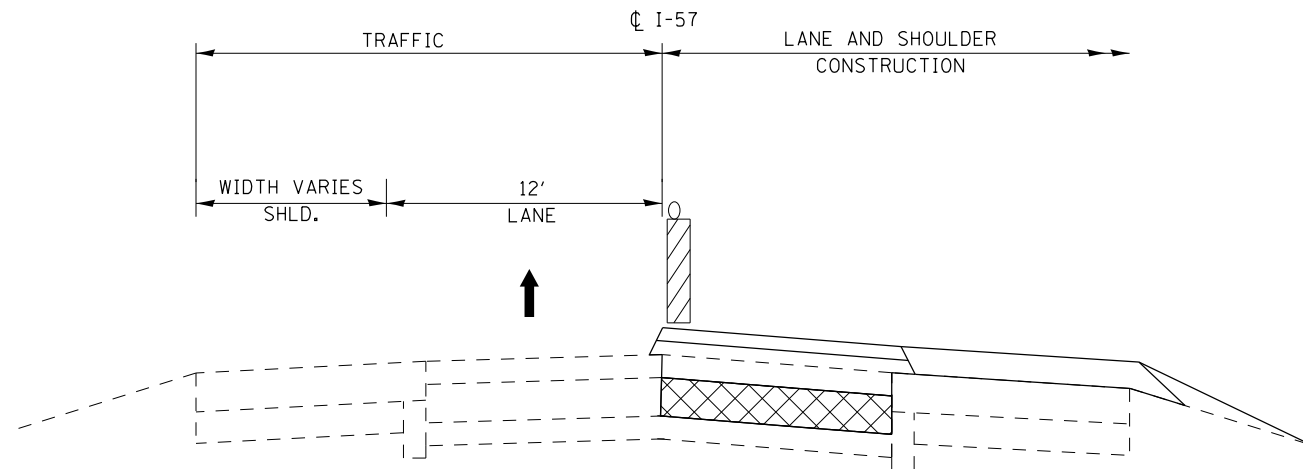

TYPICAL SECTION FOR FIRST LANE

*VERTICAL BARRICADES SHALL BE USED IN PLACE OF TYPE II BARRICADES OR DRUMS ON ALL TRAFFIC CONTROL STANDARDS.

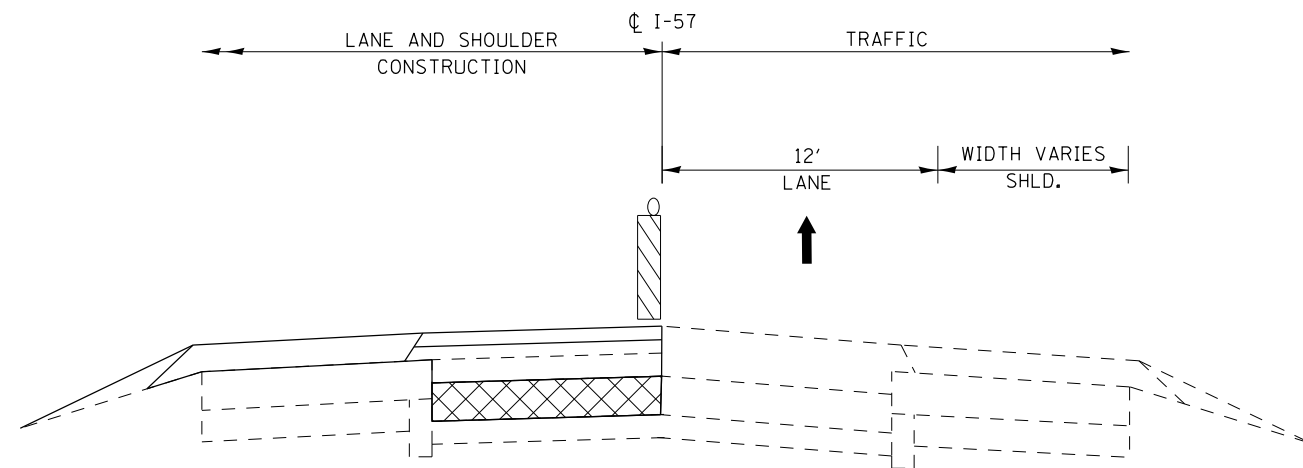

TYPICAL SECTION FOR SECOND LANE

*VERTICAL BARRICADES SHALL BE USED IN PLACE OF TYPE II BARRICADES OR DRUMS ON ALL TRAFFIC CONTROL STANDARDS.

REMOVAL AND REPLACEMENT STAGING TYPICAL SECTIONS

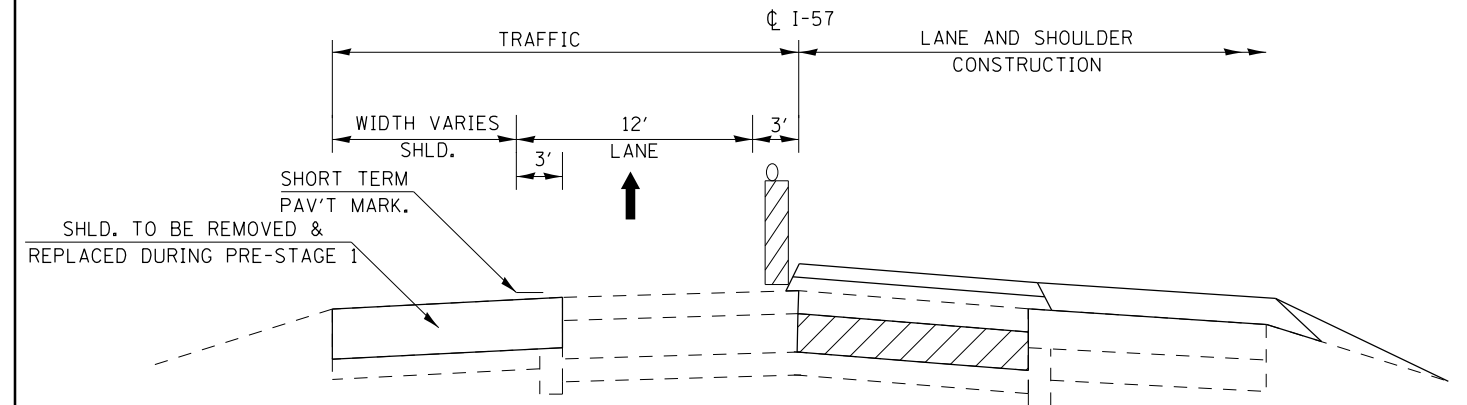

TYPICAL SECTION FOR FIRST LANE

*VERTICAL BARRICADES SHALL BE USED IN PLACE OF TYPE II BARRICADES OR DRUMS ON ALL TRAFFIC CONTROL STANDARDS.

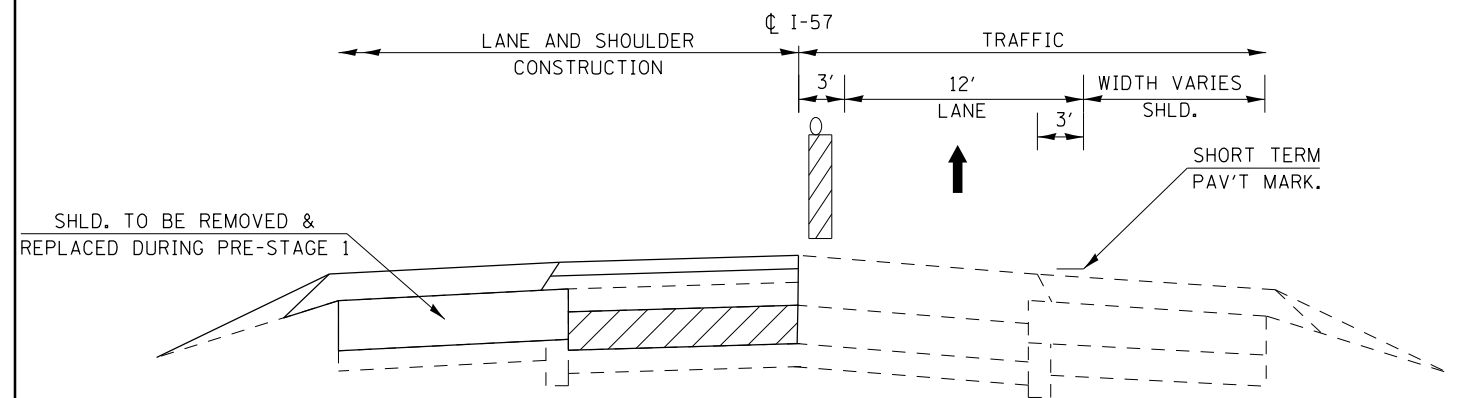

TYPICAL SECTION FOR SECOND LANE

*VERTICAL BARRICADES SHALL BE USED IN PLACE OF TYPE II BARRICADES OR DRUMS ON ALL TRAFFIC CONTROL STANDARDS.

TYPICAL PAVEMENT MARKING AT REMOVAL AND REPLACEMENT SECTIONS

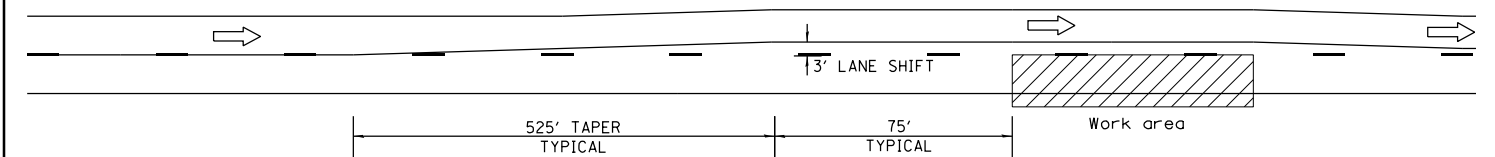

FILE NAME =	USER NAME = colemm	DESIGNED -	REVISED -
c:\pwork\pwork\colemm\d0351283\shd-1	stageconstruction.dgn	DRAWN -	REVISED -
Default	PLOT SCALE = 100.0000' / in.	CHECKED -	REVISED -
	PLOT DATE = 8/22/2014	DATE -	REVISED -

STATE OF ILLINOIS
DEPARTMENT OF TRANSPORTATION

STAGING TYPICAL SECTIONS

SCALE: SHEET OF SHEETS STA. TO STA.

F.A.I. RTE.	SECTION	COUNTY	TOTAL SHEETS	SHEET NO.
57	.	WILLIAMSON	107	50
ILLINOIS FED. AID PROJECT			CONTRACT NO. 78380	

(X1-8,X1-7-1,X1-7,X1-6-1)R-1